

# PROPOSED PAVEMENT MARKING STA 20+00 - 25+00

CONTRACT #	SECTION #	TOTAL SHEETS	SHEET NO.
89362	04-00401-24-RS	21	21

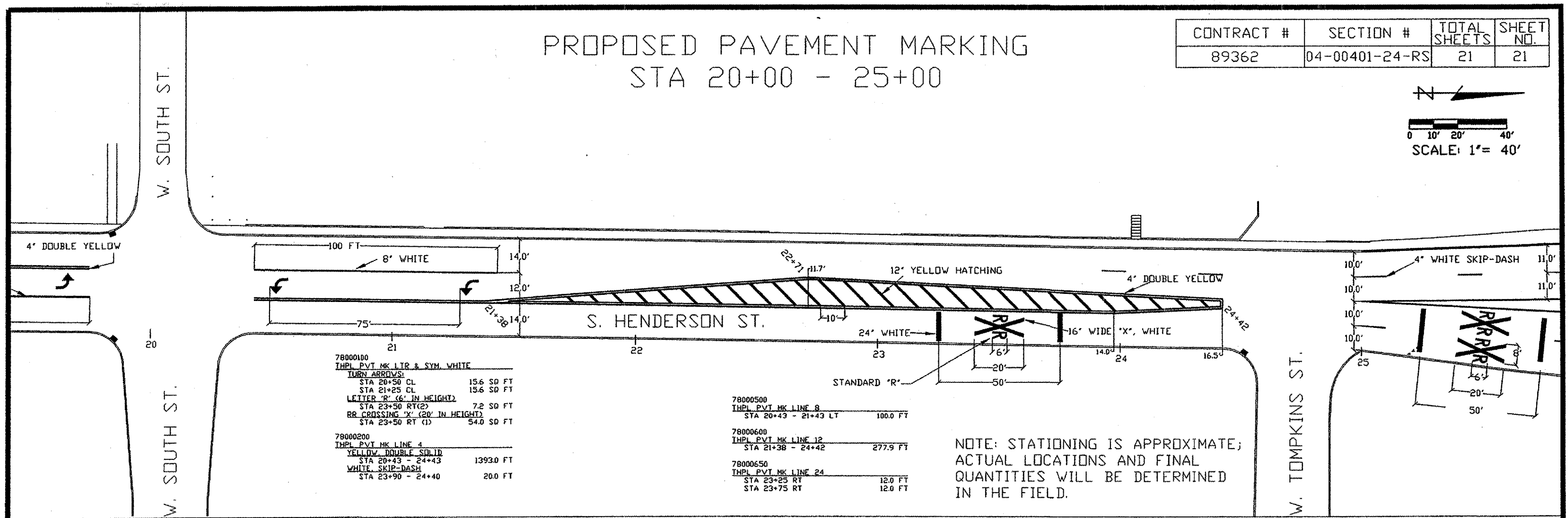
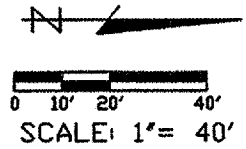

78000100	THPL PVT MK LTR & SYM, WHITE	
	TURN ARROWS:	
	STA 20+50 CL	15.6 SQ FT
	STA 21+25 CL	15.6 SQ FT
	LETTER 'R' (16' IN HEIGHT)	
	STA 23+50 RT(2)	7.2 SQ FT
	RR CROSSING 'X' (20' IN HEIGHT)	
	STA 23+50 RT (1)	54.0 SQ FT
78000200	THPL PVT MK LINE 4	
	YELLOW, DOUBLE SOLID	
	STA 20+43 - 24+43	1393.0 FT
	WHITE SKIP-DASH	
	STA 23+90 - 24+40	20.0 FT

78000500	THPL PVT MK LINE 8	
	STA 20+43 - 21+43 LT	100.0 FT
78000600	THPL PVT MK LINE 12	
	STA 21+38 - 24+42	277.9 FT
78000650	THPL PVT MK LINE 24	
	STA 23+25 RT	12.0 FT
	STA 23+75 RT	12.0 FT

NOTE: STATIONING IS APPROXIMATE;  
ACTUAL LOCATIONS AND FINAL  
QUANTITIES WILL BE DETERMINED  
IN THE FIELD.

# PROPOSED PAVEMENT MARKING STA 25+00 - 27+10

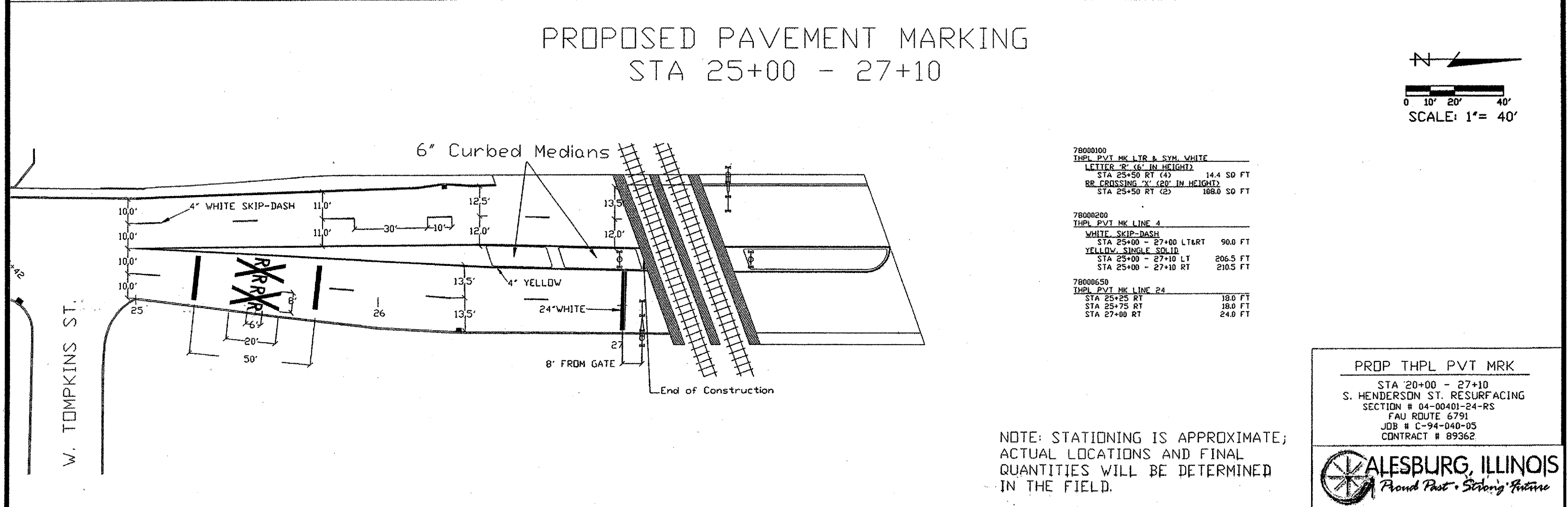
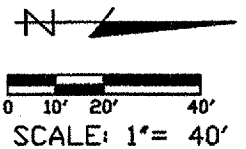

78000100	THPL PVT MK LTR & SYM, WHITE	
	LETTER 'R' (16' IN HEIGHT)	
	STA 25+50 RT (4)	14.4 SQ FT
	RR CROSSING 'X' (20' IN HEIGHT)	
	STA 25+50 RT (2)	108.0 SQ FT
78000200	THPL PVT MK LINE 4	
	WHITE SKIP-DASH	
	STA 25+00 - 27+00 LT&RT	90.0 FT
	YELLOW, SINGLE SOLID	
	STA 25+00 - 27+10 LT	206.5 FT
	STA 25+00 - 27+10 RT	210.5 FT
78000650	THPL PVT MK LINE 24	
	STA 25+25 RT	18.0 FT
	STA 25+75 RT	18.0 FT
	STA 27+00 RT	24.0 FT

PROP THPL PVT MRK  
STA 20+00 - 27+10  
S. HENDERSON ST. RESURFACING  
SECTION # 04-00401-24-RS  
FAU ROUTE 6791  
JOB # C-94-040-05  
CONTRACT # 89362

NOTE: STATIONING IS APPROXIMATE;  
ACTUAL LOCATIONS AND FINAL  
QUANTITIES WILL BE DETERMINED  
IN THE FIELD.

