

CONTRACT #	SECTION #	TOTAL SHEETS	SHEET NO.
89362	04-00401-24-RS	21	15

35400300	PCC BASE CSE V.B.	
STA 22+47.3 - 22+60.8 LT	2.2 SQ YD	
STA 22+54.5 - 22+57.5 RT	0.5 SQ YD	
STA 22+72.4 - 22+75.8 RT	0.6 SQ YD	
STA 22+77.3 - 23+30.6 LT	8.9 SQ YD	
STA 22+86.7 - 22+90.5 RT	0.6 SQ YD	
STA 23+24.0 - 23+27.0 RT	0.5 SQ YD	
STA 23+42.2 - 23+47.0 LT	0.8 SQ YD	
STA 23+53.3 - 23+56.3 RT	0.5 SQ YD	
STA 23+83.4 - 23+90.4 RT	1.2 SQ YD	
STA 23+91.4 - 23+94.5 LT	0.5 SQ YD	
STA 24+01.3 - 24+05.9 RT	0.8 SQ YD	
STA 24+02.5 - 24+10.0 LT	1.2 SQ YD	
STA 24+18.7 - 24+24.7 LT	1.0 SQ YD	
STA 24+24.7 - 24+27.7 RT	0.5 SQ YD	
STA 24+46.0 - 25+01.5 LT	9.2 SQ YD	

40600982	HMA SURF REM BUTT JT	
STA 24+73 RT	26.6 SQ YD	
40600995	TEMPORARY RAMP SPL	
STA 24+73 RT	22.2 SQ YD	
STA 24+75 LT	6.0 SQ YD	

42400300	PC CONC SIDEWALK 6	
STA 22+74.3 - 22+82.3 LT	27.0 SQ FT	
STA 24+47.4 - 24+83.4 LT	126.0 SQ FT	
44000080	HMA SURF REM (CM) 3	
STA 22+50 - 25+00	1111.1 SQ YD	

44000600	SIDEWALK RCM	
STA 22+74.3 - 22+99.8 LT	89.2 SQ FT	
STA 23+36.2 - 23+43.3 LT	25.2 SQ FT	
STA 23+63.3 - 24+03.6 LT	143.1 SQ FT	
STA 24+18.0 - 24+27.2 LT	34.0 SQ FT	
STA 24+47.4 - 24+91.1 LT	153.0 SQ FT	

40200800	AGG SURF CSE B	
STA 24+75 LT	1.4 TONS	

40600100	BIT MATLS PR CT	
STA 22+50 - 25+00	91 GAL	

40600300	AGG PR CT	
STA 22+50 - 25+00	2.3 TONS	

40603080	HMA BC SUPER II-19.0 N50	
STA 22+50 - 25+00	16J TONS	

40603535	P HMA SC SUPER 'D' N50	
STA 22+50 - 25+00	100 TONS	

40800050	INCIDENTAL HMA SURF	
STA 22+75 LT	0.2 TONS	
STA 23+25 LT	0.2 TONS	
STA 24+75 LT	0.4 TONS	

42400100	PC CONC SIDEWALK 4	
STA 22+82.3 - 22+99.8 LT	62.2 SQ FT	
STA 23+36.2 - 23+43.3 LT	25.2 SQ FT	
STA 23+63.3 - 24+03.6 LT	143.1 SQ FT	
STA 24+18.0 - 24+27.2 LT	34.0 SQ FT	
STA 24+83.4 - 24+91.1 LT	27.0 SQ FT	
STA 25+18.0 - 26+25.0 LT	141.0 SQ FT	

44000500	COMB CURB GUTTER REM	
STA 22+47.3 - 22+60.8 LT	13.5 FT	
STA 22+54.5 - 22+57.5 RT	3.0 FT	
STA 22+72.4 - 22+75.8 RT	3.4 FT	
STA 22+77.3 - 23+30.6 LT	53.3 FT	
STA 22+86.7 - 22+90.5 RT	3.8 FT	
STA 23+24.0 - 23+27.0 RT	3.0 FT	
STA 23+39.9 - 23+45.4 RT	5.5 FT	
STA 23+42.2 - 23+47.0 LT	4.8 FT	
STA 23+53.3 - 23+56.3 RT	3.0 FT	
STA 23+83.4 - 23+90.4 RT	7.0 FT	
STA 23+91.4 - 23+94.5 LT	3.1 FT	
STA 24+01.3 - 24+05.9 RT	4.6 FT	
STA 24+02.5 - 24+10.0 LT	7.5 FT	
STA 24+18.7 - 24+24.7 LT	6.0 FT	
STA 24+46.0 - 24+47.5 LT	3.0 FT	
STA 24+46.0 - 26+47.5 LT	197.5 FT	
STA 24+50.0 - 24+55.0 RT	5.0 FT	

44004400	PAVT REMOVAL SPL	
STA 22+47.3 - 22+60.8 LT	2.2 SQ YD	
STA 22+54.5 - 22+57.5 RT	0.5 SQ YD	
STA 22+72.4 - 22+75.8 RT	0.6 SQ YD	
STA 22+77.3 - 23+30.6 LT	8.9 SQ YD	
STA 22+86.7 - 22+90.5 RT	0.6 SQ YD	
STA 23+24.0 - 23+27.0 RT	0.5 SQ YD	
STA 23+42.2 - 23+47.0 LT	0.5 SQ YD	
STA 23+53.3 - 23+56.3 RT	0.5 SQ YD	
STA 23+83.4 - 23+90.4 RT	1.2 SQ YD	
STA 23+91.4 - 23+94.5 LT	0.5 SQ YD	
STA 24+01.3 - 24+05.9 RT	0.8 SQ YD	
STA 24+02.5 - 24+10.0 LT	1.2 SQ YD	
STA 24+18.7 - 24+24.7 LT	1.0 SQ YD	
STA 24+46.0 - 24+27.7 RT	0.5 SQ YD	
STA 24+46.0 - 25+01.5 LT	9.2 SQ YD	

- PC CONC SIDEWALK 4
- PC CONC SIDEWALK 6
- PC CONC SIDEWALK 8
- CL C PATCH T1 11
- CL C PATCH T2 11
- CL C PATCH T3 11
- CL C PATCH T4 11
- PCC BASE CSE WIDENING 8
- HMA BC WIDENING 4
- COMB CC&G TYPE B-6.12
- BRICK SURF REM BUTT JT

- CENTERLINE STATIONING
- WATER MAIN
- STORM SEWER
- SANITARY SEWER

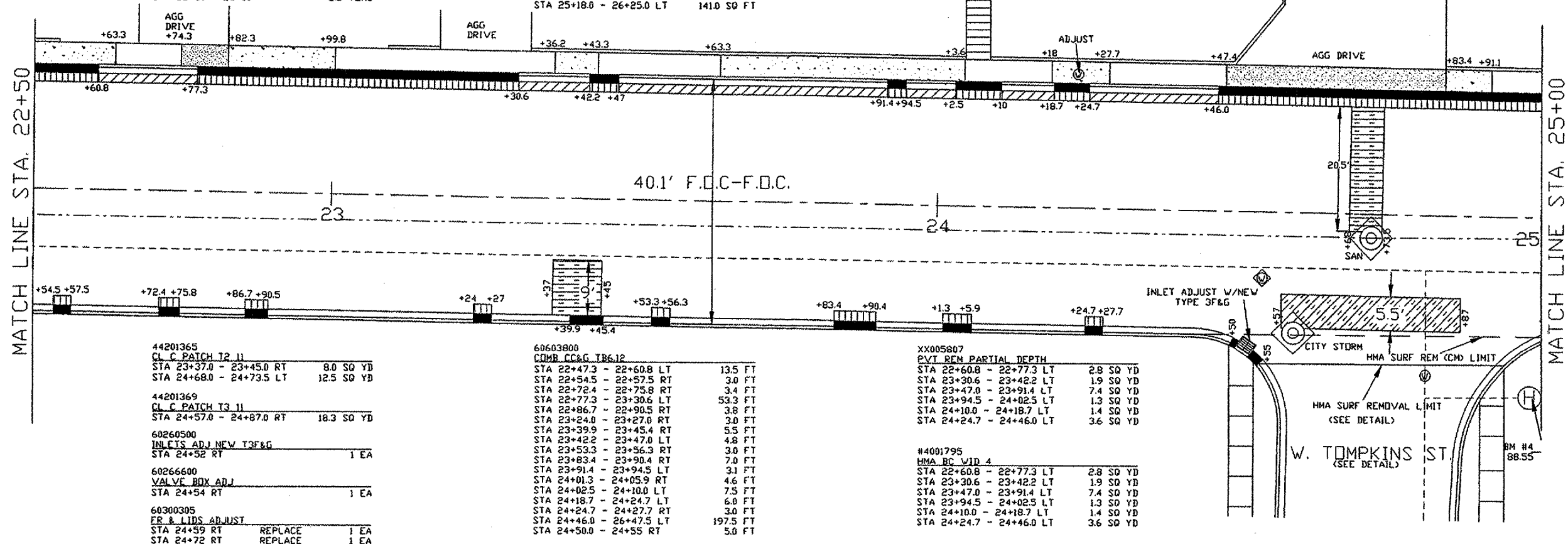
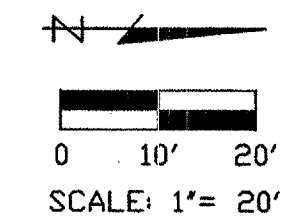

44201365	CL C PATCH T2 11	
STA 23+37.0 - 23+45.0 RT	8.0 SQ YD	
STA 24+68.0 - 24+73.5 LT	12.5 SQ YD	

44201369	CL C PATCH T3 11	
STA 24+57.0 - 24+87.0 RT	18.3 SQ YD	

60260500	INLETS ADJ NEW T3F&G	
STA 24+52 RT	1 EA	

60266600	VALVE BOX ADJ	
STA 24+54 RT	1 EA	

60300305	FR & LIDS ADJUST	
STA 24+59 RT	REPLACE 1 EA	
STA 24+72 RT	REPLACE 1 EA	

60603800	COMB CC&G TR6.12	
STA 22+47.3 - 22+60.8 LT	13.5 FT	
STA 22+54.5 - 22+57.5 RT	3.0 FT	
STA 22+72.4 - 22+75.8 RT	3.4 FT	
STA 22+77.3 - 23+30.6 LT	53.3 FT	
STA 22+86.7 - 22+90.5 RT	3.8 FT	
STA 23+24.0 - 23+27.0 RT	3.0 FT	
STA 23+39.9 - 23+45.4 RT	5.5 FT	
STA 23+42.2 - 23+47.0 LT	4.8 FT	
STA 23+53.3 - 23+56.3 RT	3.0 FT	
STA 23+83.4 - 23+90.4 RT	7.0 FT	
STA 23+91.4 - 23+94.5 LT	3.1 FT	
STA 24+01.3 - 24+05.9 RT	4.6 FT	
STA 24+02.5 - 24+10.0 LT	7.5 FT	
STA 24+18.7 - 24+24.7 LT	6.0 FT	
STA 24+24.7 - 24+27.7 RT	3.0 FT	
STA 24+46.0 - 26+47.5 LT	197.5 FT	
STA 24+50.0 - 24+55.0 RT	5.0 FT	

XX005807	PVI REM PARTIAL DEPTH	
STA 22+60.8 - 22+77.3 LT	2.8 SQ YD	
STA 23+30.6 - 23+42.2 LT	1.9 SQ YD	
STA 23+47.0 - 23+91.4 LT	7.4 SQ YD	
STA 23+94.5 - 24+02.5 LT	1.3 SQ YD	
STA 24+10.0 - 24+18.7 LT	1.4 SQ YD	
STA 24+24.7 - 24+46.0 LT	3.6 SQ YD	

#4001795	HMA BC WID 4	
STA 22+60.8 - 22+77.3 LT	2.8 SQ YD	
STA 23+30.6 - 23+42.2 LT	1.9 SQ YD	
STA 23+47.0 - 23+91.4 LT	7.4 SQ YD	
STA 23+94.5 - 24+02.5 LT	1.3 SQ YD	
STA 24+10.0 - 24+18.7 LT	1.4 SQ YD	
STA 24+24.7 - 24+46.0 LT	3.6 SQ YD	

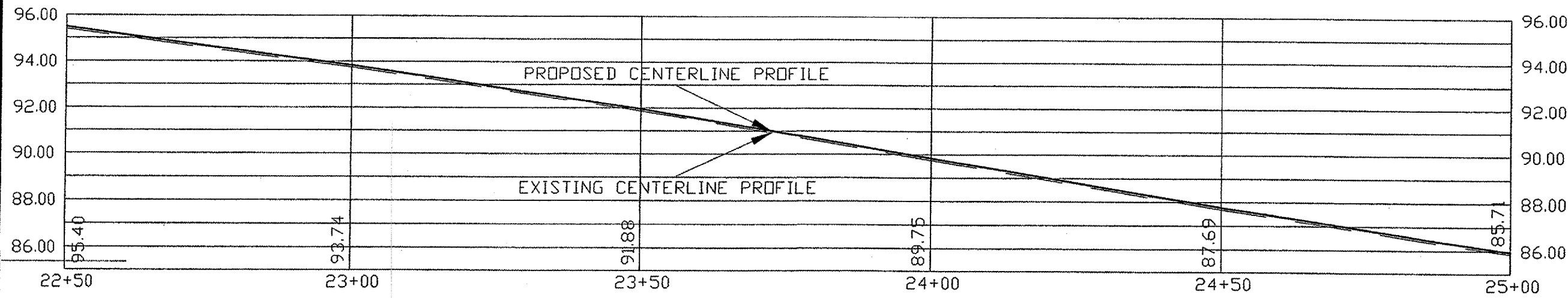

BM #4: ELEV: 88.55  
 TOP OF 'O' IN 'OPEN' DN  
 TOP OF FIRE HYDRANT  
 LOCATED AT THE NE  
 CORNER OF TOMPKINS ST.  
 AND S. HENDERSON ST.

PLAN & PROFILE 6  
 STA 22+50 - 25+00  
 S. HENDERSON ST. RESURFACING  
 SECTION # 04-00401-24-RS  
 FAU ROUTE 6791  
 JOB # C-94-040-05  
 CONTRACT # 89362



ALL ELEVATIONS EXISTING UNLESS OTHERWISE NOTED