

ROUTE NO.	SECTION	COUNTY	TOTAL SHEETS	SHEET NO.
FAU 2545	*	WILL	147	75
RELEASED DIST. NO. 7				
BLANDS				
FED. AID PROJECT				
* 98-00036-19-FP CONTRACT NO. 83896				

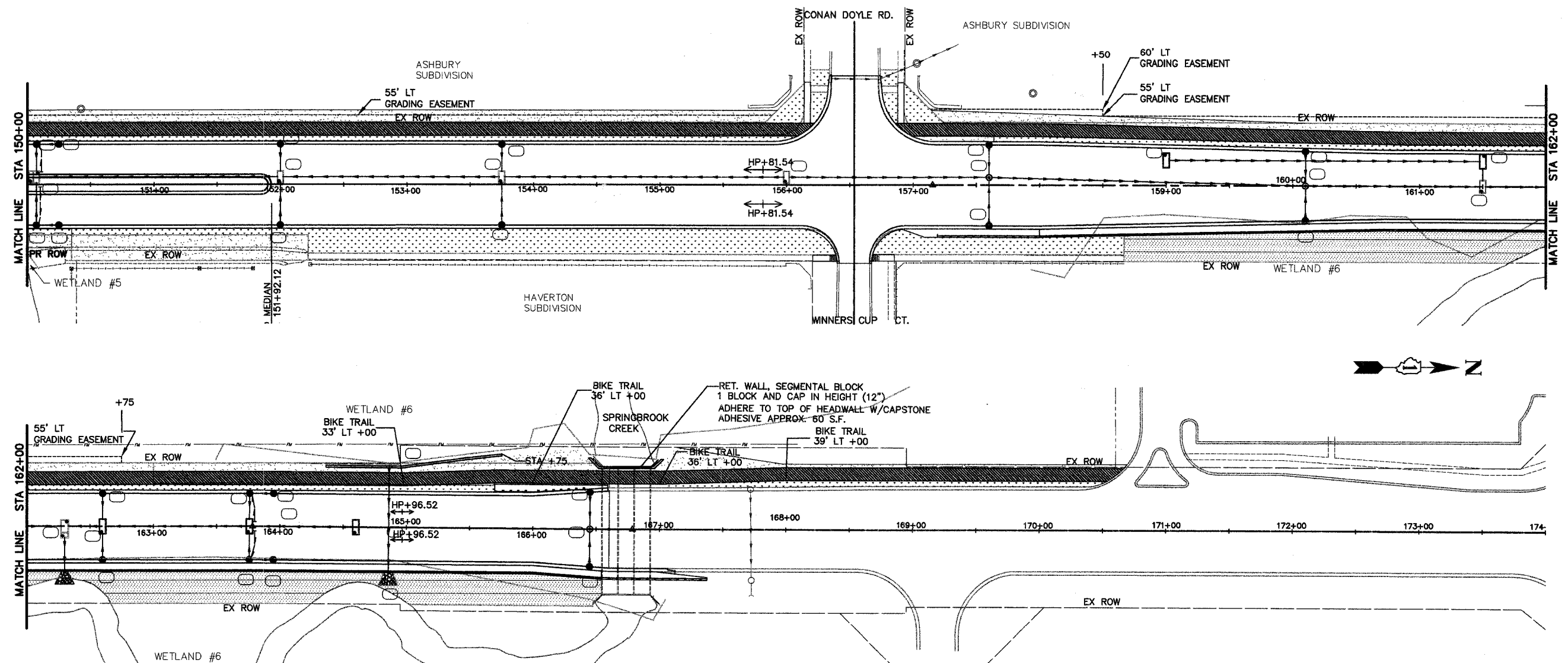

LEGEND

- SODDING SALT TOLERANT
- SEEDING CLASS 2A & EROSION CONTROL BLANKET
- STONE RIPRAP CLASS A5
- INLET & PIPE PROTECTION
- SEEDING CLASS 4A & EROSION CONTROL BLANKET

NO.	DATE	REVISION	BY

WILL COUNTY DEPARTMENT OF HIGHWAYS
 PLAINFIELD-NAPERVILLE ROAD (C.H. 14)
 ROADWAY RECONSTRUCTION
 LANDSCAPING AND EROSION CONTROL PLAN
 STA 150+00 TO 170+00

McDonough Associates Inc.
 Engineers/Architects

DESIGNED BY: JTF
 CHECKED BY: NJL
 DRAWN BY: JTF

SCALE:
 1" = 40'

P4
 DRAWING ID: G:\20030023 - Plainfield-Naperville Road\dwg\LS1-4.dwg
 PLOT DATE: 06/16/05 - 10:44