

ROUTE NO.	SECTION	COUNTY	TOTAL SHEETS	SHEET NO.
FAU 2545	*	WILL	147	74
FEDERAL DIST. NO. 7 ILLINOIS FED. AID PROJECT				
* 98-00036-19-FP CONTRACT NO. 83896				

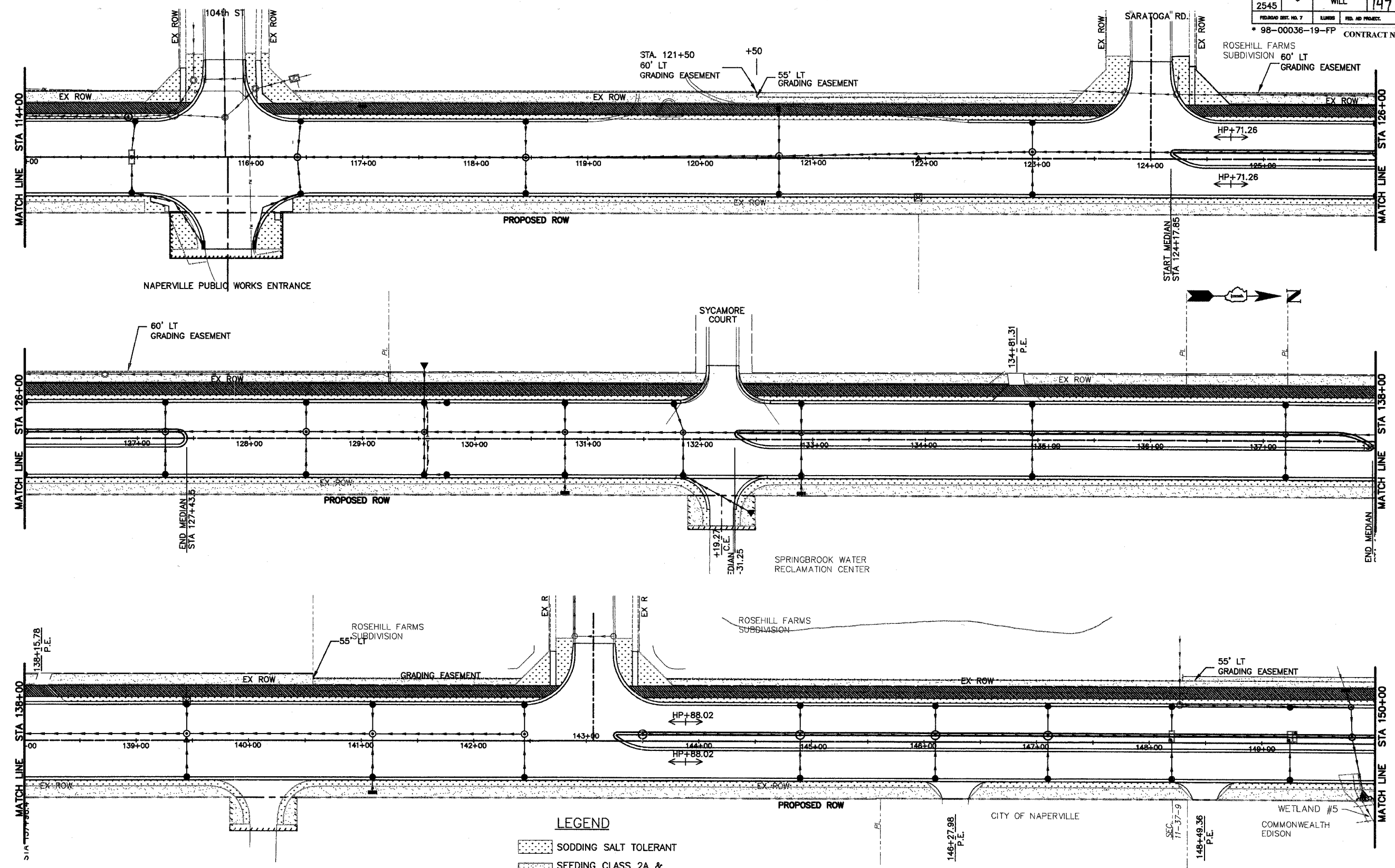

- LEGEND**
- SODDING SALT TOLERANT
 - SEEDING CLASS 2A & EROSION CONTROL BLANKET
 - STONE RIPRAP CLASS A5
 - INLET & PIPE PROTECTION
 - SEEDING CLASS 4A & EROSION CONTROL BLANKET

NO.	DATE	REVISION	BY

WILL COUNTY DEPARTMENT OF HIGHWAYS
 PLAINFIELD-NAPERVILLE ROAD (C.H. 14)
 ROADWAY RECONSTRUCTION
 LANDSCAPING AND EROSION CONTROL PLAN
 STA 114+00 TO 150+00

McDonough Associates Inc.
 Engineers/Architects

DESIGNED BY: JTF
 CHECKED BY: NUL
 DRAWN BY: JTF

SCALE:
 1" = 40'

P3
 DRAWING ID: G:\20030023 - Plainfield-Naperville Road\dwg\LS1-4.dwg
 PLOT DATE: 06/16/05 - 10:44