

ROUTE NO.	SECTION	COUNTY	TOTAL SHEETS	SHEET NO.
FAU 2545	*	WILL	147	65
FEDERAL DIST. NO. 7		KLINGB.	FED. AID PROJECT	
* 98-00036-19-FP CONTRACT NO. 83896				

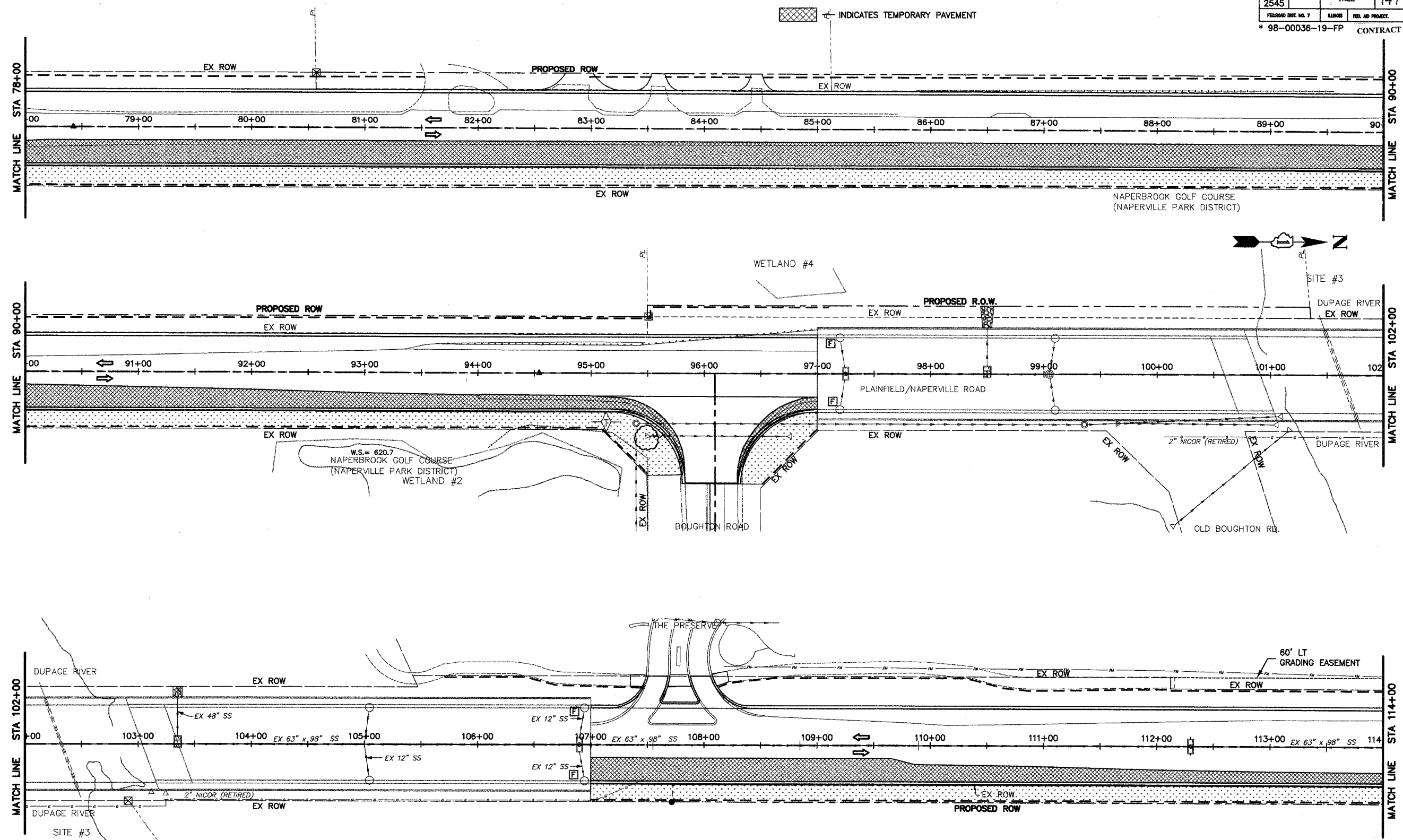

**LEGEND**

- INLET & PIPE PROTECTION (TYPICAL)
- TEMPORARY EROSION CONTROL SEEDING & MULCH METHOD 2
- AGGREGATE TEMPORARY ACCESS
- DRN. STRUCTURE INLET FILTER
- TEMPORARY DITCH CHECK
- PERIMETER EROSION BARRIER (SILT FILTER FENCE)
- TEMPORARY FENCE

NO.	DATE	REVISION	BY

WILL COUNTY DEPARTMENT OF HIGHWAYS  
 PLAINFIELD-NAPERVILLE ROAD (C.H. 14)  
 ROADWAY RECONSTRUCTION  
 TEMPORARY EROSION CONTROL - STAGE 1  
 STA 78+00 TO STA 114+00

McDonough Associates Inc.  
 Engineers/Architects

DESIGNED BY: JTF  
 CHECKED BY: NJL  
 DRAWN BY: JTF

SCALE:  
 1" = 40'

P2  
 DRAWING ID: G:\20030023 - Plainfield-Naperville Road\dwg\TEC14STG1.dwg  
 PLOT DATE: 07/08/05 - 08:06