

ROUTE NO.	SECTION	COUNTY	TOTAL SHEETS	SHEET NO.
FAU 2545	*	WILL	147	35
FED. ROAD DIST. NO. 7	ILLINOIS	FED. AID PROJECT		

* 98-00036-19-FP

CONTRACT NO. 83896

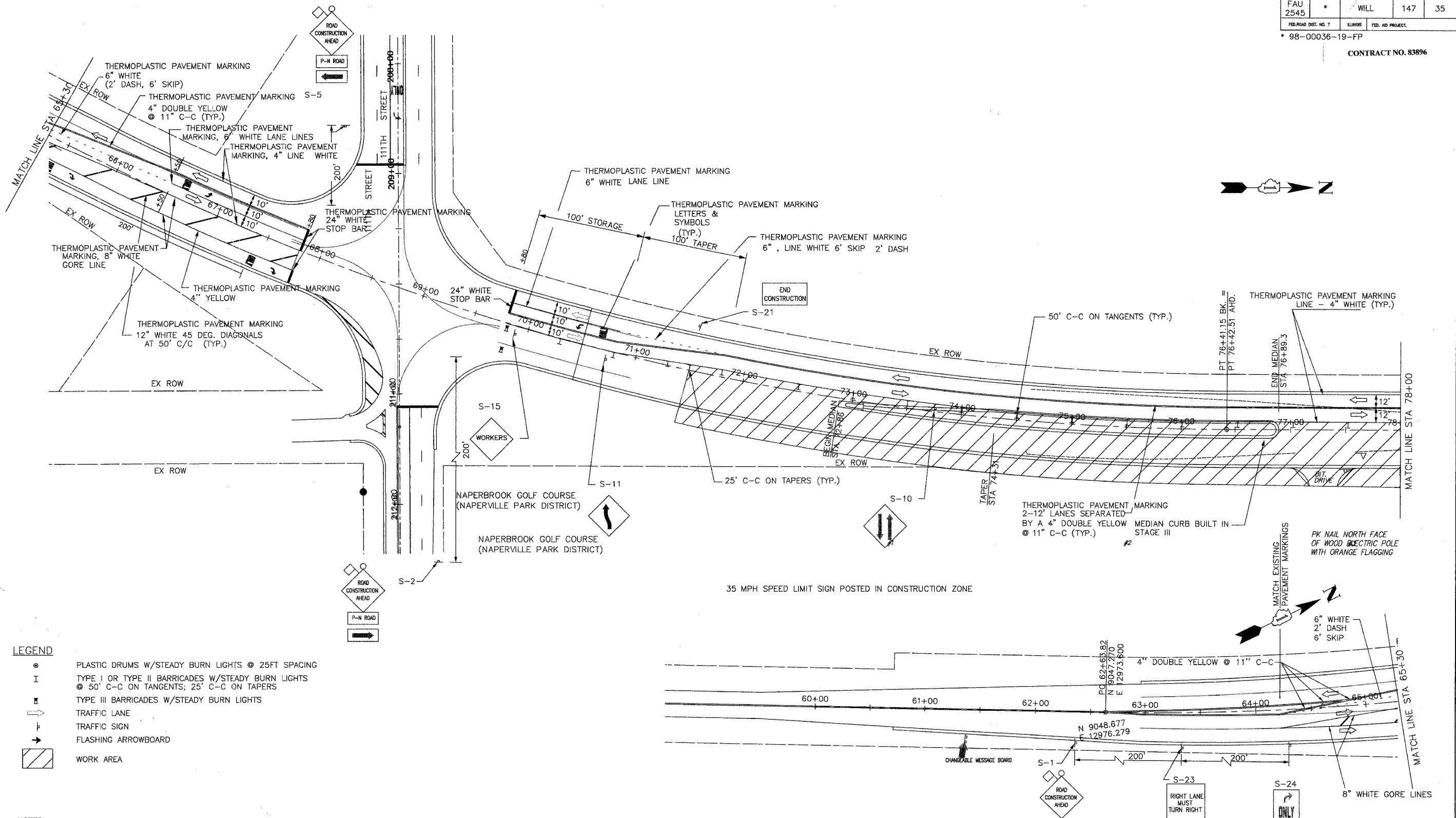

LEGEND

- ⊙ PLASTIC DRUMS W/STEADY BURN LIGHTS @ 25FT SPACING
- I TYPE I OR TYPE II BARRICADES W/STEADY BURN LIGHTS @ 50' C-C ON TANGENTS; 25' C-C ON TAPERS
- II TYPE III BARRICADES W/STEADY BURN LIGHTS
- ⇨ TRAFFIC LANE
- ⊣ TRAFFIC SIGN
- FLASHING ARROWBOARD
- ▨ WORK AREA

NOTES:

1. ADDITIONAL SUB-STAGING WILL BE REQUIRED AT ALL INTERSECTIONS AND AT THE END OF THE PROJECT. SIGNING AND BARRICADING FOR WORK SHALL BE PERFORMED PER STANDARDS 701501 AND 701606.
2. THE SIGNING AND BARRICADING FOR THE WORK TO BE COMPLETED ALONG PLAINFIELD NAPERVILLE ROAD SHALL BE IN ACCORDANCE WITH STANDARDS 701501 & 701606 AS APPLICABLE, AND AS SHOWN HEREIN.
3. THE CONTRACTOR WILL BE REQUIRED TO MAINTAIN ACCESS ACROSS ALL CROSS STREETS, COMMERCIAL ENTRANCES AND DRIVEWAYS AT ALL TIMES. AGGREGATE SURFACE COURSE FOR TEMPORARY ACCESS HAS BEEN INCLUDED FOR THIS PURPOSE. (REFER TO SPECIAL PROVISIONS)
4. THESE M.O.T. DRAWINGS REFLECT MAJOR STAGE WORK AREAS ONLY. ADDITIONAL SUBSTAGES WILL BE REQUIRED BY THE CONTRACTOR TO COMPLETE ALL WORK ACROSS TRANSITION AREAS. THIS WORK WILL BE COMPLETED AS DIRECTED BY THE ENGINEER IN ACCORDANCE WITH APPLICABLE STANDARDS INCLUDED HEREIN.

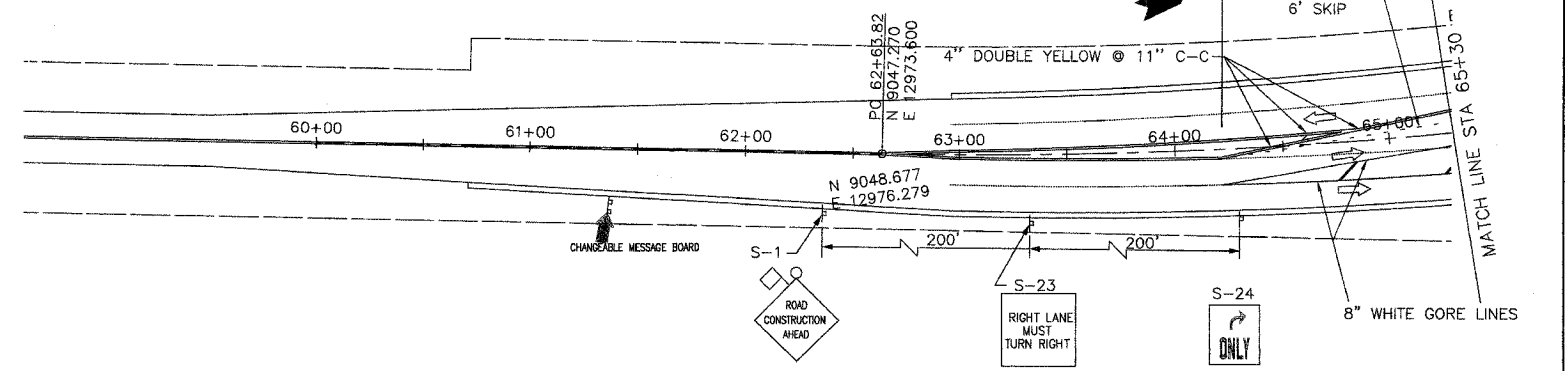

NO.	DATE	REVISION	BY

WILL COUNTY DEPARTMENT OF HIGHWAYS
PLAINFIELD-NAPERVILLE ROAD (C.H. 14)
ROADWAY RECONSTRUCTION
M.O.T. STAGE 3
STA 69+60 TO STA 78+00

McDonough Associates Inc. Engineers/Architects	DESIGNED BY: MC	SCALE: 1" = 40'
	CHECKED BY: NLL DRAWN BY: JTF	

P1
 DRAWING ID: G:\20030023 - Plainfield-Naperville Road\dwg\MOT3 1-4.dwg
 PLOT DATE: 07/08/05 10:33