

ROUTE NO. FAU 2545	SECTION *	COUNTY WILL	TOTAL SHEETS 147	SHEET NO. 27
FED. ROAD DIST. NO. 7		BLINDS	FED. AID PROJECT.	
* 98-00036-19-FP			CONTRACT NO. 83896	

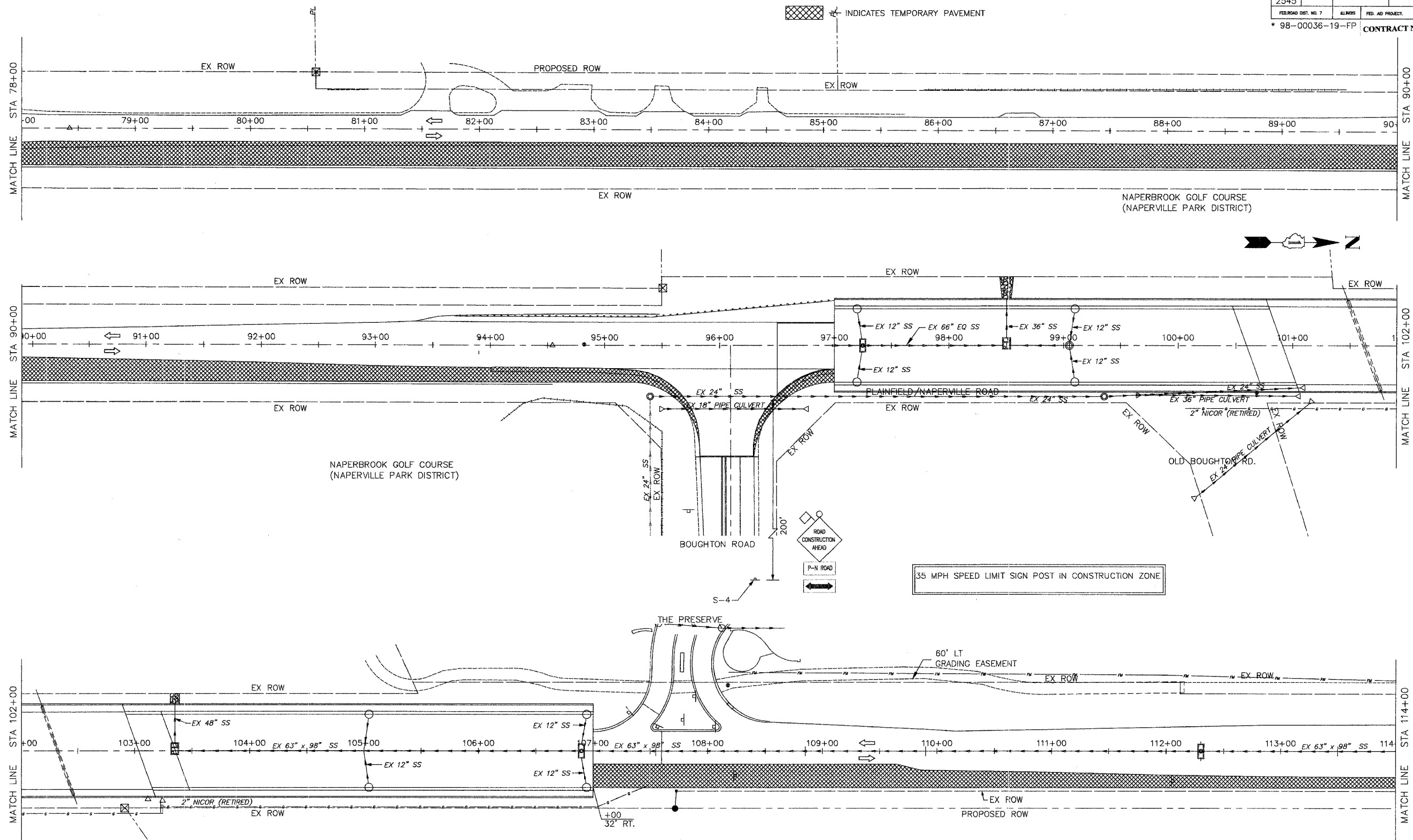

- NOTES:**
1. SIGNING AND BARRICADING FOR TEMPORARY ROADWAY WIDENING SHALL BE IN ACCORDANCE WITH STANDARDS 701326 AND 701501 AS APPLICABLE.
 2. FOR SIGN LEGEND SEE SHEET NO. MOT2
 3. TEMPORARY PAINT PAVEMENT MARKINGS SHALL BE USED ON TEMPORARY PAVEMENT FOR STAGE CONSTRUCTION. (PAY FOR AS TEMPORARY PAVEMENT MARKING OF THE SIZE SPECIFIED.)
 4. PAVEMENT MARKING TAPE SHALL BE USED ON FINAL PAVEMENT FOR STAGE CONSTRUCTION.
 5. THERMOPLASTIC PAVEMENT MARKINGS SHALL BE USED FOR FINAL PAVEMENT MARKINGS.

WILL COUNTY DEPARTMENT OF HIGHWAYS			
PLAINFIELD-NAPERVILLE ROAD (C.H. 14)			
ROADWAY RECONSTRUCTION			
TEMPORARY WIDENING AND M.O.T. STAGE 1			
STA 78+00 TO STA 114+00			
McDonough Associates Inc. Engineers/Architects		DESIGNED BY: WC	SCALE: 1" = 40'
		CHECKED BY: N.L.	
		DRAWN BY: JTF	
NO.	DATE	REVISION	BY

P2
DRAWING ID: G:\20030023 - Plainfield-Naperville Road\dwg\MOT1 1-4.dwg
PLOT DATE: 07/08/05 - 10:31