

| F.A.P. RTE. | SECTION | COUNTY | TOTAL SHEETS | SHEET NO. |
|-------------|---------|----------|--------------|-----------|
| 662 | 1(I-2) | SANGAMON | 7 | 1 |

STATE OF ILLINOIS
 DEPARTMENT OF TRANSPORTATION
 DIVISION OF HIGHWAYS
**PROPOSED
 HIGHWAY PLANS**

FAP ROUTE 662 (IL 4)
 SECTION 1(I-2)
 PROJECT: F-0662(060)
 SANGAMON COUNTY
 IL 4 (VETERANS PARKWAY)

C-96-508-08
 R 6 W

INDEX OF SHEETS

- 1 COVER SHEET
- 2 SUMMARY OF QUANTITIES
- 3 TRAFFIC SIGNAL DETAILS - IL 4 @ BRUNS LANE
- 4 TRAFFIC SIGNAL DETAILS - IL 4 @ PALOMINO ROAD
- 5 PROPOSED WIRING DIAGRAM - IL 4 @ BRUNS LANE
- 6 PROPOSED WIRING DIAGRAM - IL 4 @ PALOMINO ROAD
- 7 LEGEND FOR TRAFFIC SIGNAL DETAILS

STANDARDS

- 000001-04
- 701101-01
- 701106-01
- 701421-01
- 701701-04
- 702001-06
- 857001

IL 4 (VETERANS PARKWAY)
 BRUNS LANE
 STA 173+76
 BEGIN IMPROVEMENT

IL 4 (VETERANS PARKWAY)
 PALOMINO RD.
 STA 187+55
 END IMPROVEMENT

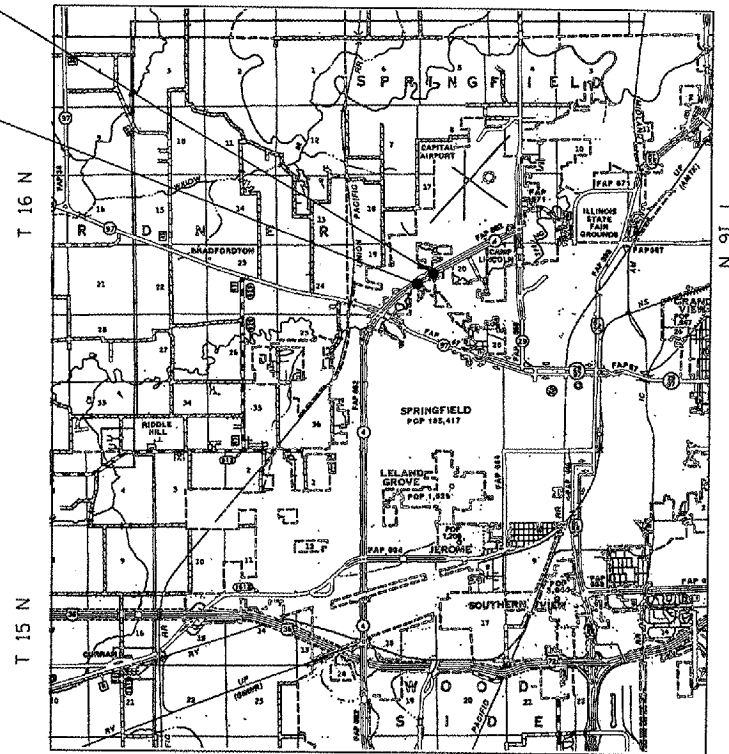

LENGTH OF PROJECT = 1379.00 FEET = 0.261 MILES

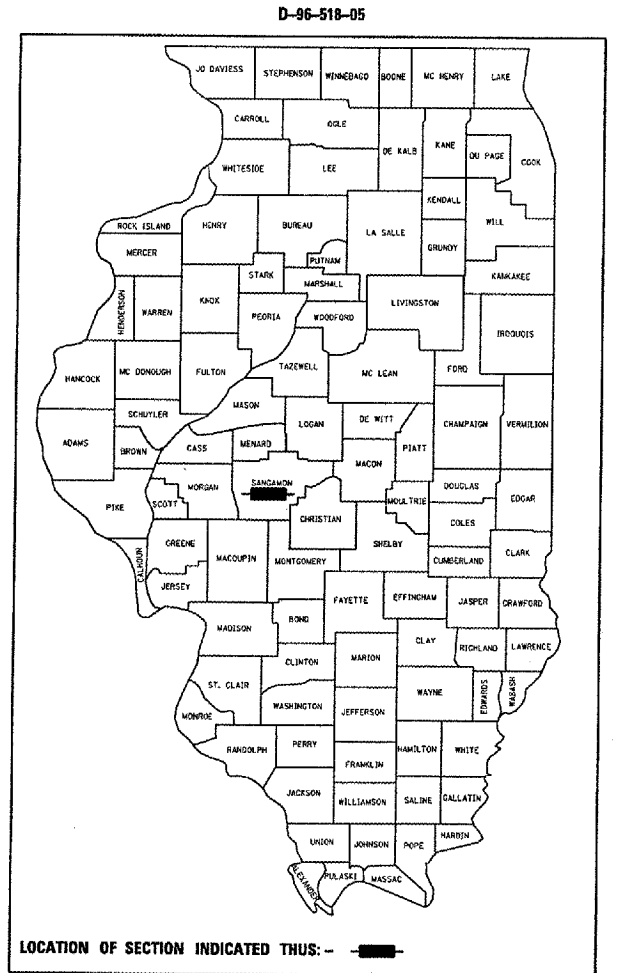

STATE OF ILLINOIS
 DEPARTMENT OF TRANSPORTATION
 DIVISION OF HIGHWAYS

SUBMITTED May 11, 2007
Carl M. Beadner
 DISTRICT ENGINEER

May 11, 2007
Eric E. Harn
 INTERIM ENGINEER OF DESIGN AND ENVIRONMENT

May 11, 2007
Milton R. Sees, P.E.
 DIRECTOR, DIVISION OF HIGHWAYS

**PRINTED BY THE AUTHORITY
 OF THE STATE OF ILLINOIS**

PROJECT ENGINEER: JOHN NEGANGARD 217-762-6980
 SENIOR SQUAD ENGINEER: MARK DUST 217-785-0597

FULL SIZE PLANS HAVE BEEN PREPARED USING STANDARD
 ENGINEERING SCALES. REDUCED SIZED PLANS WILL NOT
 CONFORM TO STANDARD SCALES. IN MAKING MEASUREMENTS
 ON REDUCED PLANS, THE ABOVE SCALES MAY BE USED.

J.U.L.I.E.
 JOINT UTILITY LOCATION INFORMATION FOR EXCAVATION
 1-800-892-0123

CONTRACT NO. 72980

| F.A. RTE. | SECTION | COUNTY | TOTAL SHEETS | SHEET NO. |
|---------------------|---------|---------------------------|--------------|-----------|
| 662 | 1(1-2) | SANGAMON | ..7.. | ..2.. |
| STA. | | TO STA. | | |
| FED. ROAD DIST. NO. | | ILLINOIS FED. AID PROJECT | | |

| SUMMARY OF QUANTITIES | | UNITS | URBAN TOTAL QUANTITY | CONSTR. CODE | CONSTR. CODE |
|-----------------------|---|-------|----------------------------|--|---|
| PAY CODE NUMBER | PAY ITEM DESCRIPTION | | | IL 4 AT BRUNS LANE Y031-1F 80% FED 10% STATE 10% CITY | IL 4 AT PALOMINO RD Y031-1F 80% FED 10% STATE 10% CITY |
| 67100100 | MOBILIZATION | L SUM | 1 | 0.5 | 0.5 |
| 70100310 | TRAFFIC CONTROL AND PROTECTION, STANDARD 701421 | L SUM | 1 | 0.5 | 0.5 |
| 70102635 | TRAFFIC CONTRL AND PROTECTION, STANDARD 701701 | L SUM | 1 | 0.5 | 0.5 |
| 85700200 | FULL-ACTUATED CONTROLLER AND TYPE IV CABINET | EACH | 1 | 1 | - |
| 85700300 | FULL-ACTUATED CONTROLLER AND TYPE V CABINET | EACH | 1 | - | 1 |
| 86400100 | TRANSCEIVER - FIBER OPTIC | EACH | 2 | 1 | 1 |
| 87100110 | FIBER OPTIC CABLE IN CONDUIT, NO 62.5/125,6F | FOOT | 1449 | 1449 | - |
| 88500100 | INDUCTIVE LOOP DETECTOR | EACH | 44 | 24 | 20 |
| 89502375 | REMOVE EXISTING TRAFFIC SIGNAL EQUIPMENT | EACH | 2 | 1 | 1 |
| X0323153 | ELECTRIC CABLE IN CONDUIT, GROUND, NO. 6 IC (GREEN) | FOOT | 1726 | 832 | 894 |

DISTRICT SIX

EXAMINED March 8 2007
[Signature]
 OPERATIONS ENGINEER

EXAMINED Mar 8 2007
[Signature]
 PROGRAM IMPLEMENTATION ENGINEER

EXAMINED Mar 8 2007
[Signature]
 PROGRAM DEVELOPMENT ENGINEER

PLOT DATE = 3/15/2007
 PLOT SCALE = 0.500000
 USER NAME = bsl

| REVISIONS | |
|-----------|------|
| NAME | DATE |
| | |
| | |
| | |
| | |
| | |
| | |
| | |
| | |
| | |
| | |

ILLINOIS DEPARTMENT OF TRANSPORTATION

SUMMARY OF QUANTITIES

SCALE: VERT. _____
 DATE: _____

DRAWN BY _____
 CHECKED BY _____

| | | | | |
|---------------------|----------|------------------|--------------|-----------|
| F.A.P. RTE. | SECTION | COUNTY | TOTAL SHEETS | SHEET NO. |
| 662 | 1(1-2) | SANGAMON | 7 | 3 |
| STA. | | TO STA. | | |
| FED. ROAD DIST. NO. | ILLINOIS | FED. AID PROJECT | | |

TRAFFIC SIGNAL QUANTITIES

VETERANS AND BRUNS

| QUANTITY | UNIT | ITEM |
|----------|------|--|
| 1 | EACH | FULL-ACTUATED CONTROLLER AND TYPE IV CABINET |
| 1 | EACH | TRANSCEIVER - FIBER OPTIC |
| 1449.0 | FOOT | FIBER OPTIC CABLE IN CONDUIT, NO. 62.5/125 6F |
| 24 | EACH | INDUCTIVE LOOP DETECTOR |
| 1 | EACH | REMOVE EXISTING TRAFFIC SIGNAL EQUIPMENT |
| 831.5 | FOOT | ELECTRIC CABLE IN CONDUIT, GROUND NO. 6, 1/C (GREEN) |

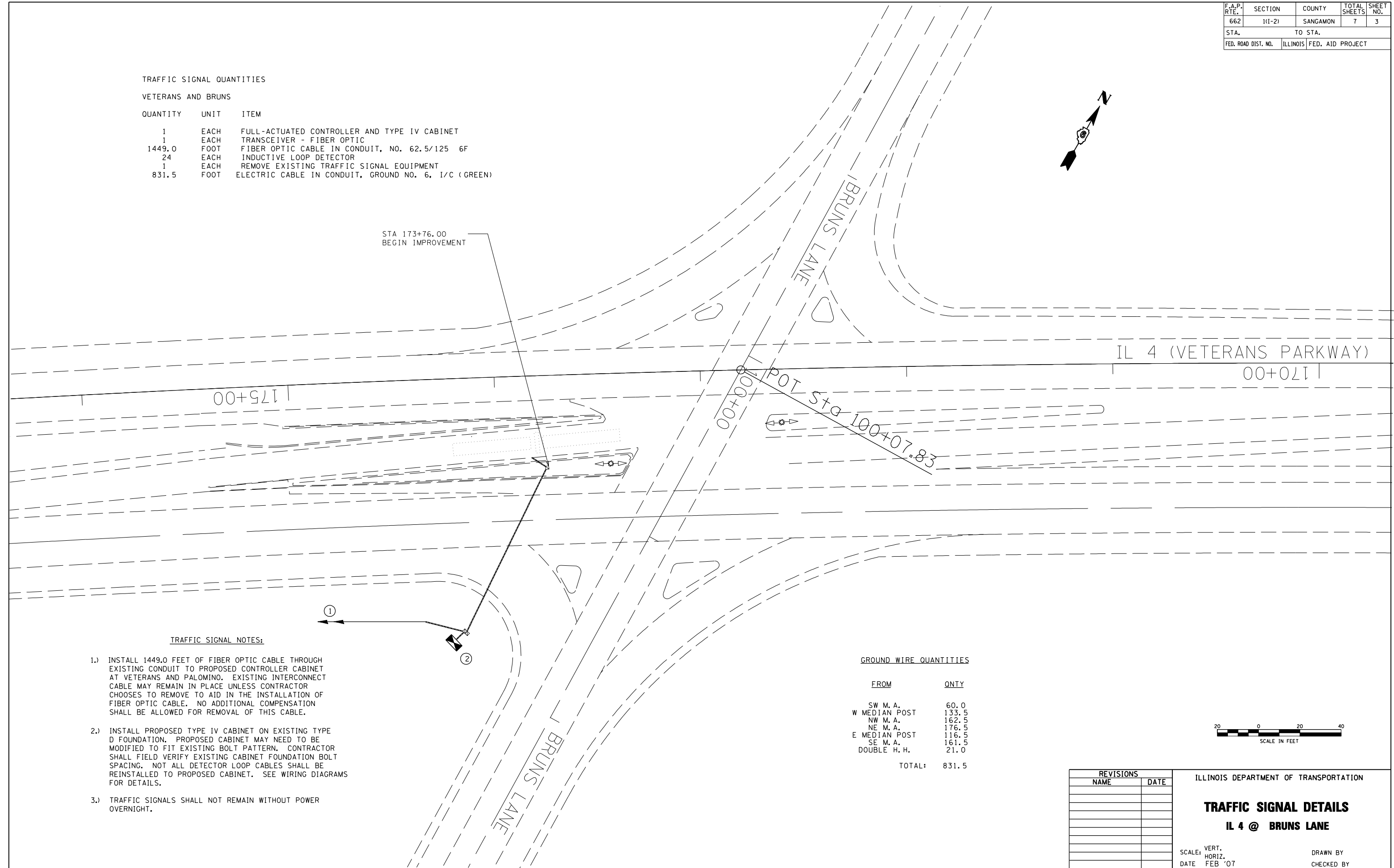

STA 173+76.00
BEGIN IMPROVEMENT

IL 4 (VETERANS PARKWAY)
00+01 | 170+01 |

175+00

POT Sta 100+07.83

TRAFFIC SIGNAL NOTES:

- 1.) INSTALL 1449.0 FEET OF FIBER OPTIC CABLE THROUGH EXISTING CONDUIT TO PROPOSED CONTROLLER CABINET AT VETERANS AND PALOMINO. EXISTING INTERCONNECT CABLE MAY REMAIN IN PLACE UNLESS CONTRACTOR CHOOSES TO REMOVE TO AID IN THE INSTALLATION OF FIBER OPTIC CABLE. NO ADDITIONAL COMPENSATION SHALL BE ALLOWED FOR REMOVAL OF THIS CABLE.
- 2.) INSTALL PROPOSED TYPE IV CABINET ON EXISTING TYPE D FOUNDATION. PROPOSED CABINET MAY NEED TO BE MODIFIED TO FIT EXISTING BOLT PATTERN. CONTRACTOR SHALL FIELD VERIFY EXISTING CABINET FOUNDATION BOLT SPACING. NOT ALL DETECTOR LOOP CABLES SHALL BE REINSTALLED TO PROPOSED CABINET. SEE WIRING DIAGRAMS FOR DETAILS.
- 3.) TRAFFIC SIGNALS SHALL NOT REMAIN WITHOUT POWER OVERNIGHT.

GROUND WIRE QUANTITIES

| FROM | QNTY |
|---------------|--------------|
| SW M. A. | 60.0 |
| W MEDIAN POST | 133.5 |
| NW M. A. | 162.5 |
| NE M. A. | 176.5 |
| E MEDIAN POST | 116.5 |
| SE M. A. | 161.5 |
| DOUBLE H. H. | 21.0 |
| TOTAL: | 831.5 |



| REVISIONS | |
|-----------|------|
| NAME | DATE |
| | |
| | |
| | |
| | |
| | |
| | |
| | |

ILLINOIS DEPARTMENT OF TRANSPORTATION
TRAFFIC SIGNAL DETAILS
IL 4 @ BRUNS LANE

SCALE: VERT. DRAWN BY
 HORIZ. CHECKED BY
DATE: FEB '07

PLOT DATE = \$DATE\$
FILE NAME = \$FILEL\$
PLOT SCALE = \$SCALE\$
REFERENCE = \$REF\$

| F.A.P. RTE. | SECTION | COUNTY | TOTAL SHEETS | SHEET NO. |
|---------------------|----------|------------------|--------------|-----------|
| 662 | 1(1-2) | SANGAMON | 7 | 4 |
| STA. | | TO STA. | | |
| FED. ROAD DIST. NO. | ILLINOIS | FED. AID PROJECT | | |

TRAFFIC SIGNAL QUANTITIES

VETERANS AND PALOMINO

| QUANTITY | UNIT | ITEM |
|----------|------|---|
| 1 | EACH | FULL-ACTUATED CONTROLLER AND TYPE V CABINET |
| 1 | EACH | TRANSCEIVER - FIBER OPTIC |
| 20 | EACH | INDUCTIVE LOOP DETECTOR |
| 1 | EACH | REMOVE EXISTING TRAFFIC SIGNAL EQUIPMENT |
| 894.0 | FOOT | ELECTRIC CABLE IN CONDUIT, GROUND NO. 6 1/C (GREEN) |



STA 187+55
END IMPROVEMENT

TRAFFIC SIGNAL NOTES:

- 1.) INSTALL 1449.0 FEET OF FIBER OPTIC CABLE THROUGH EXISTING CONDUIT TO PROPOSED CONTROLLER CABINET AT VETERANS AND PALOMINO. EXISTING INTERCONNECT CABLE MAY REMAIN IN PLACE UNLESS CONTRACTOR CHOOSES TO REMOVE TO AID IN THE INSTALLATION OF FIBER OPTIC CABLE. NO ADDITIONAL COMPENSATION SHALL BE ALLOWED FOR REMOVAL OF THIS CABLE. (QUANTITY INCLUDED ON VETERANS & BRUNS SHEET)
- 2.) INSTALL PROPOSED TYPE V CABINET ON EXISTING TYPE D FOUNDATION. PROPOSED CABINET MAY NEED TO BE MODIFIED TO FIT EXISTING BOLT PATTERN. CONTRACTOR SHALL FIELD VERIFY EXISTING CABINET FOUNDATION BOLT SPACING. NOT ALL DETECTOR LOOP CABLES SHALL BE REINSTALLED TO PROPOSED CABINET. SEE WIRING DIAGRAMS FOR DETAILS. EXISTING MASTER CONTROLLER SHALL BE RELOCATED TO PROPOSED CABINET AS PART OF CONTROLLER AND CABINET PAY ITEM.
- 3.) TRAFFIC SIGNALS SHALL NOT REMAIN WITHOUT POWER OVERNIGHT

GROUND WIRE QUANTITIES

| FROM | QNTY |
|---------------|--------------|
| NW M. A. | 67.5 |
| W MEDIAN POST | 163.5 |
| SW M. A. | 125.5 |
| SE M. A. | 189.5 |
| E MEDIAN POST | 167.5 |
| NE M. A. | 159.5 |
| DOUBLE H. H. | 21.0 |
| TOTAL: | 894.0 |



| REVISIONS | |
|-----------|------|
| NAME | DATE |
| | |
| | |
| | |
| | |
| | |
| | |
| | |
| | |
| | |
| | |

ILLINOIS DEPARTMENT OF TRANSPORTATION

TRAFFIC SIGNAL DETAILS
IL 4 @ PALOMINO RD

SCALE: VERT.
HORIZ.
DATE: FEB '07

DRAWN BY
CHECKED BY

| F.A.P. RTE. | SECTION | COUNTY | TOTAL SHEETS | SHEET NO. |
|---------------------|---------|---------------------------|--------------|-----------|
| 662 | 1(1-2) | SANGAMON | 7 | 5 |
| STA. | | TO STA. | | |
| FED. ROAD DIST. NO. | | ILLINOIS FED. AID PROJECT | | |

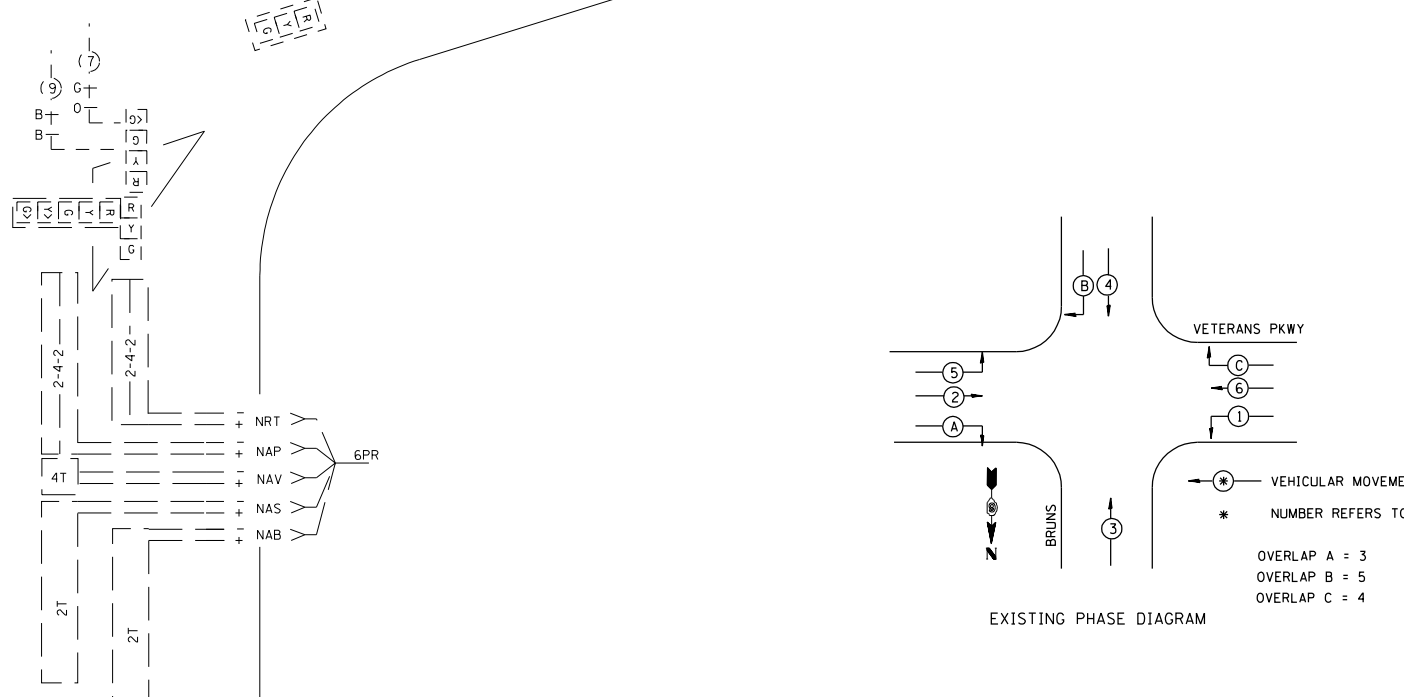
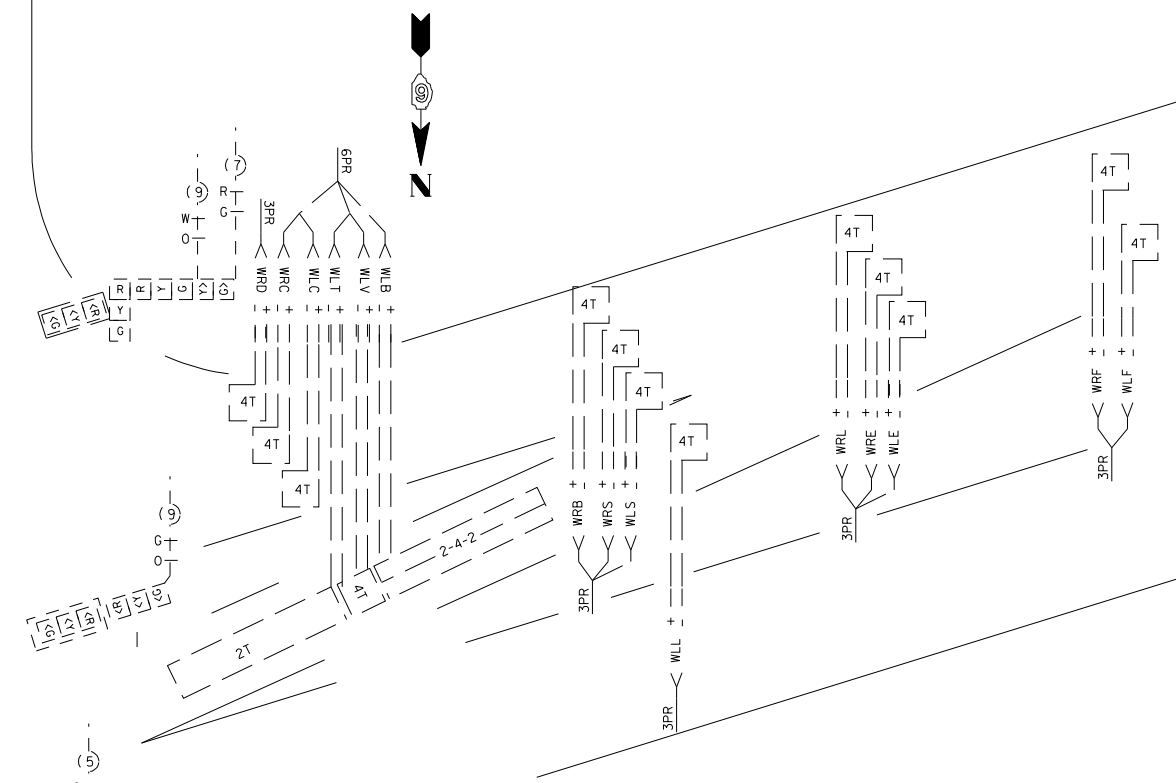
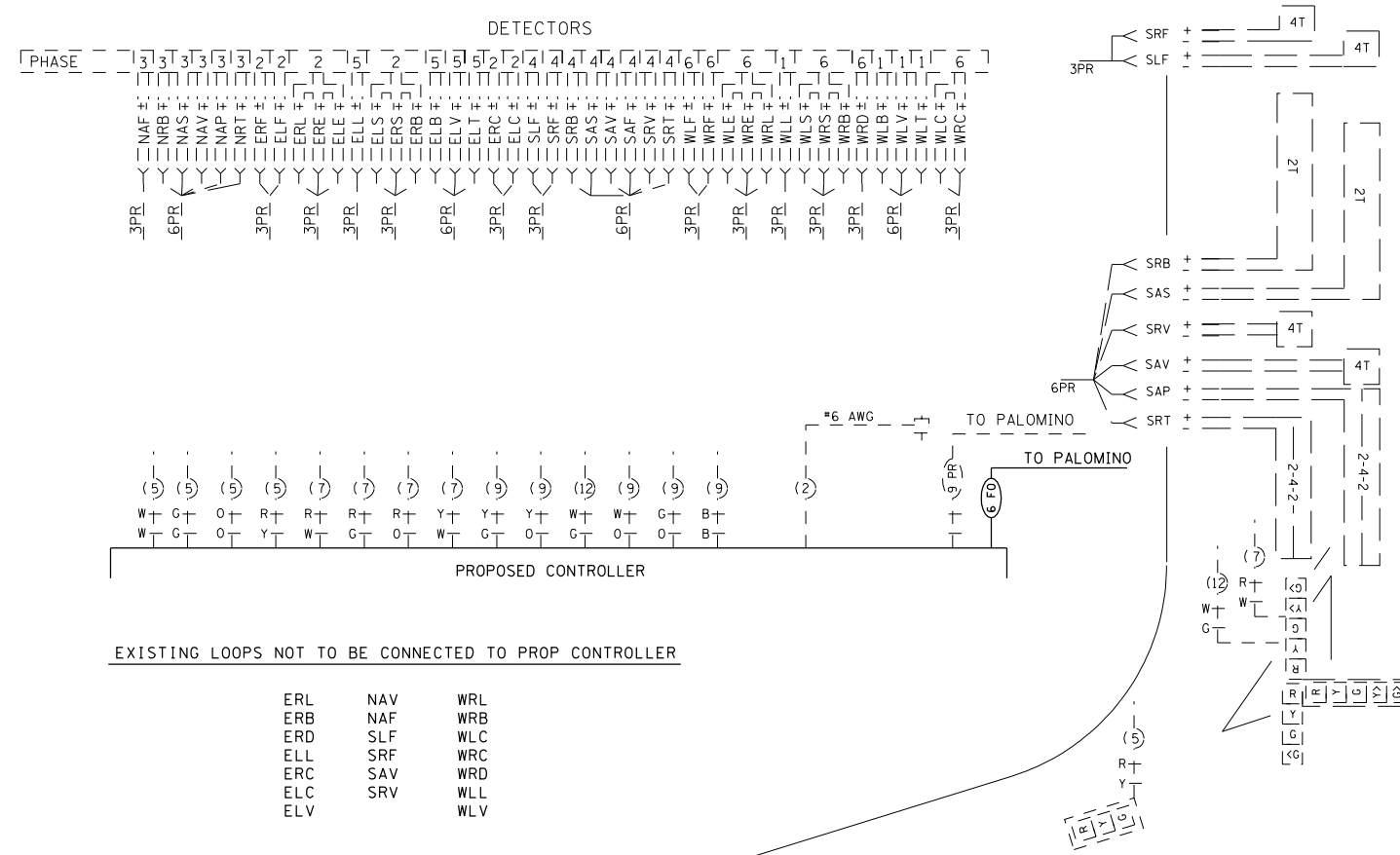

REMOVE EXISTING TRAFFIC SIGNAL EQUIPMENT CONSISTS OF:

- 1 EACH TYPE IV CABINET AND DETECTOR AMPS

ALL REMOVAL ITEMS SHALL BE DELIVERED TO CITY OF SPRINGFIELD TRAFFIC SIGNAL SHOP

| REVISIONS | |
|-----------|------|
| NAME | DATE |
| | |
| | |
| | |
| | |
| | |
| | |
| | |
| | |
| | |
| | |

ILLINOIS DEPARTMENT OF TRANSPORTATION
PROPOSED WIRING DIAGRAM
IL 4 @ BRUNS LANE
 SCALE: VERT. HORIZ.
 DATE: FEB '07
 DRAWN BY: _____
 CHECKED BY: _____

PLOT DATE = #DATES
 FILE NAME = #FILE#
 PLOT SCALE = #SCALE#
 REFERENCE = #REF#

| F.A.P. RTE. | SECTION | COUNTY | TOTAL SHEETS | SHEET NO. |
|---------------------|---------|---------------------------|--------------|-----------|
| 662 | 1(I)-2) | SANGAMON | 7 | 6 |
| STA. | | TO STA. | | |
| FED. ROAD DIST. NO. | | ILLINOIS FED. AID PROJECT | | |

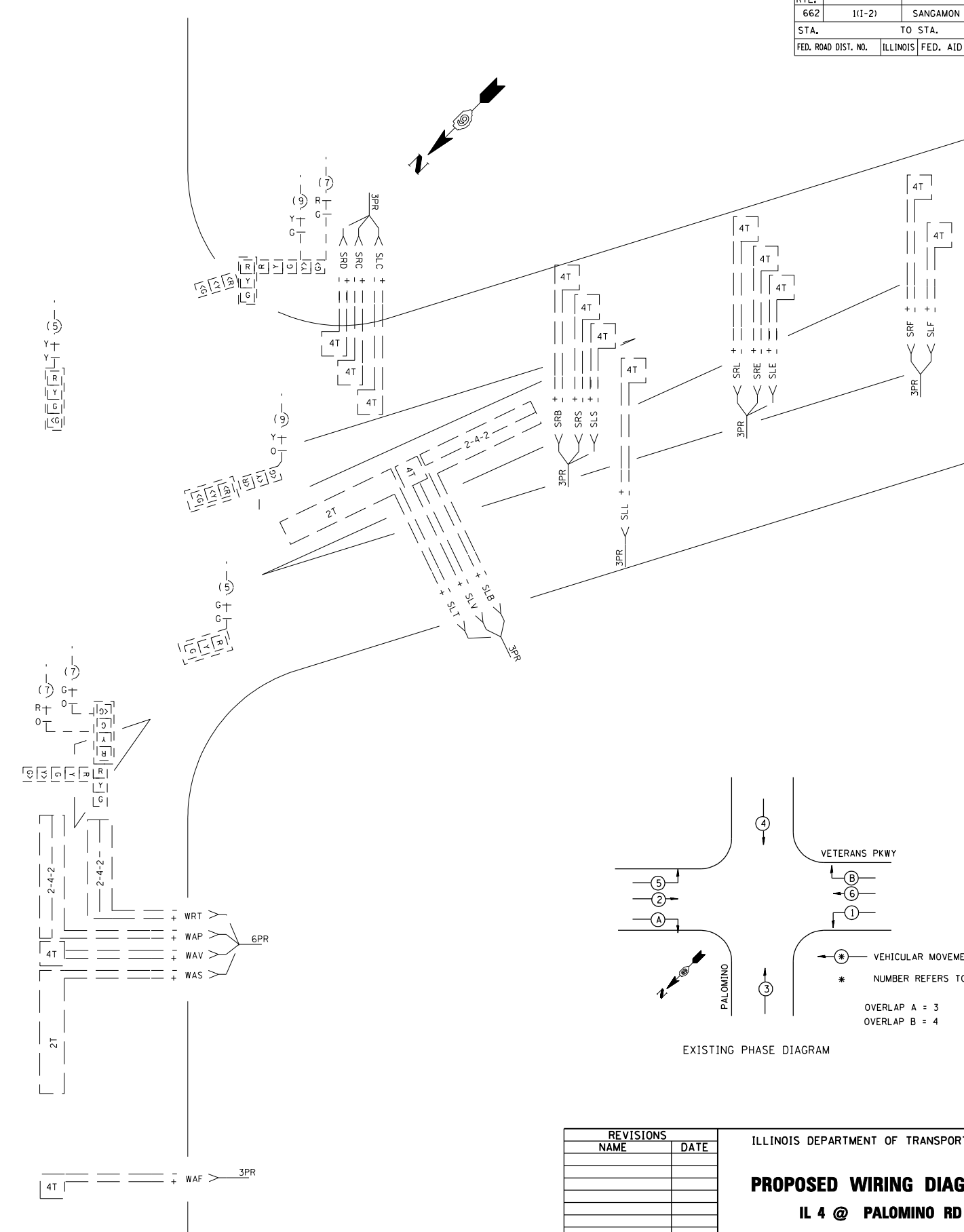
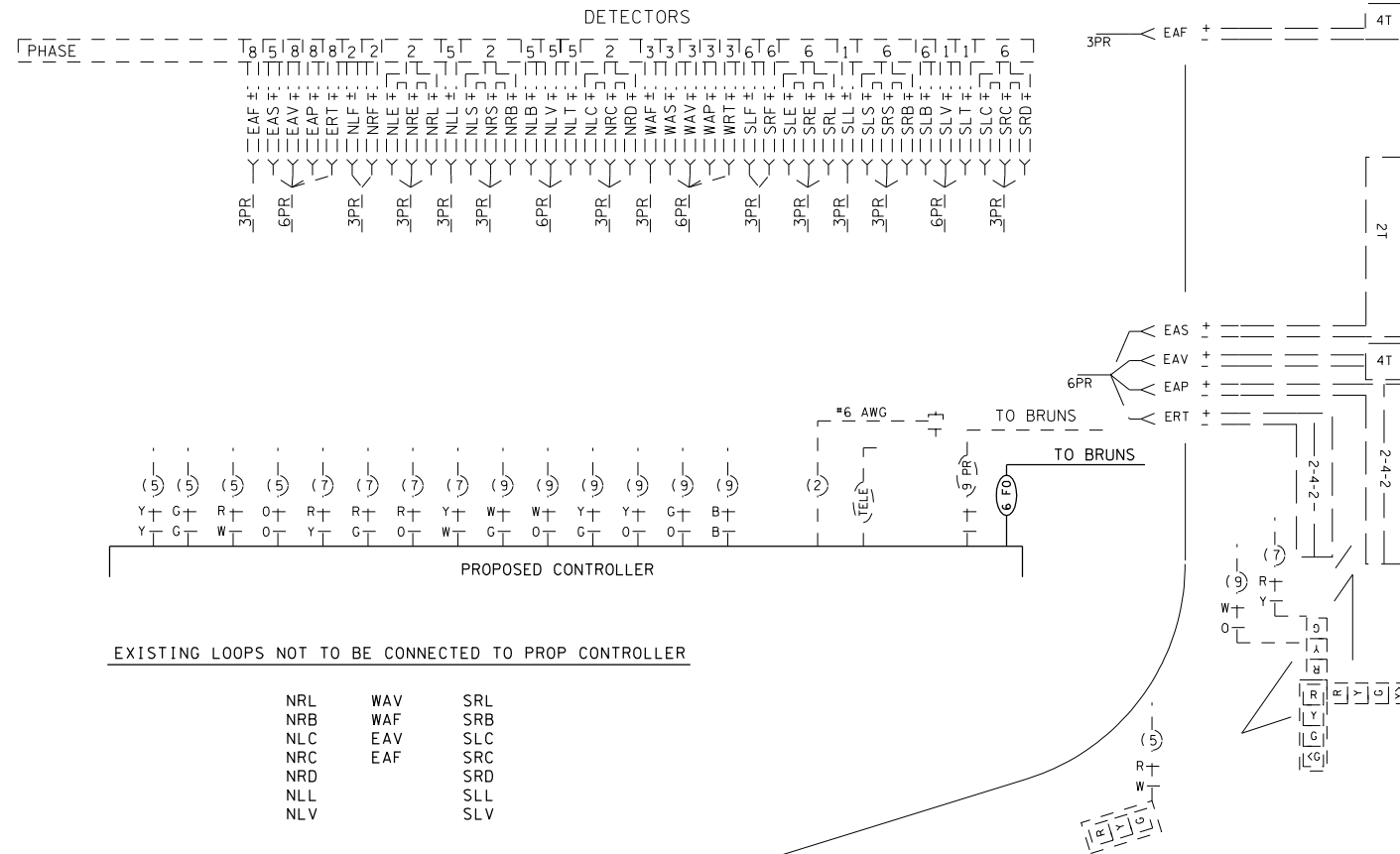

REMOVE EXISTING TRAFFIC SIGNAL EQUIPMENT CONSISTS OF:

- 1 EACH TYPE V CABINET AND DETECTOR AMPS

ALL REMOVAL ITEMS SHALL BE DELIVERED TO CITY OF SPRINGFIELD TRAFFIC SIGNAL SHOP

| REVISIONS | |
|-----------|------|
| NAME | DATE |
| | |
| | |
| | |
| | |
| | |
| | |
| | |
| | |
| | |
| | |

ILLINOIS DEPARTMENT OF TRANSPORTATION

PROPOSED WIRING DIAGRAM IL 4 @ PALOMINO RD

SCALE: VERT. FEB '07
 HORIZ. DATE: FEB '07
 DRAWN BY: KDA
 CHECKED BY:

PLOT DATE = #DATE#
 FILE NAME = #FILE#
 PLOT SCALE = #SCALE#
 REFERENCE = #REF#

| F.A.P. RTE. | SECTION | COUNTY | TOTAL SHEETS | SHEET NO. |
|---------------------|----------|------------------|--------------|-----------|
| 662 | 1(1-2) | SANGAMON | 7 | 7 |
| STA. | | TO STA. | | |
| FED. ROAD DIST. NO. | ILLINOIS | FED. AID PROJECT | | |

TRAFFIC SIGNAL PLAN LEGEND

| EXISTING | PROPOSED | DESCRIPTION |
|----------|----------|--|
| | | SIGNAL HEAD |
| | | SIGNAL HEAD WITH BACKPLATE |
| | | TEMPORARY SIGNAL HEAD |
| | | PEDESTRIAN SIGNAL HEAD |
| | | PEDESTRIAN PUSHBUTTON DETECTOR |
| | | DETECTOR LOOP |
| | | QUADRAPOLE DETECTOR LOOP |
| | | SIGNAL POST |
| | | ALUMINUM MAST ARM ASSEMBLY AND POLE |
| | | STEEL MAST ARM ASSEMBLY AND POLE |
| | | WOOD POLE |
| | | WOOD POLE WITH GUY |
| | | SERVICE INSTALLATION |
| | | CONTROLLER |
| | | HANDHOLE |
| | | HEAVY DUTY HANDHOLE |
| | | DOUBLE HANDHOLE |
| | | JUNCTION BOX |
| | | GULFBOX JUNCTION |
| | | AERIAL CABLE |
| | | CONDUIT LENGTH - CONSTRUCTION (T=TRENCH P=PUSHED A=AUGERED E=EXISTING) SIZE - TYPE (S=STEEL P=PVC F=FIBER DUCT U=UNI-DUCT) |
| | | CONDUIT SPLICE |
| | | SPAN WIRE / TETHER WIRE |
| | | 21 SIDEWALK REMOVAL IN SO M (SO FT) |
| | | 9 PC CONC SDWLK 100 mm IN SO M (SO YD) |
| | | 12 PC CONC SDWLK 100 mm SPECIAL IN SO M (SO YD) |

TRAFFIC SIGNAL WIRING DIAGRAM LEGEND

| EXISTING | PROPOSED | DESCRIPTION |
|----------|----------|--|
| | | 200 mm (8") SIGNAL SECTION |
| | | 300 mm (12") SIGNAL SECTION |
| | | DIRECTIONAL SIGNAL SECTION |
| | | 225 mm (9") PEDESTRIAN SIGNAL FACE |
| | | 300 mm (12") PEDESTRIAN SIGNAL FACE |
| | | SIGNAL FACE WITH BACKPLATE |
| | | PROGRAMMED SIGNAL SECTION |
| | | SIGNAL SECTION WITH LOUVRE |
| | | DUAL-INDICATION SIGNAL SECTION |
| | | INDUCTION DETECTOR LOOP |
| | | QUADRAPOLE DETECTOR LOOP |
| | | DIRECT-CONNECTED LOOP LEAD-IN (TWISTED) |
| | | ELECTRIC CABLE DENOTING NUMBER OF CONDUCTORS |
| | | ELECTRIC CABLE TO BE REMOVED |
| | | ELECTRIC CABLE IDENTIFIER TAPE CODES (R= RED W= WHITE Y= YELLOW G= GREEN B= BLUE O= ORANGE) |
| | | PEDESTRIAN PUSHBUTTON DETECTOR |
| | | VIDEO DETECTION CAMERA |
| | | EMERGENCY VEHICLE PREEMPTOR |

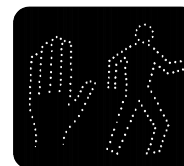

| REVISIONS | |
|-----------|------|
| NAME | DATE |
| | |
| | |
| | |
| | |
| | |
| | |
| | |
| | |
| | |
| | |

ILLINOIS DEPARTMENT OF TRANSPORTATION
LEGEND FOR TRAFFIC SIGNAL DETAILS

SCALE: VERT.
HORIZ.
DATE: DECEMBER 3, 1999

DRAWN BY
CHECKED BY WCD

DETLOOP