

F.A.P. RTE.	SECTION	COUNTY	TOTAL SHEETS	SHEET NO.
320		LOGAN	111	48
STA.		TO STA.		
FED. ROAD DIST. NO.		ILLINOIS FED. AID PROJECT		

• 103 & 22(I,N,T,S)

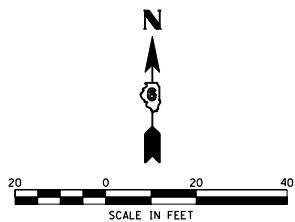

- (I01) 137+27.56, 39.00' LT
2.0' R CURB FACE
- (I02) 137+41.74, 52.47' LT
2.0' R CURB FACE
- (I03) 137+40.95, 40.00' LT
3.0' R CURB FACE
- (SW1) 137+33.76, 47.65' LT
CURB/CROSSWALK FACE
- (SW2) 137+37.39, 51.10' LT
CURB/CROSSWALK FACE
- (SW3) 137+38.33, 50.11' LT
PI CROSSWALK FACE
- (SW4) 137+43.78, 50.11' LT
CURB/CROSSWALK FACE
- (SW5) 137+43.86, 45.11' LT
CURB/CROSSWALK FACE
- (SW6) 137+35.97, 44.61' LT
PI CROSSWALK FACE
- (SR1) 137+12.65, 69.88' LT
PR SIDEWALK RAMP
- (SR2) 137+15.98, 73.64' LT
PR SIDEWALK RAMP

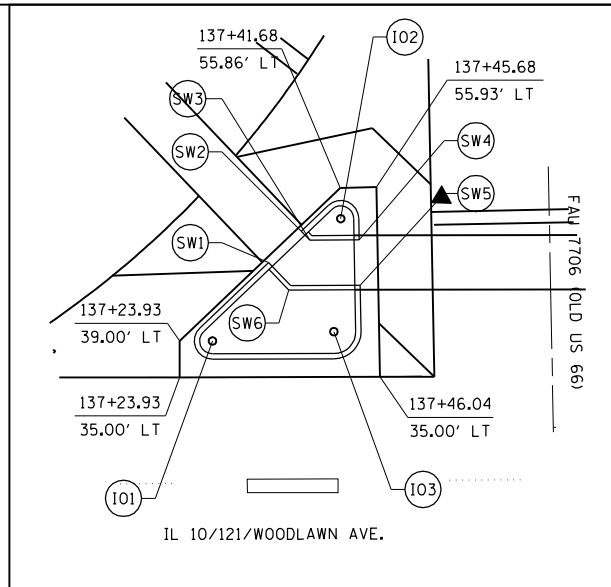

ISLAND DETAIL A-A

STA. 137+65.64 (IL 10/121/WOODLAWN RD) =
STA. 1762+29.39 (OLD US 66/LINCOLN PARKWAY)

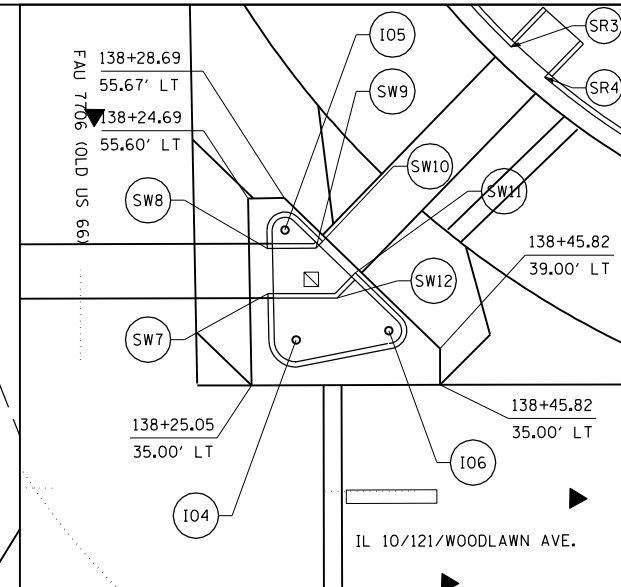

ISLAND DETAIL B-B

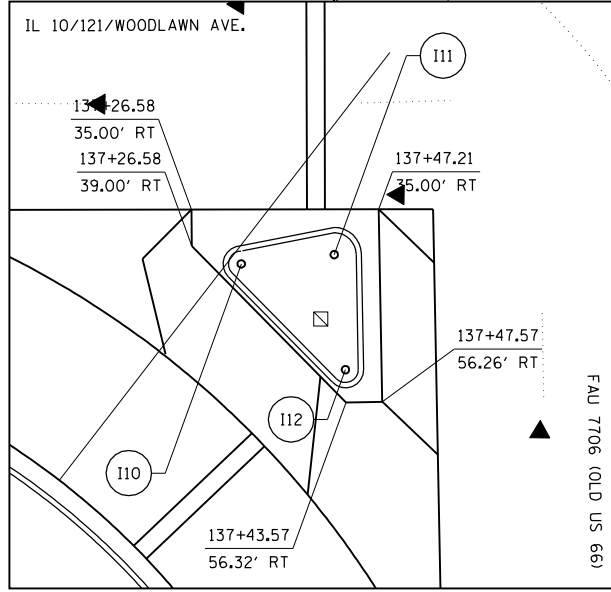
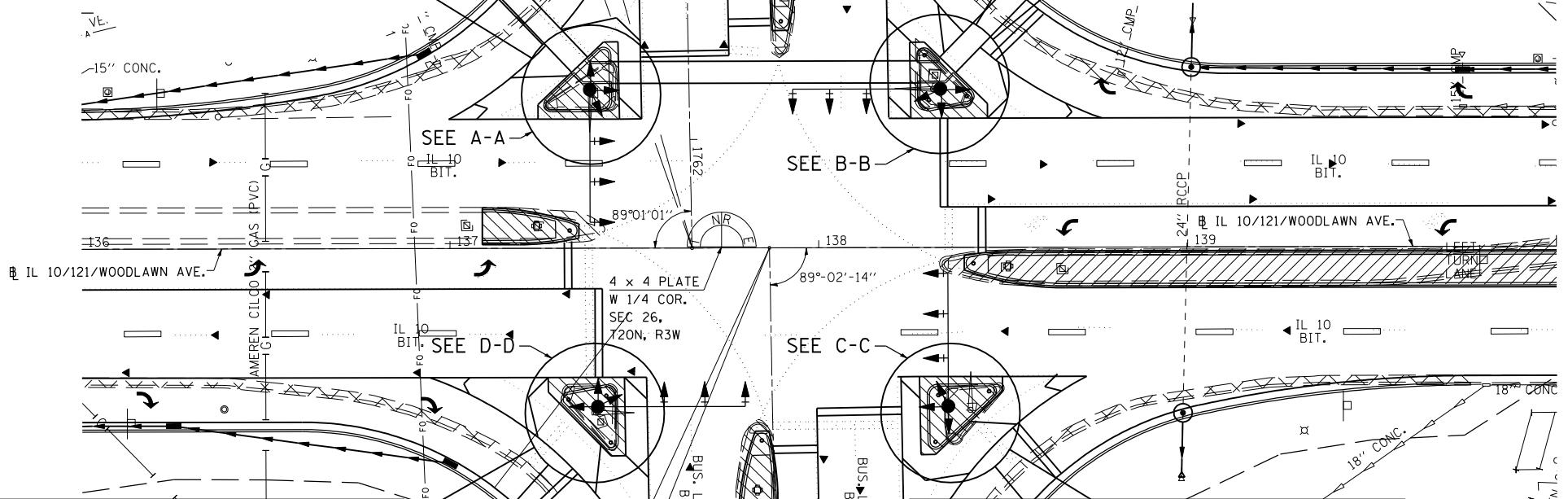

ISLAND DETAIL D-D

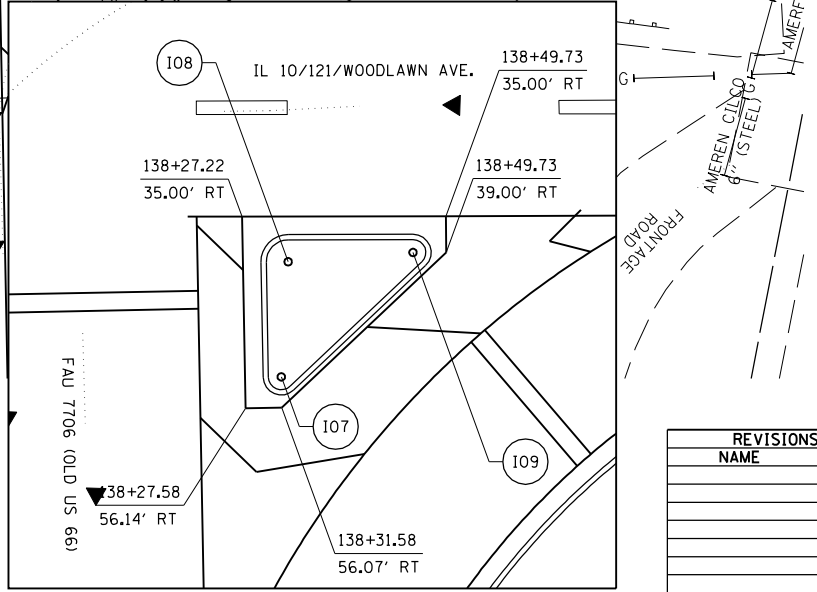

ISLAND DETAIL C-C

STA. 137+86.63 (IL 10/121/WOODLAWN RD) =
STA. 0+00.56 (OLD US 66/LINCOLN PARKWAY)

- (I04) 138+29.96, 40.00' LT
3.0' R CURB FACE
- (I05) 138+28.76, 52.12' LT
2.0' R CURB FACE
- (I06) 138+40.18, 41.00' LT
2.0' R CURB FACE
- (SW7) 138+26.88, 45.11' LT
CURB/CROSSWALK FACE
- (SW8) 138+26.76, 50.11' LT
CURB/CROSSWALK FACE
- (SW9) 138+32.17, 50.11' LT
PI CROSSWALK FACE
- (SW10) 138+32.91, 50.87' LT
CURB/CROSSWALK FACE
- (SW11) 138+36.49, 47.38' LT
CURB/CROSSWALK FACE
- (SW12) 138+34.49, 44.61' LT
PI CROSSWALK FACE
- (SR3) 138+53.75, 72.28' LT
PR SIDEWALK RAMP
- (SR4) 138+57.46, 68.92' LT
PR SIDEWALK RAMP

- (I07) 138+31.52, 52.70' RT
4.0' R CURB FACE
- (I08) 138+32.31, 40.00' RT
6.0' R CURB FACE
- (I09) 138+46.08, 39.00' RT
4.0' R CURB FACE

REVISIONS	
NAME	DATE

ILLINOIS DEPARTMENT OF TRANSPORTATION
ISLAND DETAILS
 IL 10/121/WOODLAWN RD.
 SECTION 103 & 22(I,N,T,S)
 LOGAN COUNTY
 LINCOLN, IL

SCALE: VERT. _____
 HORIZ. _____
 DATE: 07-25-05

DRAWN BY: TMJ
 CHECKED BY: VTY

PLOT DATE = 3/20/2007
 FILE NAME = c:\projects\65338A\shdet0118.mxd
 PLOT SCALE = 42.3525' / IN.
 USER NAME = laughlin-1