

F.A.P. RTE.	SECTION	COUNTY	TOTAL SHEETS	SHEET NO.
320	(103, 221), N.T.S.	LOGAN	111	46
STA.		TO STA.		
FED. ROAD DIST. NO.		ILLINOIS FED. AID PROJECT		

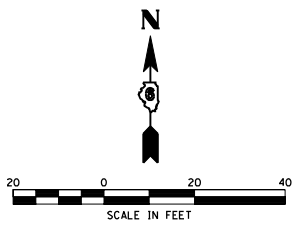

- NW1 135+92.94, 35.00' LT (400' R) ELEV.= 581.12
- NW2 136+12.93, 35.50' LT ELEV.= 581.26
- NW3 136+32.88, 37.00' LT ELEV.= 581.39
- NW4 136+52.72, 39.49' LT ELEV.= 581.49
- NW5 136+64.49, 41.45' LT (400' - 90' R) ELEV.= 581.55
- NW6 136+83.65, 47.19' LT ELEV.= 581.61
- NW7 137+01.07, 57.02' LT ELEV.= 581.72
- NW8 1761+58.09, 48.54' RT ELEV.= 581.82
- NW9 1761+41.91, 36.78' RT ELEV.= 582.02
- NW10 1761+23.54, 28.88' RT ELEV.= 582.42
- NW11 1761+03.87, 25.23' RT ELEV.= 582.82
- NW12 1760+97.40, 25.00' RT (90' R) ELEV.= 582.89
- SW1 136+59.83, 47.00' RT (85' R) ELEV.= 581.39
- SW2 136+79.69, 49.35' RT ELEV.= 581.51
- SW3 136+98.45, 56.28' RT ELEV.= 518.55
- SW4 137+15.08, 67.40' RT ELEV.= 581.50
- SW5 0+81.67, 59.36' RT ELEV.= 581.45
- SW6 1+00.00, 49.90' RT ELEV.= 581.40
- SW14 136+25.00, 35.00' RT ELEV.= 581.34
- SW15 136+50.00, 35.00' RT ELEV.= 581.54

- NW13 136+00.00, 35.00' LT ELEV.= 581.17
- NW14 136+25.00, 35.00' LT ELEV.= 581.37
- NW15 136+50.00, 35.00' LT ELEV.= 581.56
- NW16 136+75.00, 35.00' LT ELEV.= 581.76
- NW17 137+00.00, 35.00' LT ELEV.= 582.01
- NW18 137+25.00, 35.00' LT ELEV.= 582.26
- NW19 1761+94.16, 13.00' RT ELEV.= 582.54
- NW20 1761+75.00, 13.00' RT ELEV.= 582.65
- NW21 1761+50.00, 13.00' RT ELEV.= 582.79
- SW16 136+75.00, 35.00' RT ELEV.= 581.76
- SW17 137+00.00, 35.00' RT ELEV.= 581.99
- SW18 137+25.00, 35.00' RT ELEV.= 582.01
- SW19 0+34.99, 34.00' RT ELEV.= 582.03
- SW20 0+50.00, 34.00' RT ELEV.= 581.94

- NW22 1761+25.00, 13.00' RT ELEV.= 583.00
- NW23 1761+00.00, 13.00' RT ELEV.= 583.12
- SW14 136+25.00, 35.00' RT ELEV.= 581.34
- SW15 136+50.00, 35.00' RT ELEV.= 581.54
- SW16 136+75.00, 35.00' RT ELEV.= 581.76
- SW17 137+00.00, 35.00' RT ELEV.= 581.99
- SW18 137+25.00, 35.00' RT ELEV.= 582.01
- SW19 0+34.99, 34.00' RT ELEV.= 582.03
- SW20 0+50.00, 34.00' RT ELEV.= 581.94
- SW21 0+75.00, 34.00' RT ELEV.= 581.80
- SW22 1+00.00, 34.00' RT ELEV.= 581.66

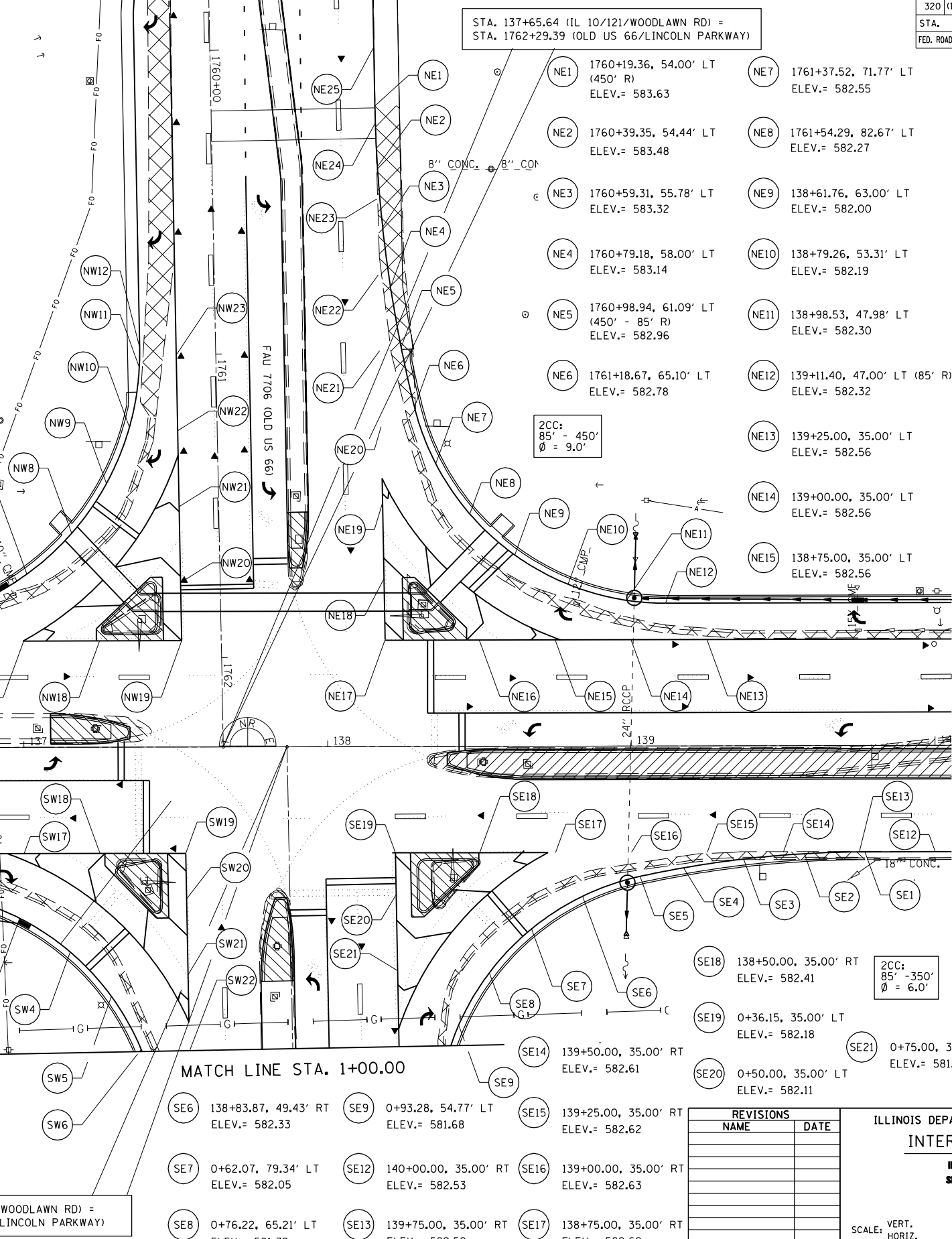

STA. 137+65.64 (IL 10/121/WOODLAWN RD) =
STA. 1762+29.39 (OLD US 66/LINCOLN PARKWAY)

2CC:
90° - 400'
Ø = 5.0'

2CC:
85° - 450'
Ø = 9.0'

2CC:
85° - 350'
Ø = 6.0'

2CC:
85° - 450'
Ø = 10.0'

STA. 137+86.63 (IL 10/121/WOODLAWN RD) =
STA. 0+00.56 (OLD US 66/LINCOLN PARKWAY)

MATCH LINE STA. 1+00.00

- SW14 136+25.00, 35.00' RT ELEV.= 581.34
- SW15 136+50.00, 35.00' RT ELEV.= 581.54

- SE6 138+83.87, 49.43' RT ELEV.= 582.33
- SE7 0+62.07, 79.34' LT ELEV.= 582.05
- SE8 0+76.22, 65.21' LT ELEV.= 581.79
- SE9 0+93.28, 54.77' LT ELEV.= 581.68
- SE10 140+00.00, 35.00' RT ELEV.= 582.53
- SE11 139+75.00, 35.00' RT ELEV.= 582.59
- SE12 139+25.00, 35.00' RT ELEV.= 582.62
- SE13 139+00.00, 35.00' RT ELEV.= 582.63
- SE14 139+50.00, 35.00' RT ELEV.= 582.61
- SE15 139+25.00, 35.00' RT ELEV.= 582.62
- SE16 139+00.00, 35.00' RT ELEV.= 582.63
- SE17 138+75.00, 35.00' RT ELEV.= 582.62
- SE18 138+50.00, 35.00' RT ELEV.= 582.41
- SE19 0+36.15, 35.00' LT ELEV.= 582.18
- SE20 0+50.00, 35.00' LT ELEV.= 582.11
- SE21 0+75.00, 35.00' LT ELEV.= 581.99
- SE22 139+02.78, 42.92' RT (350' - 85' R) ELEV.= 582.47

REVISIONS	
NAME	DATE

ILLINOIS DEPARTMENT OF TRANSPORTATION
INTERSECTION DETAIL
IL 10/121/WOODLAWN RD.
SECTION 103 & 22(N.T.S)
LOGAN COUNTY
LINCOLN, IL
SCALE: VERT. HORIZ.
DATE 09-20-2005
DRAWN BY TMJ
CHECKED BY VTY

PLOT DATE = 3/28/2007
FILE NAME = c:\projects\65338A\shumdetail.dgn
PLOT SCALE = 42.3524 / IN.
USER NAME = laughlin-1