

F.A.P. RTE.	SECTION	COUNTY	TOTAL SHEETS	SHEET NO.
320 (103, 22) I, N, TS		LOGAN	111	33
STA.		TO STA.		
FED. ROAD DIST. NO.	ILLINOIS	FED. AID PROJECT		

STA. 143+90.83 END
SEC. (103, 22) I, N, TS IMPROVEMENT
IL 10/121/WOODLAWN RD.

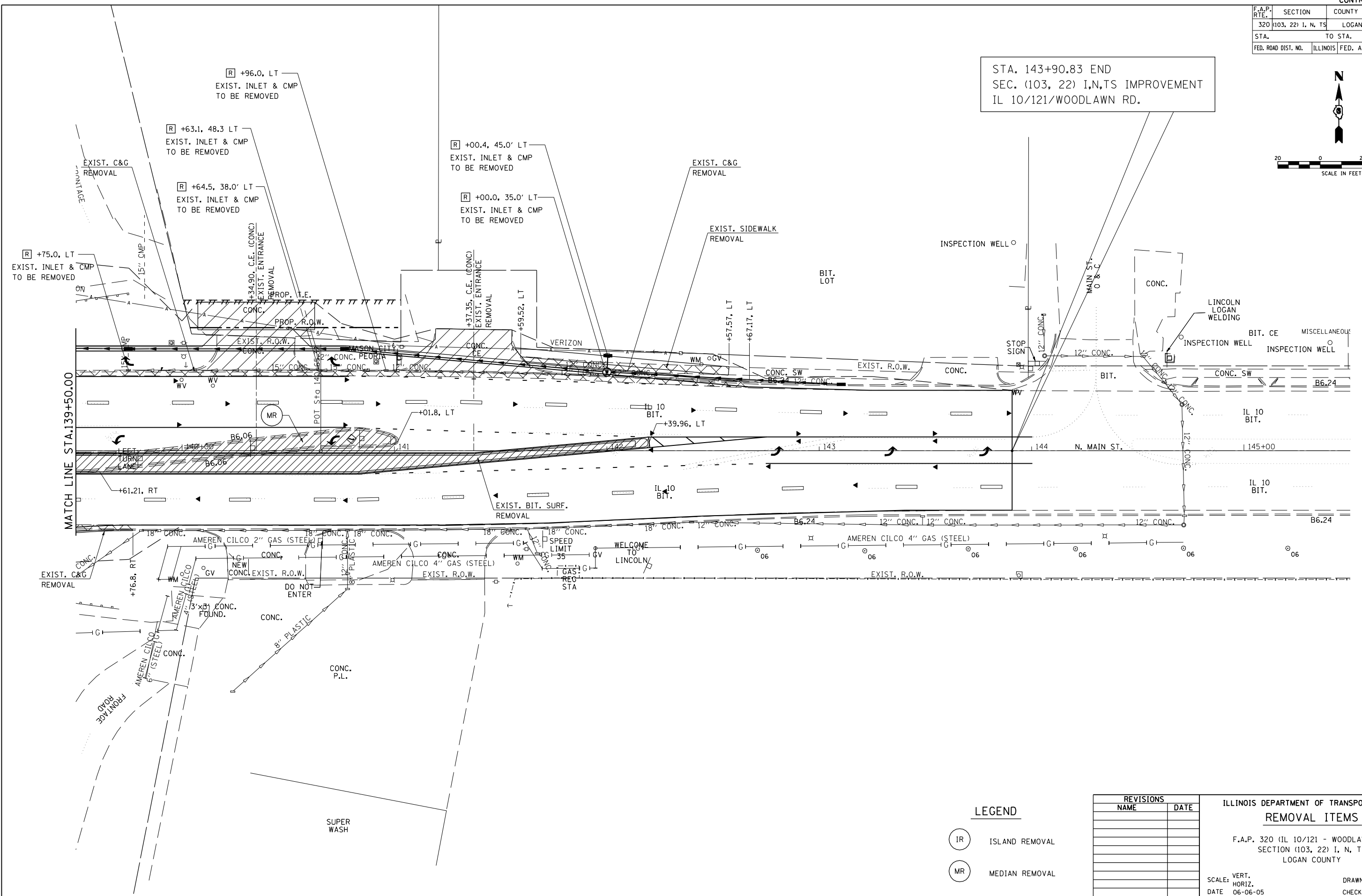
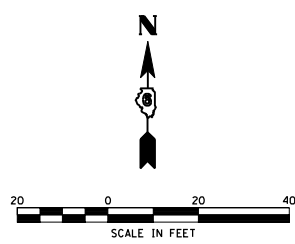

LEGEND

- (IR) ISLAND REMOVAL
- (MR) MEDIAN REMOVAL

REVISIONS	
NAME	DATE

ILLINOIS DEPARTMENT OF TRANSPORTATION
REMOVAL ITEMS
F.A.P. 320 (IL 10/121 - WOODLAWN RD.)
SECTION (103, 22) I, N, TS
LOGAN COUNTY
SCALE: VERT. 1"=20'
HORIZ. 1"=40'
DATE: 06-06-05
DRAWN BY: TMJ
CHECKED BY: VTY

PLOT DATE = 3/20/2007
FILE NAME = c:\projects\65338A\shop\plan\m\11118.dgn
PLOT SCALE = 42.3525' / IN.
REFERENCE = #REF#