

F.A.P. RTE.	SECTION	COUNTY	TOTAL SHEETS	SHEET NO.
320 (103, 22) I, N, TS		LOGAN	111	32
STA. TO STA.		FED. ROAD DIST. NO. ILLINOIS FED. AID PROJECT		

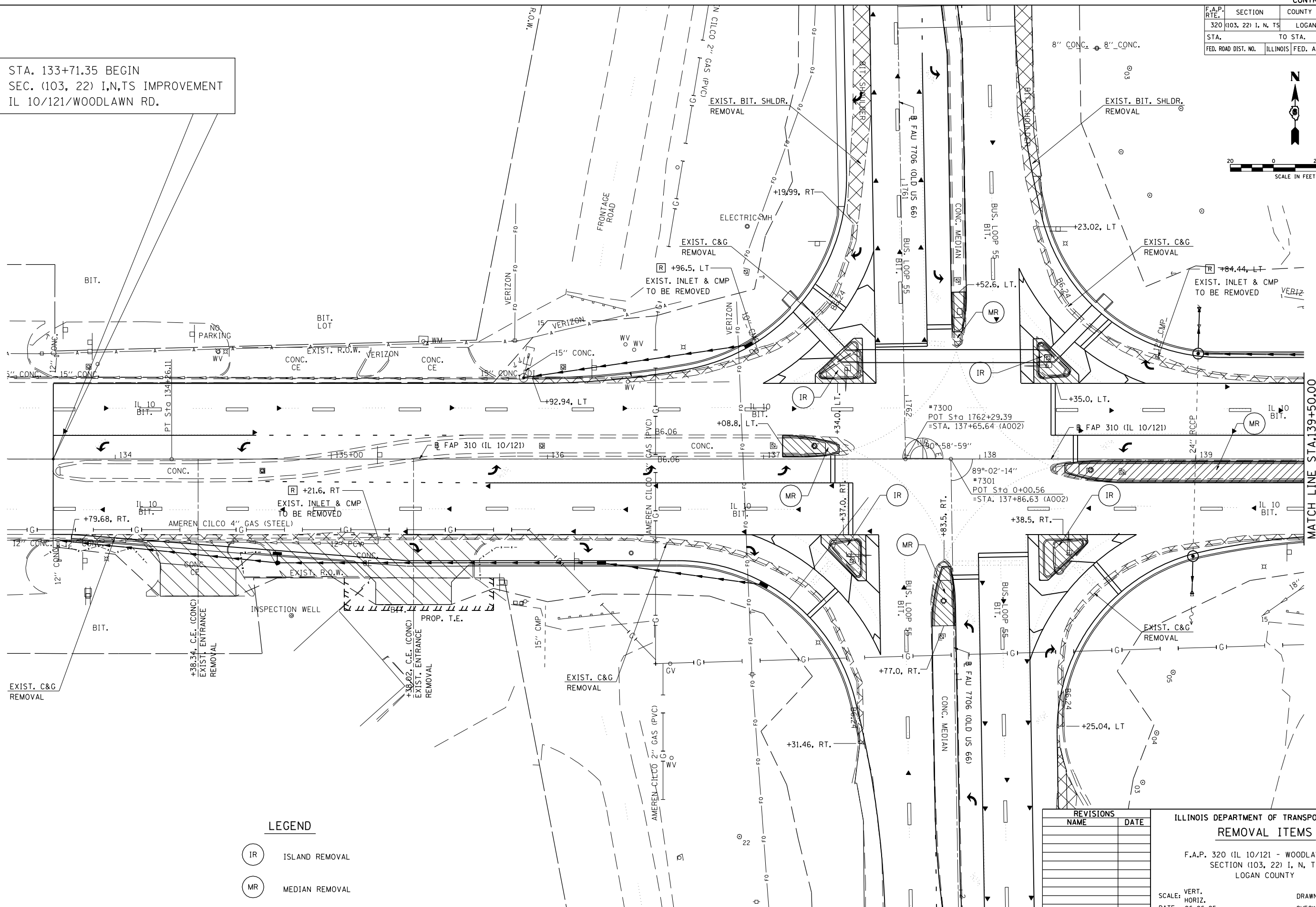

STA. 133+71.35 BEGIN  
SEC. (103, 22) I,N,TS IMPROVEMENT  
IL 10/121/WOODLAWN RD.



MATCH LINE STA. 139+50.00

**LEGEND**

(IR) ISLAND REMOVAL

(MR) MEDIAN REMOVAL

REVISIONS	
NAME	DATE

ILLINOIS DEPARTMENT OF TRANSPORTATION  
**REMOVAL ITEMS**

F.A.P. 320 (IL 10/121 - WOODLAWN RD.)  
SECTION (103, 22) I, N, TS  
LOGAN COUNTY

SCALE: VERT. HORIZ.  
DATE: 06-06-05

DRAWN BY: TMJ  
CHECKED BY: VTY

PLOT DATE = 3/28/2007  
FILE NAME = c:\projects\685338a\shop\plan\m11118.dgn  
PLOT SCALE = 42.3525' / IN.  
REFERENCE = #REF#