

T 19 N, R 11 W, SEC. 5, 2ND P.M.

CONTRACT NO. 70185				
F.A.P. RTE.	SECTION	COUNTY	TOTAL SHEETS	SHEET NO.
332	.	VERMILION	62	43
STA. 107+50		TO STA. 113+50		
FED. ROAD DIST. NO. ILLINOIS FED. AID PROJECT				
*(47Z-3)RS-1 & (52CS,48Z-1)RS-3				

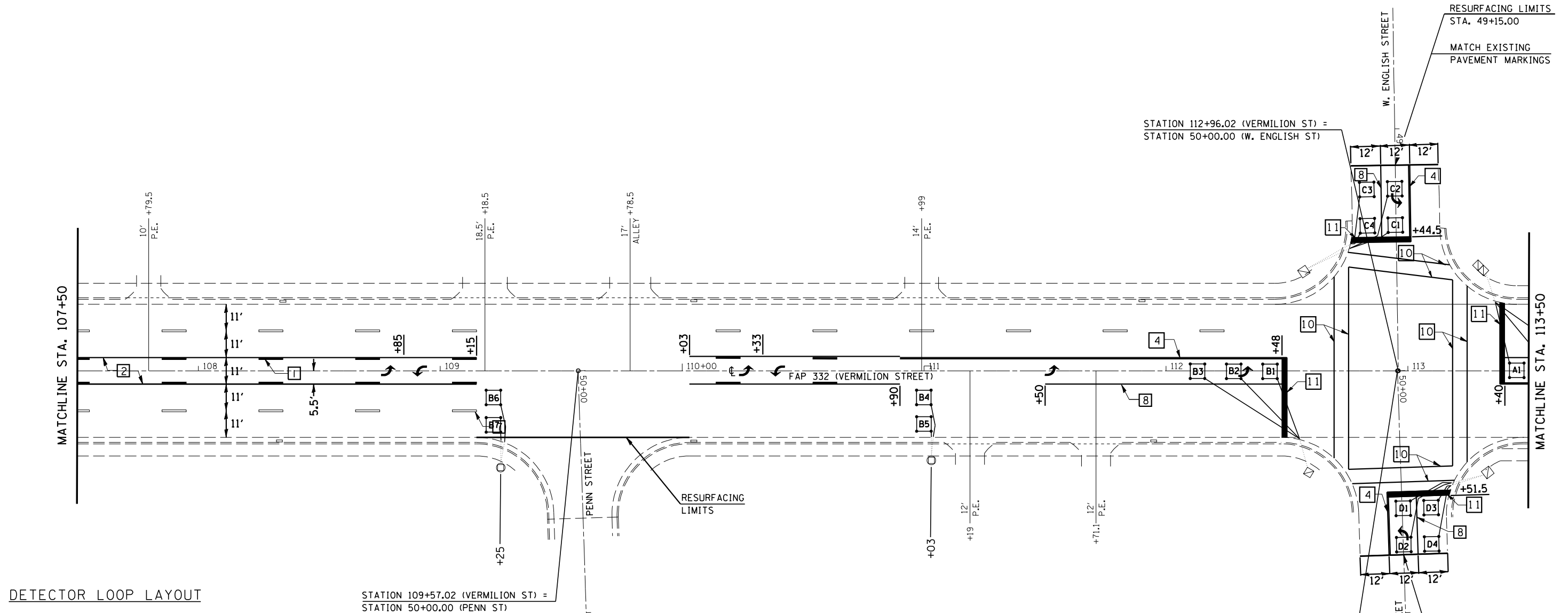

DETECTOR LOOP LAYOUT

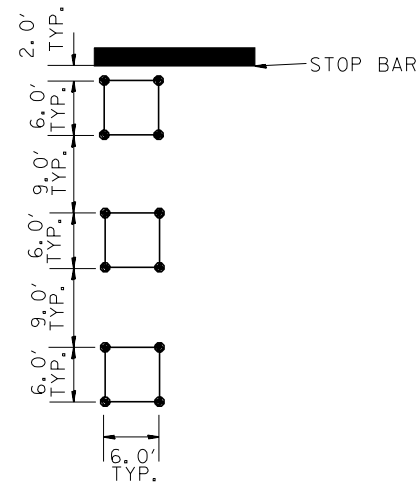

STATION 109+57.02 (VERMILION ST) =
STATION 50+00.00 (PENN ST)

STATION 112+95.70 (VERMILION ST) =
STATION 50+00.00 (E. ENGLISH ST)

DETAIL OF DETECTOR LOOP WIRING

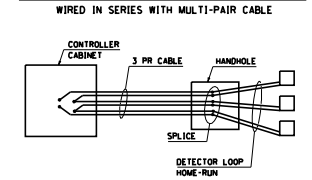

DETECTOR LOOP DATA
ENGLISH ST.

LOOP	SIZE	TURNS
A1-3	6' X 6'	3
A4-5	6' X 6'	4
A6-7	6' X 6'	5
B1-3	6' X 6'	4
B4-5	6' X 6'	5
B6-7	6' X 6'	6
C1-2	6' X 6'	3
C3-4	6' X 6'	3
D1-2	6' X 6'	3
D3-4	6' X 6'	3

REVISIONS	
NAME	DATE

ILLINOIS DEPARTMENT OF TRANSPORTATION

ROADWAY PLANS

SCALE: VERT. HORIZ.
DATE

DRAWN BY
CHECKED BY

PLOT DATE = 3/27/2007
FILE NAME = c:\projects\4593881\c81\vt\riping.dgn
PLOT SCALE = 42,352% / IN.
USER NAME = carrollr