

| F.A.I. RTE. | SECTION | COUNTY | TOTAL SHEETS | SHEET NO. |
|-------------|---------|---------|--------------|-----------|
| 39 | | LASALLE | 16 | 12 |

*50(1,2,3,4,5,6,7,8)PATCHING

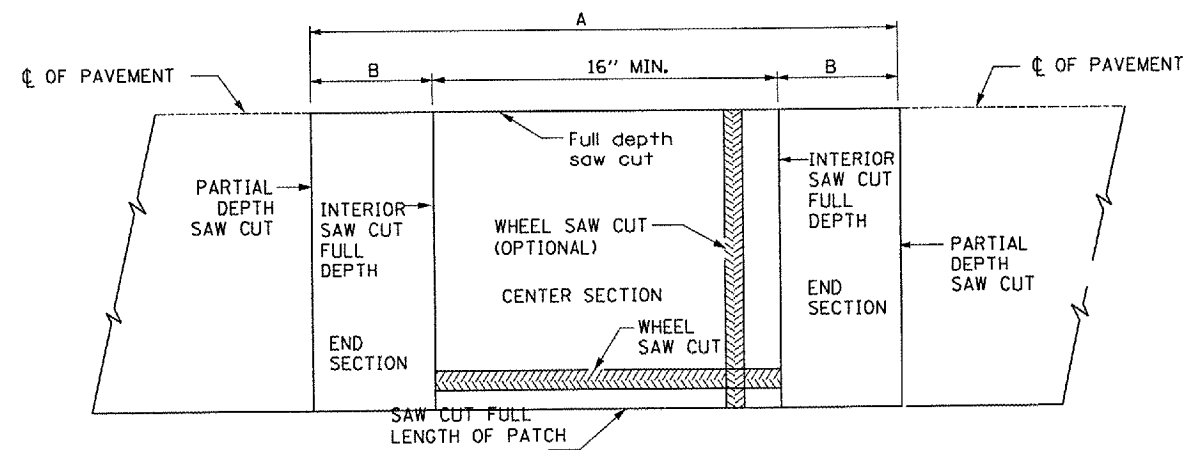

ALTERNATE SAWING DETAIL
(PCC SHOULDER)

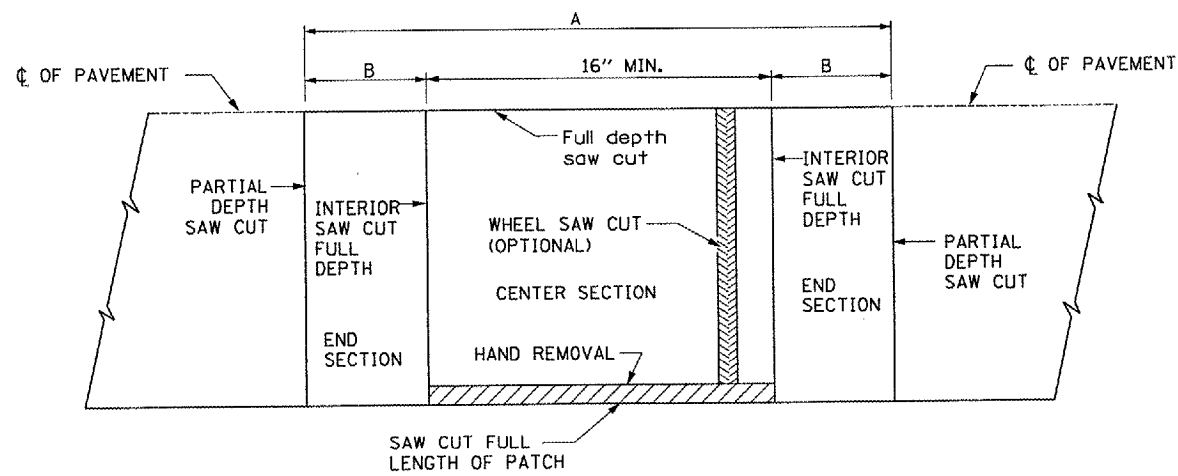

PAVEMENT SAWING DETAIL
(PCC SHOULDER)

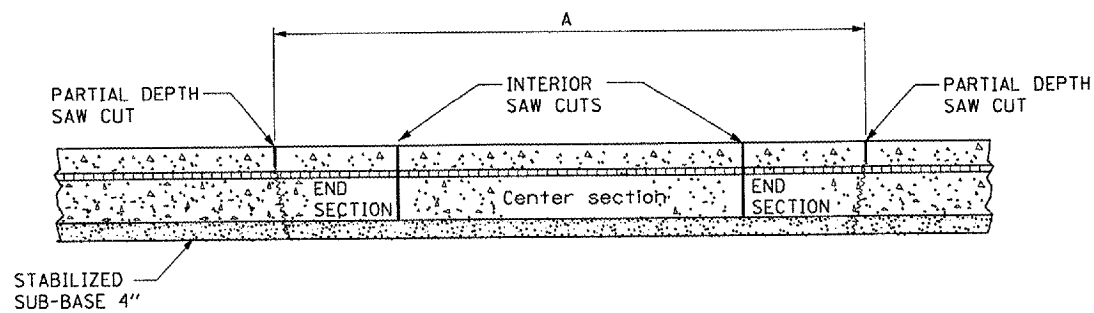

REMOVAL DETAIL

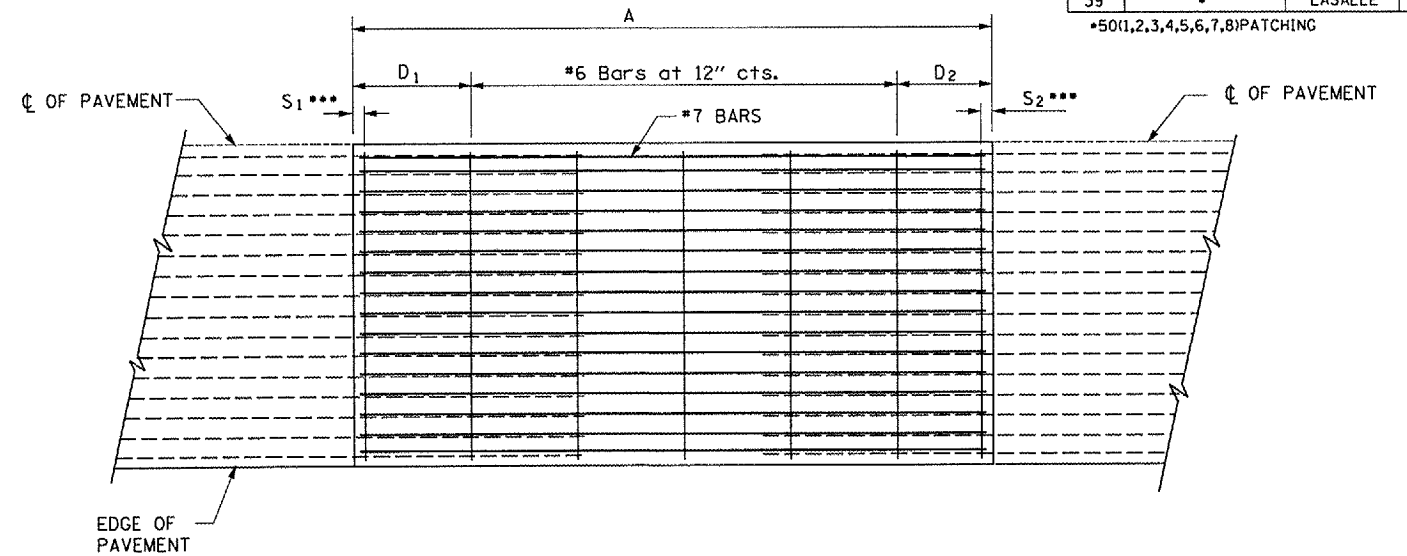

PROPOSED PAVEMENT DETAIL
(AGAINST CONCRETE SHOULDER)

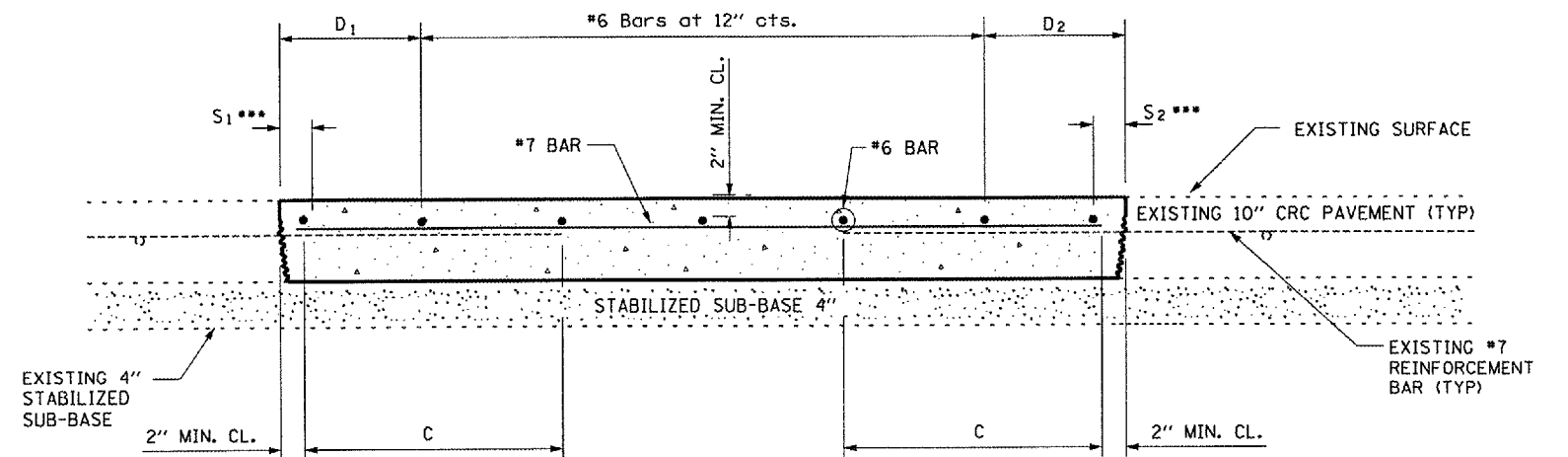

PROPOSED CLASS A PATCHING DETAIL

| EXISTING LONGITUDINAL REINFORCEMENT BARS | A (min.) | B (min.) | C (min.) |
|--|----------|----------|----------|
| No. 7 | 6'-0" | 24" | 22" |

NOTES:

- EVERY 3rd INTERSECTION MUST BE TIED
- LAP NEW REINFORCEMENT WITH EXISTING LONGITUDINAL REINFORCEMENT
- VARIABLES: WHERE S₁ AND S₂ ARE 2 1/2" MIN. AND 12" MAX. D₁ = 2(S₁) AND D₂ = 2(S₂)

| REVISIONS | |
|-----------|------|
| NAME | DATE |
| | |
| | |
| | |
| | |
| | |
| | |
| | |

ILLINOIS DEPARTMENT OF TRANSPORTATION
CLASS A PATCHING DETAILS
FAI ROUTE 39 (I-39)
SECTION 50(1,2,3,4,5,6,7,8)PATCHING
LASALLE COUNTY

Date: February 27, 2007
c:/projects/cmain08/cm304/detalls.dgn