

F.A.P. RTE.	SECTION	COUNTY	TOTAL SHEETS	SHEET NO.
505	110RS-1, 111RS-3	STEPHENSON	174	44
STA. 10520+00	TO STA. 10550+00			
FED. ROAD DIST. NO.	ILLINOIS	FED. AID PROJECT		
CONTRACT NO. 64C32				

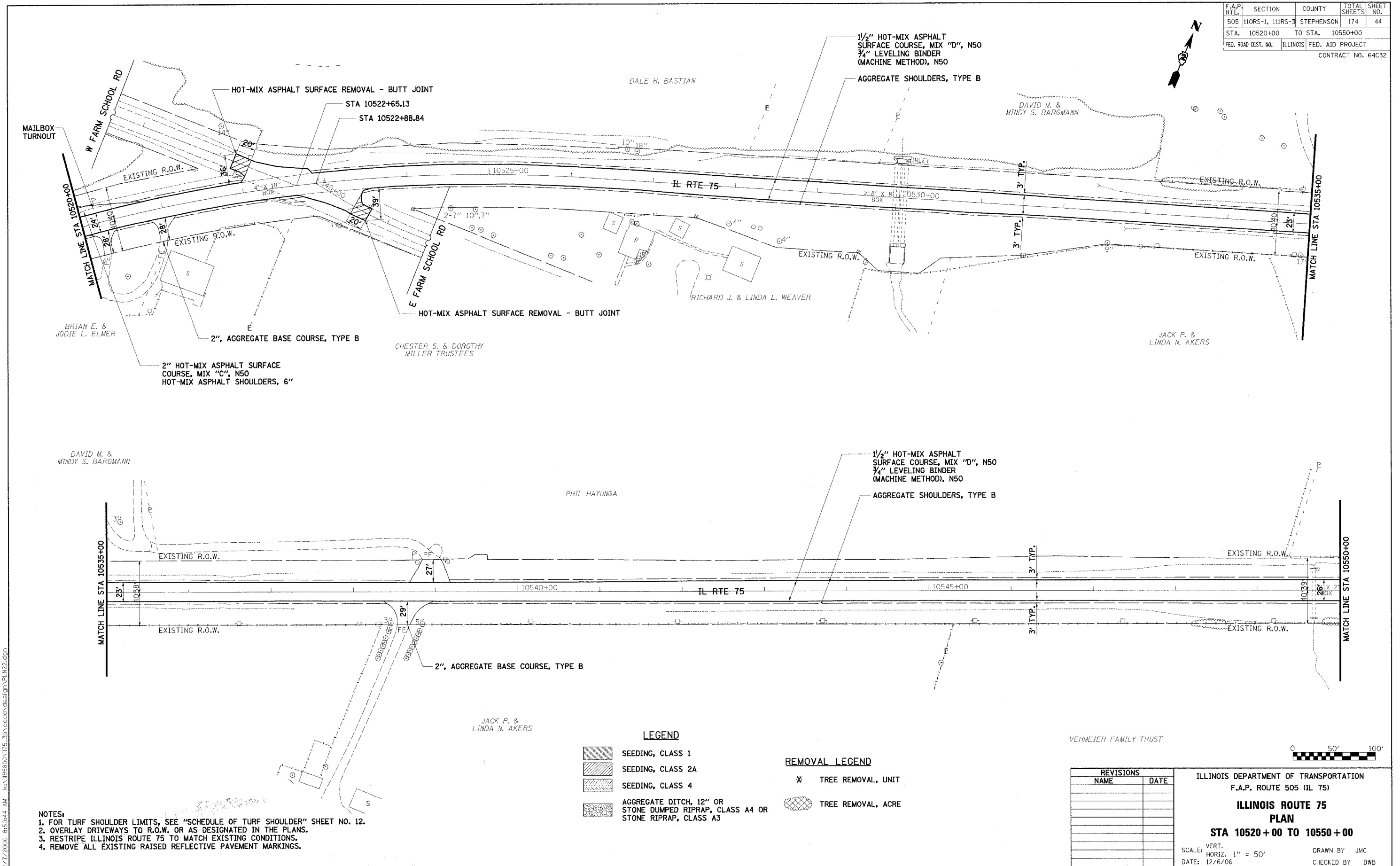

**LEGEND**

	SEEDING, CLASS 1		TREE REMOVAL, UNIT
	SEEDING, CLASS 2A		TREE REMOVAL, ACRE
	SEEDING, CLASS 4		
	AGGREGATE DITCH, 12" OR STONE DUMPED RIPRAP, CLASS A4 OR STONE RIPRAP, CLASS A3		

**REMOVAL LEGEND**

	TREE REMOVAL, UNIT
	TREE REMOVAL, ACRE

- NOTES:**
1. FOR TURF SHOULDER LIMITS, SEE "SCHEDULE OF TURF SHOULDER" SHEET NO. 12.
  2. OVERLAY DRIVEWAYS TO R.O.W. OR AS DESIGNATED IN THE PLANS.
  3. RESTRIPE ILLINOIS ROUTE 75 TO MATCH EXISTING CONDITIONS.
  4. REMOVE ALL EXISTING RAISED REFLECTIVE PAVEMENT MARKINGS.

REVISIONS	
NAME	DATE

ILLINOIS DEPARTMENT OF TRANSPORTATION  
 F.A.P. ROUTE 505 (IL 75)  
**ILLINOIS ROUTE 75**  
**PLAN**  
**STA 10520+00 TO 10550+00**

SCALE: VERT. 1" = 50'  
 DATE: 12/6/06

DRAWN BY JMC  
 CHECKED BY DWB

12/7/2006 8:50:44 AM K:\195800\IT5\_3p\caadd\des\gn\PLN22.dgn