

F.A.P. RTE.	SECTION	COUNTY	TOTAL SHEETS	SHEET NO.
505	110RS-1, 111RS-3	STEPHENSON	174	37
STA. 10370+00 TO STA. 10385+00				
FED. ROAD DIST. NO. ILLINOIS FED. AID PROJECT				
CONTRACT NO. 64C32				

PLAN	SURVEYED	DATE
	ALIGNED	
	ADJUSTED	
	NOTED	
	NOTED	
	NOTED	
	NOTED	
	NOTED	
	NOTED	
	NOTED	

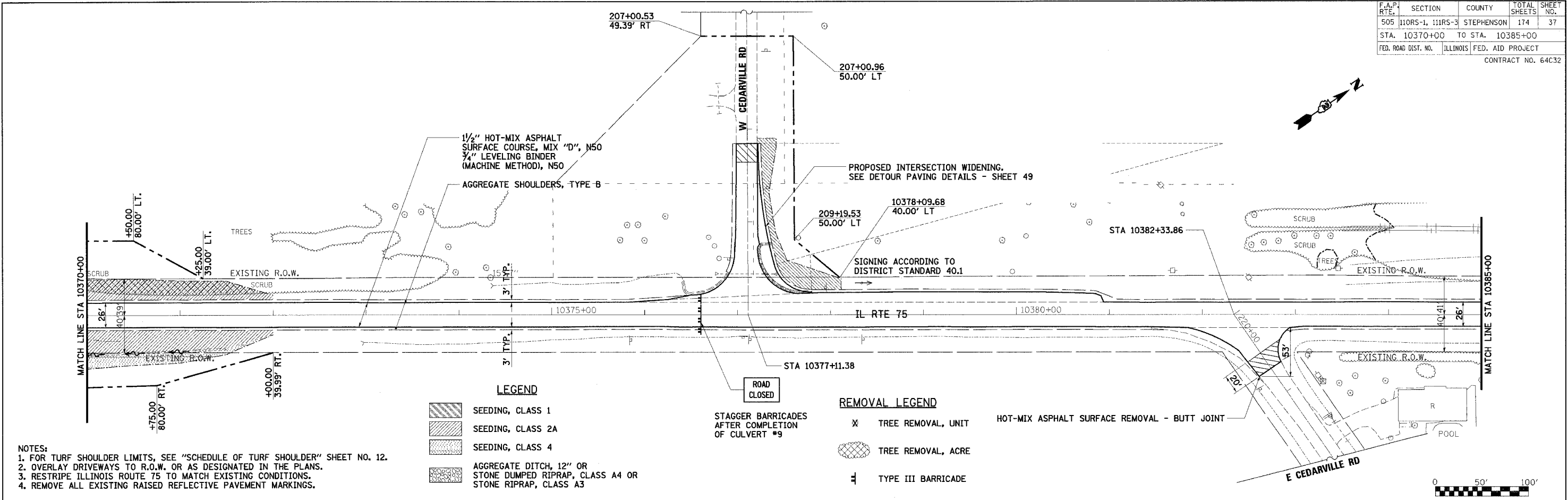

- NOTES:**
1. FOR TURF SHOULDER LIMITS, SEE "SCHEDULE OF TURF SHOULDER" SHEET NO. 12.
 2. OVERLAY DRIVEWAYS TO R.O.W. OR AS DESIGNATED IN THE PLANS.
 3. RESTRIPE ILLINOIS ROUTE 75 TO MATCH EXISTING CONDITIONS.
 4. REMOVE ALL EXISTING RAISED REFLECTIVE PAVEMENT MARKINGS.

- LEGEND**
- SEEDING, CLASS 1
 - SEEDING, CLASS 2A
 - SEEDING, CLASS 4
 - AGGREGATE DITCH, 12" OR STONE DUMPED RIPRAP, CLASS A4 OR STONE RIPRAP, CLASS A3

- REMOVAL LEGEND**
- TREE REMOVAL, UNIT
 - TREE REMOVAL, ACRE
 - TYPE III BARRICADE
- STAGGER BARRICADES AFTER COMPLETION OF CULVERT #9
- HOT-MIX ASPHALT SURFACE REMOVAL - BUTT JOINT

PROFILE	SURVEYED	DATE
	PLOTTED	
	CHECKED	
	BY	
	NO.	
	NO.	
	NO.	
	NO.	
	NO.	
	NO.	
	NO.	

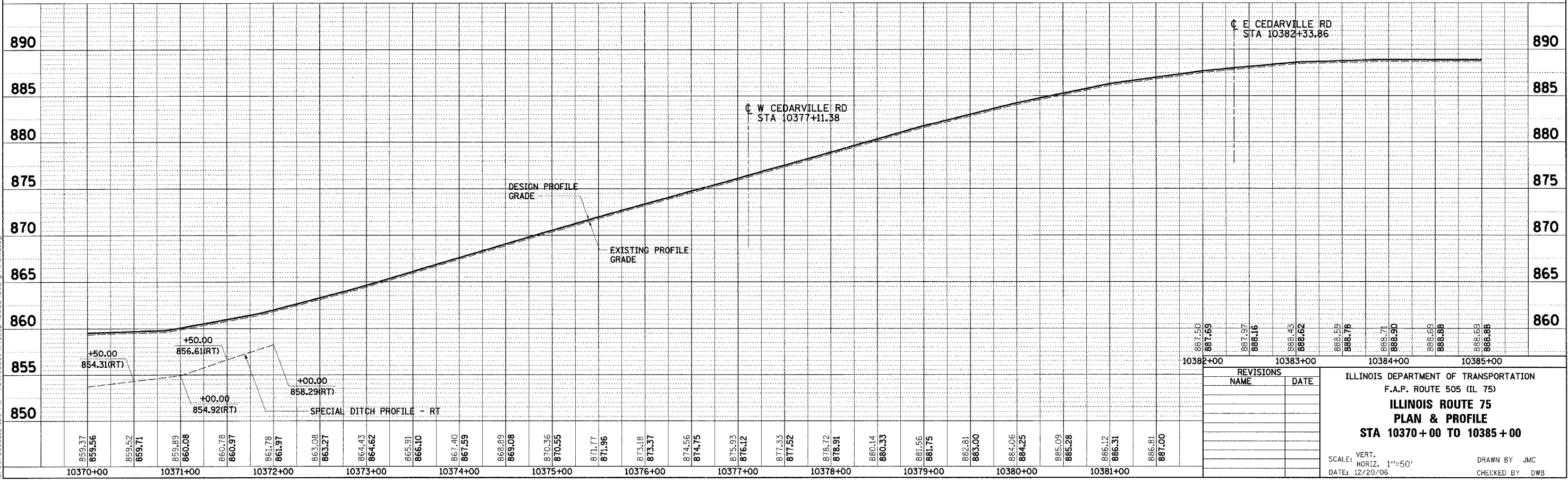

REVISIONS	
NAME	DATE

ILLINOIS DEPARTMENT OF TRANSPORTATION
 F.A.P. ROUTE 505 (IL 75)
ILLINOIS ROUTE 75
PLAN & PROFILE
STA 10370+00 TO 10385+00

SCALE: VERT. 1"=50'
 HORIZ. 1"=50'
 DATE: 12/20/06

DRAWN BY JMC
 CHECKED BY DWB