

BENEDICT & DOROTHY M.
KUROWSKI TRUSTEES

GILT EDGE FARMS INC.



F.A.P. RTE.	SECTION	COUNTY	TOTAL SHEETS	SHEET NO.
505	110RS-1, 111RS-3	STEPHENSON	174	30
STA. 10265+00 TO STA. 10280+00				
FED. ROAD DIST. NO. ILLINOIS		FED. AID PROJECT		
CONTRACT NO. 64C32				

PLAN	SURVEYED	BY	DATE
	ALIGNED		
	NOTE BOOK NO.		
	FILE NAME		

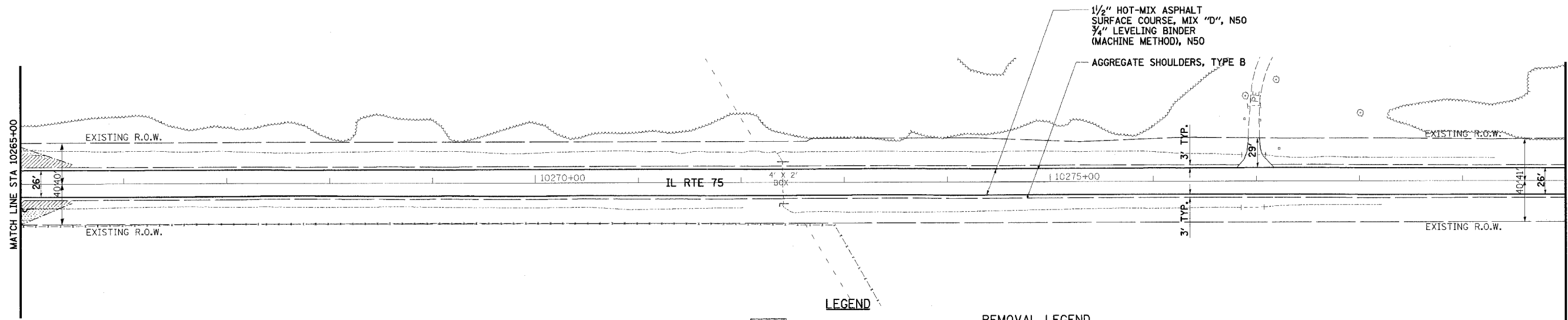

JANET E. LUBBERS

- NOTES:
1. FOR TURF SHOULDER LIMITS, SEE "SCHEDULE OF TURF SHOULDER" SHEET NO. 12.
 2. OVERLAY DRIVEWAYS TO R.O.W. OR AS DESIGNATED IN THE PLANS.
 3. RESTRIPE ILLINOIS ROUTE 75 TO MATCH EXISTING CONDITIONS.
 4. REMOVE ALL EXISTING RAISED REFLECTIVE PAVEMENT MARKINGS.

LEGEND		REMOVAL LEGEND	
	SEEDING, CLASS 1		TREE REMOVAL, UNIT
	SEEDING, CLASS 2A		TREE REMOVAL, ACRE
	SEEDING, CLASS 4		
	AGGREGATE DITCH, 12" OR STONE DUMPED RIPRAP, CLASS A4 OR STONE RIPRAP, CLASS A3		

GILT EDGE FARMS INC.



PROFILE	SURVEYED	BY	DATE
	GRADE CHECKED		
	MAN NOTED		
	STRUCTURE NOTATIONS CHECKED		

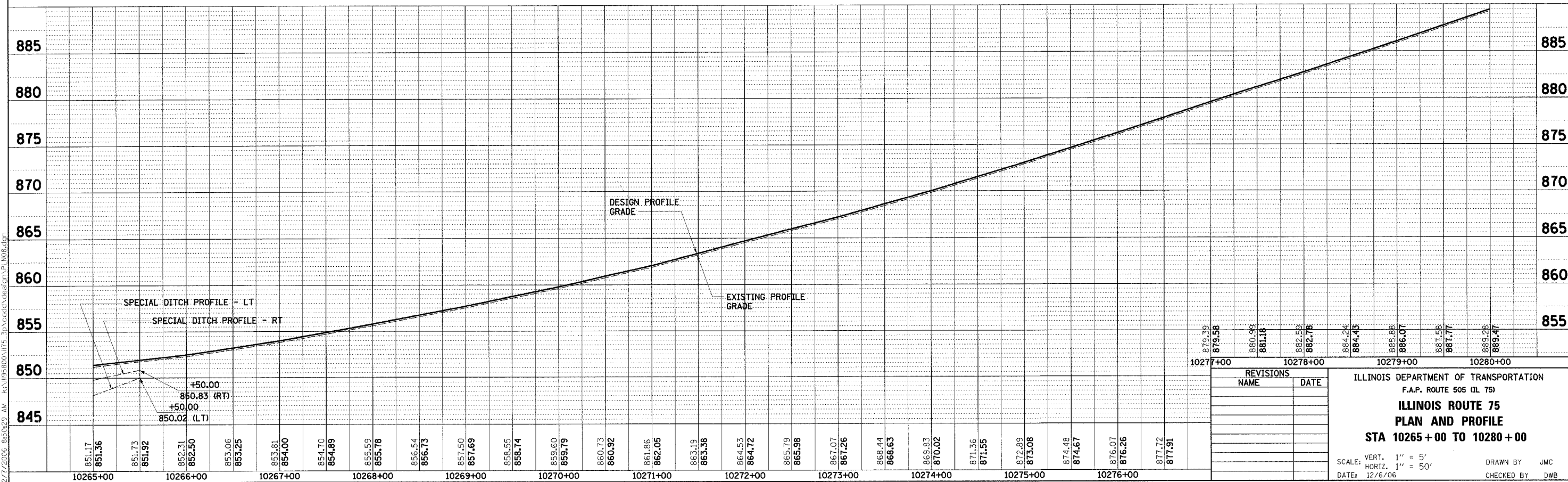

REVISIONS	
NAME	DATE

ILLINOIS DEPARTMENT OF TRANSPORTATION
F.A.P. ROUTE 505 (IL 75)
**ILLINOIS ROUTE 75
PLAN AND PROFILE**
STA 10265+00 TO 10280+00

SCALE: VERT. 1" = 5'	DRAWN BY JMC
HORIZ. 1" = 50'	CHECKED BY DWB
DATE: 12/6/06	