

BENEDICT & DOROTHY M.
KUROWSKI TRUSTEES

F.A.P. RTE.	SECTION	COUNTY	TOTAL SHEETS	SHEET NO.
505 110RS-1, 111RS-3	STEPHENSON	174	29	
STA. 10250+00		TO STA. 10265+00		
FED. ROAD DIST. NO.	ILLINOIS	FED. AID PROJECT	CONTRACT NO. 64C32	

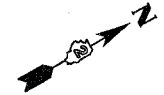

DATE
BY
CHECKED
DATE
BY
NO.
FILE NAME

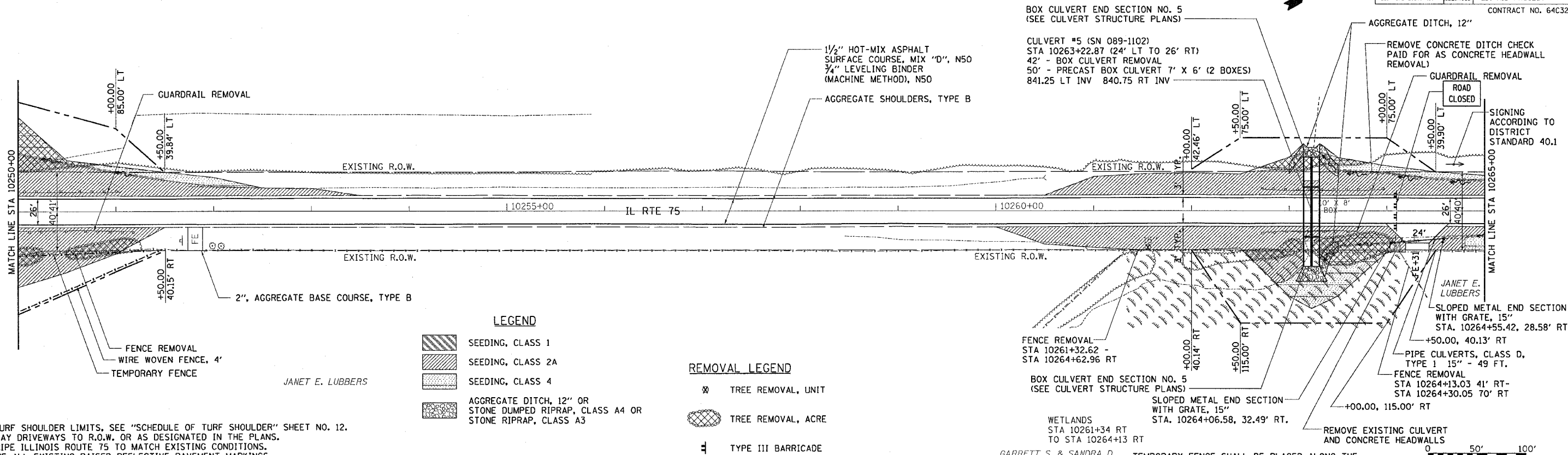

- NOTES:
- FOR TURF SHOULDER LIMITS, SEE "SCHEDULE OF TURF SHOULDER" SHEET NO. 12.
 - OVERLAY DRIVEWAYS TO R.O.W. OR AS DESIGNATED IN THE PLANS.
 - RESTRIPE ILLINOIS ROUTE 75 TO MATCH EXISTING CONDITIONS.
 - REMOVE ALL EXISTING RAISED REFLECTIVE PAVEMENT MARKINGS.

TEMPORARY FENCE SHALL BE PLACED ALONG THE CONSTRUCTION LIMITS WITHIN THE WETLANDS BOUNDARY

DATE
BY
CHECKED
DATE
BY
NO.
FILE NAME

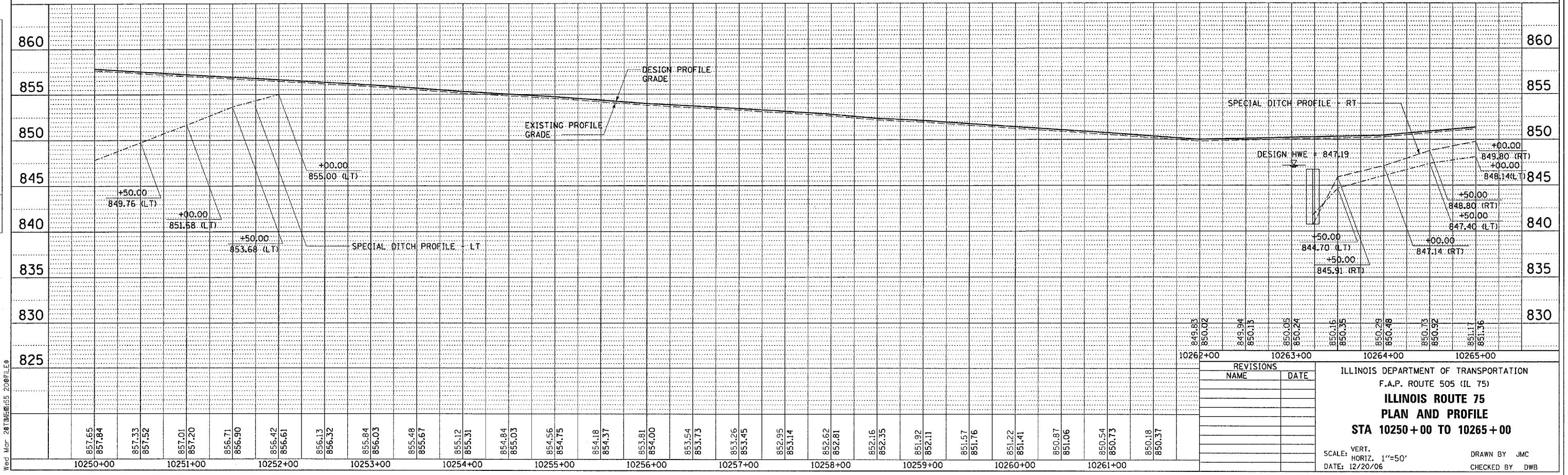

REVISIONS	
NAME	DATE

ILLINOIS DEPARTMENT OF TRANSPORTATION
F.A.P. ROUTE 505 (IL 75)
**ILLINOIS ROUTE 75
PLAN AND PROFILE**
STA 10250+00 TO 10265+00

SCALE: VERT. 1"=50'
DATE: 12/20/06

DRAWN BY JMC
CHECKED BY DWB

Wed, Mar 28 11:55:20 2007 FILES