

F.A.P. RTE.	SECTION	COUNTY	TOTAL SHEETS	SHEET NO.
505	110RS-1, 111RS-3	STEPHENSON	174	27
STA. 10220+00		TO STA. 10235+00		
FED. ROAD DIST. NO.		ILLINOIS FED. AID PROJECT		CONTRACT NO. 64C32

ERIC L. SEFFORD

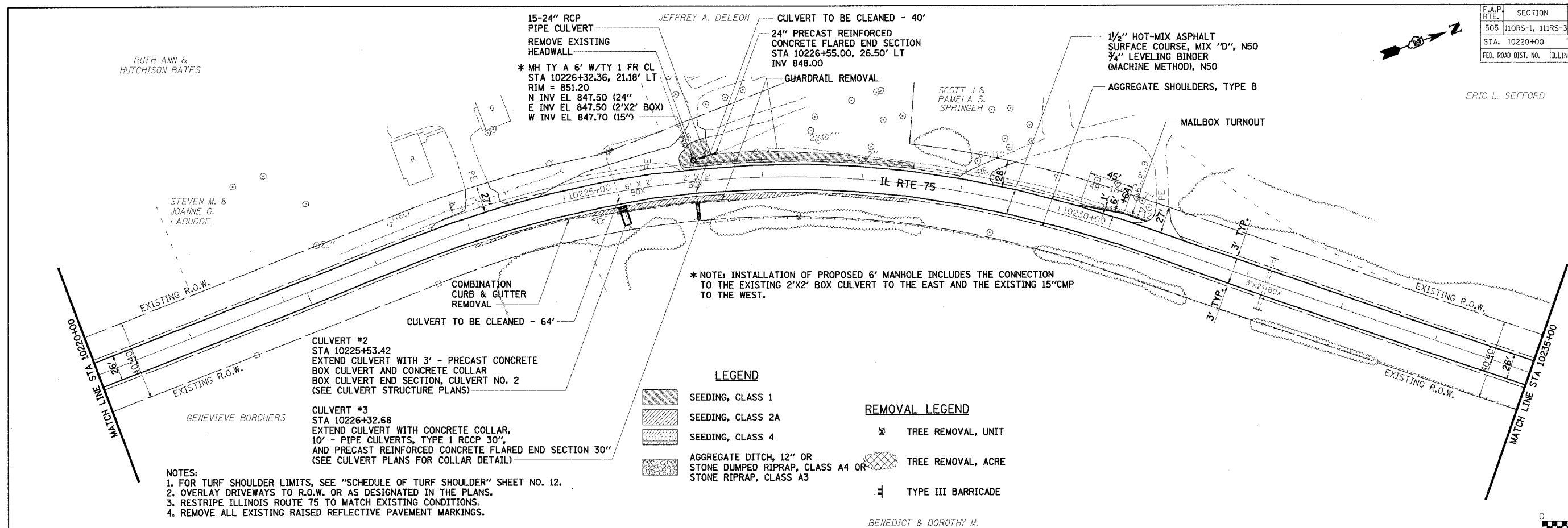

DATE	BY	REVISION



- NOTES:
- FOR TURF SHOULDER LIMITS, SEE "SCHEDULE OF TURF SHOULDER" SHEET NO. 12.
  - OVERLAY DRIVEWAYS TO R.O.W. OR AS DESIGNATED IN THE PLANS.
  - RESTRIPE ILLINOIS ROUTE 75 TO MATCH EXISTING CONDITIONS.
  - REMOVE ALL EXISTING RAISED REFLECTIVE PAVEMENT MARKINGS.

**LEGEND**

- SEEDING, CLASS 1
- SEEDING, CLASS 2A
- SEEDING, CLASS 4
- AGGREGATE DITCH, 12" OR STONE DUMPED RIPRAP, CLASS A4 OR STONE RIPRAP, CLASS A3

**REMOVAL LEGEND**

- TREE REMOVAL, UNIT
- TREE REMOVAL, ACRE
- TYPE III BARRICADE

DATE	BY	REVISION

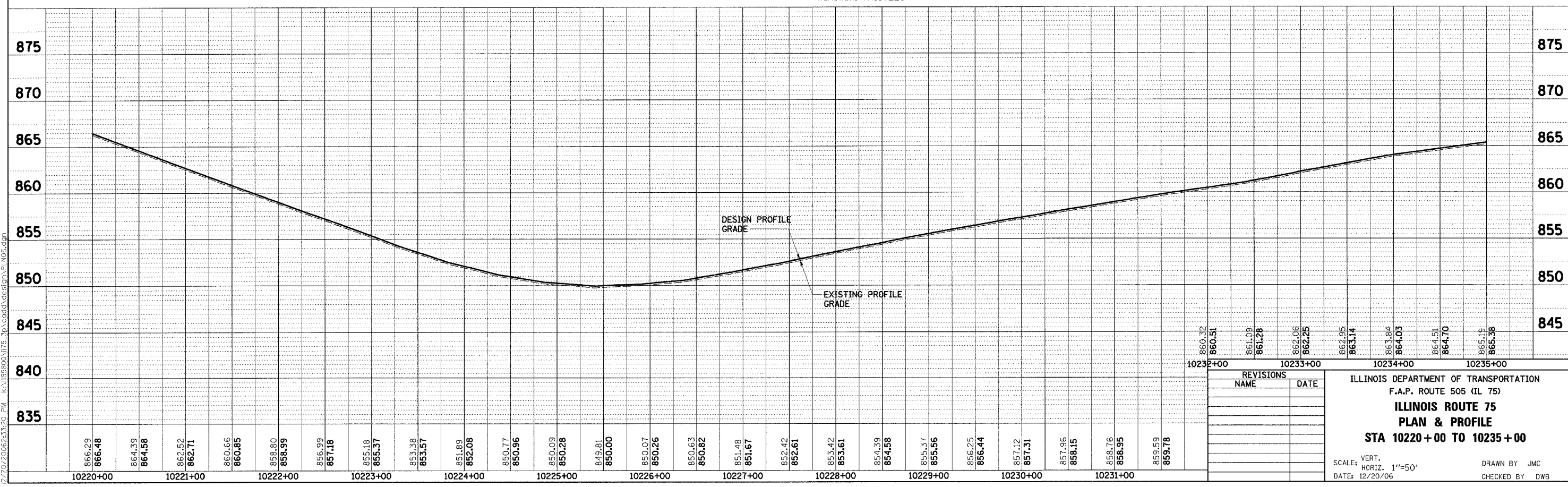

REVISIONS	
NAME	DATE

ILLINOIS DEPARTMENT OF TRANSPORTATION  
F.A.P. ROUTE 505 (IL 75)  
**ILLINOIS ROUTE 75**  
**PLAN & PROFILE**  
**STA 10220 + 00 TO 10235 + 00**

SCALE: VERT. 1"=50'  
DATE: 12/20/06

DRAWN BY JMC  
CHECKED BY DWB

P:\20\2006\23320\_FM\_KA\1058500\1175\_3p\_cadd\design\_P\_1105.dgn