

WALTER
OPPENHEIMER

RUTH ANN &
HUTCHISON BATES



F.A.P. RTE.	SECTION	COUNTY	TOTAL SHEETS	SHEET NO.
505	110RS-1, 111RS-3	STEPHENSON	174	25
STA. 10190+00 TO STA. 10205+00				
FED. ROAD DIST. NO.		ILLINOIS FED. AID PROJECT		
CONTRACT NO. 64C32				

PLAN	DATE	BY
SEWERED		
ADJUSTED		
RT. OF WAY CHECKED		
ADD FILE NAME		

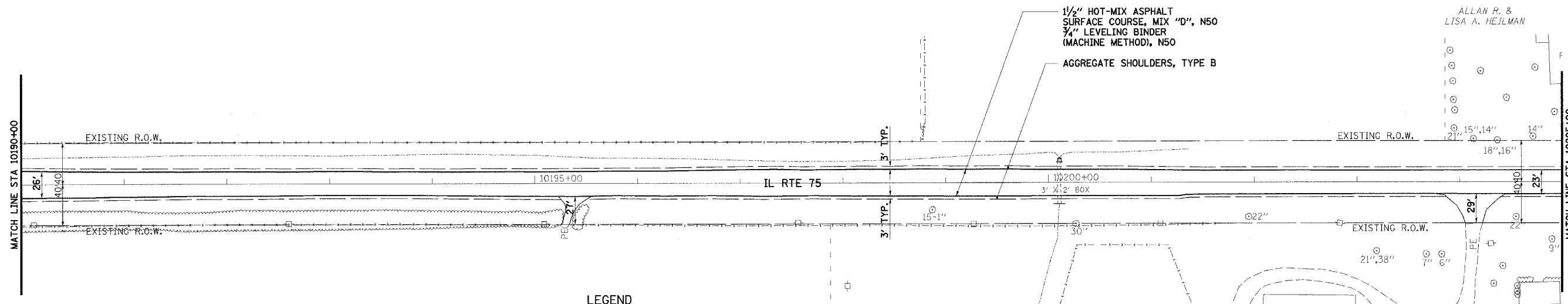

DEAN D. & KRISTI K.
PARRISH

LEGEND

- SEEDING, CLASS 1
- SEEDING, CLASS 2A
- SEEDING, CLASS 4
- AGGREGATE DITCH, 12" OR STONE DUMPED RIPRAP, CLASS A4 OR STONE RIPRAP, CLASS A3

REMOVAL LEGEND

- TREE REMOVAL, UNIT
- TREE REMOVAL, ACRE

NOTES:

1. FOR TURF SHOULDER LIMITS, SEE "SCHEDULE OF TURF SHOULDER" SHEET NO. 12.
2. OVERLAY DRIVEWAYS TO R.O.W. OR AS DESIGNATED IN THE PLANS.
3. RESTRIPE ILLINOIS ROUTE 75 TO MATCH EXISTING CONDITIONS.
4. REMOVE ALL EXISTING RAISED REFLECTIVE PAVEMENT MARKINGS.

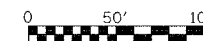

PROFILE	DATE	BY
REMOVED		
ADJUSTED		
RT. OF WAY CHECKED		
STRUCTURE NOTATIONS UPD		

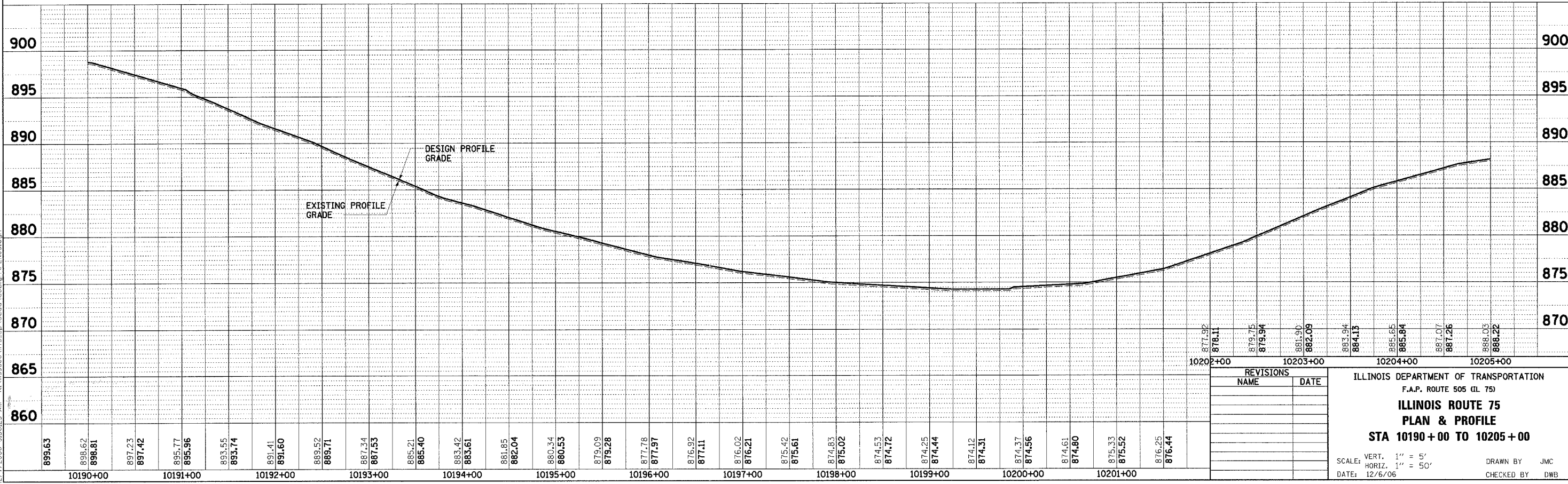

REVISIONS	
NAME	DATE

ILLINOIS DEPARTMENT OF TRANSPORTATION
 F.A.P. ROUTE 505 (IL 75)
ILLINOIS ROUTE 75
PLAN & PROFILE
STA 10190+00 TO 10205+00

SCALE: VERT. 1" = 5'
 HORIZ. 1" = 50'

DATE: 12/6/06

DRAWN BY JMC
 CHECKED BY DWB

12/7/2006 9:50:25 AM K:\1095800\1175_3p\cadd\east\plan\10190+00.dgn