

F.A.P. RTE.	SECTION	COUNTY	TOTAL SHEETS	SHEET NO.
339	116 RS-4	COOK	15	7
STA. 503+86		TO STA. 527+00		
FED. ROAD DIST. NO. 1 ILLINOIS FED. AID PROJECT				

CONTRACT NO. 62668

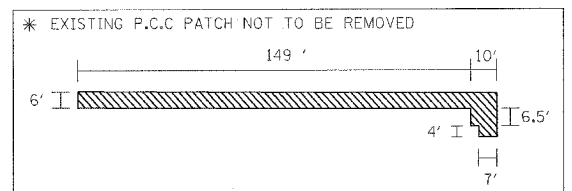
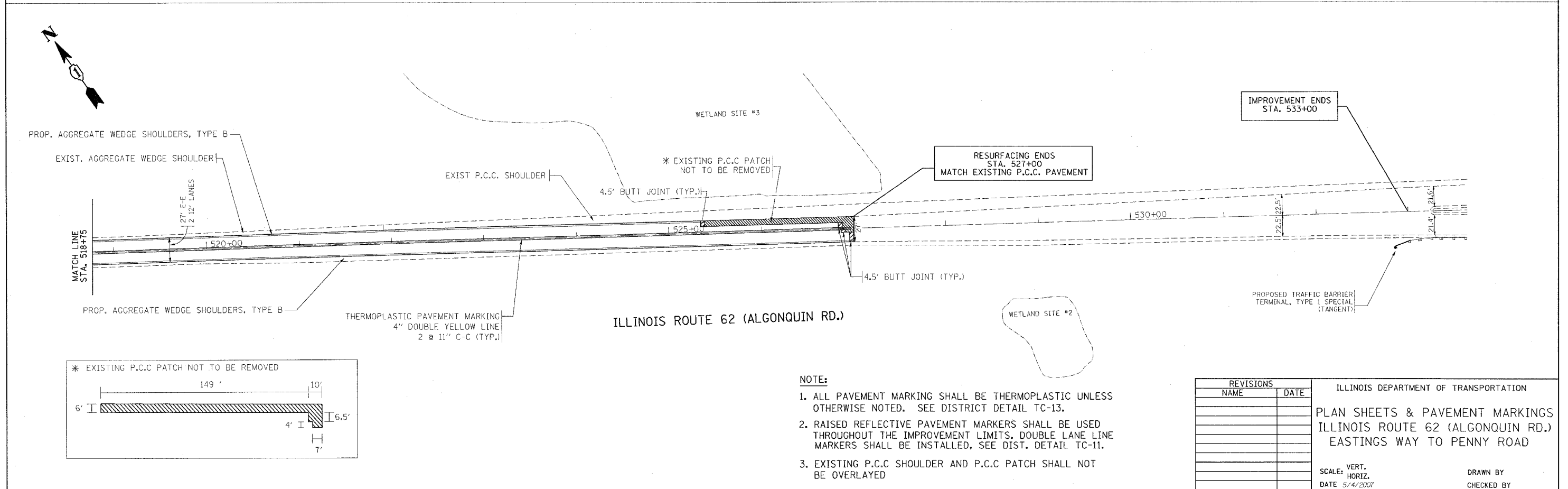
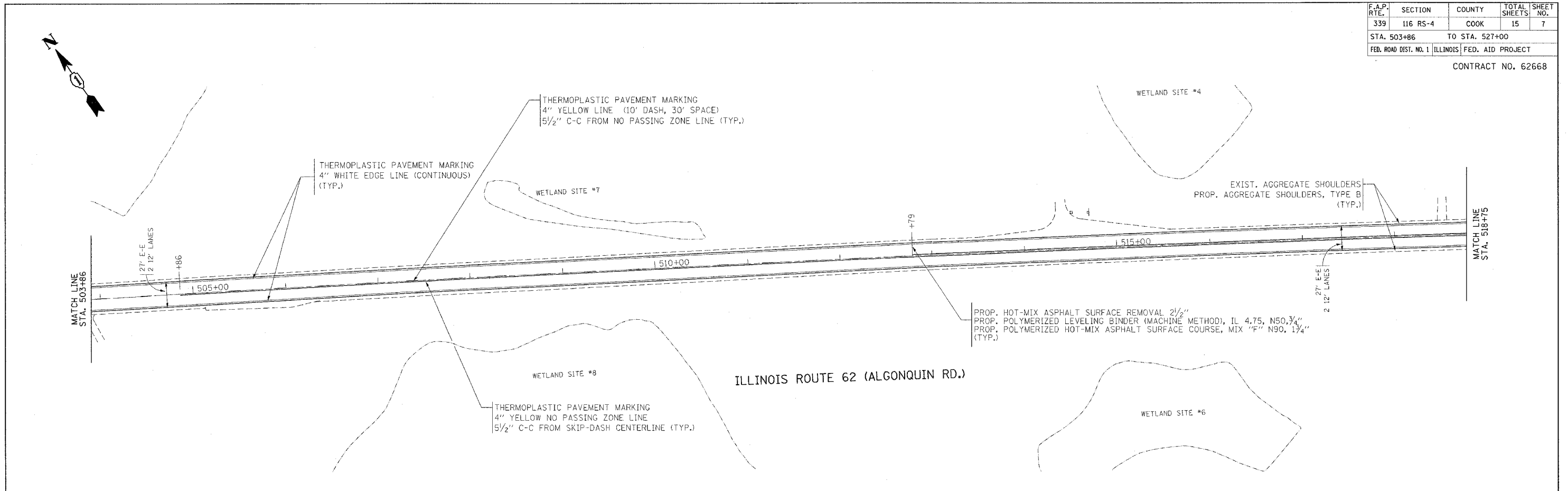

- NOTE:**
1. ALL PAVEMENT MARKING SHALL BE THERMOPLASTIC UNLESS OTHERWISE NOTED. SEE DISTRICT DETAIL TC-13.
 2. RAISED REFLECTIVE PAVEMENT MARKERS SHALL BE USED THROUGHOUT THE IMPROVEMENT LIMITS. DOUBLE LANE LINE MARKERS SHALL BE INSTALLED, SEE DIST. DETAIL TC-11.
 3. EXISTING P.C.C. SHOULDER AND P.C.C. PATCH SHALL NOT BE OVERLAYED

REVISIONS	
NAME	DATE

ILLINOIS DEPARTMENT OF TRANSPORTATION
 PLAN SHEETS & PAVEMENT MARKINGS
 ILLINOIS ROUTE 62 (ALGONQUIN RD.)
 EASTINGS WAY TO PENNY ROAD

SCALE: VERT. _____
 HORIZ. _____
 DATE: 5/14/2007

DRAWN BY _____
 CHECKED BY _____