

F.A.U. RTE.	SECTION	COUNTY	TOTAL SHEETS	SHEET NO.
1504	2007-016-RS	COOK	14	1

STATE OF ILLINOIS
DEPARTMENT OF TRANSPORTATION
DIVISION OF HIGHWAYS

**PROPOSED
HIGHWAY PLANS**

F.A.U. ROUTE 1504: 55TH STREET
US 12/20/45 TO EAST AVENUE/EVERLY AVENUE
SECTION: 2007-016-RS
RESURFACING (MAINTENANCE)
COOK COUNTY
C-91-256-07

FOR INDEX OF SHEETS, SEE SHEET NO. 2

IMPROVEMENT LOCATED IN THE
VILLAGE OF LAGRANGE

IMPROVEMENT BEGINS
STA. 101+55

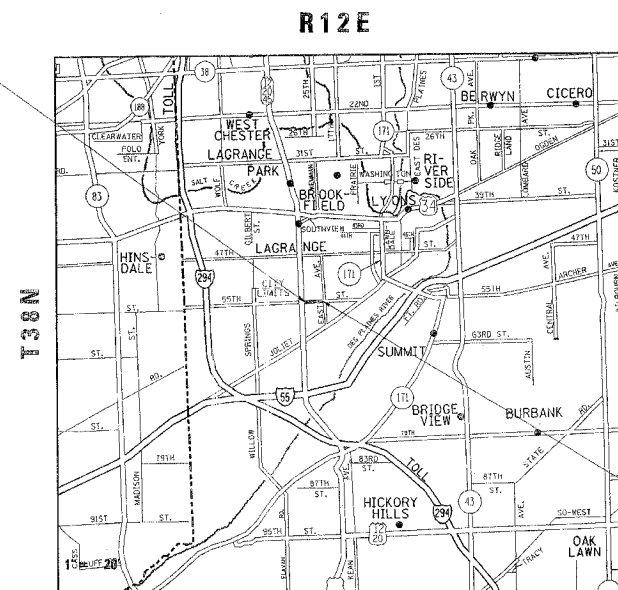

TRAFFIC DATA
2006 ADT = 23000
POSTED SPEED LIMIT = 40 MPH

IMPROVEMENT ENDS
STA. 125+58

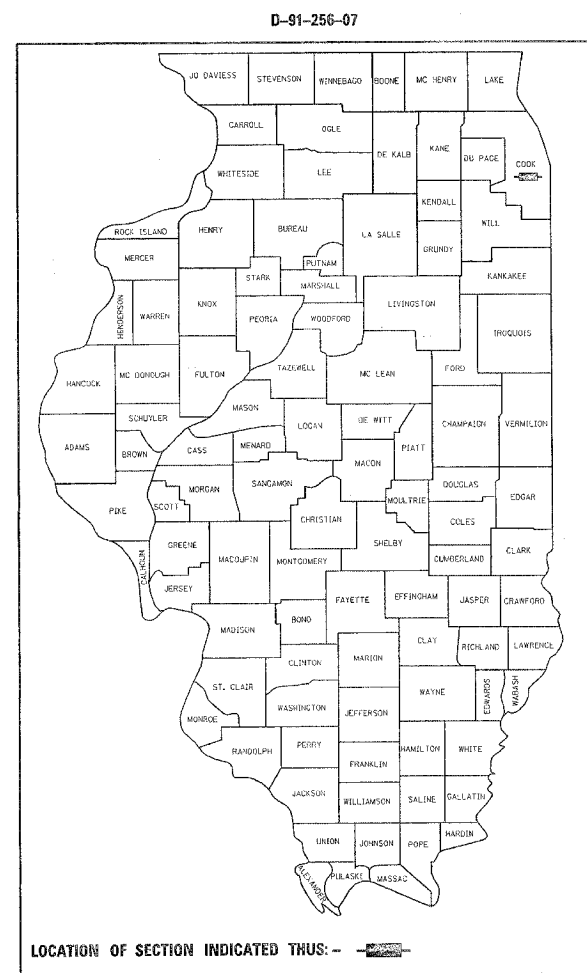

LOCATION OF SECTION INDICATED THUS: -

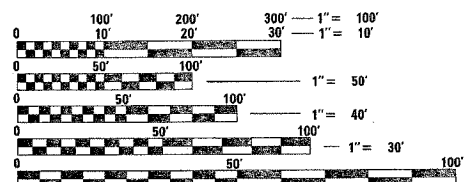

FULL SIZE PLANS HAVE BEEN PREPARED USING STANDARD
ENGINEERING SCALES. REDUCED SIZED PLANS WILL NOT
CONFORM TO STANDARD SCALES. IN MAKING MEASUREMENTS
ON REDUCED PLANS, THE ABOVE SCALES MAY BE USED.

J.U.L.I.E.
JOINT UTILITY LOCATION INFORMATION FOR EXCAVATION
1-800-892-0123

GROSS & NET LENGTH OF IMPROVEMENT = 2,403 FT = 0.455 MILE

STATE OF ILLINOIS
DEPARTMENT OF TRANSPORTATION
DIVISION OF HIGHWAYS

SUBMITTED April 12 2007
Diane O'Keefe/CD
DEPUTY DIRECTOR OF HIGHWAYS, REGION ENGINEER

May 11 2007
Eric E. Haran/ED
INTERIM ENGINEER OF DESIGN AND ENVIRONMENT

May 11 2007
Milton R. Sauer/PE/ED
DIRECTOR OF HIGHWAYS, CHIEF ENGINEER

PRINTED BY THE AUTHORITY
OF THE STATE OF ILLINOIS

DISTRICT ONE DESIGN PLAN PREPARATION ENGINEER: KEN ENG/LONG TRAN (847) 705-4240