

**NOTE:**

1. POSITION OF THE HANDICAP MARKING AND SIGNAGE, ADMINISTRATION ONLY SIGNAGE, FAA SIGNAGE, AND FLIGHTSTAR SIGNAGE ARE ALL SUBJECT TO AIRPORT APPROVAL PRIOR TO INSTALLATION. THE CONTRACTOR SHALL COORDINATE THIS ITEM WITH THE R.E. AND AIRPORT 24 HOURS BEFORE INSTALLING THESE ITEMS.

**LEGENDS**

	NEW SIGN
	NEW PAVEMENT MARKING
	SIGN NUMBER
	EXISTING LIGHT POLE

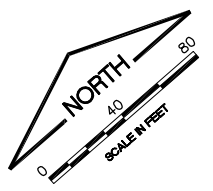

FILE: MARKING LAYOUT.dwg  
UPDATE BY: Dale Draughan  
PLOT DATE: 5/3/2013 12:23 PM

Coally  
KEYMAP  
CMI UTILITIES  
CMI EP SVY  
1105905\_TOPO\_FAA Site JMW 2  
BASE\_PROP\_MARK  
BASE\_PROP\_GEO  
CMI Tower Site TOPO  
**UN052**

REVISIONS		
NUMBER	BY	DATE

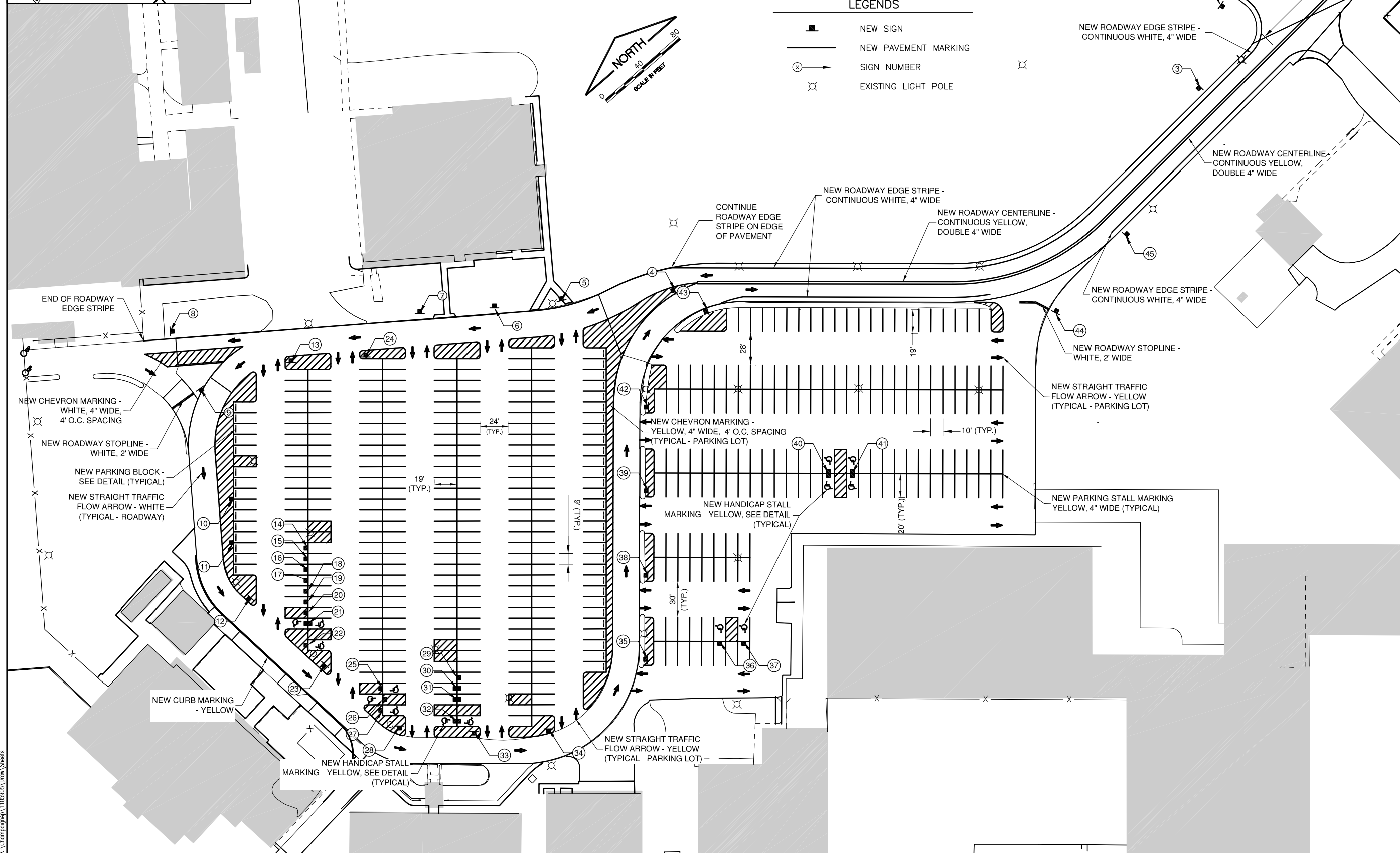
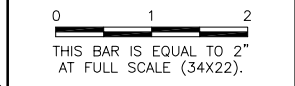

**UNIVERSITY OF ILLINOIS  
WILLARD AIRPORT  
SAVOY, ILLINOIS**

**RELOCATE ENTRANCE ROADWAY &  
REHABILITATE OLD TERMINAL PARKING LOT  
MARKING & SIGN LAYOUT**

© Copyright CMT, Inc.

**CMT**  
CRAWFORD, MURPHY & TILLY, INC.  
CONSULTING ENGINEERS  
License No. 184-000613

DESIGN BY:	CBG
DRAWN BY:	CMT
CHECKED BY:	KLB
APPROVED BY:	CET
DATE:	4/19/2013
JOB No:	11059-05-00

K:\Champaign\1105905\_Drawn\_Sheets