

**LEGENDS**

|                         |  |
|-------------------------|--|
| [Hatched Pattern]       | NEW 2" BITUMINOUS SURFACE COURSE                                   |
| [Hatched Pattern]       | NEW 2" BITUMINOUS BASE COURSE                                      |
| [Hatched Pattern]       | NEW 8" CRUSHED AGGREGATE BASE COURSE                               |
| [Hatched Pattern]       | NEW 2" & VARIABLE BITUMINOUS SURFACE COURSE                        |
| [Hatched Pattern]       | NEW 1-1/2" & VARIABLE BITUMINOUS SURFACE COURSE                    |
| [Hatched Pattern]       | NEW 1" & VARIABLE BITUMINOUS LEVELING COURSE                       |
| [Hatched Pattern]       | REMOVE ISLAND  |
| [Hatched Pattern]       | NEW 1-1/2" & VARIABLE BITUMINOUS SURFACE COURSE                    |
| [Hatched Pattern]       | NEW 1" & VARIABLE BITUMINOUS LEVELING COURSE                       |
| [Hatched Pattern]       | NEW 2" BITUMINOUS BASE COURSE                                      |
| [Hatched Pattern]       | NEW 8" CRUSHED AGGREGATE BASE COURSE                               |
| [Stippled Pattern]      | FULL DEPTH BITUMINOUS REPAIR<br>(SEE TYPICAL SECTIONS 2, SHEET 18) |
| [Hatched Pattern]       | NEW 4" P.C.C. SIDEWALK   |
| [Cross-hatched Pattern] | NEW BUTT JOINT   |
| [Dashed Line]           | BITUMINOUS CRACK REPAIR<br>(SEE TYPICAL SECTIONS 2, SHEET 18)      |



FILE: PROPOSED IMPROVEMENTS 1.dwg  
 UPDATE BY: Dale Draughan  
 PLOT DATE: 5/3/2013 12:22 PM

Coally  
 CMI UTILITIES  
 CMI TOWER TOPO  
 KEYMAP  
 CMI EP SVY  
 BASE\_PROP\_IMP  
 BASE\_PROP\_IMP

**UN052**

**REVISIONS**

| NUMBER | BY | DATE |
|--------|----|------|
|        |    |      |
|        |    |      |
|        |    |      |

0 1 2  
 THIS BAR IS EQUAL TO 2"  
 AT FULL SCALE (34X22).

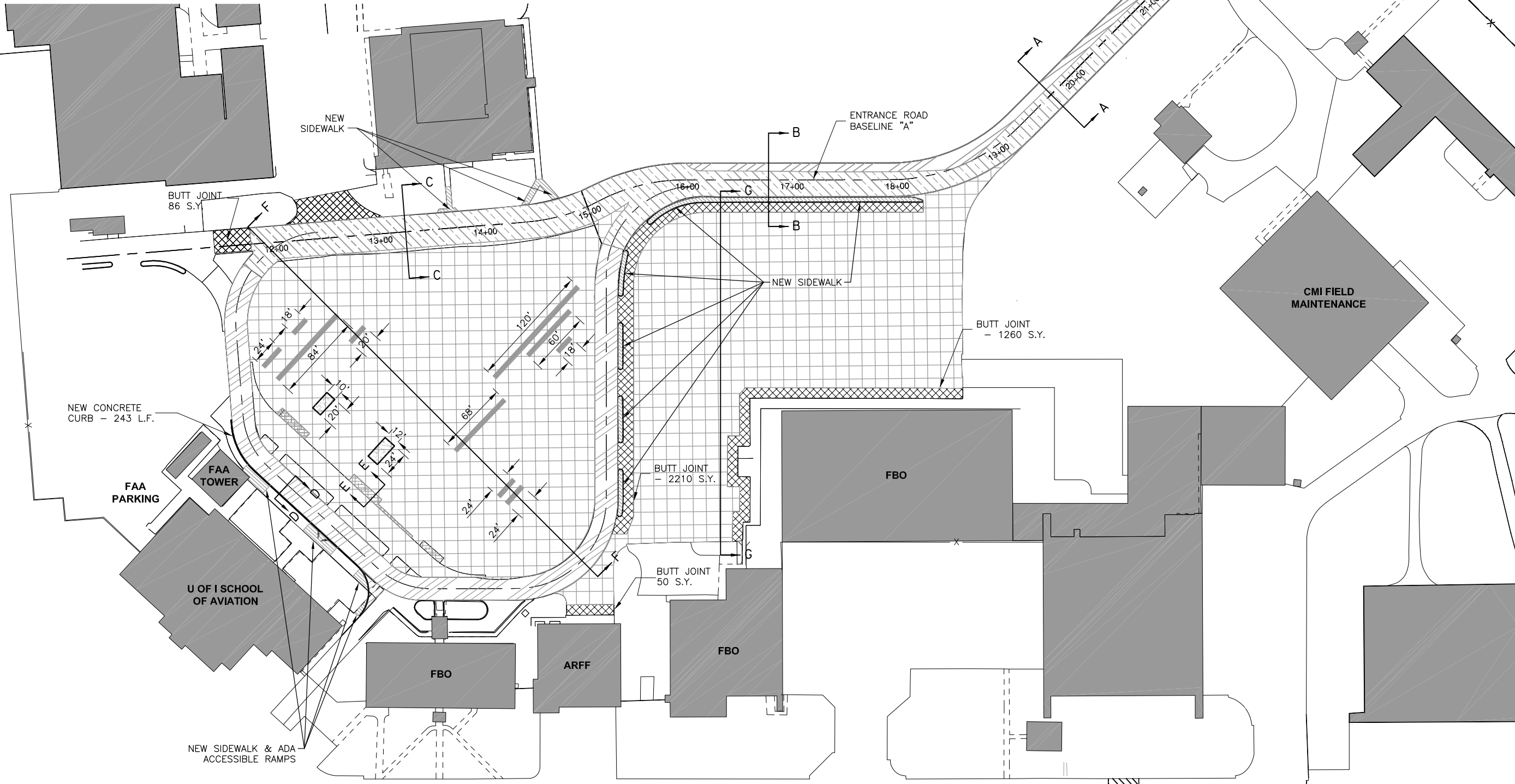

UNIVERSITY OF ILLINOIS  
 WILLARD AIRPORT  
 SAVOY, ILLINOIS

RELOCATE ENTRANCE ROADWAY &  
 REHABILITATE OLD TERMINAL PARKING LOT

**PROPOSED IMPROVEMENTS**

© Copyright CMT, Inc.

**CMT**  
 CRAWFORD, MURPHY & TILLY, INC.  
 CONSULTING ENGINEERS  
 License No. 184-000613

|                        |             |
|------------------------|-------------|
| DESIGN BY:             | CBG         |
| DRAWN BY:              | CMT         |
| CHECKED BY:            | KLB         |
| APPROVED BY:           | CET         |
| DATE:                  | 4/19/2013   |
| JOB No:                | 11059-05-00 |
| IL. PROJ. NO. CMI-4269 |             |
| SHEET 16 OF 38 SHEETS  |             |

K:\Champaign\1105905\Draw\Sheets