

PHASE 5 NOTES:

1. CONTRACTOR SHALL GIVE THE AIRPORT SEVEN (7) DAYS NOTIFICATION PRIOR TO THE COMMENCEMENT OF EACH PHASE.
2. ALL CONSTRUCTION BARRICADES AND TEMPORARY SIGNAGE SHALL BE IN PLACE PRIOR TO THE COMMENCEMENT OF THIS PHASE.
3. CONTRACTOR SHALL FOLLOW IDOT REQUIREMENTS AND SPECIFICATIONS FOR CONSTRUCTION TRAFFIC SIGNAGE.
4. VEHICLES REMAINING IN THE WORK LIMITS OF THE PARKING LOT SHALL BE TOWED TO THE OTHER HALF OF THE LOT. ANY DAMAGED INFLECTED ON THE VEHICLE DURING THE TOW SHALL BE THE RESPONSIBILITY OF THE CONTRACTOR.

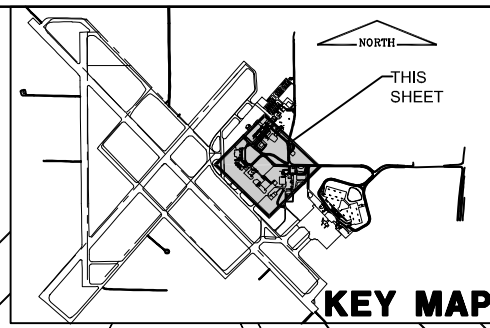
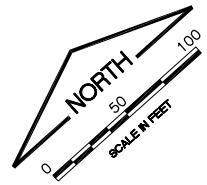

FILE: CONST ACTIVITY PLAN PH 5.dwg
 UPDATE BY: Dale Draughan
 PLOT DATE: 5/3/2013 12:21 PM

Cooly
 KEYMAP
 CMI Tower Site TOPO
 BASE_PROP_PHASE

UN052

REVISIONS		
NUMBER	BY	DATE

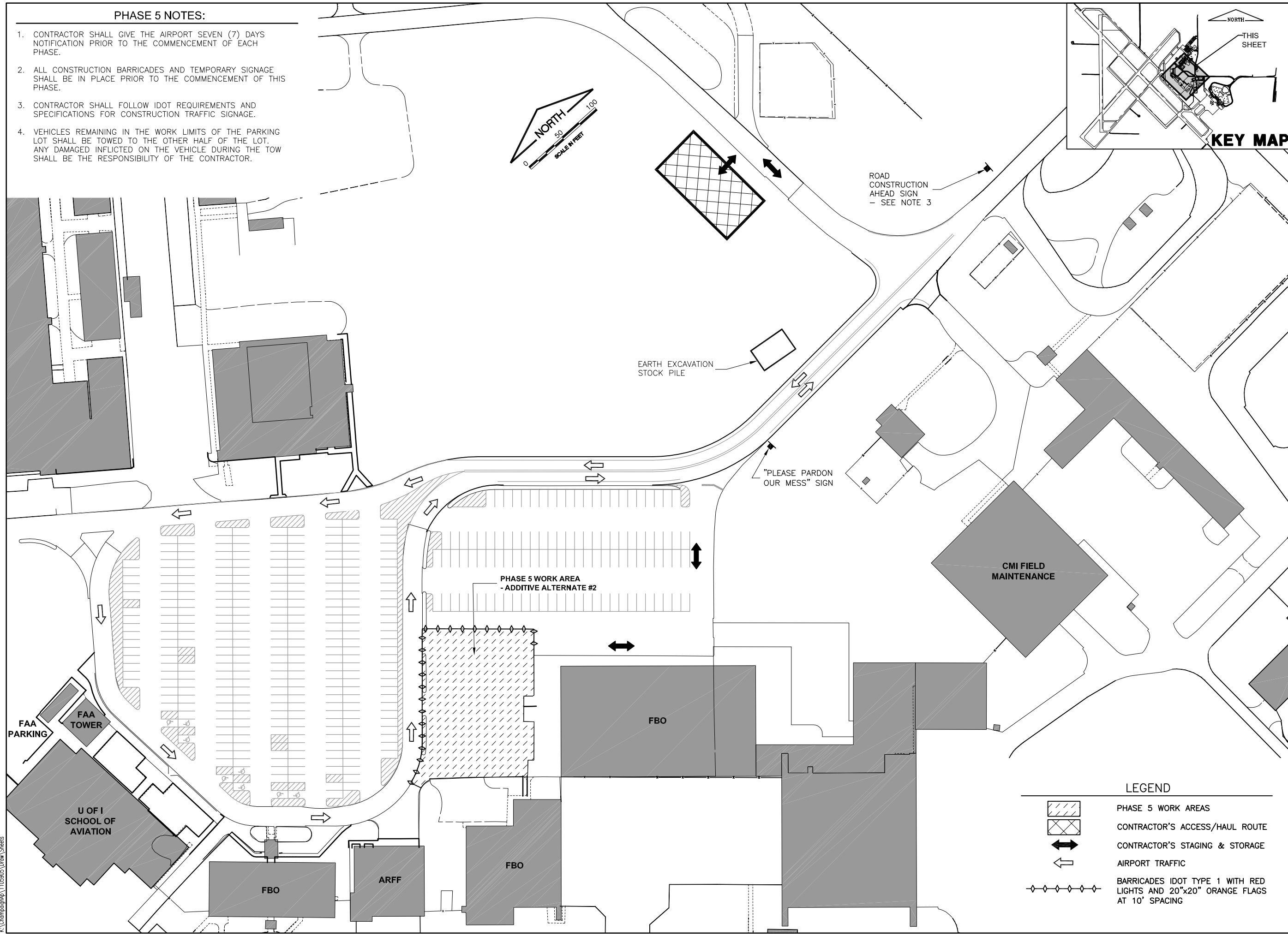

**UNIVERSITY OF ILLINOIS
 WILLARD AIRPORT
 SAVOY, ILLINOIS**

**RELOCATE ENTRANCE ROADWAY &
 REHABILITATE OLD TERMINAL PARKING LOT
 CONSTRUCTION ACTIVITY PLAN
 PHASE 5**

© Copyright CMT, Inc.

CMT
 CRAWFORD, MURPHY & TILLY, INC.
 CONSULTING ENGINEERS
 License No. 184-000613

LEGEND

	PHASE 5 WORK AREAS
	CONTRACTOR'S ACCESS/HAUL ROUTE
	CONTRACTOR'S STAGING & STORAGE
	AIRPORT TRAFFIC
	BARRICADES IDOT TYPE 1 WITH RED LIGHTS AND 20"x20" ORANGE FLAGS AT 10' SPACING

DESIGN BY:	CBG
DRAWN BY:	CMT
CHECKED BY:	KLB
APPROVED BY:	CET
DATE:	4/19/2013
JOB No:	11059-05-00
IL. PROJ. NO. CMI-4269	
SHEET 09 OF 38 SHEETS	

K:\Champaign\1105905\Draw\Sheets