

CRITICAL POINT TABLE						
POINT	LATITUDE	LONGITUDE	GROUND ELEVATION	MAXIMUM EQUIPMENT ELEVATION	POLE HEIGHT	OVERALL POLE ELEVATION
A	40° 02' 26.21854	88° 16' 11.91509	746'	771'	N/A	N/A
B	40° 02' 22.29664	88° 16' 12.47602	748'	773'	N/A	N/A
C	40° 02' 23.92338	88° 16' 07.65604	744'	769'	N/A	N/A
D	40° 02' 21.89253	88° 16' 01.65291	744'	769'	N/A	N/A
E	40° 02' 30.62576	88° 16' 04.71105	746'	771'	N/A	N/A
F	40° 02' 24.32355	88° 16' 02.08393	746'	771'	N/A	N/A
G	40° 02' 24.45645	88° 16' 07.75965	744'	N/A	30'	774'
H	40° 02' 23.19029	88° 16' 05.97198	744'	N/A	30'	774'
I	40° 02' 22.29527	88° 16' 03.93635	744'	N/A	30'	774'
J	40° 02' 22.34883	88° 16' 01.49211	744'	N/A	30'	774'

- ### GENERAL NOTES
1. THE CONTRACTOR SHALL STORE EQUIPMENT AND MATERIALS AT THE LOCATION SHOWN FOR THE "CONTRACTOR'S STAGING, STORAGE, AND PARKING SITE".
 2. BROKEN OR WASTE CONCRETE AND ASPHALT SHALL BE DISPOSED OF BY THE CONTRACTOR OFF AIRPORT PROPERTY, UNLESS DIRECTED BY THE AIRPORT MANAGER.
 3. VEHICLES AND EQUIPMENT SHALL NOT BE ALLOWED WITHIN THE AIRSIDE OPERATIONS OF THE AIRPORT.
 4. ALL PAVEMENTS, DRIVES AND OTHER AREAS USED BY THE CONTRACTOR FOR HAUL ROADS AND STORAGE AREAS SHALL BE MAINTAINED AND REPAIRED IN KIND BY THE CONTRACTOR TO THE SATISFACTION OF AIRPORT MANAGER. NO ADDITIONAL COMPENSATION SHALL BE MADE TO THE CONTRACTOR FOR THIS WORK.
 5. EXISTING TURF AREAS DISTURBED BY THE CONTRACTOR'S OPERATIONS OUTSIDE OF THE TURFING LIMITS SHALL BE COMPLETELY RESTORED BY HIM AT HIS EXPENSE TO THE SATISFACTION OF THE AIRPORT MANAGER.
 6. REFER TO THE CONSTRUCTION ACTIVITY PLANS AND THE SPECIFICATIONS FOR ADDITIONAL REQUIREMENTS CONCERNING COORDINATION OF CONSTRUCTION ACTIVITIES.
 7. AT THE PRECONSTRUCTION MEETING, CONTRACTOR SHALL SUPPLY THE AIRPORT MANAGER WITH PROPOSED CLOSURE AND PHASING DATES FOR HIS REVIEW AND APPROVAL. THE RESIDENT ENGINEER SHALL KEEP THE AIRPORT MANAGER ADVISED OF ANY PROPOSED CHANGES IN CLOSURE AND PHASING DATES.

FILE: AIRPORT SITE PLAN.dwg
 UPDATE BY: Dale Draughan
 PLOT DATE: 5/3/2013 12:20 PM

Coally
 CMI Tower Site TOPO

UN052

REVISIONS		
NUMBER	BY	DATE

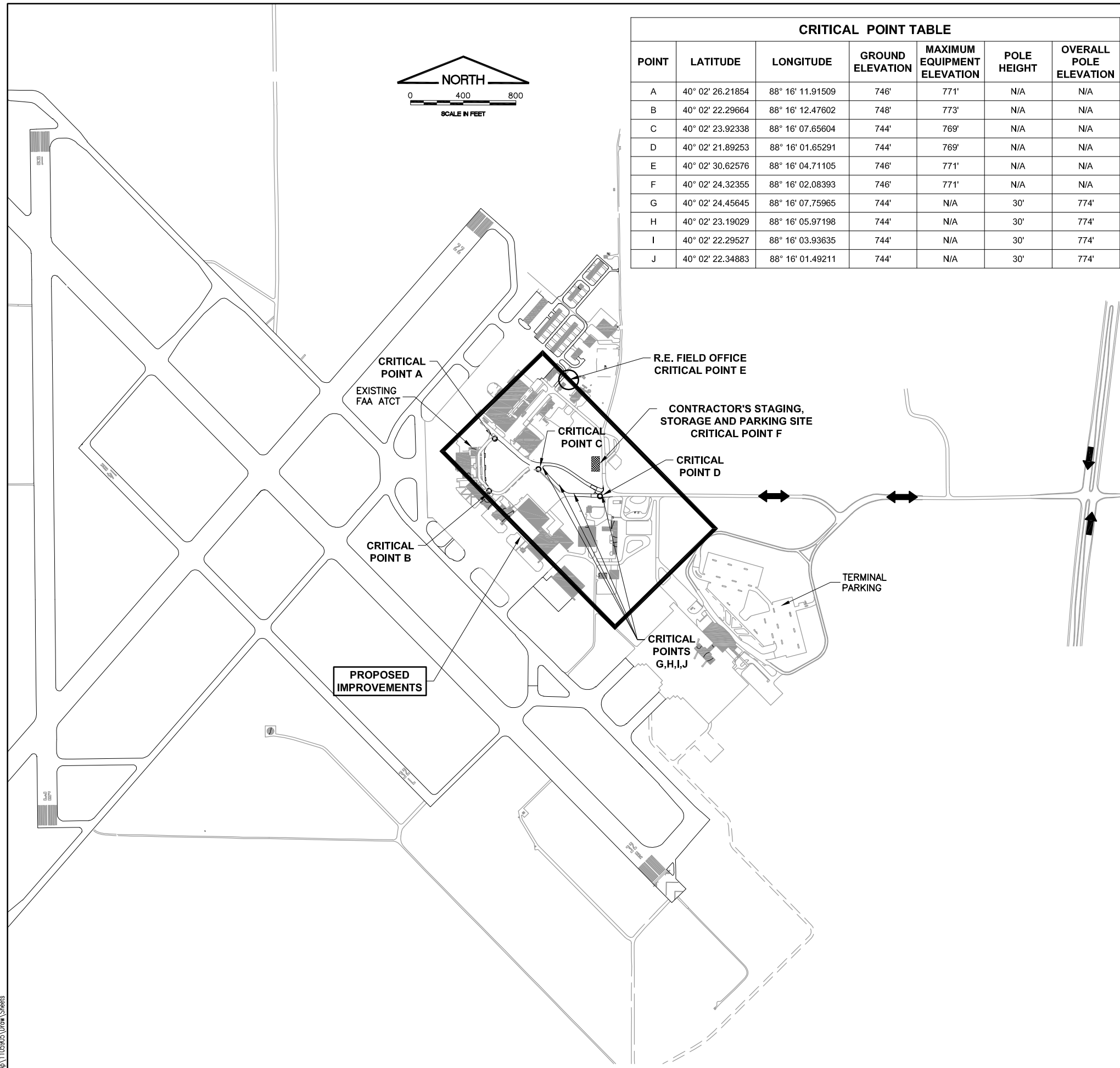
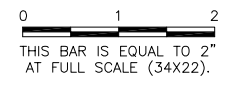

- ### CONTRACTOR'S ACCESS NOTES
1. CONTRACTOR'S ACCESS SHALL BE AS FOLLOWS:
 - A. THE CONTRACTORS ACCESS TO THE WORK SHALL BE AS SHOWN ON THE SITE PLAN AND CONSTRUCTION ACTIVITY PLANS.
 - B. DURING ADVERSE WEATHER, THE CONTRACTOR SHALL MAKE PROVISIONS FOR ACCESS TO THE WORK SITE AT NO ADDITIONAL COST TO THE CONTRACT. NO EXTENSION OF CONTRACT TIME WILL BE CONSIDERED FOR DELAYS DUE TO LACK OF ADEQUATE ACCESS TO THE WORK.
 - C. THE CONTRACTOR SHALL STORE EQUIPMENT AND MATERIALS IN SUCH A WAY AS TO NOT DISTURB AGRICULTURAL AREAS AND NOT VIOLATE THE PART 77 APPROACH AND PRIMARY SURFACES.
 - D. EMPLOYEE PERSONAL VEHICLES SHALL NOT BE ALLOWED BEYOND THE CONTRACTOR'S PARKING AREA. CONTRACTOR PERSONNEL SHALL PARK IN THE CONTRACTOR'S STORAGE AREA. PERSONNEL SHALL BE TRANSPORTED TO THE WORK SITE BY COMPANY OWNED VEHICLES.
 - E. THE CONTRACTOR SHALL BE RESPONSIBLE FOR COORDINATING ALL ACCESS ROADS WITH THE APPROPRIATE AGENCY RESPONSIBLE FOR THE ROADWAY.
 2. AN AREA WILL BE PROVIDED BY THE AIRPORT TO THE CONTRACTOR AS THE STAGING, STORAGE AND EMPLOYEE PARKING SITE, AT THE LOCATION SHOWN.

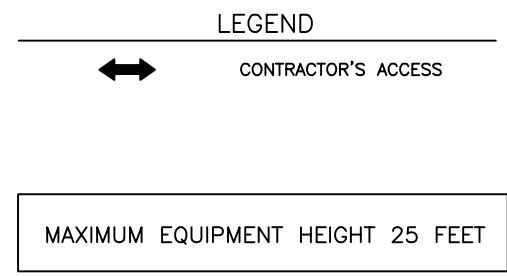

UNIVERSITY OF ILLINOIS
 WILLARD AIRPORT
 SAVOY, ILLINOIS

RELOCATE ENTRANCE ROADWAY &
 REHABILITATE OLD TERMINAL PARKING LOT
 AIRPORT SITE PLAN AND
 GENERAL NOTES

© Copyright CMT, Inc.
CMT
 CRAWFORD, MURPHY & TILLY, INC.
 CONSULTING ENGINEERS
 License No. 184-000613

DESIGN BY:	CBG
DRAWN BY:	CMT
CHECKED BY:	KLB
APPROVED BY:	CET
DATE:	4/19/2013
JOB No:	11059-05-00

K:\Champaign\1105905\Draw\Sheets