

F.A.U. ROUTE	SECTION	COUNTY	TOTAL SHEETS	SHEET NUMBER
9521	10-00051-00-SW	PERRY	33	24
CITY OF DUQUOIN		PROJECT NO. TE-0009(105)		
CONTRACT NO. 96499		JOB NO. C-99-512-11		

MORE THAN
MEMORIES
210 E. MAIN

KABINET HOUSE
212 E. MAIN

FAVORITE THINGS
216 1/2 E. MAIN

COUNTRY STORE
218 E. MAIN

GRAND THEATRE
220 E. MAIN

U.S. POST OFFICE

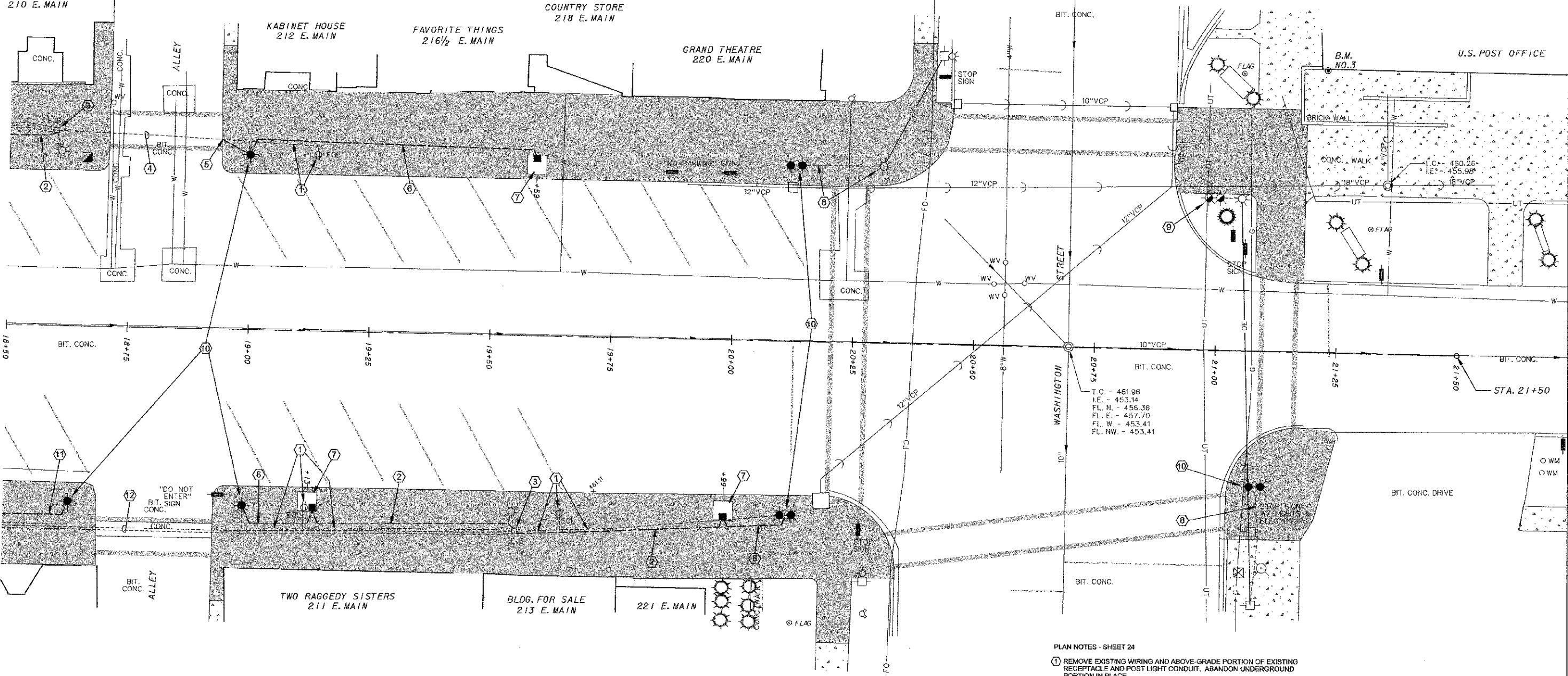

LEGEND

- | | | | | | |
|--|---|--|--------------------------------|--|----------------------------|
| | POWER POLE | | SANITARY SEWER AND MANHOLE | | FIBER OPTIC LINE |
| | POWER / TELEPHONE POLE | | C.O. - CLEAN OUT | | UNDERGROUND TELEPHONE LINE |
| | POWER / TELEPHONE POLE W/ LIGHT | | FIRE HYDRANT | | POST |
| | STREET LIGHT POLE | | W.V. - WATER VALVE | | ORNAMENTAL CONTAINER |
| | SINGLE / DOUBLE FIXTURE PEDESTRIAN LIGHT - 70W, HSP | | W.M. - WATER METER | | ORNAMENTAL SHRUB |
| | EXISTING ELECTRICAL JUNCTION BOX | | W.S.O. - WATER SERVICE SHUTOFF | | TREE W/ SIZE & TYPE |
| | PROPOSED ELECTRICAL JUNCTION BOX | | 6\"/> | | |

PLAN NOTES - SHEET 24

- REMOVE EXISTING WIRING AND ABOVE-GRADE PORTION OF EXISTING RECEPTACLE AND POST LIGHT CONDUIT. ABANDON UNDERGROUND PORTION IN PLACE.
- 3 - #10 (TWO 120V CIRCUITS), AND 1 - #10 EQUIPMENT GROUND IN 3/4\"/>

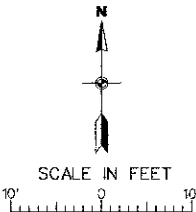

CITY OF DUQUOIN
PERRY COUNTY, ILLINOIS
MAIN STREET SIDEWALK REPLACEMENT
PROPOSED ELECTRICAL PLAN
STA. 18+50 TO STA. 21+50