

F.A.U. ROUTE	SECTION	COUNTY	TOTAL SHEETS	SHEET NUMBER
9521	10-00051-00-SW	PERRY	33	20
CITY OF DUQUOIN		PROJECT NO. TE-0009(105)		
CONTRACT NO. 99499		JOB NO. C-09-512-11		

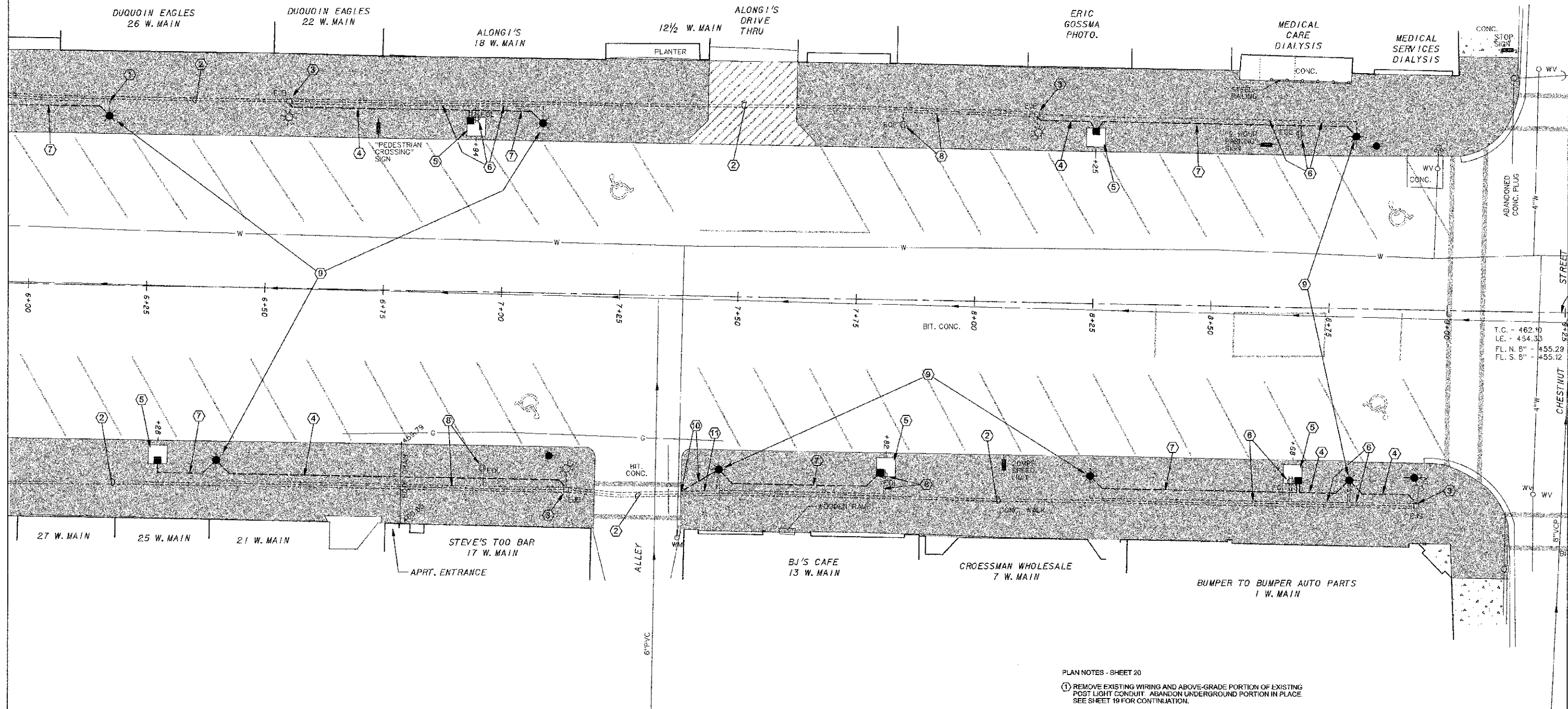

LEGEND

	- POWER POLE		- SANITARY SEWER AND MANHOLE		- FIBER OPTIC LINE
	- POWER / TELEPHONE POLE		- C.O. O - CLEAN OUT		- UT - UNDERGROUND TELEPHONE LINE
	- POWER / TELEPHONE POLE W/ LIGHT		- FIRE HYDRANT		- POST
	- STREET LIGHT POLE		- WVO - WATER VALVE		- SIGN
	- SINGLE / DOUBLE FIXTURE PEDESTRIAN LIGHT - 70W, HSP		- WMO - WATER METER		- ORNAVENTAL CONTAINER
	- EXISTING ELECTRICAL JUNCTION BOX		- WSO - WATER SERVICE SHUTOFF		- ORNAVENTAL SHRUB
	- PROPOSED ELECTRICAL JUNCTION BOX		- 6"W - WATER MAIN & SIZE		- TREE W/ SIZE & TYPE
	- EXISTING ELECTRICAL OUTLET		- G - GAS LINE		- TC - TOP OF CASTING - TOP OF CURB
	- EXISTING ELECTRICAL CONDUIT		- GV O - GAS VALVE		- INV. - INVERT
	- PROPOSED ELECTRICAL CIRCUIT		- GM O - GAS METER		- FL - FLOW LINE
	- OVERHEAD ELECTRIC LINE		- STORM SEWER & MANHOLE		- EXISTING CONCRETE SIDEWALK
	- ANCHOR		- STORM SEWER & INLET		- PROPOSED PCC SIDEWALK
	- TRAFFIC CONTROL LIGHT				
	- RAILROAD CROSSING GATE				

PLAN NOTES - SHEET 20

- REMOVE EXISTING WIRING AND ABOVE-GRADE PORTION OF EXISTING POST LIGHT CONDUIT. ABANDON UNDERGROUND PORTION IN PLACE. SEE SHEET 19 FOR CONTINUATION.
- EXISTING 2 - 2" PVC AND WIRING TO REMAIN; LOCATE AND AVOID DAMAGE TO SAME.
- TYPICAL EXISTING ELECTRIC JUNCTION BOX (EJB) TO REMAIN. DISCONNECT AND REMOVE EXISTING WIRING AS NOTED TO EXISTING POST LIGHTS AND RECEPTACLES. PROVIDE NEW WIRING TAPPED TO THE EXISTING FEEDERS IN THE EJB, WITH WATERPROOF SPLICES. SEE TYPICAL SCHEMATIC, SHEET 25.
- 3 - #10 (TWO 120 VOLT CIRCUITS PLUS NEUTRAL), AND 1 - #10 EQUIPMENT GROUND IN 3/4" PVC FROM EJB TO PROPOSED TREE GRATE JUNCTION BOX OR POST LIGHT AS SHOWN.
- SEE DETAIL SHEET 25 FOR PROPOSED WIRING IN TREE GRATES.
- REMOVE EXISTING WIRING AND ABOVE-GRADE PORTION OF EXISTING RECEPTACLE CONDUIT. ABANDON UNDERGROUND PORTION IN PLACE.
- 2 - #10, AND 1 - #10 EQUIPMENT GROUND IN NEW 3/4" PVC FROM TREE GRATE JUNCTION BOX TO POST LIGHT.
- REMOVE EXISTING WIRING AND ABOVE-GRADE PORTION OF EXISTING RECEPTACLE CONDUIT. ABANDON UNDERGROUND PORTION IN PLACE.
- REMOVE EXISTING POST LIGHT ASSEMBLY AND REINSTALL ON PROPOSED CONCRETE BASE PER DETAIL SHEET 3. PROVIDE FUSING FOR LIGHT FEED PER SCHEMATIC, SHEET 25.
- LOCATE, AND INTERCEPT EXISTING 3/4" PVC AT POINT INDICATED. EXTEND PROPOSED CONDUIT FROM THIS POINT TO THE POST LIGHT. REMOVE EXISTING CONDUCTORS AND REPLACE WITH 3 - #10 TWO 120 VOLT CIRCUITS PLUS NEUTRAL, AND 1 - #10 EQUIPMENT GROUND IN 3/4" PVC TO THE POST LIGHT.
- REMOVE ABOVE-GRADE PORTION OF THE EXISTING POST LIGHT CONDUIT.

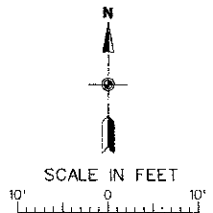

CITY OF DUQUOIN
PERRY COUNTY, ILLINOIS
MAIN STREET SIDEWALK REPLACEMENT
PROPOSED ELECTRICAL PLAN
STA. 6+00 TO STA. 9+25