

F.A.U. ROUTE	SECTION	COUNTY	TOTAL SHEETS	SHEET NUMBER
9521	10-00051-00-SW	PERRY	33	6
CITY OF DUQUOIN		PROJECT NO. TE-0009(105)		
CONTRACT NO. 99499		JOB NO. C-99-512-11		

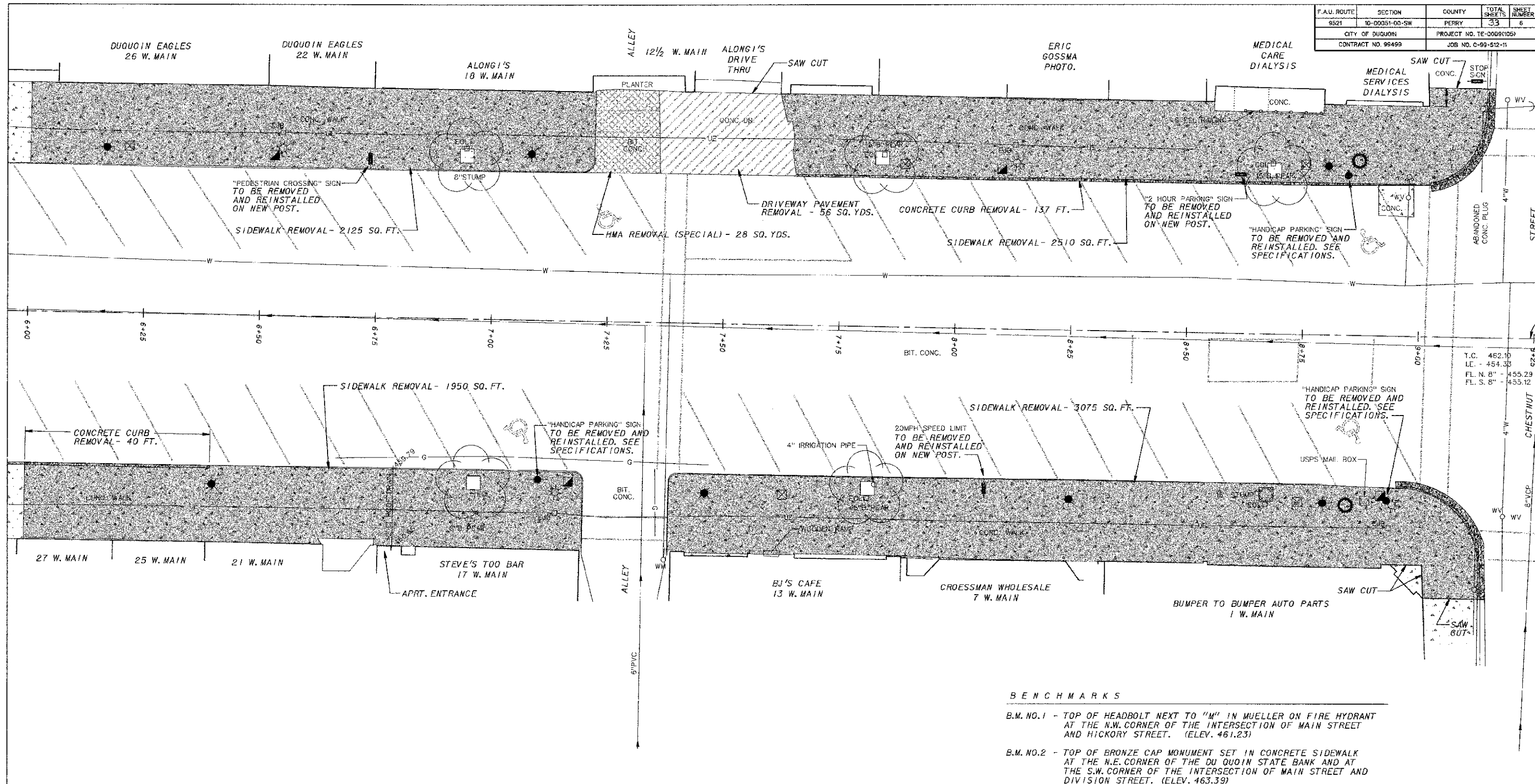

BENCHMARKS

- B.M. NO.1 - TOP OF HEADBOLT NEXT TO "M" IN MUELLER ON FIRE HYDRANT AT THE N.W. CORNER OF THE INTERSECTION OF MAIN STREET AND HICKORY STREET. (ELEV. 461.23)
- B.M. NO.2 - TOP OF BRONZE CAP MONUMENT SET IN CONCRETE SIDEWALK AT THE N.E. CORNER OF THE DU QUOIN STATE BANK AND AT THE S.W. CORNER OF THE INTERSECTION OF MAIN STREET AND DIVISION STREET. (ELEV. 463.39)

LEGEND

	- POWER POLE		- FIBER OPTIC LINE		- STORM SEWER & MANHOLE		- ORNAMENTAL CONTAINER TO BE REMOVED AND REINSTALLED BY OTHERS
	- POWER / TELEPHONE POLE		- UNDERGROUND TELEPHONE LINE		- STORM SEWER & INLET		- TREE OR STUMP W/ SIZE & TYPE TO BE REMOVED
	- POWER / TELEPHONE POLE W/ LIGHT		- SANITARY SEWER AND MANHOLE		- RAILROAD CROSSING GATE		- MONITORING WELL
	- STREET LIGHT POLE TO REMAIN		- CLEAN OUT		- TRAFFIC CONTROL LIGHT		- TOP OF CASTING - TOP OF CURB
	- SINGLE FIXTURE PEDESTRIAN LIGHT TO BE REMOVED AND REINSTALLED		- FIRE HYDRANT		- TRASH CAN TO BE REMOVED AND REINSTALLED BY OTHERS		- INVERT
	- DOUBLE FIXTURE PEDESTRIAN LIGHT TO BE REMOVED AND REINSTALLED		- WATER VALVE		- ABANDON CONC. LIGHT STANDARD BASE		- FLOW LINE
	- ANCHOR		- WATER METER		- POST		- EXISTING CONCRETE SIDEWALK
	- ELECTRICAL JUNCTION BOX		- WATER SERVICE SHUTOFF		- SIGN		- PROPOSED SIDEWALK REMOVAL
	- ELECTRICAL OUTLET		- WATER MAIN & SIZE		- HANDICAP PARKING SIGN TO BE REMOVED AND REINSTALLED		- PROPOSED CURB/CURB & GUTTER REMOVAL
	- ELECTRICAL CONDUIT		- GAS LINE		- LANDSCAPE STONE/BOULDER		- PROPOSED DRIVEWAY PAVEMENT REMOVAL
	- UNDERGROUND ELECTRIC LINE		- GAS VALVE		- ORNAMENTAL SHRUB		- PROPOSED BITUMINOUS PAVEMENT REMOVAL
			- GAS METER				

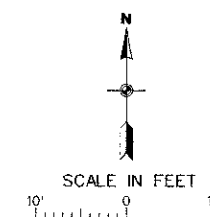

CITY OF DUQUOIN
PERRY COUNTY, ILLINOIS
MAIN STREET SIDEWALK REPLACEMENT
EXISTING SITE AND REMOVAL PLAN
STA. 6+00 TO STA. 9+00