

VILLAGE OF GODFREY  
PPN: 24-1-01-27-00-000-004

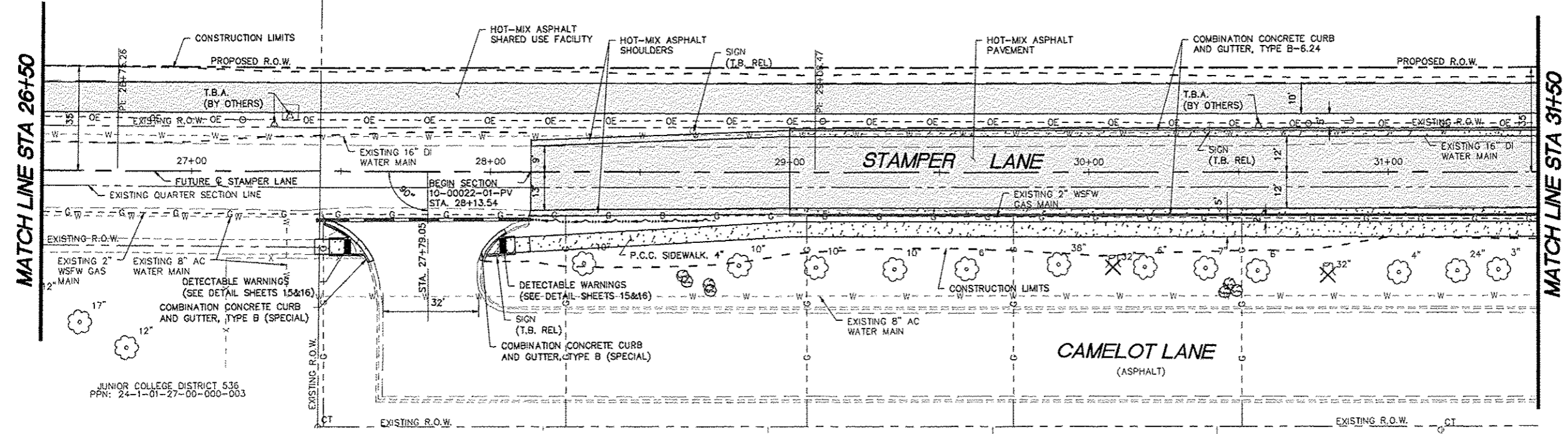

JUNIOR COLLEGE DISTRICT 536  
PPN: 24-1-01-27-00-000-003

\*UNLESS OTHERWISE NOTED @ PROFILE OF SHARED-USE PATH IS 0.35 FT ABOVE PROPOSED ROADWAY AND FUTURE STAMPER LANE @ PROFILE.

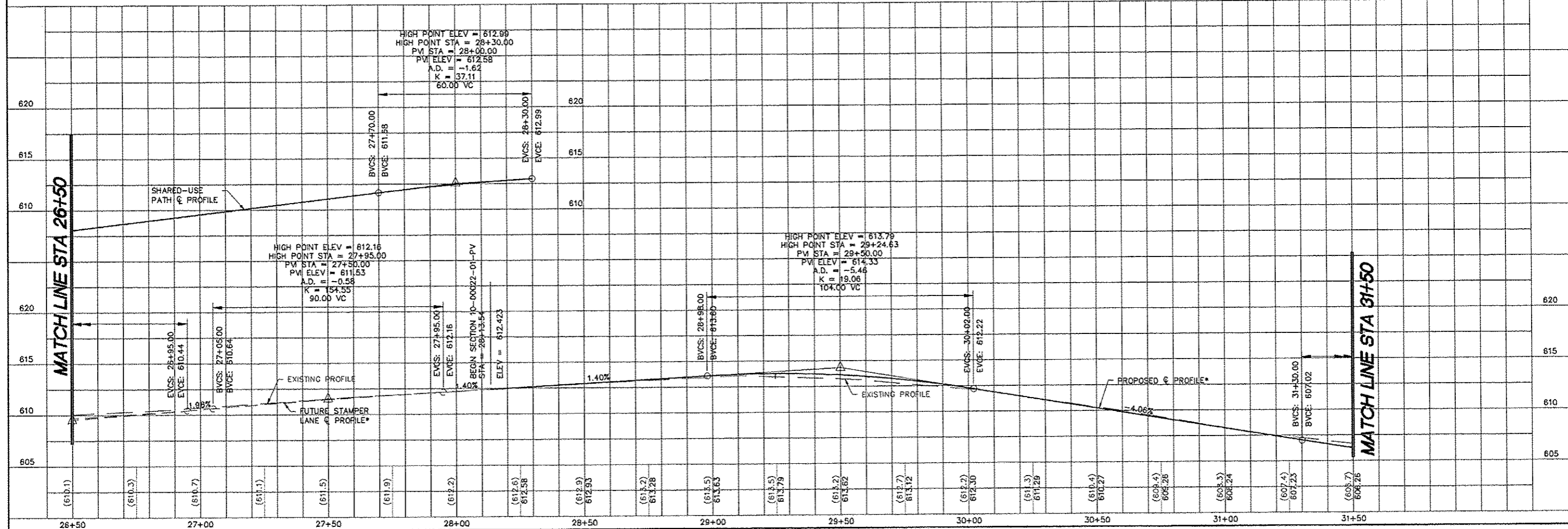

REVISIONS

**SMS ENGINEERS**  
Sheppard, Morgan & Schwaab, Inc.  
CONSULTING ENGINEERS AND LAND SURVEYORS  
215 Market Street, P.O. Box 11, 50002, El Paso, TX 79962-3715, E-mail: [msm@smsengineers.com](mailto:msm@smsengineers.com)  
10 Central Expressway, Suite 3, Granite City, IL 62040, 61837-5100, E-mail: [msm@smsengineers.com](mailto:msm@smsengineers.com)  
DESIGN FIRM # 184-000992

DWG. NO. \_\_\_\_\_  
DATE: MARCH, 2013  
SCALE: HORT: 1"=20'  
VERT: 1"=5'

REF. BK.	PG.
JOB NO.	438439
DSN. BY:	SW
DWN. BY:	BCS
CHK. BY:	SW

SHEET 7 OF 80