

ROUTE	SECTION	COUNTY	TOTAL SHEETS	SHEET NO.
FAS 680 (CH 4)	12-00111-00-RS	EDGAR	27	8
EDGAR COUNTY, ILLINOIS			CONTRACT NO. 91485	
FFO. AID PROJECT				

UTILITIES LOCATED WITHIN SECTION			
Utility Company	Type	Location	Relocation Required
Clark Edgar Rural Water	Buried Water	Throughout Project	None
Enerstar Power Corp.	Aerial Electric	Throughout Project	None
Frontier Communications	Buried Telephone	Throughout Project	None

SECTION 12-00111-00-RS  
PROJECT RS-0680 (110)  
BEGINS STATION 14+75

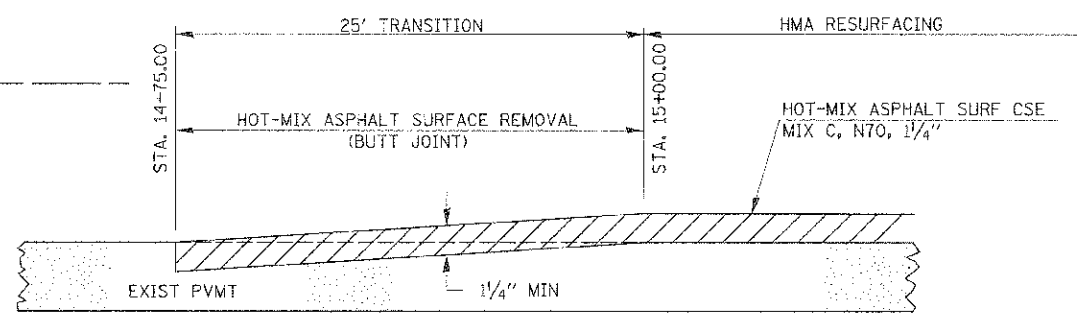
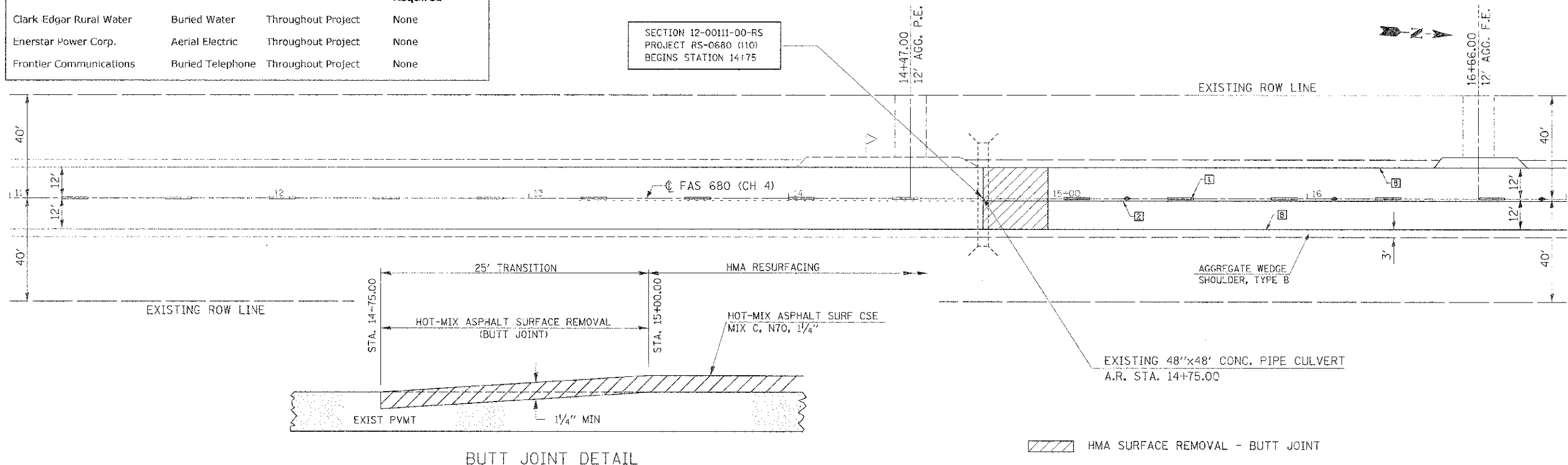

BUTT JOINT DETAIL

EXISTING 48"x48' CONC. PIPE CULVERT  
A.R. STA. 14+75.00

EXIST. CURVE LOWER-1  
PI STA. = 20+93.57  
 $\Delta = 21^\circ 11' 37''$  (L7)  
D = 3° 24' 00"  
R = 1,585.17'  
T = 315.36'  
L = 623.51'  
E = 29.25'  
P.C. STA. = 17+78.21  
P.T. STA. = 24+01.72

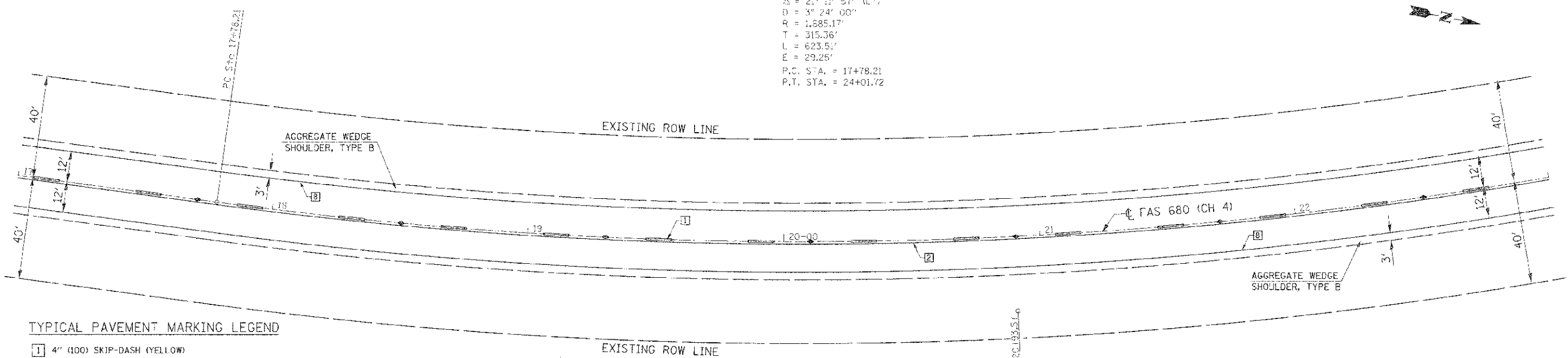

TYPICAL PAVEMENT MARKING LEGEND

- 1 4" (100) SKIP-DASH (YELLOW)
- 2 4" (100) SOLID (YELLOW)
- 3 12" (300) DIAGONAL (YELLOW)
- 4 4" (100) DOUBLE YELLOW (NARROW)
- 6 4" (100) SOLID (WHITE)

TYPICAL PAVEMENT MARKERS LEGEND

- ◆ TWO-WAY AMBER MARKER
- ▶ ONE-WAY AMBER MARKER
- ▷ ONE-WAY CRYSTAL MARKER

PLAN  
SCALE: 1" = 20'



EDGAR COUNTY  
HIGHWAY DEPARTMENT

FILE 8