

\*Dimensions Perpendicular to  $\odot$  Roadway  
 \*\*Trim to fit where required.  
 \*\*\*Bend to fit.

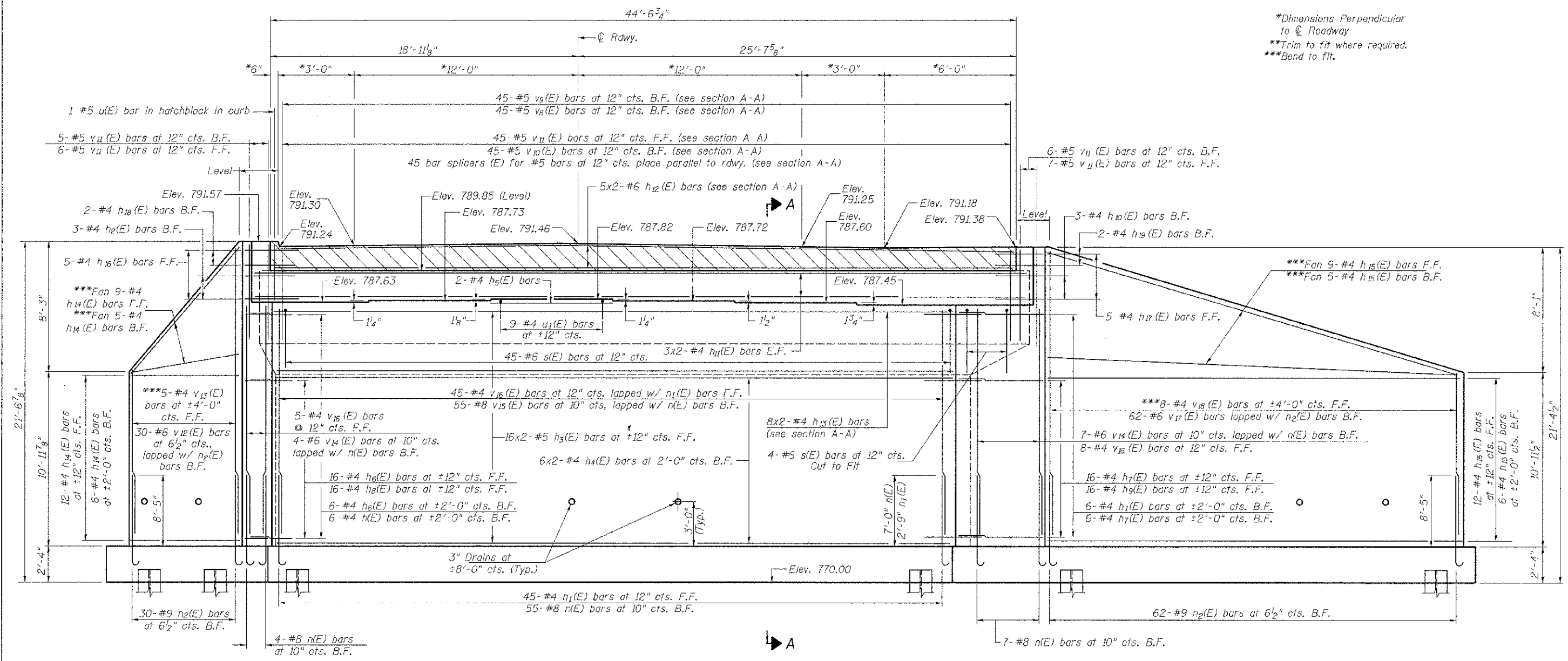

**ELEVATION**  
(Looking South)

**Notes:**  
 See sheet 22 of 28 for Section A-A, Bar Details & Bill of Materials.  
 Pour steps monolithically with cap.  
 Hatched area to be poured after superstructure is in place.  
 See sheet 21 of 28 for footing details, pile locations & anchor bolt layout.  
 Space reinforcement in cap to miss anchor bolts.  
 See sheet 19 of 28 for anchor bolt details.

**MIN. BAR LAP**  
 (Vertical)  
 #4 bar = 2'-7"  
 #6 bar = 3'-10"  
 #8 bar = 6'-9"  
 (Horizontal)  
 #4 bar = 2'-0"  
 #5 bar = 2'-6"  
 #6 bar = 3'-0"

FILE NAME - V:\2555\CADD SHEETS\STRUCTURES - Rec'd	USER NAME = amountst	DESIGNED BAN	REVISED -	<b>DEKALB COUNTY</b> <b>C.H. 26 (FIVE POINTS RD.)</b> <b>OVER SOUTH BRANCH OF KISHWAUKEE RIVER</b>	<b>SOUTH ABUTMENT</b>	RTE. NO.	SECTION	COUNTY	TOTAL SHEETS	SHEET NO.	
	02-27-2013\2555\E20.dgn	DRAWN TAC	REVISED -			CH 26	05-00044-01-BR	DEKALB	49	35	
	PLOT SCALE = NONE	CHECKED CTM	REVISED -			CONTRACT NO. 87477					
	PLOT DATE = 3/26/2013	DATE -	REVISED -			SCALE: N/A	SHEET NO. 20 OF 26 SHEETS	STA. N/A	TO STA. N/A	ILLINOIS FED. AID PROJECT BR3-11221089	