

\* EXISTING TOPOGRAPHY & R.O.W. LIMITS PROHIBIT WIDENING OF SIDEWALKS TO CURRENT IDOT STANDARDS

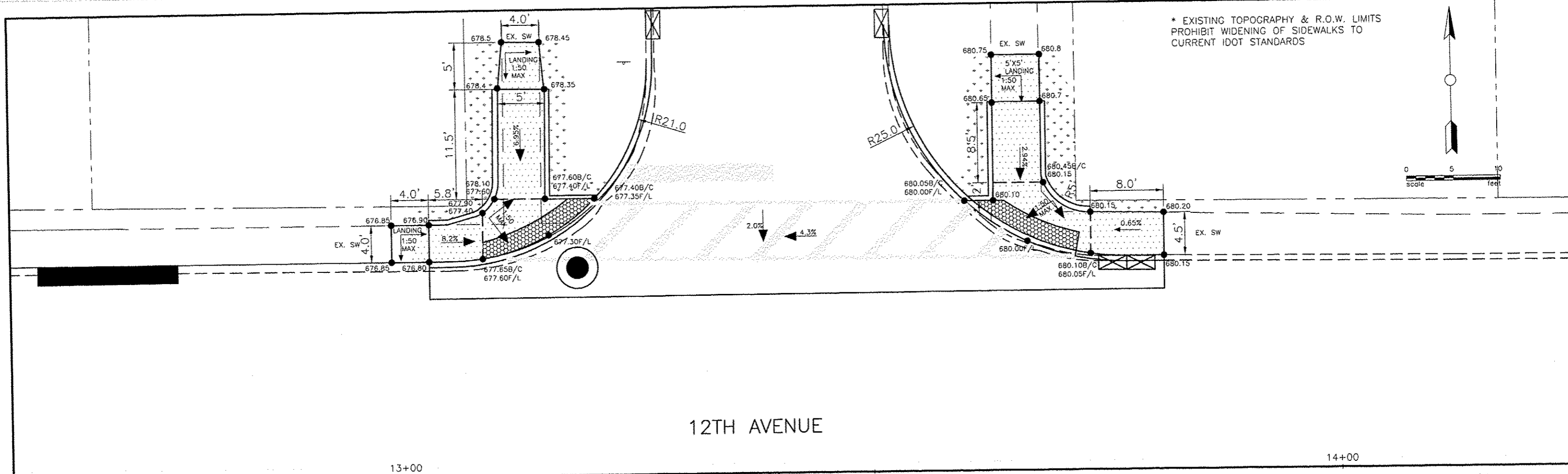
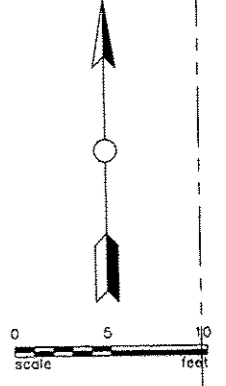

12TH AVENUE

13+00

14+00

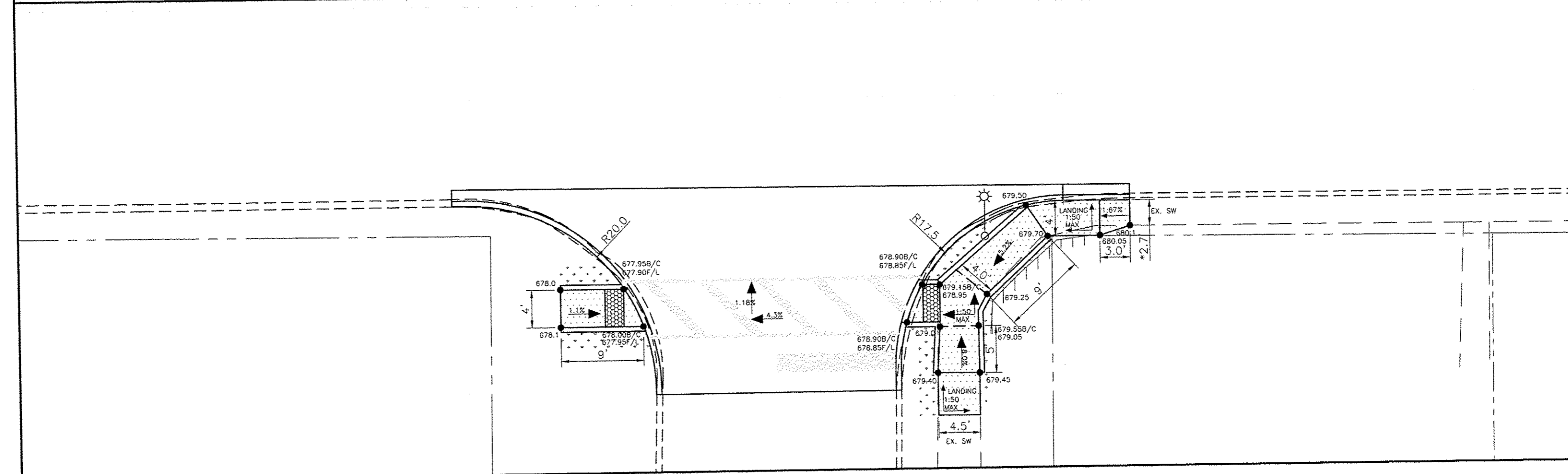

CITY OF MOLINE  
 DEPARTMENT OF PUBLIC WORKS - ENGINEERING DIVISION  
 3635 4TH AVENUE, MOLINE, IL 61265  
 (309) 524-2350  
 CITY ENGINEER - SCOTT HINTON, P.E.

12TH AVENUE OVERLAY  
 19TH STREET TO 34TH STREET  
 SIDEWALKS (25TH STREET)

Date	Revision
3-21-13	IDOT COMMENTS

Date	2-20-12	Sheet	10
Scale	1:5	of	40
Design Engineer	JWC	Project	MFT 254