

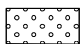





LEGEND

-  SEEDING, CLASS 2A AND TEMPORARY EROSION CONTROL SEEDING
-  EROSION CONTROL BLANKET AND TEMPORARY EROSION CONTROL BLANKET
-  RIPRAP
-  AGGREGATE DITCH
-  TEMPORARY DITCH CHECK
-  INLET & PIPE PROTECTION
-  PERIMETER EROSION BARRIER

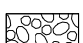

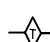
FILE NAME = F:\Projects\1DOT PROJECTS\09-101-11.4\Drawings\CADD Sheets\Contract 2\104.D876817-sh	USER NAME = Richard Heinke	DESIGNED - JAH	REVISED -
		DRAWN - RNH	REVISED -
		CHECKED - TMM	REVISED -
		DATE -	REVISED -

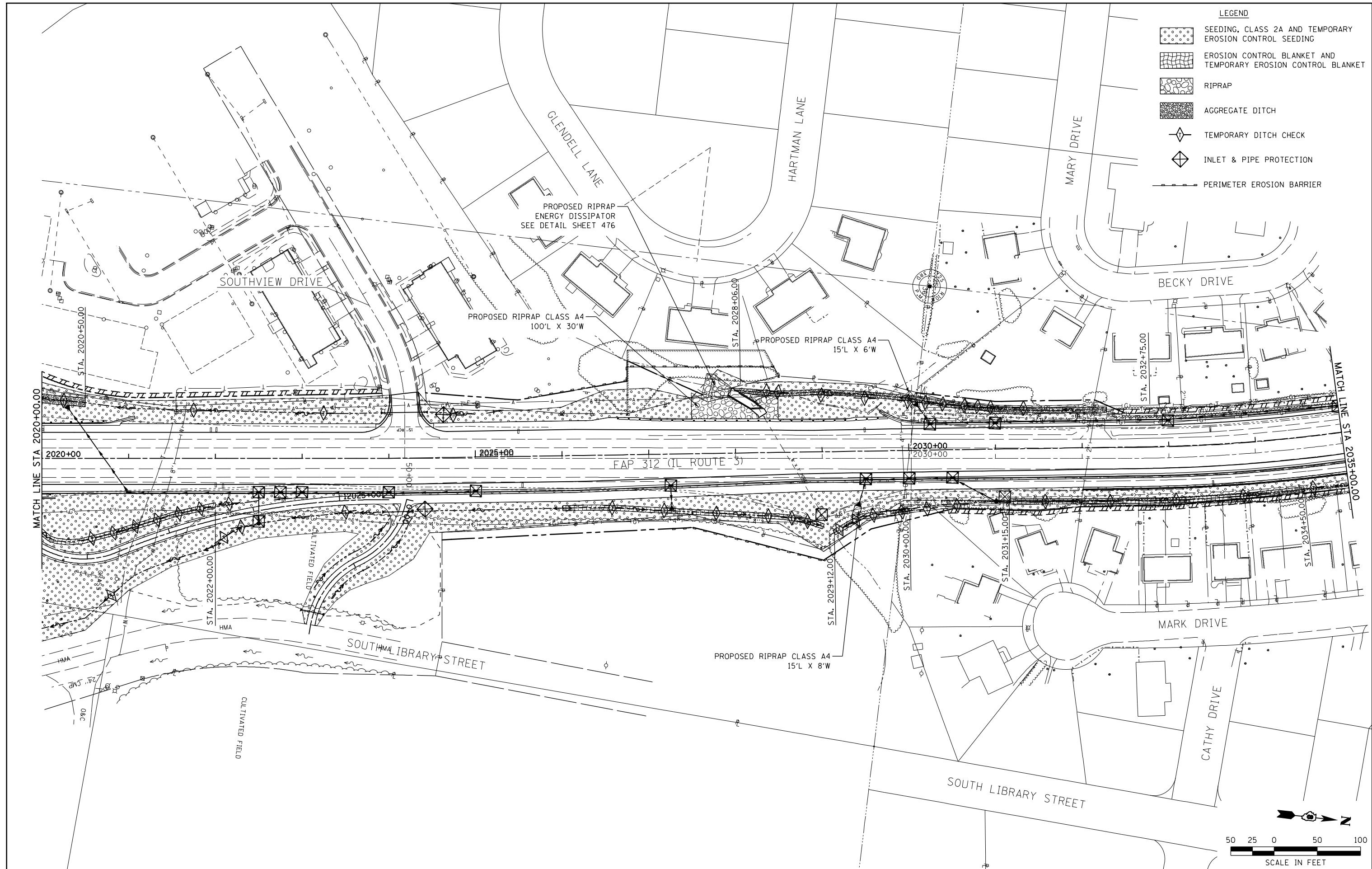
**STATE OF ILLINOIS
DEPARTMENT OF TRANSPORTATION**

McDonough-Whillow, P.C.
PROFESSIONAL DESIGN NO. 184-022754
SCALE: 1" = 50'

EROSION CONTROL PLAN
IL ROUTE 3
SHEET NO. 4 OF 19 SHEETS
STA. 2020+00.00 TO STA. 2035+00.00

F.A.P. RTE. 312	SECTION 68-WRS-1	COUNTY MONROE	TOTAL SHEETS 760	SHEET NO. 212
CONTRACT NO. 76817				ILLINOIS FED. AID PROJECT