

# STAGE 1B - CONSTRUCTION ACTIVITIES

CONSTRUCT PCC ISLAND IN NORTHWEST QUADRANT

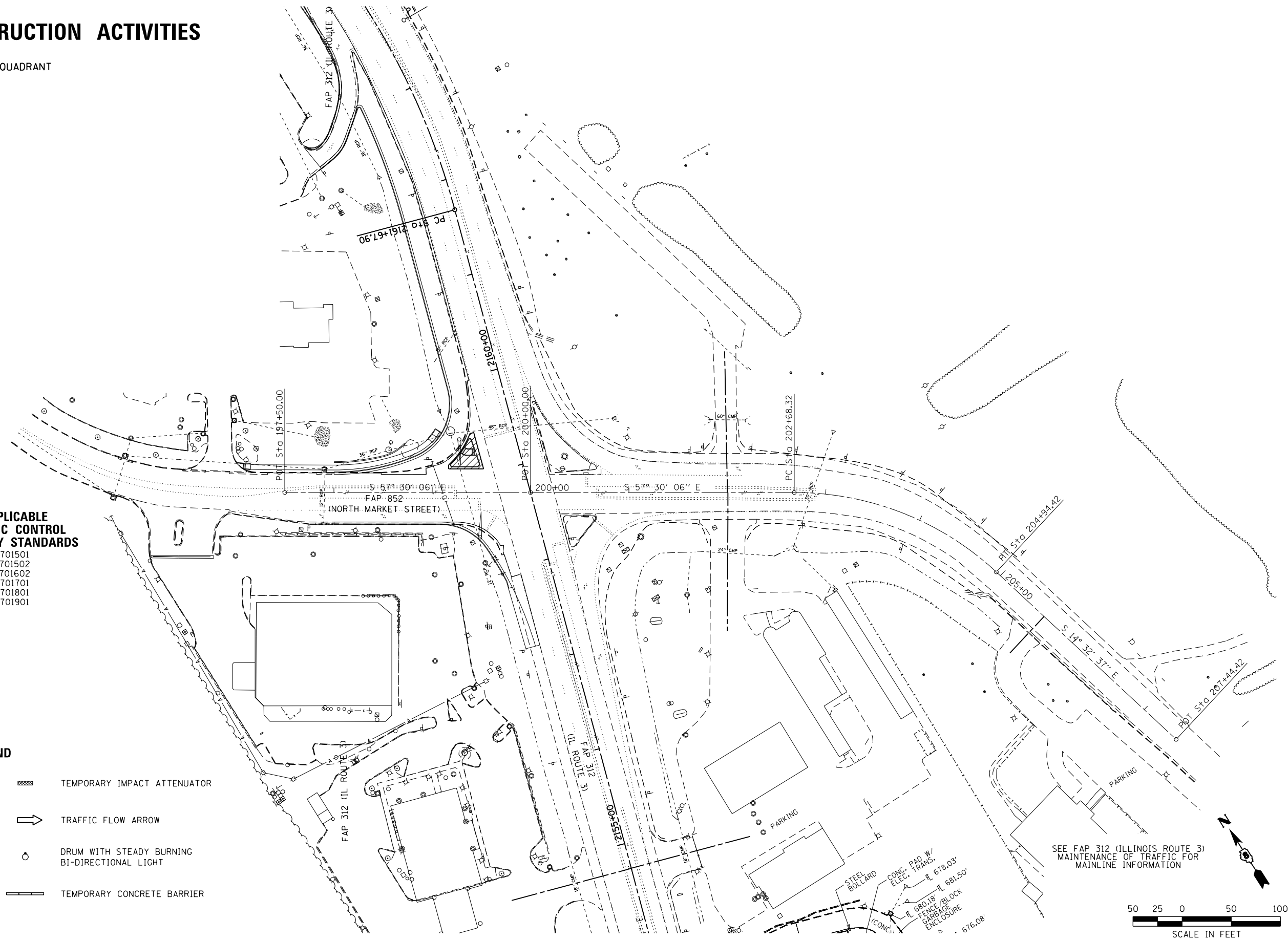

### APPLICABLE TRAFFIC CONTROL HIGHWAY STANDARDS

- 701501
- 701502
- 701602
- 701701
- 701801
- 701901

### LEGEND

- |  |                       |  |   |
|--|-----------------------|--|---|
|  | TEMPORARY PAVEMENT    |  | TEMPORARY IMPACT ATTENUATOR                   |
|  | PRESTAGE CONSTRUCTION |  | TRAFFIC FLOW ARROW                            |
|  | STAGE 1 CONSTRUCTION  |  | DRUM WITH STEADY BURNING BI-DIRECTIONAL LIGHT |
|  | STAGE 2 CONSTRUCTION  |  | TEMPORARY CONCRETE BARRIER                    |
|  | STAGE 3 CONSTRUCTION  |  |   |

SEE FAP 312 (ILLINOIS ROUTE 3) MAINTENANCE OF TRAFFIC FOR MAINLINE INFORMATION



LAST SAVED = 1/23/2013  
 PEN TABLE = V8-244-441  
 PLOT DRIVER = pdfnclayershp21.ctb

FILE NAME =	USER NAME = beriechmann	DESIGNED -	REVISED -
I:\1001100\Phase II - 76817\Cad\T\Plans\071.D876817-sht-Staging-1B-NMarket.dgn		DRAWN -	REVISED -
		CHECKED -	REVISED -
		DATE -	REVISED -
	PLOT DATE = 1/25/2013 3:31:35 PM		

STATE OF ILLINOIS  
DEPARTMENT OF TRANSPORTATION

**HORNER & SHIRIN, INC.**  
ENGINEERS

**SUGGESTED STAGES OF CONSTRUCTION AND TRAFFIC CONTROL**  
STAGE 1B - NORTH MARKET STREET

SCALE: 1" = 50' SHEET NO. 44 OF 46 SHEETS STA. 2108+00.00 TO STA. 2122+00.00

F.A.P. RTE.	SECTION	COUNTY	TOTAL SHEETS	SHEET NO.
312	68-WRS-1	MONROE	760	203
				CONTRACT NO. 76817

ILLINOIS FED. AID PROJECT