

STAGE 1A - CONSTRUCTION ACTIVITIES

REMOVE & RECONSTRUCT NORTH 1/2 OF SOUTHVIEW DRIVE



APPLICABLE TRAFFIC CONTROL HIGHWAY STANDARDS

- 701001
- 701006
- 701011
- 701201
- 701206
- 701301
- 701306
- 701311
- 701326
- 701336
- 701901

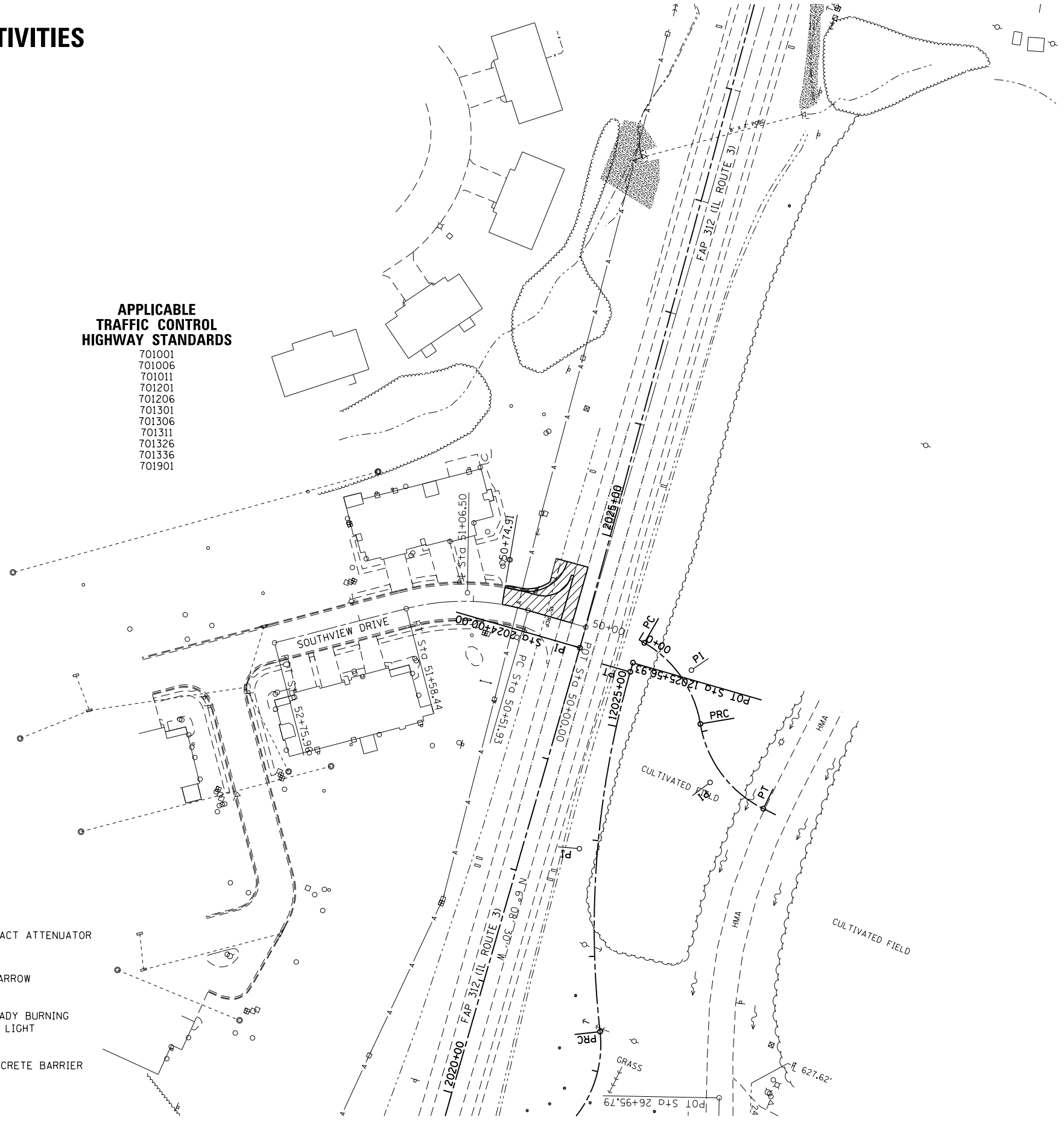

LEGEND

- | | | | |
|--|-----------------------|--|---|
| | TEMPORARY PAVEMENT | | TEMPORARY IMPACT ATTENUATOR |
| | PRESTAGE CONSTRUCTION | | TRAFFIC FLOW ARROW |
| | STAGE 1 CONSTRUCTION | | DRUM WITH STEADY BURNING BI-DIRECTIONAL LIGHT |
| | STAGE 2 CONSTRUCTION | | TEMPORARY CONCRETE BARRIER |
| | STAGE 3 CONSTRUCTION | | |

SEE FAP 312 (ILLINOIS ROUTE 3) MAINTENANCE OF TRAFFIC FOR MAINLINE INFORMATION

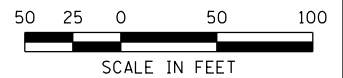

LAST SAVED = 1/22/2013
 PEN TABLE = W24414141
 PLOT DRIVER = pdfplotlayers.pltcf9

FILE NAME =	USER NAME = beriechmann	DESIGNED -	REVISED -
I:\1001100\Phase II - 76817\Cad\T\Plans\065_0876817-sht-Staging-1A-Southview.dgn		DRAWN -	REVISED -
	PLOT SCALE = 100.0000' / 1"	CHECKED -	REVISED -
	PLOT DATE = 1/25/2013 3:31:00 PM	DATE -	REVISED -

STATE OF ILLINOIS
DEPARTMENT OF TRANSPORTATION



SUGGESTED STAGES OF CONSTRUCTION AND TRAFFIC CONTROL
STAGE 1A - SOUTHVIEW DRIVE

SCALE: 1" = 50' SHEET NO. 20 OF 46 SHEETS STA. 2108+00.00 TO STA. 2122+00.00

F.A.P. RTE.	SECTION	COUNTY	TOTAL SHEETS	SHEET NO.
312	68-WRS-1	MONROE	760	179
				CONTRACT NO. 76817
ILLINOIS FED. AID PROJECT				