

STAGE 2B - CONSTRUCTION ACTIVITIES

MAINTAIN EXISTING LEFT/THRU LANE
 SHIFT RIGHT TURNING TRAFFIC TO COMPLETED WIDENING
 CONSTRUCT PCC ISLAND IN NORTHEAST QUADRANT

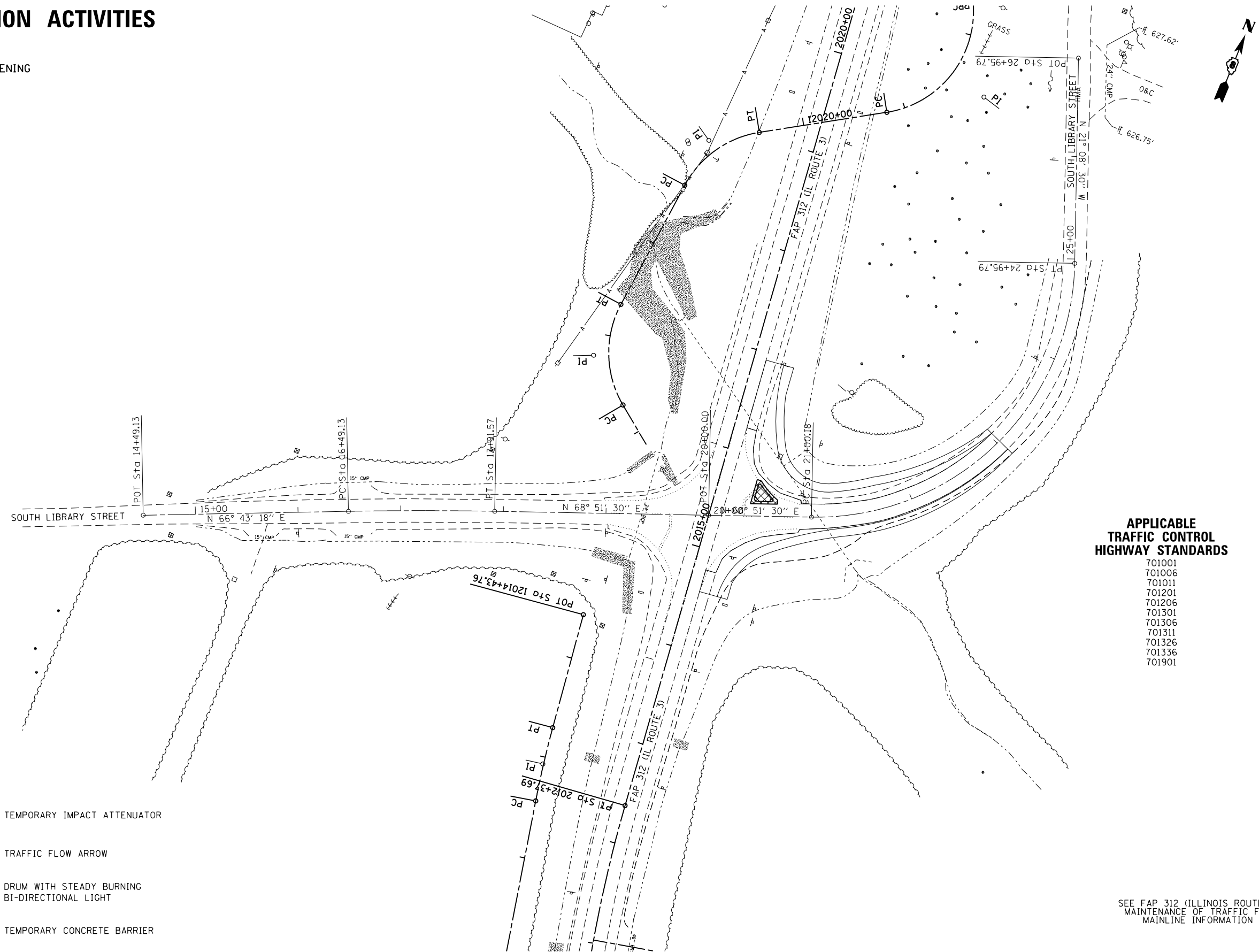

APPLICABLE TRAFFIC CONTROL HIGHWAY STANDARDS

- 701001
- 701006
- 701011
- 701201
- 701206
- 701301
- 701306
- 701311
- 701326
- 701336
- 701901

LEGEND

- | | | | |
|--|-----------------------|--|---|
| | TEMPORARY PAVEMENT | | TEMPORARY IMPACT ATTENUATOR |
| | PRESTAGE CONSTRUCTION | | TRAFFIC FLOW ARROW |
| | STAGE 1 CONSTRUCTION | | DRUM WITH STEADY BURNING BI-DIRECTIONAL LIGHT |
| | STAGE 2 CONSTRUCTION | | TEMPORARY CONCRETE BARRIER |
| | STAGE 3 CONSTRUCTION | | |

SEE FAP 312 (ILLINOIS ROUTE 3)
 MAINTENANCE OF TRAFFIC FOR
 MAINLINE INFORMATION

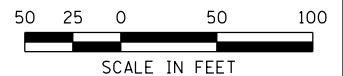

LAST SAVED = 1/22/2013
 PEN TABLE = W:\444\441
 PLOT DRIVER = pdfplotlayers.pltcf9

FILE NAME =	USER NAME = beriechmann	DESIGNED -	REVISED -
I:\10011100\Phase II - 76817\Cad\T\Plans\064_0876817-sht-Staging-2B-Library.dgn		DRAWN -	REVISED -
	PLOT SCALE = 100.0000' / 1"	CHECKED -	REVISED -
	PLOT DATE = 1/25/2013 3:30:59 PM	DATE -	REVISED -

STATE OF ILLINOIS
 DEPARTMENT OF TRANSPORTATION

HORNER &
 SHIRIN, INC.
 ENGINEERS

SUGGESTED STAGES OF CONSTRUCTION
 AND TRAFFIC CONTROL
 STAGE 2B - SOUTH LIBRARY STREET

SCALE: 1" = 50'

SHEET NO. 19 OF 46 SHEETS STA. 2108+00.00 TO STA. 2122+00.00

F.A.P. RTE.	SECTION	COUNTY	TOTAL SHEETS	SHEET NO.
312	68-WRS-1	MONROE	760	178
				CONTRACT NO. 76817
ILLINOIS FED. AID PROJECT				