

STAGE 2A - CONSTRUCTION ACTIVITIES

MAINTAIN EXISTING TRAFFIC LANES & PATTERNS
CONSTRUCT WIDENING & SHOULDER ALONG EAST LEG OF SOUTH LIBRARY STREET

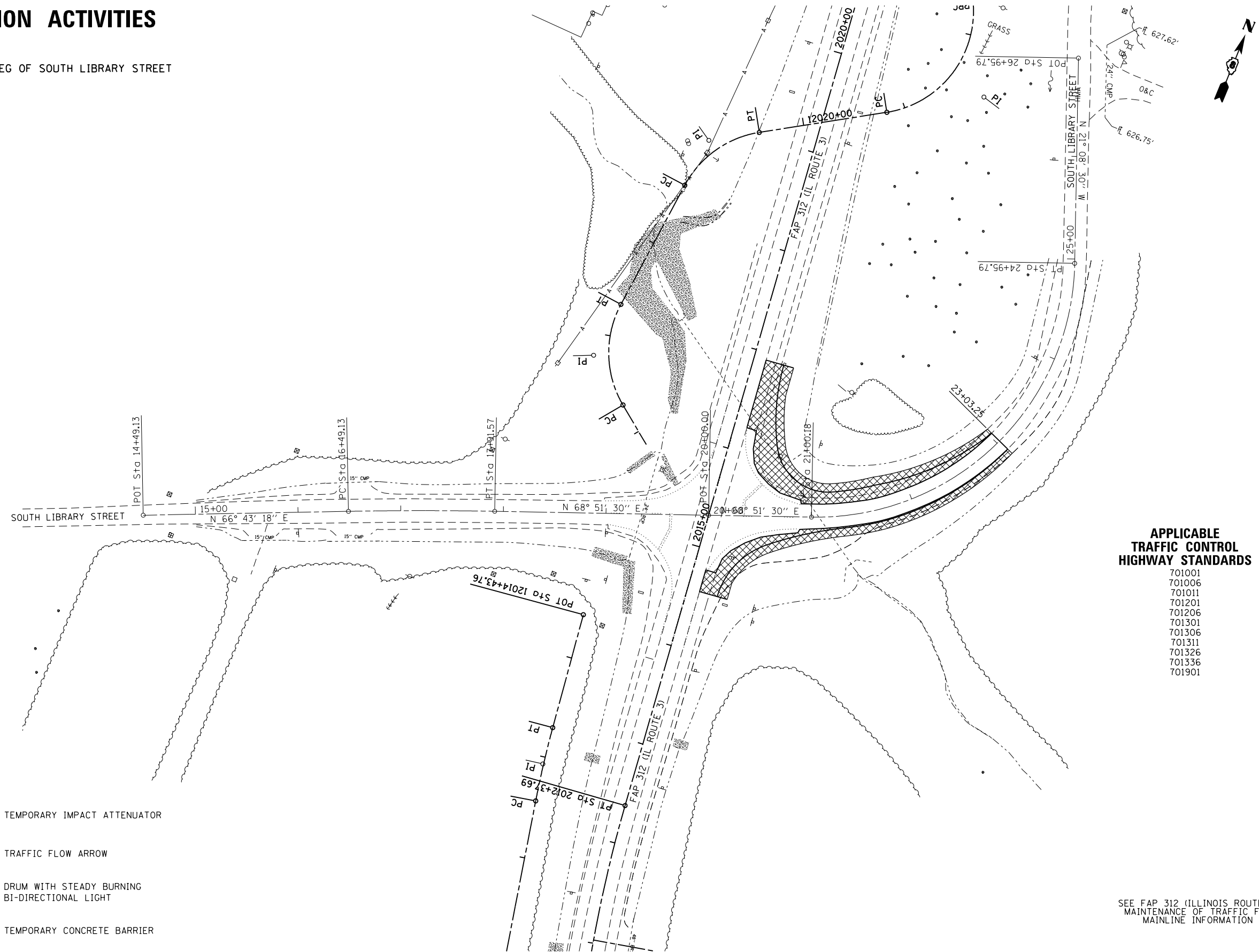

APPLICABLE TRAFFIC CONTROL HIGHWAY STANDARDS

- 701001
- 701006
- 701011
- 701201
- 701206
- 701301
- 701306
- 701311
- 701326
- 701336
- 701901

LEGEND

- TEMPORARY PAVEMENT
- PRESTAGE CONSTRUCTION
- STAGE 1 CONSTRUCTION
- STAGE 2 CONSTRUCTION
- STAGE 3 CONSTRUCTION
- TEMPORARY IMPACT ATTENUATOR
- TRAFFIC FLOW ARROW
- DRUM WITH STEADY BURNING BI-DIRECTIONAL LIGHT
- TEMPORARY CONCRETE BARRIER

SEE FAP 312 (ILLINOIS ROUTE 3) MAINTENANCE OF TRAFFIC FOR MAINLINE INFORMATION

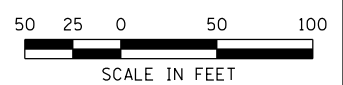

LAST SAVED = 1/22/2013
 PEN TABLE = W2444141
 PLOT DRIVER = pdfplotlayers.pltcf9

FILE NAME =	USER NAME = beriechmann	DESIGNED -	REVISED -
I:\10011100\Phase II - 76817\Cad\T\Plans\064_0876817-sht-Staging-2A-Library.dgn		DRAWN -	REVISED -
	PLOT SCALE = 100.0000' / 1"	CHECKED -	REVISED -
	PLOT DATE = 1/25/2013 3:30:58 PM	DATE -	REVISED -

STATE OF ILLINOIS
DEPARTMENT OF TRANSPORTATION

HORNER & SHIRIN, INC.
ENGINEERS

SUGGESTED STAGES OF CONSTRUCTION AND TRAFFIC CONTROL
STAGE 2A - SOUTH LIBRARY STREET

SCALE: 1" = 50' SHEET NO. 18 OF 46 SHEETS STA. 2108+00.00 TO STA. 2122+00.00

F.A.P. RTE.	SECTION	COUNTY	TOTAL SHEETS	SHEET NO.
312	68-WRS-1	MONROE	760	177
				CONTRACT NO. 76817
ILLINOIS FED. AID PROJECT				