

# SGATE 1B - CONSTRUCTION ACTIVITIES

MAINTAIN EXISTING LEFT/THRU LANE  
 SHIFT RIGHT TURNING TRAFFIC TO COMPLETED WIDENING  
 CONSTRUCT PCC ISLAND IN SOUTHWEST QUADRANT

## APPLICABLE TRAFFIC CONTROL HIGHWAY STANDARDS

- 701001
- 701006
- 701011
- 701201
- 701206
- 701301
- 701306
- 701311
- 701326
- 701336
- 701901

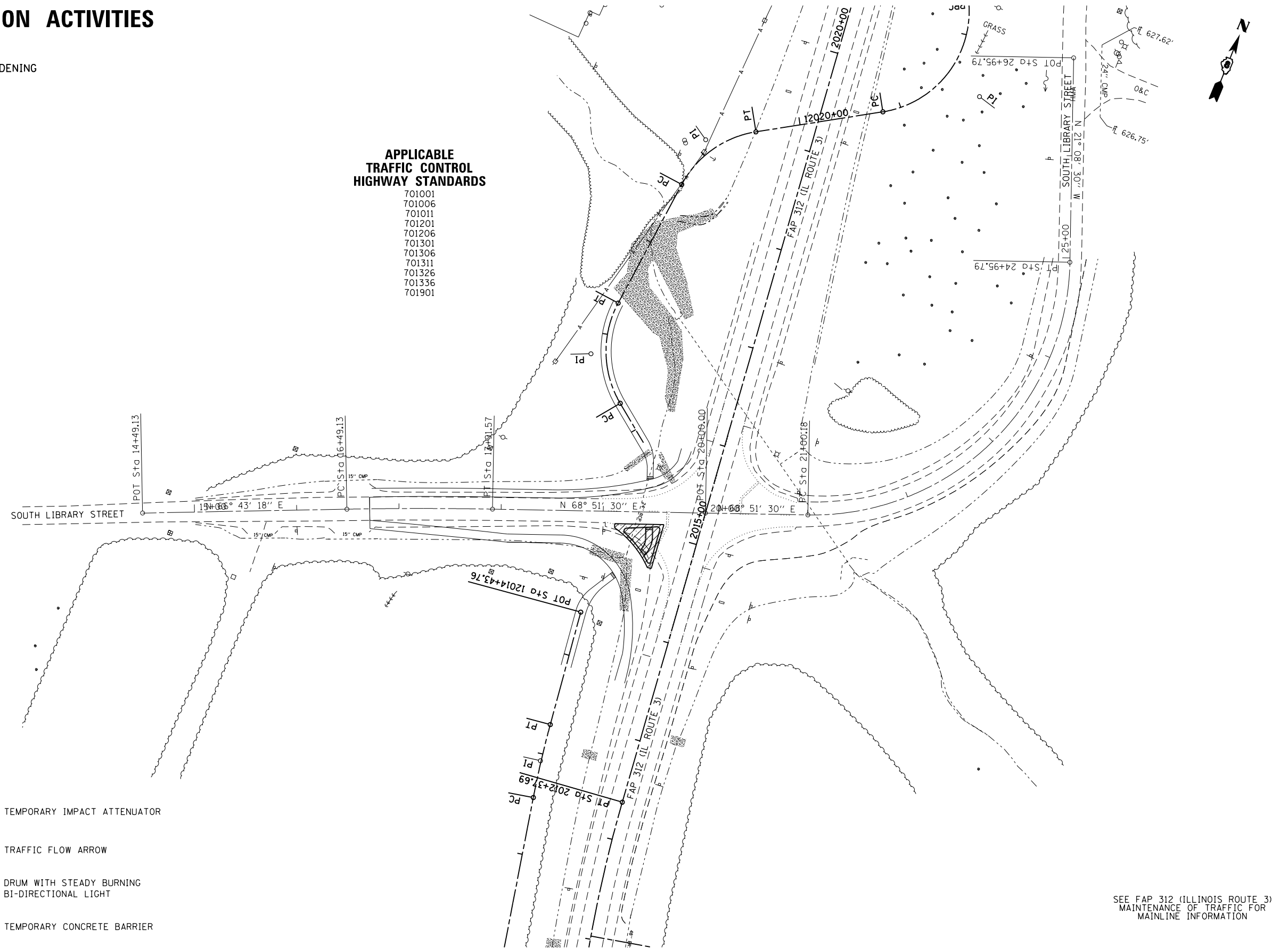

## LEGEND

- |  |                       |  |   |
|--|-----------------------|--|---|
|  | TEMPORARY PAVEMENT    |  | TEMPORARY IMPACT ATTENUATOR                   |
|  | PRESTAGE CONSTRUCTION |  | TRAFFIC FLOW ARROW                            |
|  | STAGE 1 CONSTRUCTION  |  | DRUM WITH STEADY BURNING BI-DIRECTIONAL LIGHT |
|  | STAGE 2 CONSTRUCTION  |  | TEMPORARY CONCRETE BARRIER                    |
|  | STAGE 3 CONSTRUCTION  |  |   |

SEE FAP 312 (ILLINOIS ROUTE 3)  
 MAINTENANCE OF TRAFFIC FOR  
 MAINLINE INFORMATION



LAST SAVED = 1/25/2013  
 PEN TABLE = V8,444,444  
 PLOT DRIVER = pdfplotlayers.pltcf9

FILE NAME =	USER NAME = beriechmann	DESIGNED -	REVISED -
I:\1001100\Phase II - 76817\Cad\T\Plans\064_0876817-sht-Staging-1B-Library.dgn		DRAWN -	REVISED -
	PLOT SCALE = 100.0000' / 1"	CHECKED -	REVISED -
	PLOT DATE = 1/25/2013 3:30:57 PM	DATE -	REVISED -

STATE OF ILLINOIS  
 DEPARTMENT OF TRANSPORTATION

**HORNER & SHIRIN, INC.**  
 ENGINEERS

**SUGGESTED STAGES OF CONSTRUCTION AND TRAFFIC CONTROL**  
 STAGE 1B - SOUTH LIBRARY STREET

SCALE: 1" = 50'

SHEET NO. 17 OF 46 SHEETS STA. 2108+00.00 TO STA. 2122+00.00

F.A.P. RTE.	SECTION	COUNTY	TOTAL SHEETS	SHEET NO.
312	68-WRS-1	MONROE	760	176
CONTRACT NO. 76817				
ILLINOIS FED. AID PROJECT				