

STAGE 1 - CONSTRUCTION ACTIVITIES

SHIFT IL ROUTE 3 TRAFFIC EAST TO 2-12' LANES & TURN LANE UTILIZING THE EXISTING PAVEMENT AND EXISTING SHOULDER
 CONSTRUCT PROPOSED WIDENING AND PORTION OF CULVERT ON WEST SIDE OF IL ROUTE 3
 CONSTRUCT TEMPORARY PAVEMENT ADJACENT TO PROPOSED SHOULDER FOR STAGE 2 TRAFFIC

SEE SIDEROAD MAINTENANCE OF TRAFFIC SHEETS FOR DETAILS

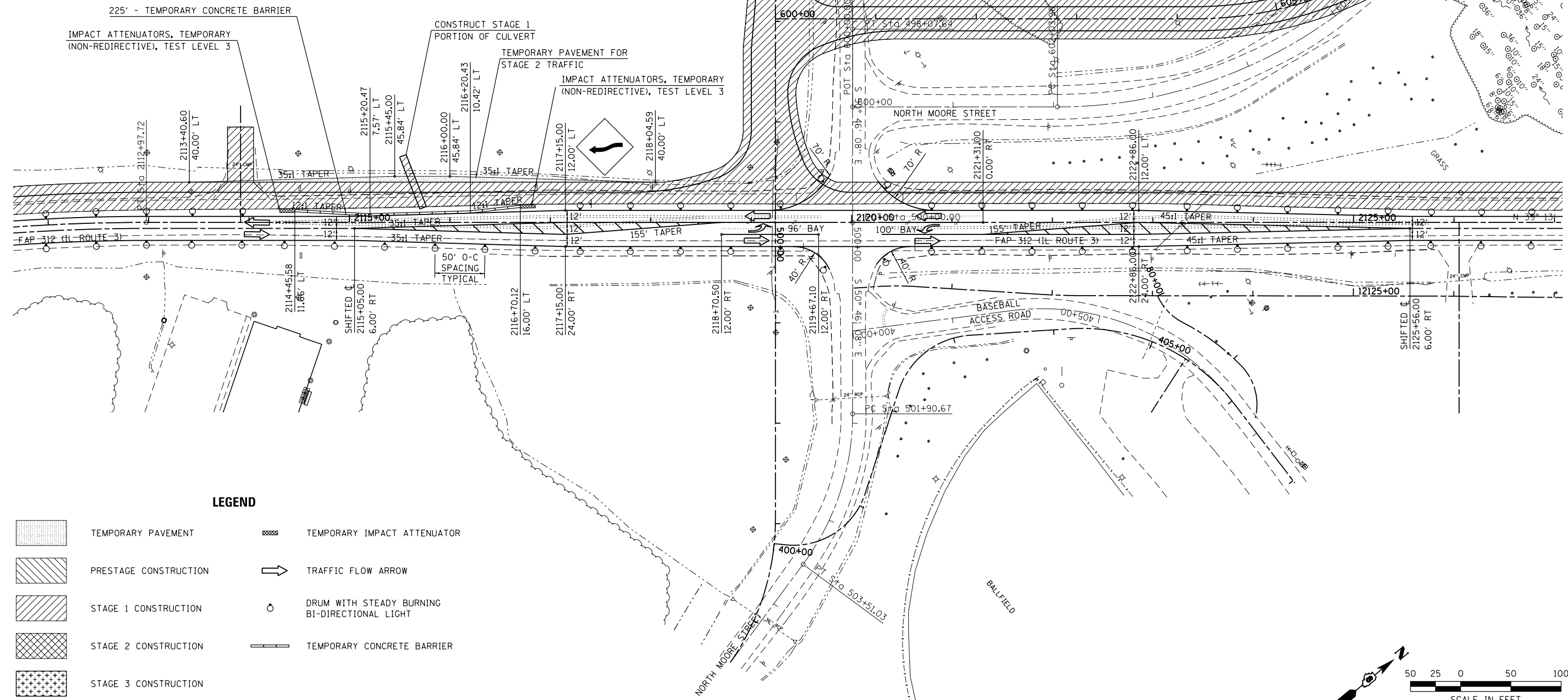

LEGEND

- | | | | |
|--|-----------------------|--|---|
| | TEMPORARY PAVEMENT | | TEMPORARY IMPACT ATTENUATOR |
| | PRESTAGE CONSTRUCTION | | TRAFFIC FLOW ARROW |
| | STAGE 1 CONSTRUCTION | | DRUM WITH STEADY BURNING BI-DIRECTIONAL LIGHT |
| | STAGE 2 CONSTRUCTION | | TEMPORARY CONCRETE BARRIER |
| | STAGE 3 CONSTRUCTION | | |

LAST SAVED = 1/25/2013
 PEN TABLE = W:\PEN\141
 PLOT DRIVER = pdf\INCLAYERS\shd\stcf9

FILE NAME =	USER NAME = beriechmann	DESIGNED -	REVISED -
I:\1001100\Phase II - 76817\Cad\T\Plans\063_0876817-shd-Staging-1-IL3-03.dgn		DRAWN -	REVISED -
		CHECKED -	REVISED -
PLOT SCALE = 100.0000' / 1"		DATE -	REVISED -
PLOT DATE = 1/25/2013 3:30:50 PM			

STATE OF ILLINOIS
 DEPARTMENT OF TRANSPORTATION

HORNER & SHIFRIN, INC.
 ENGINEERS

SUGGESTED STAGES OF CONSTRUCTION AND TRAFFIC CONTROL
 STAGE 1 - STA 2115+79.04

SCALE: 1" = 50' SHEET NO. 13 OF 46 SHEETS STA. 2108+00.00 TO STA. 2122+00.00

F.A.P. RTE.	SECTION	COUNTY	TOTAL SHEETS	SHEET NO.
312	68-WRS-1	MONROE	760	172
				CONTRACT NO. 76817
ILLINOIS FED. AID PROJECT				

