

STAGE 2 - CONSTRUCTION ACTIVITIES

SHIFT IL ROUTE 3 TRAFFIC WEST TO NEW PAVEMENT
 CONSTRUCT WIDENING AND REMAINDER OF CULVERT ON EAST SIDE OF IL ROUTE 3

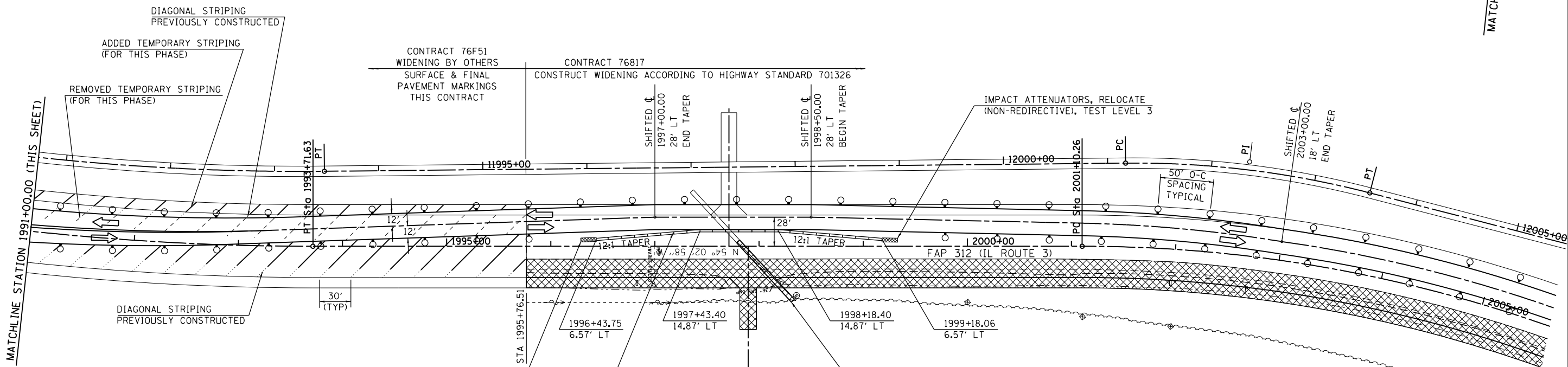
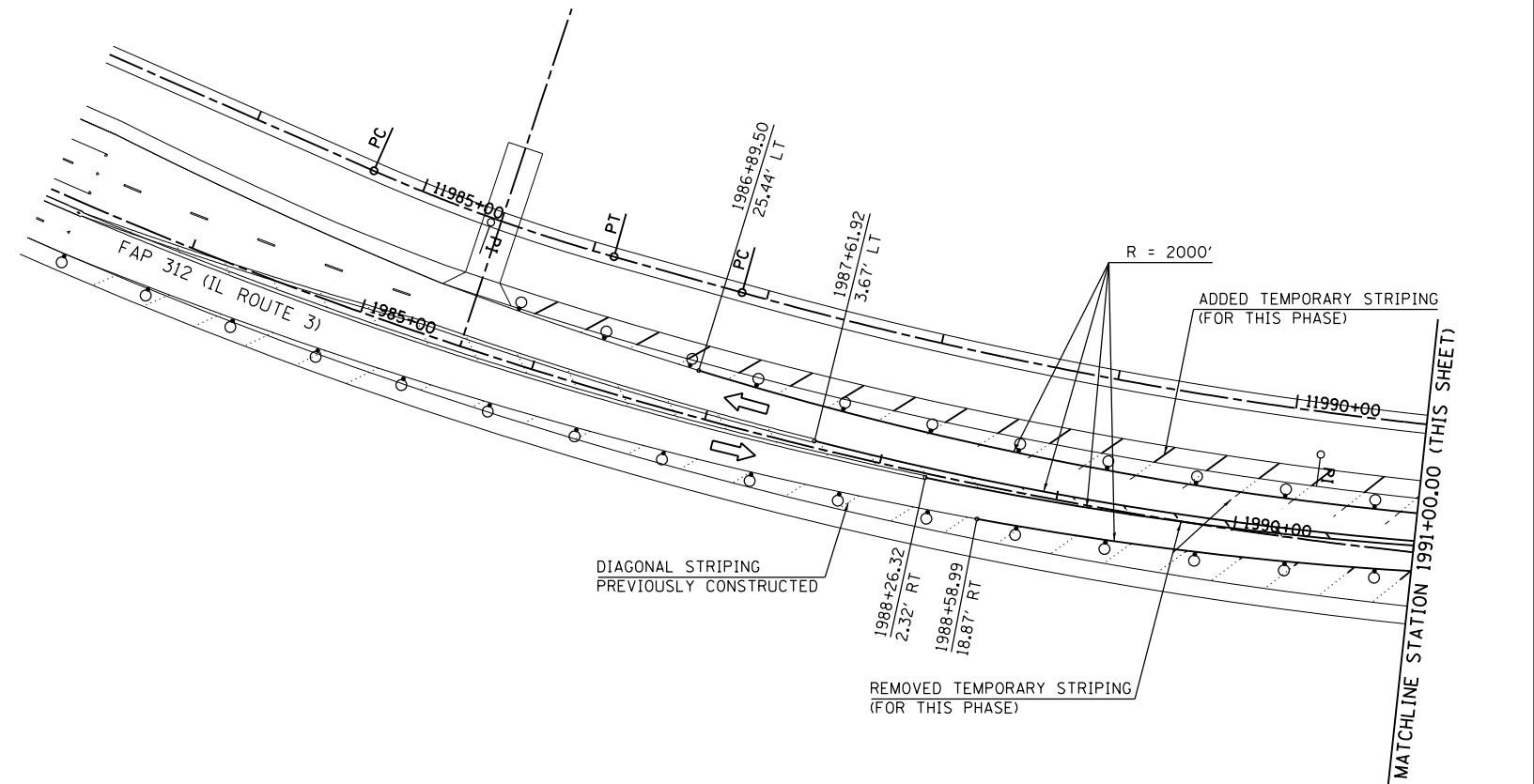

LEGEND

- TEMPORARY PAVEMENT
- PRESTAGE CONSTRUCTION
- STAGE 1 CONSTRUCTION
- STAGE 2 CONSTRUCTION
- STAGE 3 CONSTRUCTION
- TEMPORARY IMPACT ATTENUATOR
- TRAFFIC FLOW ARROW
- DRUM WITH STEADY BURNING BI-DIRECTIONAL LIGHT
- TEMPORARY CONCRETE BARRIER

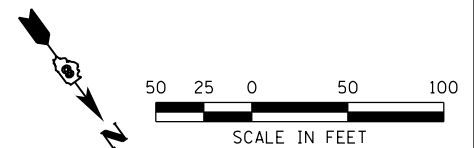

LAST SAVED = 1/25/2013 3:30:36 PM
 PEN TABLE = V:\PEN\PLT
 PLOT DRIVER = pdfnclayers\pltdrvr

FILE NAME =	USER NAME = beriechmann	DESIGNED -	REVISED -
I:\1001100\Phase II - 76817\Cad\T\Plans\061.D876817-sht-Staging-2-IL3-01.dgn		DRAWN -	REVISED -
		CHECKED -	REVISED -
PLOT DATE = 1/25/2013 3:30:36 PM		DATE -	REVISED -

**STATE OF ILLINOIS
 DEPARTMENT OF TRANSPORTATION**

**HORNER &
 SHIRIN, INC.
 ENGINEERS**

**SUGGESTED STAGES OF CONSTRUCTION
 AND TRAFFIC CONTROL**
 STAGE 2 - STA 1990+00.00 TO STA. 2005+00.00

F.A.P. RTE.	SECTION	COUNTY	TOTAL SHEETS	SHEET NO.
312	68-WRS-1	MONROE	670	165
CONTRACT NO. 76817			ILLINOIS FED. AID PROJECT	

SCALE: 1" = 50' SHEET NO. 6 OF 46 SHEETS STA. 1990+00.00 TO STA. 2005+00.00