

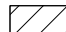

- LEGEND**
-  HMA SURFACE REMOVAL, VARIABLE DEPTH
 -  PAVEMENT REMOVAL
 -  PAVED SHOULDER REMOVAL

- REMOVE PIPE UNDERDRAINS PER TYPICAL SECTIONS
- GREAT RIVER ROAD AND AMERICA'S BYWAYS SIGNS ARE TO BE RELOCATED. ALL OTHER SIGNS ARE TO BE REMOVED. SEE SCHEDULE.

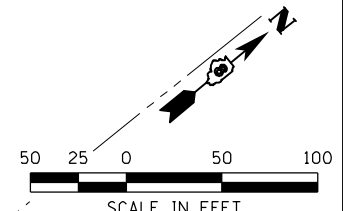
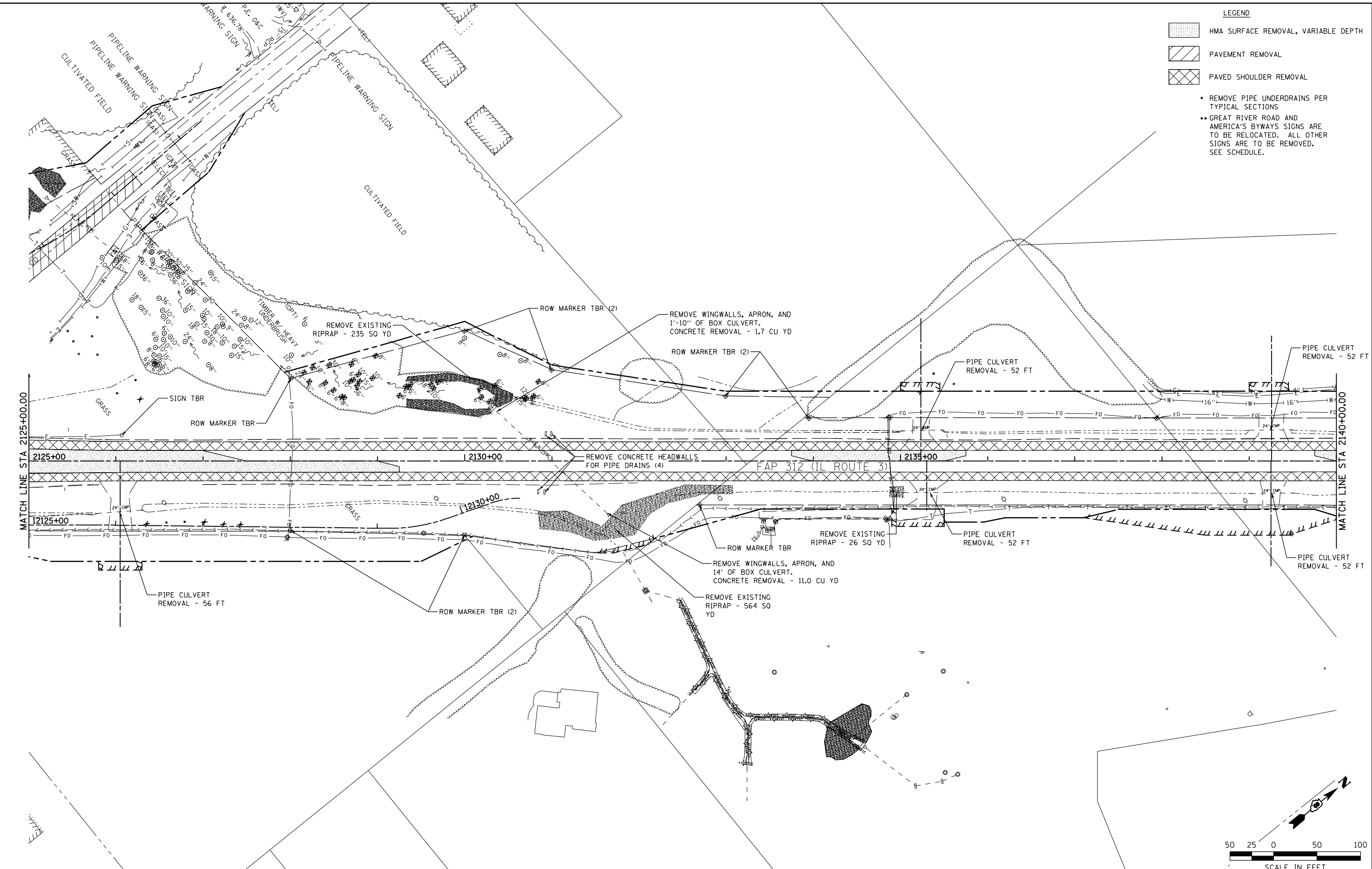

FILE NAME = F:\Projects\DOT PROJECTS\09-101-11.4\Drawings\CADD Sheets\Contract 2\161.0876817-sh-	USER NAME = Richard Heinke	DESIGNED - DRAWN -	REVISED - REVISED - REVISED - REVISED -	STATE OF ILLINOIS DEPARTMENT OF TRANSPORTATION		McDonough-Whillow, P.C. PROFESSIONAL DESIGN NO. 184-002754	PLAN & PROFILE IL ROUTE 3		F.A.P. RTE. 312	SECTION 68-WRS-1	COUNTY MONROE	TOTAL SHEETS 760	SHEET NO. 151
PLOT SCALE = 100.0000' / in.	CHECKED -	DATE -	SCALE: 1" = 50'	SHEET NO. 11 OF 19 SHEETS	STA. 2125+00.00 TO STA. 2140+00.00	CONTRACT NO. 76817		ILLINOIS FED. AID PROJECT					