

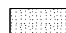

- LEGEND**
-  HMA SURFACE REMOVAL, VARIABLE DEPTH
 -  PAVEMENT REMOVAL
 -  PAVED SHOULDER REMOVAL
- REMOVE PIPE UNDERDRAINS PER TYPICAL SECTIONS
 - GREAT RIVER ROAD AND AMERICA'S BYWAYS SIGNS ARE TO BE RELOCATED. ALL OTHER SIGNS ARE TO BE REMOVED. SEE SCHEDULE.

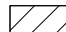
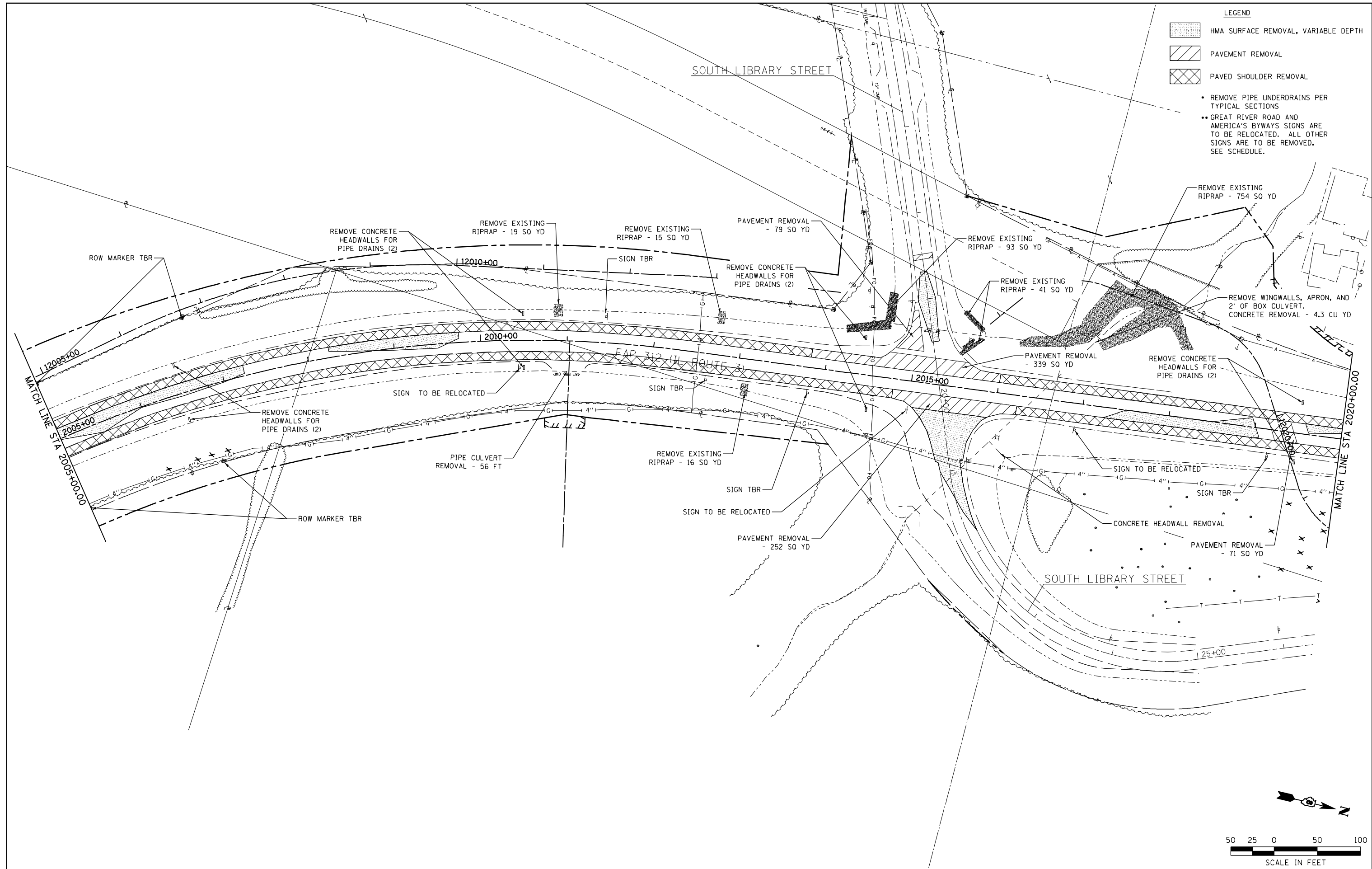

| | | | | | | | | | | | |
|--|----------------------------|----------------|-----------|---|---|------------------------------------|---------------------------|------------------|--------------------------|------------------|------------------------------------|
| FILE NAME = F:\Projects\IDOT PROJECTS\09-101-11.4\Drawings\CADD Sheets\Contract 2\153.0876817-sh | USER NAME = Richard Heinke | DESIGNED - JAH | REVISED - | STATE OF ILLINOIS DEPARTMENT OF TRANSPORTATION |  McDonough-Whillow P.C. PROFESSIONAL DESIGN No. 184-002754 | REMOVAL PLAN IL ROUTE 3 | F.A.P. RTE. 312 | SECTION 68-WRS-1 | COUNTY MONROE | TOTAL SHEETS 760 | SHEET NO. 143 |
| PLOT SCALE = 100.0000' / in. | CHECKED - TMM | REVISOR - RNH | REVISOR - | | | | CONTRACT NO. 76817 | | | | |
| PLOT DATE = 1/24/2013 | DATE - | REVISOR - | REVISOR - | | | | ILLINOIS FED. AID PROJECT | | | | |
| | | | | | | | SCALE: 1" = 50' | | SHEET NO. 3 OF 19 SHEETS | | STA. 2005+00.00 TO STA. 2020+00.00 |