

RIGHT OF WAY NOTES AND OFFSETS OMITTED FOR CLARITY
PLEASE SEE THE PLAT OF HIGHWAY SHEETS FOR ADDITIONAL DETAILS

KENNETH RALPH HARTMAN, JR., ET AL

PROPOSED BOLLARDS
SEE DETAILS

STA 50+00.00 @ SOUTHVIEW DRIVE =
STA 2024+18.55 @ FAP 312 (IL ROUTE 3)

COMBINATION CURB &
GUTTER TYPE B-6.24

END PROJECT
STA 50+74.91

COMBINATION CURB &
GUTTER TYPE B-6.24

CONSTRUCTION LIMITS

CONSTRUCTION LIMITS

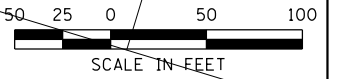

PLAN	SURVEYED	DATE
NOTE BOOK	PLOTTED	BY
NO.	ALIGNED	
	CHECKED	
	FILED	
	DATE	

PROFILE	SURVEYED	DATE
NOTE BOOK	PLOTTED	BY
NO.	GRADES CHECKED	
	STRUCTURE NOTATIONS CHECKED	

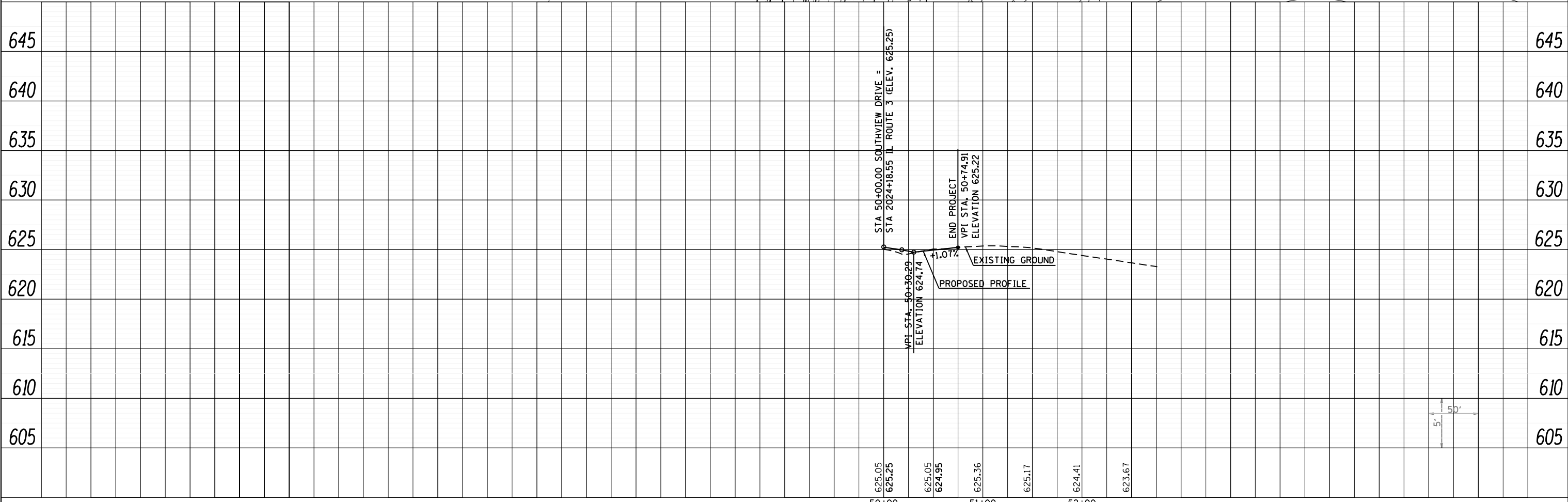

LAST SAVED = 1/23/2013
PEN TABLE = VBL-H&I.rtl
PLOT DRIVER = pdfNCLAYER\$wplctcf9

FILE NAME =	USER NAME = beriechmann	DESIGNED -	REVISED -
I:\1001100\Phase II - 76817\Cad\T\Plans\050_0876817-shr-plnprf-16.dgn		DRAWN -	REVISED -
		CHECKED -	REVISED -
		DATE -	REVISED -

STATE OF ILLINOIS
DEPARTMENT OF TRANSPORTATION

HORNER &
SHIRIN, INC.
ENGINEERS

PLAN & PROFILE
SOUTHVIEW DRIVE

SCALE: 1" = 50' SHEET NO. 30 OF 40 SHEETS STA. 50+00.00 TO STA. 50+74.91

F.A.P. RTE.	SECTION	COUNTY	TOTAL SHEETS	SHEET NO.
312	68-WRS-1	MONROE	760	130
CONTRACT NO. 76817			ILLINOIS FED. AID PROJECT	