

PLAN	SURVEYED	DATE
NOTE BOOK	ALIGNED	BY
NO.	CHECKED	
	FILE NAME	

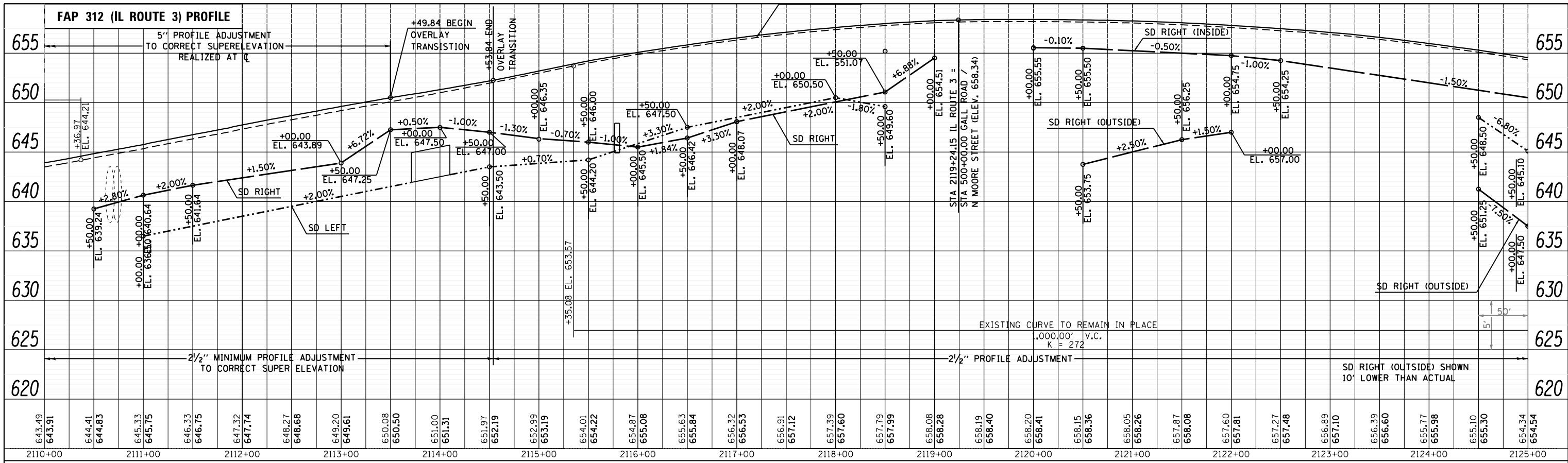

PROFILE	SURVEYED	DATE
NOTE BOOK	GRADES CHECKED	BY
NO.	STRUCTURE	
	NOTATIONS	

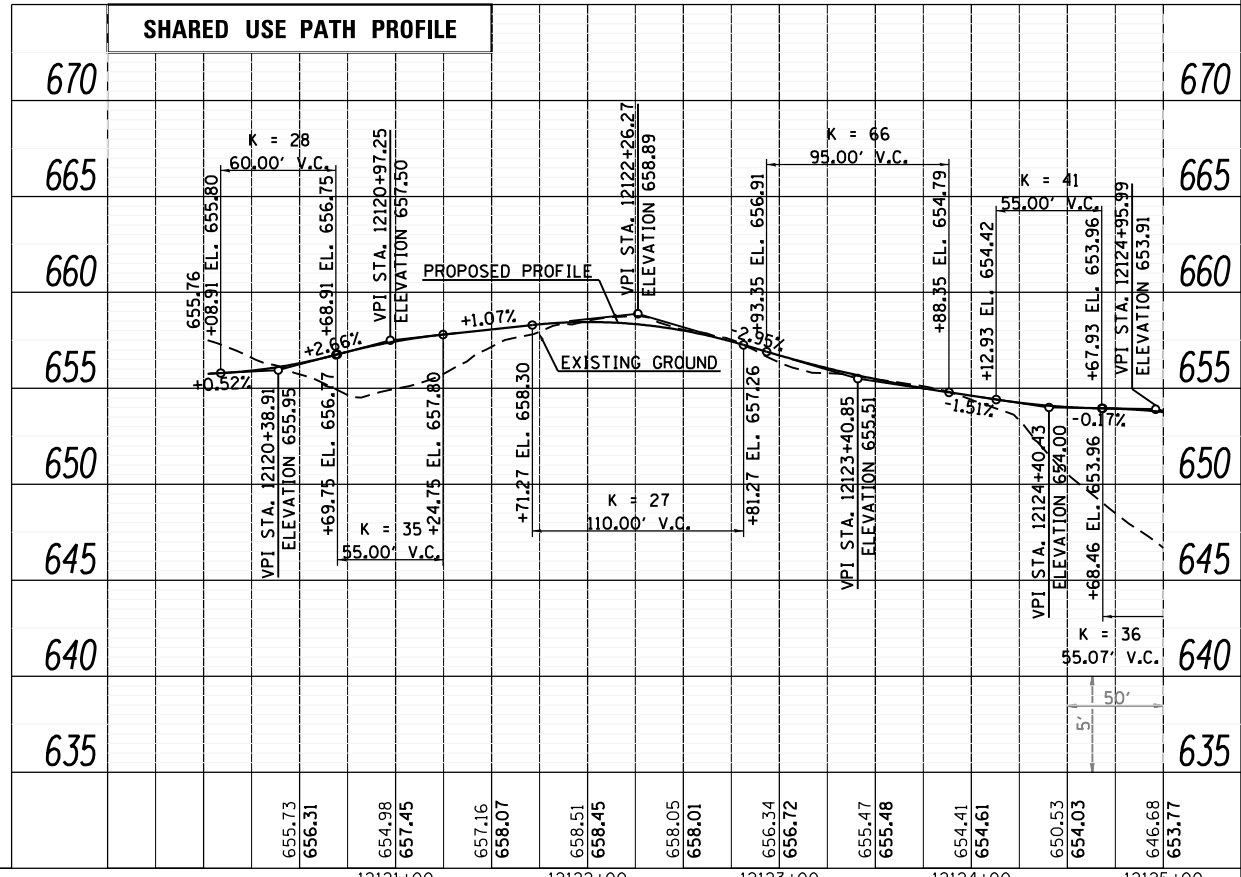
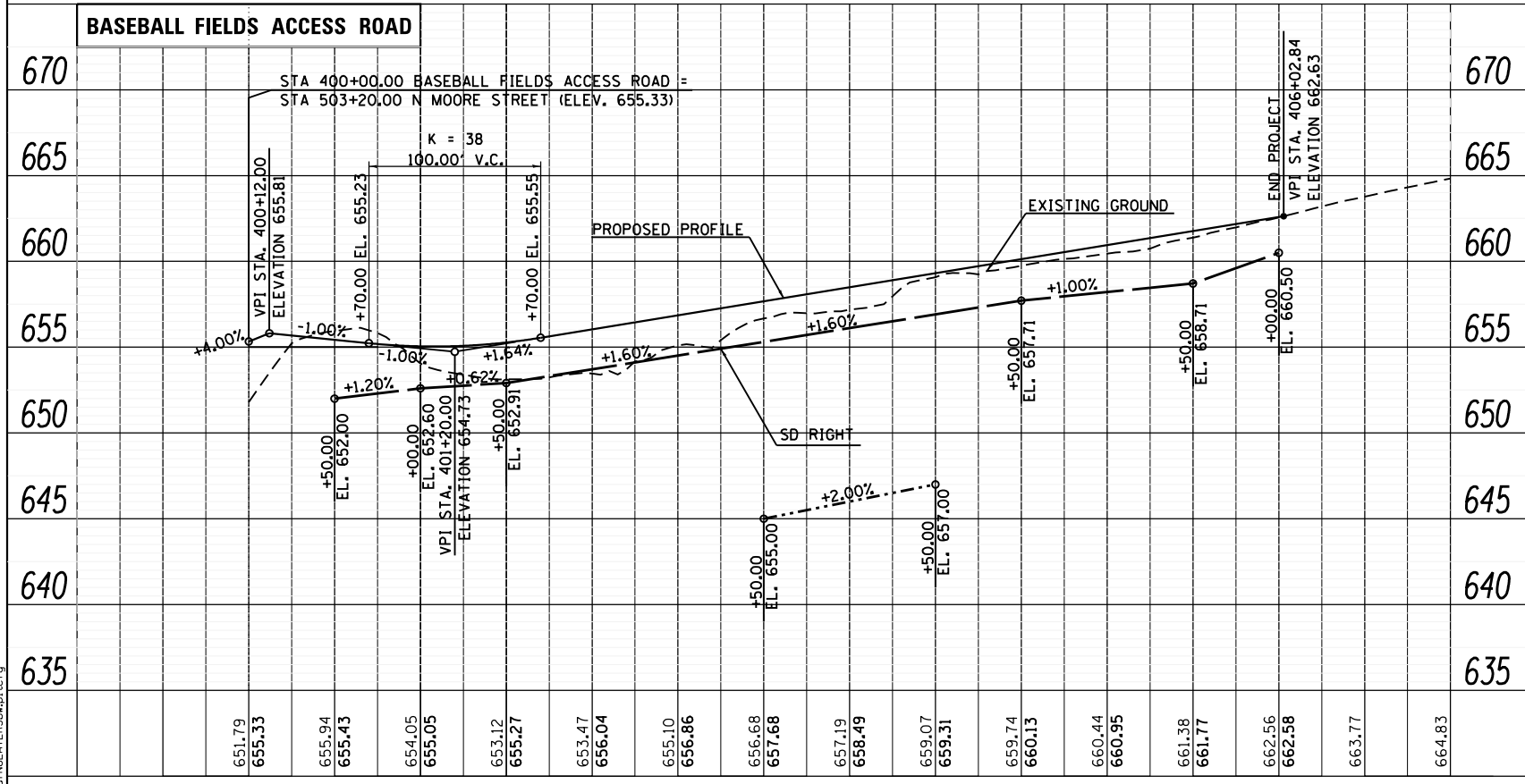

LAST SAVED = 1/22/2013
 PEN DRIVER = V6-H61F.rtl
 PLOT DRIVER = pdfNLAVERSpw.pltcf9

FILE NAME =	USER NAME = beriechmann	DESIGNED -	REVISED -
I:\10011001_Phase II - 76817\Cad\T\Plans\01.L0876817-shr-profile-10.dgn		DRAWN -	REVISED -
PLOT SCALE = 100.0000' / in.		CHECKED -	REVISED -
PLOT DATE = 1/25/2013 3:29:59 PM		DATE -	REVISED -

STATE OF ILLINOIS
 DEPARTMENT OF TRANSPORTATION

HORNER & SHIRIN, INC. ENGINEERS		PROFILE	
FAP 312 (IL ROUTE 3) / BASEBALL FIELDS ACCESS ROAD		F.A.P. RTE. 312	SECTION 68-WRS-1
SCALE: 50H:5V		COUNTY MONROE	TOTAL SHEETS 120
SHEET NO. 20 OF 40 SHEETS		CONTRACT NO. 76817	
STA. 2110+00.00 TO STA. 2125+00.00		ILLINOIS FED. AID PROJECT	