

**BENCHMARKS**

BM 106 CHISELED "□" ON SOUTH SIDE OF LIGHT POLE FOUNDATION ON WEST SIDE OF IL 3. NEAR SOUTHEAST CORNER OF DENNY'S PARKING LOT. STA 2170+62, 96' LT ELEV = 694.86'

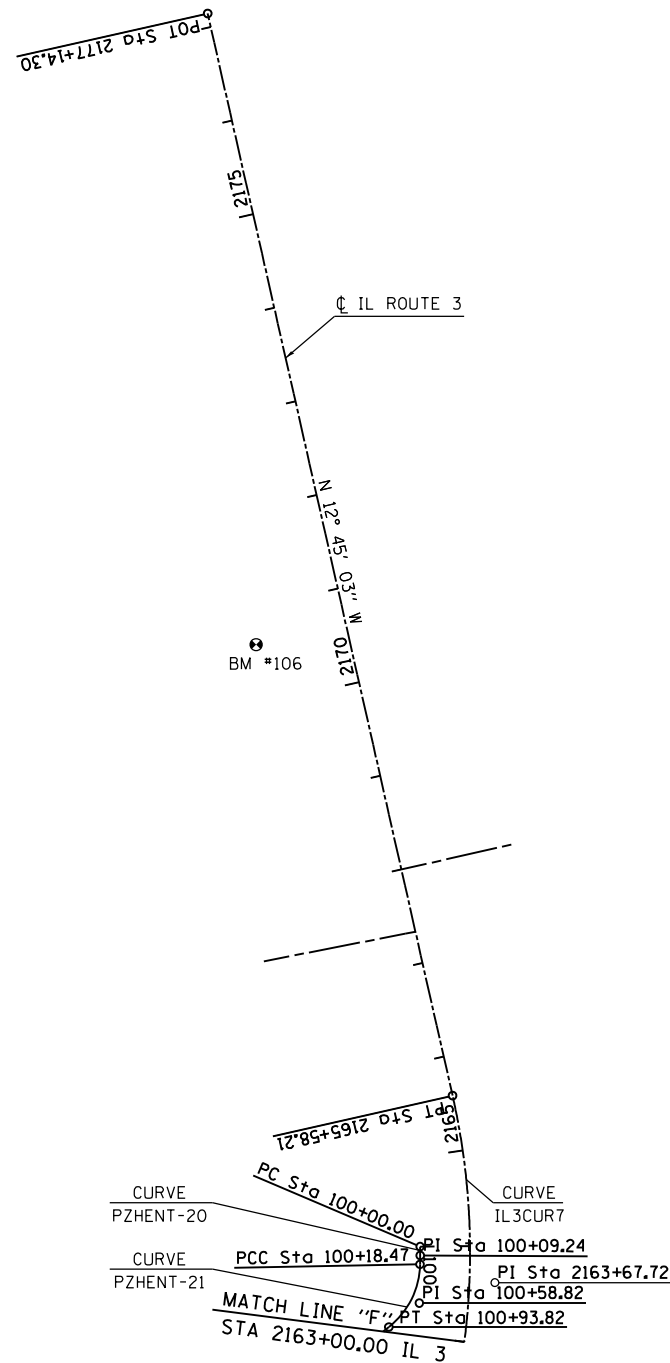

<p>PROP. CURVE PZHENT-20                  PI STA. = 100+09.24  <math>\Delta = 1^\circ 32' 24''</math> (RT)  <math>D = 8^\circ 20' 11''</math>  <math>R = 687.30'</math>  <math>T = 9.24'</math>  <math>L = 18.47'</math>  <math>E = 0.06'</math>  <math>e = \text{-----}</math>  <math>T.R. = \text{-----}</math>                  S.E. RUN = -----                  P.C. STA = 100+00.00                  P.T. STA = 100+18.47</p>	<p>PROP. CURVE PZHENT-21                  PI STA. = 100+58.82  <math>\Delta = 50^\circ 47' 26''</math> (RT)  <math>D = 67^\circ 24' 24''</math>  <math>R = 85.00'</math>  <math>T = 40.35'</math>  <math>L = 75.35'</math>  <math>E = 9.09'</math>  <math>e = \text{-----}</math>  <math>T.R. = \text{-----}</math>                  S.E. RUN = -----                  P.C. STA = 100+18.47                  P.T. STA = 100+93.82</p>	<p>PROP. CURVE IL3CUR7                  PI STA. = 2163+67.72  <math>\Delta = 30^\circ 14' 57''</math> (LT)  <math>D = 7^\circ 45' 00''</math>  <math>R = 739.30'</math>  <math>T = 199.82'</math>  <math>L = 390.31'</math>  <math>E = 26.53'</math>  <math>e = 4.0\%</math>  <math>T.R. = 52'</math>                  S.E. RUN = 155'                  P.C. STA = 2161+67.90                  P.T. STA = 2165+58.21</p>
---	---	--

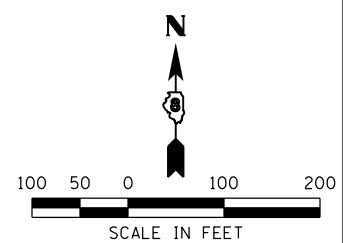

LAST SAVED = 1/22/2013 10:44:41 AM  
 PEN TABLE = W:\44444444  
 PLOT DRIVER = pdfnclayers\psw\pltdcf9

FILE NAME =	USER NAME = beriechmann	DESIGNED -	REVISED -
I:\1001100\Phase II - 76817\Cad\T\Plans\006_0876817-shd-ATB-7.dgn		DRAWN -	REVISED -
		CHECKED -	REVISED -
PLOT DATE = 1/25/2013 3:29:09 PM		DATE -	REVISED -

**STATE OF ILLINOIS**  
**DEPARTMENT OF TRANSPORTATION**

**HORNER & SHIRIN, INC.**  
**ENGINEERS**

**ALIGNMENTS, TIES, AND BENCHMARKS**

SCALE: 1" = 100'    SHEET NO. 7 OF 20 SHEETS    STA. 2163+00.00 TO STA. 2177+14.30

F.A.P. RTE.	SECTION	COUNTY	TOTAL SHEETS	SHEET NO.
312	68-WRS-1	MONROE	760	87
CONTRACT NO. 76817				
ILLINOIS FED. AID PROJECT				