

STATE OF ILLINOIS  
DEPARTMENT OF PUBLIC WORKS & BUILDINGS  
DIVISION OF HIGHWAYS

ROUTE NO.	FRACTION	COUNTY	TOTAL SHEETS	SHEET NO.	SHEET NO.
74	10-4	Champaign	34	10	18 SHEETS
FED. ROAD DIST. NO. 7	ILLINOIS	FED. AID PROJECT			

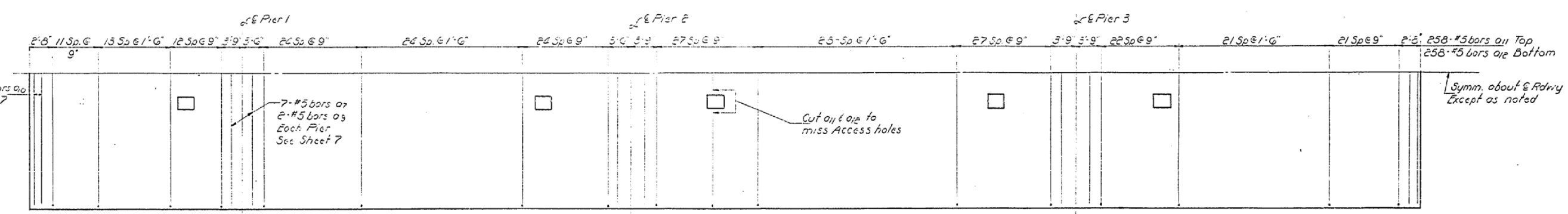
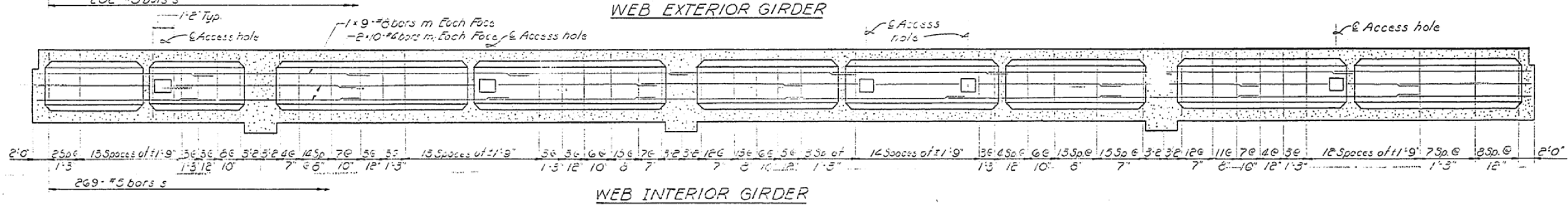
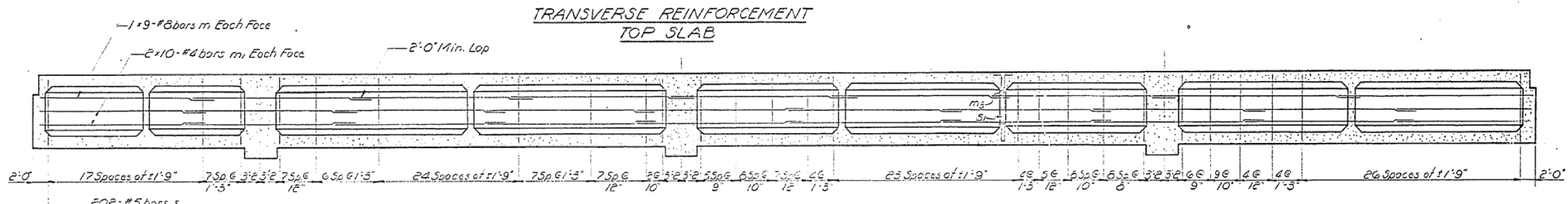
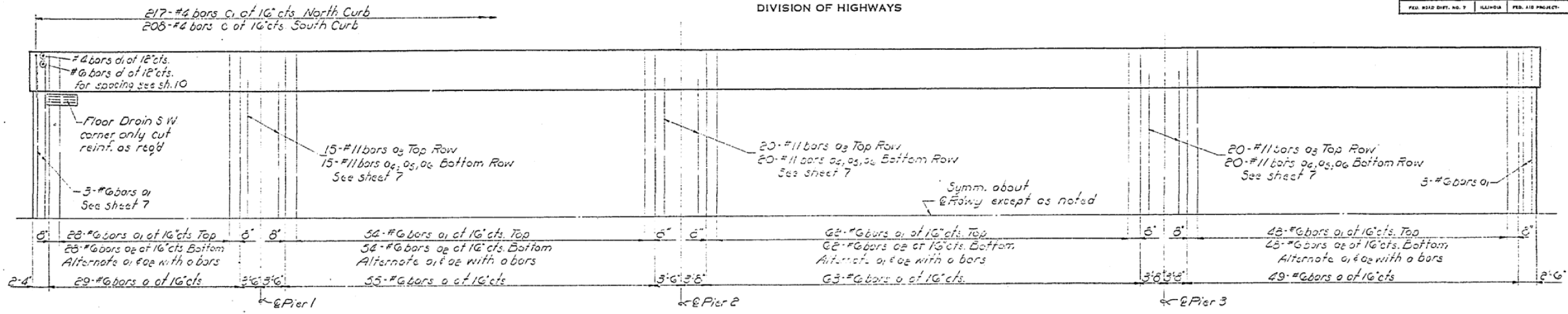

DESIGNED	James P. Prince	EXAMINED	[Signature]
CHECKED	[Signature]	PASSED	[Signature]
DRAWN	[Signature]	APPROVED	[Signature]
CHECKED	JWP		JNP

TRANSVERSE REINFORCEMENT  
BOTTOM SLAB

NOTES  
All top and bottom slab transverse bars are to be placed radially, spacing measured along & roadway.  
Spacing for web reinforcement are measured along & girder.  
For Bill of Material see sheet 8

F.A.I.R.T. 74 SEC. 10-4 HB-2  
CHAMPAIGN COUNTY  
STA. 1547+92.43