

DEAD LOAD DEFLECTION DIAGRAMS
(Includes weight of concrete, excluding beams).

Note:
The above deflections are not to be used in the field if the engineer is working from the grade elevations adjusted for dead load deflections as shown below.

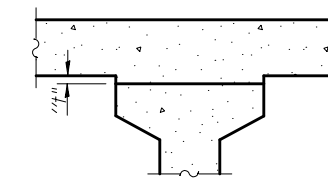

To determine "t": After all precast prestressed beams have been erected, elevations of the top flanges of the beams shall be taken at intervals shown below. These elevations subtracted from the "Theoretical Grade Elevations Adjusted for Dead Load Deflections" shown below, minus slab thickness, equals the fillet heights "t" above top flanges of beams.

FILLET HEIGHTS

WEST CURTAIN WALL

Location	Station	Offset	Theoretical Grade Elevations	Theoretical Grade Elevations Adjusted For Dead Load Deflection
Bk. N. Abut.	22+66.10	-25.52	759.41	759.41
C Brg. N. Abut.	22+66.82	-25.50	759.41	759.41
C1	22+76.50	-25.31	759.32	759.32
D1	22+86.18	-25.25	759.23	759.23
E1	22+95.86	-25.32	759.14	759.14
C Brg. N. Bent	23+03.45	-25.46	759.07	759.07
Bk. N. Bent	23+04.66	-25.49	759.05	759.05

BEAM 1b

Location	Station	Offset	Theoretical Grade Elevations	Theoretical Grade Elevations Adjusted For Dead Load Deflection
Bk. N. Abut.	22+66.11	-19.02	759.54	759.54
C Brg. N. Abut.	22+66.84	-19.00	759.54	759.54
C1	22+76.60	-18.81	759.45	759.46
D1	22+86.36	-18.75	759.36	759.38
E1	22+96.12	-18.82	759.27	759.28
C Brg. N. Bent	23+03.77	-18.96	759.19	759.19
Bk. N. Bent	23+04.99	-18.99	759.18	759.18

BEAM 2b

Location	Station	Offset	Theoretical Grade Elevations	Theoretical Grade Elevations Adjusted For Dead Load Deflection
Bk. N. Abut.	22+66.12	-11.35	759.57	759.57
C Brg. N. Abut.	22+66.86	-11.33	759.57	759.57
C1	22+76.71	-11.14	759.47	759.49
D1	22+86.57	-11.08	759.38	759.40
E1	22+96.42	-11.16	759.29	759.30
C Brg. N. Bent	23+04.15	-11.30	759.22	759.22
Bk. N. Bent	23+05.38	-11.33	759.20	759.20

BEAM 3b

Location	Station	Offset	Theoretical Grade Elevations	Theoretical Grade Elevations Adjusted For Dead Load Deflection
Bk. N. Abut.	22+66.13	-3.68	759.46	759.46
C Brg. N. Abut.	22+66.87	-3.66	759.45	759.45
C1	22+76.82	-3.47	759.35	759.37
D1	22+86.78	-3.42	759.26	759.28
E1	22+96.73	-3.49	759.17	759.18
C Brg. N. Bent	23+04.54	-3.64	759.10	759.10
Bk. N. Bent	23+05.78	-3.67	759.09	759.09

F.A.S. RTE. 1520 (C.H. 50) & PG

Location	Station	Offset	Theoretical Grade Elevations	Theoretical Grade Elevations Adjusted For Dead Load Deflection
Bk. N. Abut.	22+66.13	0.00	759.40	759.40
C Brg. N. Abut.	22+66.87	0.00	759.40	759.40
C1	22+76.87	0.00	759.30	759.31
D1	22+86.87	0.00	759.21	759.22
E1	22+96.87	0.00	759.11	759.12
C Brg. N. Bent	23+04.73	0.00	759.04	759.04
Bk. N. Bent	23+05.98	0.00	759.02	759.02

BEAM 4b

Location	Station	Offset	Theoretical Grade Elevations	Theoretical Grade Elevations Adjusted For Dead Load Deflection
Bk. N. Abut.	22+66.14	3.99	759.34	759.34
C Brg. N. Abut.	22+66.89	4.01	759.34	759.34
C1	22+76.94	4.20	759.24	759.25
D1	22+87.00	4.25	759.14	759.16
E1	22+97.05	4.17	759.05	759.06
C Brg. N. Bent	23+04.94	4.02	758.98	758.98
Bk. N. Bent	23+06.19	3.98	758.97	758.97

BEAM 5b

Location	Station	Offset	Theoretical Grade Elevations	Theoretical Grade Elevations Adjusted For Dead Load Deflection
Bk. N. Abut.	22+66.15	11.66	759.23	759.23
C Brg. N. Abut.	22+66.91	11.68	759.22	759.22
C1	22+77.06	11.87	759.12	759.14
D1	22+87.22	11.92	759.03	759.05
E1	22+97.38	11.83	758.93	758.94
C Brg. N. Bent	23+05.34	11.68	758.86	758.86
Bk. N. Bent	23+06.61	11.64	758.85	758.85

EAST CURTAIN WALL

Location	Station	Offset	Theoretical Grade Elevations	Theoretical Grade Elevations Adjusted For Dead Load Deflection
Bk. N. Abut.	22+66.15	18.17	759.14	759.14
C Brg. N. Abut.	22+66.92	18.18	759.13	759.13
C1	22+77.17	18.37	759.04	759.04
D1	22+87.41	18.42	758.94	758.94
E1	22+97.66	18.33	758.84	758.84
C Brg. N. Bent	23+05.69	18.17	758.76	758.76
Bk. N. Bent	23+06.97	18.14	758.75	758.75