

F.A.I. R.T.E.	SECTION	COUNTY	TOTAL SHEETS	SHEET NO.
57	D3 PATCHING 2014-4	IROQUOIS	19	1
		ILLINOIS	CONTRACT NO. 66C92	

INDEX OF SHEETS

1. COVER SHEET
2. GENERAL NOTES
3. SUMMARY OF QUANTITIES
4. TYPICAL SECTIONS
- 5 - 7. SCHEDULES - NORTHBOUND LANES
- 8 - 11. SCHEDULES - SOUTHBOUND LANES
12. TRAFFIC CONTROL AND PROTECTION, STANDARD 701400 (SPECIAL)
- 13 - 15. CLASS A PATCHES
- 16 - 18. CLASS B PATCHES
19. TYPICAL PAVEMENT MARKINGS

HIGHWAY STANDARDS

- | | |
|-----------|---|
| 000001-06 | STANDARD SYMBOLS, ABBREVIATIONS AND PATTERNS |
| 001001-02 | AREAS OF REINFORCEMENT BARS |
| 001006 | DECIMAL OF AN INCH AND OF A FOOT |
| 420701-02 | PAVEMENT FABRIC |
| 421001-02 | BAR REINFORCEMENT FOR CRC PAVEMENT |
| 701101-03 | OFF-ROAD OPERATIONS MULTILANE, 15' (4.5 m) TO 24" (600 mm) FROM PAVEMENT EDGE |
| 701401-07 | LANE CLOSURE, FREEWAY/EXPRESSWAY |
| 701411-08 | LANE CLOSURE, MULTILANE, AT ENTRANCE OR EXIT RAMP FOR SPEEDS ≥ 45 MPH |
| 701426-05 | LANE CLOSURE, MULTILANE INTERMITTENT OR MOVING OPERATION, FOR SPEEDS ≥ 45 MPH |
| 701456-02 | PARTIAL EXIT RAMP CLOSURE FREEWAY/EXPRESSWAY |
| 701901-02 | TRAFFIC CONTROL DEVICES |

DEPARTMENT OF TRANSPORTATION

DIVISION OF HIGHWAYS

**PROPOSED
HIGHWAY PLANS**

FAI ROUTE 57 (I-57)

SECTION D3 PATCHING 2014-4

PAVEMENT PATCHING

IROQUOIS

C-93-088-13

**END PROJECT
KANKAKEE COUNTY LINE
(M.P. 301.96)**

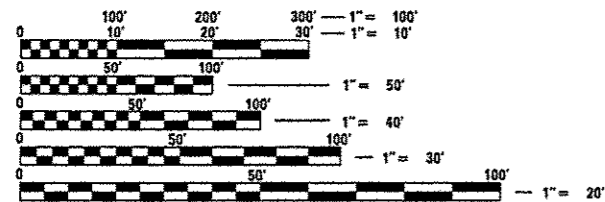
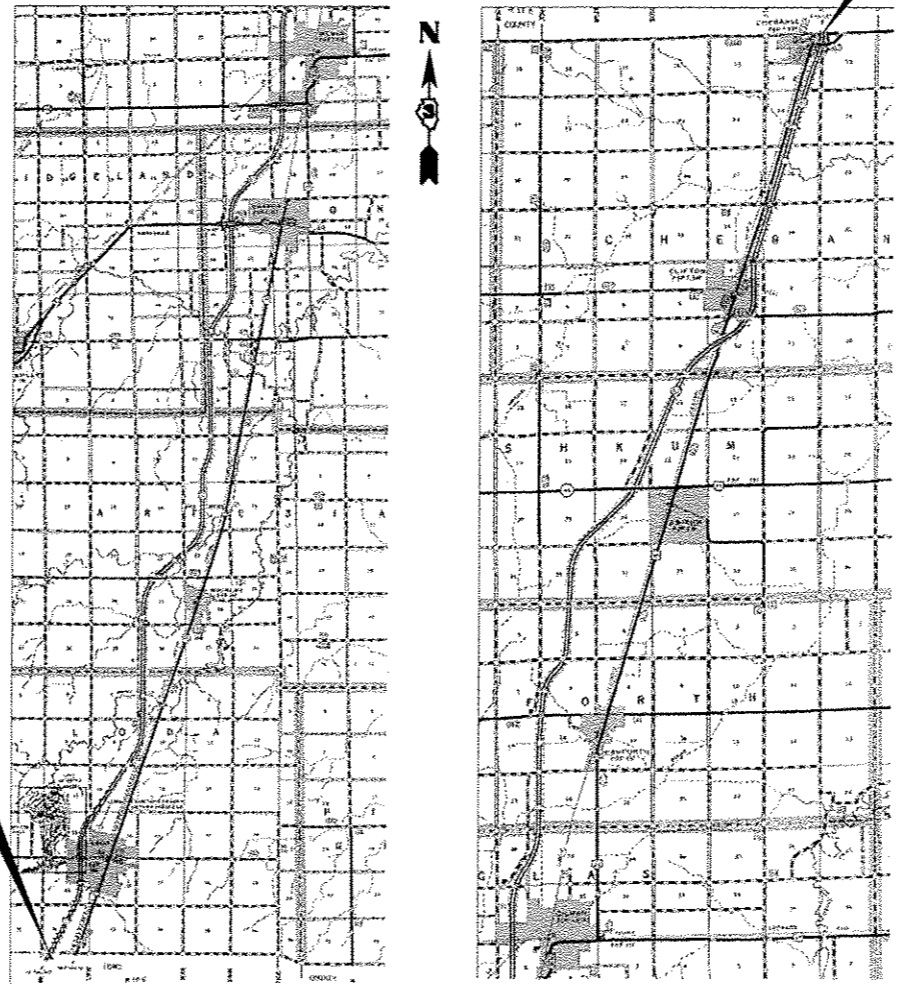
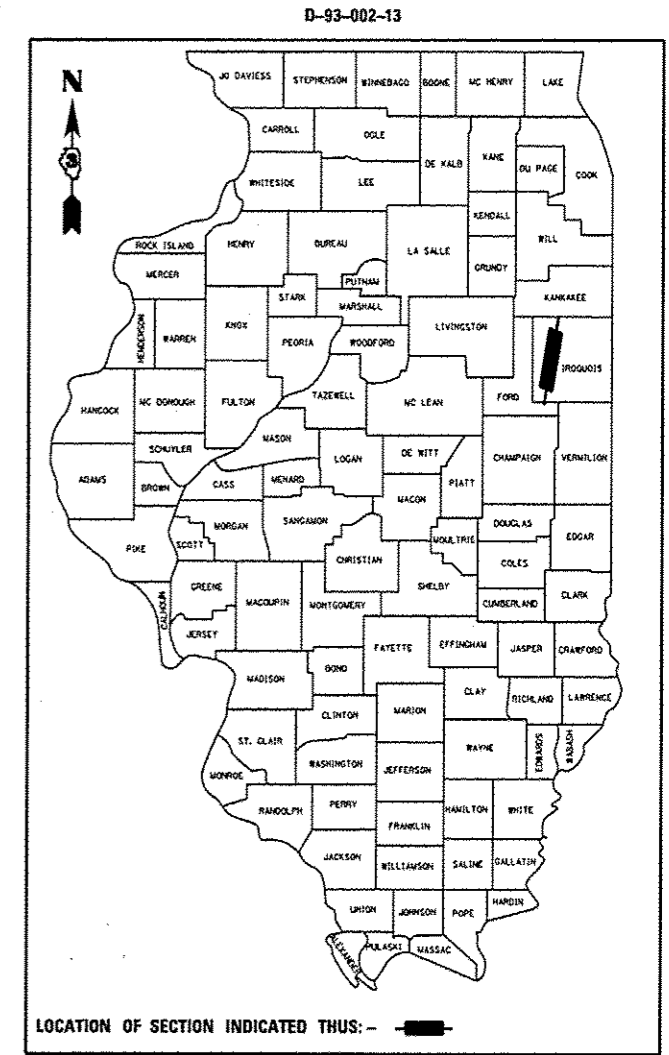

FULL SIZE PLANS HAVE BEEN PREPARED USING STANDARD ENGINEERING SCALES. REDUCED SIZED PLANS WILL NOT CONFORM TO STANDARD SCALES. IN MAKING MEASUREMENTS ON REDUCED PLANS, THE ABOVE SCALES MAY BE USED.

J.U.L.I.E.
JOINT UTILITY LOCATION INFORMATION FOR EXCAVATION
1-800-892-0123
OR 811

PROJECT ENGINEER: JOE KANNEL P.E.
UNIT CHIEF: RON WOODSHANK
TOWNSHIP: VARIOUS
CONTRACT NO. 66C92

GROSS LENGTH = 204706 FT. = 38.770 MILE
NET LENGTH = 1062 FT. = 0.201 MILE

RURAL	
INTERSTATE	
FAI 57 (I-57)	
2011	
ADT	17300
P.V.	65.23%
S.U.	3.99%
M.U.	30.78%

STATE OF ILLINOIS
DEPARTMENT OF TRANSPORTATION
DIVISION OF HIGHWAYS

SUBMITTED 4-3-2013
Paul A. Tardella
DEPUTY DIRECTOR OF HIGHWAYS, REGION ENGINEER

May 10 2013
John D. Baranzelli, P.E.
ENGINEER OF DESIGN AND ENVIRONMENT

May 10 2013
Omar Osman, P.E.
DIRECTOR OF HIGHWAYS, CHIEF ENGINEER

**PRINTED BY THE AUTHORITY
OF THE STATE OF ILLINOIS**

GENERAL NOTES

PLAN DIMENSIONS AND DETAILS RELATIVE TO EXISTING PLANS ARE SUBJECT TO NOMINAL CONSTRUCTION VARIATIONS. THE CONTRACTOR SHALL FIELD VERIFY EXISTING DIMENSIONS AND DETAILS AFFECTING NEW CONSTRUCTION AND MAKE NECESSARY APPROVED ADJUSTMENTS PRIOR TO CONSTRUCTION OR ORDERING OF MATERIALS. SUCH VARIATIONS SHALL NOT BE CAUSE FOR ADDITIONAL COMPENSATION FOR A CHANGE IN SCOPE OF WORK; HOWEVER, THE CONTRACTOR WILL BE PAID FOR THE QUANTITY ACTUALLY FURNISHED AT THE UNIT PRICE BID FOR THE WORK.

FOR STABILIZATION, ALL TYPE III BARRICADES WILL REQUIRE A MINIMUM OF FOUR SAND BAGS PER BARRICADE.

ANY REFERENCE TO A STANDARD IN THESE PLANS SHALL BE INTERPRETED TO MEAN THE EDITION AS INDICATED BY THE SUBNUMBER SHOWN IN THE LIST OF STANDARDS OR THE COPY INCLUDED IN THESE PLANS.

THE CONTRACTOR SHALL CONTACT JULIE AT LEAST 48 HOURS PRIOR TO EXCAVATION TO DETERMINE WHICH UTILITIES ARE IN THE AREA.

COMMITMENTS

DISPOSAL OF EXCAVATED MATERIALS. ALL UNSUITABLE OR UNSTABLE MATERIALS, DEFINED AS SOILS, EMBANKMENTS, SUB-BASE GRANULAR MATERIALS, AND/OR AGGREGATE MATERIALS THAT ARE EXCAVATED DUE TO CONSTRUCTION OPERATIONS SHALL BE DISPOSED OF WITHIN THE LIMITS OF THE EXISTING RIGHT OF WAY. DISPOSAL OF EXCAVATED MATERIALS, AS DEFINED ABOVE, OFF THE EXISTING RIGHT OF WAY SHALL NOT BE PERMITTED.

EXCAVATED MATERIALS SHALL BE DISPOSED OF AT LOCATIONS DIRECTED BY THE ENGINEER. ANY SUCH DISPOSAL SHALL NOT CREATE AND UNSIGHTLY OR OBJECTIONABLE APPEARANCE OR DETRACT FROM THE NATURAL TOPOGRAPHIC FEATURES WITHOUT WRITTEN PERMISSION FROM THE ENGINEER.

DATE: 4-3-2013

PREPARED BY: Don Brundage
DISTRICT STUDIES & PLANS ENGINEER

EXAMINED BY: Richard [Signature]
DISTRICT CONSTRUCTION ENGINEER

Wayne L. Phillips
DISTRICT MATERIALS ENGINEER

Bruce C. Hicken
DISTRICT OPERATIONS ENGINEER

FILE NAME *	USER NAME * potelyj	DESIGNED - RW	REVISED -	STATE OF ILLINOIS DEPARTMENT OF TRANSPORTATION	GENERAL NOTES	F.A.I. RTE.	SECTION	COUNTY	TOTAL SHEETS	SHEET NO.
01\pwork\pwidot\potelyj\0336599\0366	92-ehk-details.dgn	DRAWN - RW	REVISED -			57	D3 PATCHING 2014-4	IRROQUOIS	19	2
	PLOT SCALE * 100.0000' / 1" =	CHECKED -	REVISED -					CONTRACT NO. 66C92		
	PLOT DATE * 4/3/2013	DATE -	REVISED -			SCALE:	SHEET NO. 1 OF 1 SHEETS	STA.	TO STA.	(ILLINOIS) FED. AID PROJECT

CODE NO.	ITEM	UNIT	TOTAL QUANTITIES	CONSTR. CODE 100% STATE ROADWAY	
				0005 RURAL MAINLINE	RAMPS
44200610	CLASS A PATCHES, TYPE II, 13 INCH	SQ YD	1512	1512	
44200982	CLASS B PATCHES, TYPE II, 11 INCH	SQ YD	407		407
44201299	DOWEL BARS 1 1/2"	EACH	1036		1036
44213000	PATCH REINFORCEMENT	SQ YD	1512	1512	
44213100	PAVEMENT FABRIC	SQ YD	2326	1512	814
44213200	SAW CUTS	FOOT	11292	9072	2220
67100100	MOBILIZATION	L SUM	1	0.5	0.5
70100420	TRAFFIC CONTROL AND PROTECTION, STANDARD 701411	EACH	24	12	12
70100825	TRAFFIC CONTROL AND PROTECTION, STANDARD 701456	L SUM	1		1
70103815	TRAFFIC CONTROL SURVEILLANCE	CAL DAY	35	25	10
* 78009004	MODIFIED URETHANE PAVEMENT MARKING LINE 4"	FOOT	1554	1110	444
* 78009006	MODIFIED URETHANE PAVEMENT MARKING LINE 6"	FOOT	1350	1350	
X0326867	RADAR SPEED TRAILER	CAL MO	1	1	
X0326880	MESSAGE BOARD VEHICLE DRIVER	HOUR	280	280	
X0326907	PORTABLE, VEHICLE MOUNTED, CHANGEABLE MESSAGE SIGN	CAL MO	1	1	
X7010805	TRAFFIC CONTROL AND PROTECTION, STANDARD 701401 (SPECIAL)	L SUM	1	1	

* SPECIALITY ITEM

FILE NAME *	USER NAME * woodshankr1	DESIGNED - RW	REVISED -	STATE OF ILLINOIS DEPARTMENT OF TRANSPORTATION	SUMMARY OF QUANTITIES			F.A.I. RTE.	SECTION	COUNTY	TOTAL SHEETS	SHEET NO.
c:\pwwork\pwwork\woodshankr1\d0336999\0366C92-shr-dates1.dgn	DRAWN - RW	CHECKED -	REVISED -					57	D3 PATCHING 2014-4	IRROQUOIS	19	3
PLOT SCALE * 1/8"=1'-0"	CHECKED -	REVISED -	REVISED -		SCALE: SHEET NO. 1 OF 1 SHEETS STA. TO STA.			CONTRACT NO. 66C92				
PLOT DATE * 3/28/2013	DATE -	REVISED -	REVISED -		ILLINOIS FED. AID PROJECT							

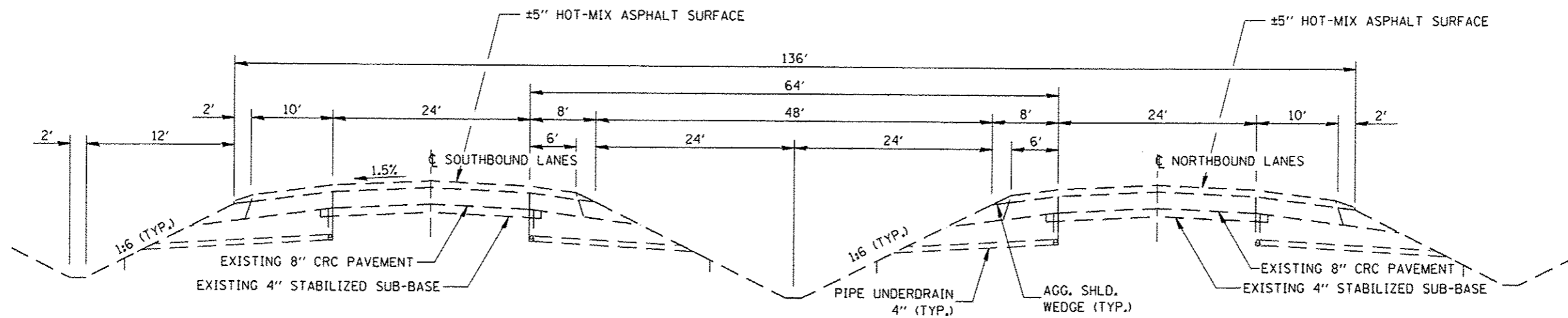

TYPICAL SECTION

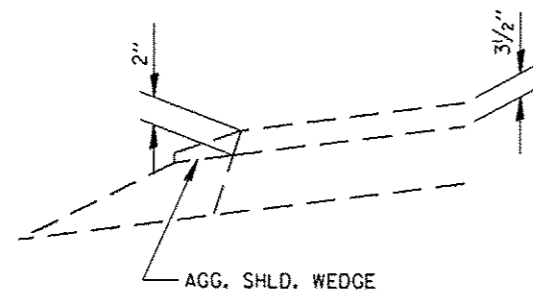

OUTSIDE SHOULDERS

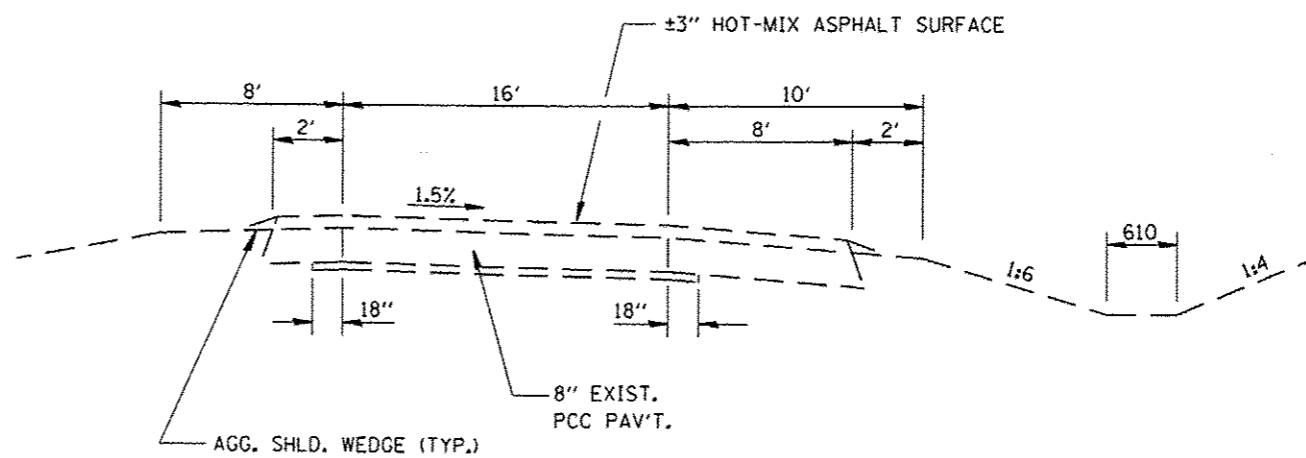

TYPICAL SECTION THRU RAMPS

FILE NAME :	USER NAME : woodshankr1	DESIGNED - RW	REVISED -
c:\pwwork\pwwork\woodshankr1\d8336599\366C92-sh1-detail.dgn		DRAWN - RW	REVISED -
	PLOT SCALE = 100.0000' / 1"	CHECKED -	REVISED -
	PLOT DATE = 3/28/2013	DATE -	REVISED -

STATE OF ILLINOIS
DEPARTMENT OF TRANSPORTATION

TYPICAL SECTIONS

SCALE: SHEET NO. 1 OF 1 SHEETS STA. TO STA.

F.A.I. RTE.	SECTION	COUNTY	TOTAL SHEETS	SHEET NO.
57	D3 PATCHING 2014-4	IROQUOIS	19	4
CONTRACT NO. 66C92				
[ILLINOIS] FED. AID PROJECT				

SCHEDULES
CLASS A PATCHES
NORTHBOUND LANES

LOCATION MILE POST	PASSING LANE				DRIVING LANE			
	TYPE II 13"	PATCH REINF.	PAV'T FABRIC	SAW CUTS	TYPE II 13"	PATCH REINF.	PAV'T FABRIC	SAW CUTS
	SQ YD	SQ YD	SQ YD	FOOT	SQ YD	SQ YD	SQ YD	FOOT
266.80	8	8	8	48	8	8	8	48
268.32	8	8	8	48	8	8	8	48
268.34					8	8	8	48
268.53	8	8	8	48	8	8	8	48
268.84	8	8	8	48	8	8	8	48
269.25	8	8	8	48	8	8	8	48
269.44	8	8	8	48	8	8	8	48
271.00	8	8	8	48	8	8	8	48
271.10	8	8	8	48	8	8	8	48
271.42					8	8	8	48
272.18					8	8	8	48
272.95					8	8	8	48
273.74					8	8	8	48
277.02					8	8	8	48
277.10					8	8	8	48
277.39	8	8	8	48	8	8	8	48
277.52	8	8	8	48	8	8	8	48
277.58					8	8	8	48
278.02					8	8	8	48
278.30	8	8	8	48				
278.45					8	8	8	48
278.66					8	8	8	48
280.82					8	8	8	48
281.32					8	8	8	48
282.00					8	8	8	48
283.10					8	8	8	48
283.42					8	8	8	48
284.04					8	8	8	48
284.40					8	8	8	48
284.50					8	8	8	48
284.90	8	8	8	48	8	8	8	48
285.00	8	8	8	48	8	8	8	48
285.52	8	8	8	48	8	8	8	48
286.50	8	8	8	48	8	8	8	48
287.59					8	8	8	48
287.68					8	8	8	48
288.80	8	8	8	48	8	8	8	48
289.10	8	8	8	48				
289.62	8	8	8	48	8	8	8	48
PAGE 1 TOTAL	144	144	144	864	296	296	296	1776

SCHEDULE
PAVEMENT MARKING
NORTHBOUND LANES

LOCATION MILE POST	MODIFIED URETHANE PAVEMENT MARKING LINE 4"		MODIFIED URETHANE PAVEMENT MARKING LINE 6"
	FEET		FEET
	YELLOW	WHITE	WHITE
266.80	6	6	10
268.32	6	6	10
268.34		6	10
268.53	6	6	10
268.84	6	6	10
269.25	6	6	10
269.44	6	6	10
271.00	6	6	10
271.10	6	6	10
271.42		6	10
272.18		6	10
272.95		6	10
273.74		6	10
277.02		6	10
277.10		6	10
277.39	6	6	10
277.52	6	6	10
277.58		6	10
278.02		6	10
278.30	6		10
278.45		6	10
278.66		6	10
280.82		6	10
281.32		6	10
282.00		6	10
283.10		6	10
283.42		6	10
284.04		6	10
284.40		6	10
284.50		6	10
284.90	6	6	10
285.00	6	6	10
285.52	6	6	10
286.50	6	6	10
287.59		6	10
287.68		6	10
288.80	6	6	10
289.10	6		10
289.62	6	6	10
PAGE 1 TOTAL	108	222	390

SCHEDULE
PAVEMENT MARKING
NORTHBOUND LANES

LOCATION MILE POST	MODIFIED URETHANE PAVEMENT MARKING LINE 4"		MODIFIED URETHANE PAVEMENT MARKING LINE 6"
	FEET		FEET
	YELLOW	WHITE	WHITE
292.34		6	10
292.50		6	10
292.60		6	10
293.08		6	10
293.15	6		10
293.82	6		10
294.04	6		10
299.70	6	6	10
300.52	6	6	10
300.58	6	6	10
PAGE 2 TOTAL	36	42	100
NB TOTALS	408		490

SCHEDULE
PAVEMENT MARKING
NORTHBOUND RAMPS

LOCATION EXIT NO.	L.M.	MODIFIED URETHANE PAVEMENT MARKING LINE 4"		
		FEET		
		YELLOW	WHITE	
272	EXIT	0.02	6	6
		0.07	6	6
		0.14	6	6
		0.23	6	6
		0.01	6	6
	ENTRANCE	0.06	6	6
		0.11	6	6
		0.15	6	6
		0.21	6	6
		0.02	6	6
280	EXIT	0.18	6	6
		0.20	6	6
	ENTRANCE	0.04	6	6
		0.12	6	6
		0.19	6	6
		0.23	6	6
283	EXIT	0.05	6	6
		0.18	6	6
	ENTRANCE	0.20	6	6
		0.03	6	6
		0.08	6	6
		0.12	6	6
		0.19	6	6
		0.2	6	6
PAGE TOTAL		144	144	
NB RAMP TOTALS		288		

SCHEDULES
CLASS A PATCHES
SOUTHBOUND LANES

LOCATION MILE POST	PASS LANE	DRIVE LANE	PASSING LANE				DRIVING LANE			
			TYPE II 13"	PATCH REINF.	PAV'T FABRIC	SAW CUTS	TYPE II 13"	PATCH REINF.	PAV'T FABRIC	SAW CUTS
			SQ YD	SQ YD	SQ YD	FOOT	SQ YD	SQ YD	SQ YD	FOOT
300.37	6	6	8	8	8	48	8	8	8	48
300.30	6	6	8	8	8	48	8	8	8	48
300.28		6					8	8	8	48
299.70	6	6	8	8	8	48	8	8	8	48
299.65	6	6	8	8	8	48	8	8	8	48
299.60	6	6	8	8	8	48	8	8	8	48
299.49	6	6	8	8	8	48	8	8	8	48
299.47	6	6	8	8	8	48	8	8	8	48
299.41	6	6	8	8	8	48	8	8	8	48
298.26		6					8	8	8	48
293.15		6					8	8	8	48
292.00		6					8	8	8	48
290.50		6					8	8	8	48
290.48		6					8	8	8	48
285.70		6					8	8	8	48
285.65	6	6	8	8	8	48	8	8	8	48
285.60	6	6	8	8	8	48	8	8	8	48
283.70		6					8	8	8	48
282.68		6					8	8	8	48
282.67	6		8	8	8	48				
282.66		6					8	8	8	48
282.65		6					8	8	8	48
282.48		6					8	8	8	48
282.44		6					8	8	8	48
282.40		6					8	8	8	48
282.31		6					8	8	8	48
282.30		6					8	8	8	48
282.28		6					8	8	8	48
282.25		6					8	8	8	48
282.18		6					8	8	8	48
282.17	6	6	8	8	8	48	8	8	8	48
282.15	6	6	8	8	8	48	8	8	8	48
282.10	6	6	8	8	8	48	8	8	8	48
282.09	6	6	8	8	8	48	8	8	8	48
281.98		6					8	8	8	48
281.18		6					8	8	8	48
280.70	6	6	8	8	8	48	8	8	8	48
280.66	6		8	8	8	48				
280.58	6	6	8	8	8	48				
PAGE 1 TOTAL	108	222	144	144	144	864	296	296	296	1776

SCHEDULES
CLASS A PATCHES
SOUTHBOUND LANES

LOCATION MILE POST	PASS LANE	DRIVE LANE	PASSING LANE				DRIVING LANE			
			TYPE II 13"	PATCH REINF.	PAV'T FABRIC	SAW CUTS	TYPE II 13"	PATCH REINF.	PAV'T FABRIC	SAW CUTS
			SO YD	SO YD	SO YD	FOOT	SO YD	SO YD	SO YD	FOOT
280.50		6					8	8	8	48
280.48		6					8	8	8	48
280.20		6					8	8	8	48
280.00		6					8	8	8	48
279.91	6		8	8	8	48				
279.89	6		8	8	8	48				
279.87	6		8	8	8	48				
278.55	6	6	8	8	8	48	8	8	8	48
277.88	6	6	8	8	8	48	8	8	8	48
277.85	6	6	8	8	8	48	8	8	8	48
277.82	6	6	8	8	8	48	8	8	8	48
277.20	6		8	8	8	48				
277.17	6	6	8	8	8	48	8	8	8	48
276.88		6					8	8	8	48
276.82		6					8	8	8	48
276.70		6					8	8	8	48
276.66		6					8	8	8	48
276.65		6					8	8	8	48
276.51		6					8	8	8	48
276.49		6					8	8	8	48
276.45		6					8	8	8	48
276.38		6					8	8	8	48
276.28		6					8	8	8	48
276.08		6					8	8	8	48
276.05		6					8	8	8	48
276.00	6	6	8	8	8	48	8	8	8	48
275.99		6					8	8	8	48
275.98		6					8	8	8	48
275.96	6	6	8	8	8	48	8	8	8	48
275.80	6		8	8	8	48				
275.78		6					8	8	8	48
275.70		6					8	8	8	48
275.61		6					8	8	8	48
275.50	6		8	8	8	48				
275.25		6					8	8	8	48
275.21	6		8	8	8	48				
275.05		6					8	8	8	48
275.04		6					8	8	8	48
274.98		6					8	8	8	48
PAGE 2 TOTAL	84	192	112	112	112	672	256	256	256	1536

SCHEDULES
CLASS A PATCHES
SOUTHBOUND LANES

LOCATION MILE POST	PASS LANE	DRIVE LANE	PASSING LANE				DRIVING LANE			
			TYPE II 13''	PATCH REINF.	PAV'T FABRIC	SAW CUTS	TYPE II 13''	PATCH REINF.	PAV'T FABRIC	SAW CUTS
			SQ YD	SQ YD	SQ YD	FOOT	SQ YD	SQ YD	SQ YD	FOOT
274.90	6	6	8	8	8	48	8	8	8	48
271.41	6	6	8	8	8	48	8	8	8	48
270.70	6	6	8	8	8	48	8	8	8	48
270.66	6	6	8	8	8	48	8	8	8	48
269.56	6	6	8	8	8	48	8	8	8	48
268.60	6	6	8	8	8	48	8	8	8	48
268.10	6	6	8	8	8	48	8	8	8	48
265.50	6	6	8	8	8	48	8	8	8	48
265.48	6	6	8	8	8	48	8	8	8	48
264.92	6	6	8	8	8	48	8	8	8	48
PAGE 3 TOTAL	60	60	80	80	80	480	80	80	80	480
SB TOTALS	252	474	336	336	336	2016	632	632	632	3792

SCHEDULE
PAVEMENT MARKING
SOUTHBOUND LANES

LOCATION MILE POST	MODIFIED URETHANE PAVEMENT MARKING LINE 4"		MODIFIED URETHANE PAVEMENT MARKING LINE 6"
	FEET		FEET
	YELLOW	WHITE	WHITE
300.37	6	6	10
300.30	6	6	10
300.28		6	10
299.70	6	6	10
299.65	6	6	10
299.60	6	6	10
299.49	6	6	10
299.47	6	6	10
299.41	6	6	10
298.26		6	10
293.15		6	10
292.00		6	10
290.50		6	10
290.48		6	10
285.70		6	10
285.65	6	6	10
285.60	6	6	10
283.70		6	10
282.68		6	10
282.67	6		10
282.66		6	10
282.65		6	10
282.48		6	10
282.44		6	10
282.40		6	10
282.31		6	10
282.30		6	10
282.28		6	10
282.25		6	10
282.18		6	10
282.17	6	6	10
282.15	6	6	10
282.10	6	6	10
282.09	6	6	10
281.98		6	10
281.18		6	10
280.70	6	6	10
280.66	6		10
280.58	6	6	10
PAGE 1 TOTAL	108	222	390

SCHEDULE
PAVEMENT MARKING
SOUTHBOUND LANES

LOCATION MILE POST	MODIFIED URETHANE PAVEMENT MARKING LINE 4"		MODIFIED URETHANE PAVEMENT MARKING LINE 6"
	FEET		FEET
	YELLOW	WHITE	WHITE
280.50		6	10
280.48		6	10
280.20		6	10
280.00		6	10
279.91	6		10
279.89	6		10
279.87	6		10
278.55	6	6	10
277.88	6	6	10
277.85	6	6	10
277.82	6	6	10
277.20	6		10
277.17	6	6	10
276.88		6	10
276.82		6	10
276.70		6	10
276.66		6	10
276.65		6	10
276.51		6	10
276.49		6	10
276.45		6	10
276.38		6	10
276.28		6	10
276.08		6	10
276.05		6	10
276.00	6	6	10
275.99		6	10
275.98		6	10
275.96	6	6	10
275.80	6		10
275.78		6	10
275.70		6	10
275.61		6	10
275.50	6		10
275.25		6	10
275.21	6		10
275.05		6	10
275.04		6	10
274.98		6	10
PAGE 2 TOTAL	84	192	390

SCHEDULE
PAVEMENT MARKING
SOUTHBOUND LANES

LOCATION MILE POST	MODIFIED URETHANE PAVEMENT MARKING LINE 4"		MODIFIED URETHANE PAVEMENT MARKING LINE 6"
	FEET		FEET
	YELLOW	WHITE	WHITE
274.90	6	6	10
271.41	6	6	10
270.70	6	6	10
270.66	6	6	10
269.56	6	6	10
268.60	6	6	10
268.10	6	6	10
265.50	6	6	10
PAGE 3 TOTAL	48	48	80
SB TOTALS	702		860

SCHEDULE
PAVEMENT MARKING
SOUTHBOUND RAMPS

LOCATION		L.M.	MODIFIED URETHANE PAVEMENT MARKING LINE 4"	
EXIT NO.	EXIT		FEET	
			YELLOW	WHITE
283	EXIT	0.03	6	6
		0.07	6	6
		0.02	6	6
	ENTRANCE	0.05	6	6
		0.11	6	6
		0.16	6	6
280	EXIT	0.19	6	6
		0.02	6	6
		0.18	6	6
272	EXIT	0.21	6	6
		0.05	6	6
		0.08	6	6
PAGE TOTAL			78	78
SB RAMP TOTALS			156	

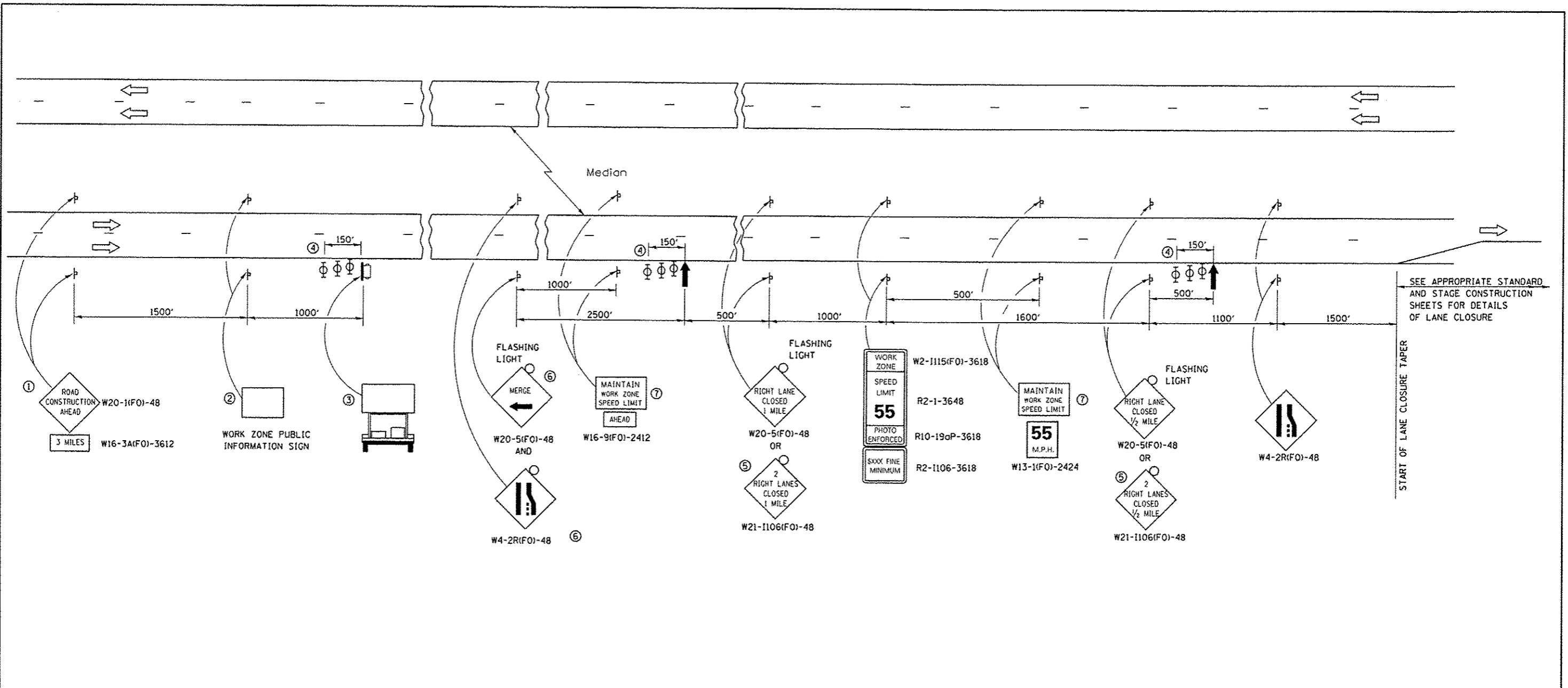

- ① THE ROAD CONSTRUCTION AHEAD SIGN SHALL BE LOCATED 3 MILES IN ADVANCE OF THE PROJECT LIMITS.
- ② THE MESSAGE AND SIZE OF THE WORK ZONE PUBLIC INFORMATION SIGN SHALL BE AS SPECIFIED BY THE DEPARTMENT.
- ③ TO BE PLACED IN THE MEDIAN WHEN FEASIBLE. THE MESSAGE BOARD SHALL BE USED TO DISPLAY STATUS OF LANES WITHIN THE PROJECT. THE PRIMARY MESSAGES SHALL BE:
 "RIGHT LANE CLOSED" / " x MILES AHEAD"
 "LEFT LANE CLOSED" / " x MILES AHEAD"
 "ALL LANES OPEN"
- ④ THREE, TYPE II BARRICADES, DRUMS, OR VERTICAL BARRICADES AT 50' CENTERS.
- ⑤ THIS SIGN SHALL BE USED WHEN 2 LANES ARE CLOSED.
- ⑥ WHEN THE LEFT LANE IS CLOSED, SWITCH THESE TWO SIGNS AND THE DIRECTION OF THE MERGE ARROW.

⑦ 48"x36" FLUORESCENT ORANGE SIGN WITH BLACK LETTERS.

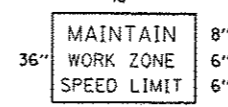

- ↑ ARROW BOARD
- PORTABLE CHANGEABLE MESSAGE SIGN
- ⊥ SIGN
- ⊕ TYPE II BARRICADE, DRUM, OR VERTICAL BARRICADE WITH MONODIRECTIONAL FLASHING LIGHT

GENERAL NOTE:

THIS STANDARD IS USED WHERE AT ANY TIME A LANE IS CLOSED ON A FREEWAY/EXPRESSWAY.

WHEN THE LEFT LANE IS CLOSED, LEFT LANE CLOSED SIGNS SHALL BE SUBSTITUTED FOR THE RIGHT LANE CLOSED SIGNS.

THE FIRST TWO SIGNS AND THE MESSAGE BOARD ARE STATIONARY. THE OTHER SIGNS AND ARROWBOARDS SHALL BE MOVED AS NECESSARY TO MAINTAIN THE REQUIRED DISTANCE FROM THE START OF THE LANE CLOSURE TAPER(S).

SEE SPECIAL PROVISIONS.

FILE NAME =	USER NAME = woodshankr1	DESIGNED - RW	REVISED -	STATE OF ILLINOIS DEPARTMENT OF TRANSPORTATION	TRAFFIC CONTROL AND PROTECTION STANDARD 701400 (SPECIAL)	F.A.I. RTE.	SECTION	COUNTY	TOTAL SHEETS	SHEET NO.
c:\pwwork\pwwork\woodshankr1\d0326599\366C92-sh1-detail.dgn	DRAWN - RW	REVISED -	57			D3 PATCHING 2014-4	ILLINOIS	19	12	
PLOT SCALE = 1/8"=1'-0"	CHECKED -	REVISED -	CONTRACT NO. 66C92							
PLOT DATE = 3/28/2013	DATE -	REVISED -	ILLINOIS FED. AID PROJECT							

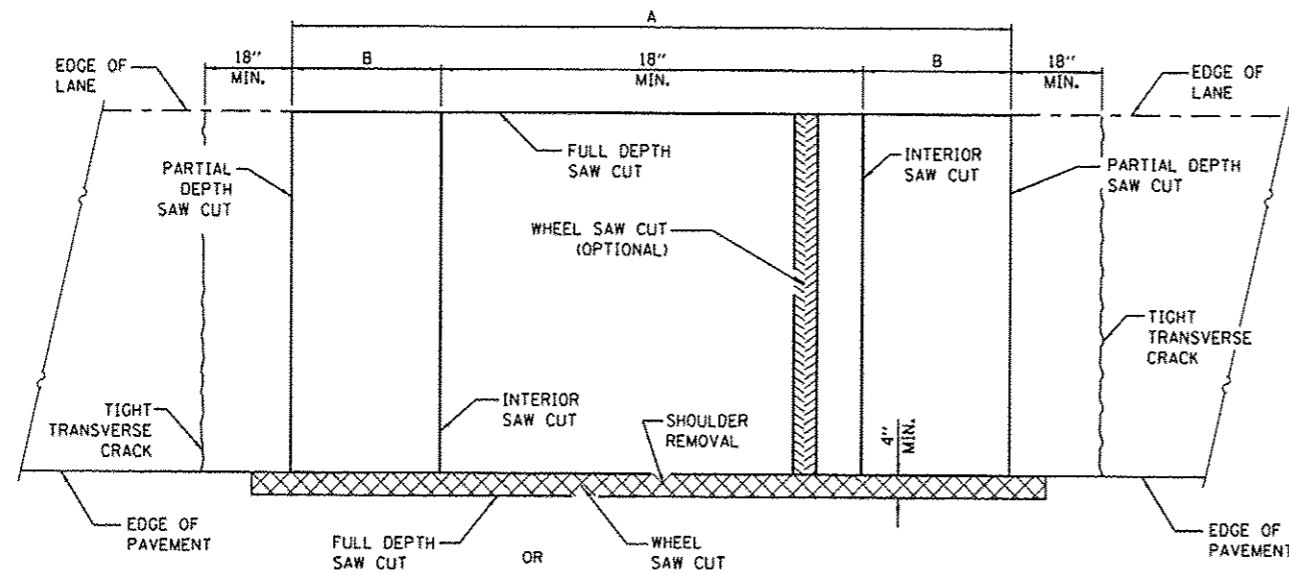

PAVEMENT SAWING DETAIL
(HMA SHOULDER)

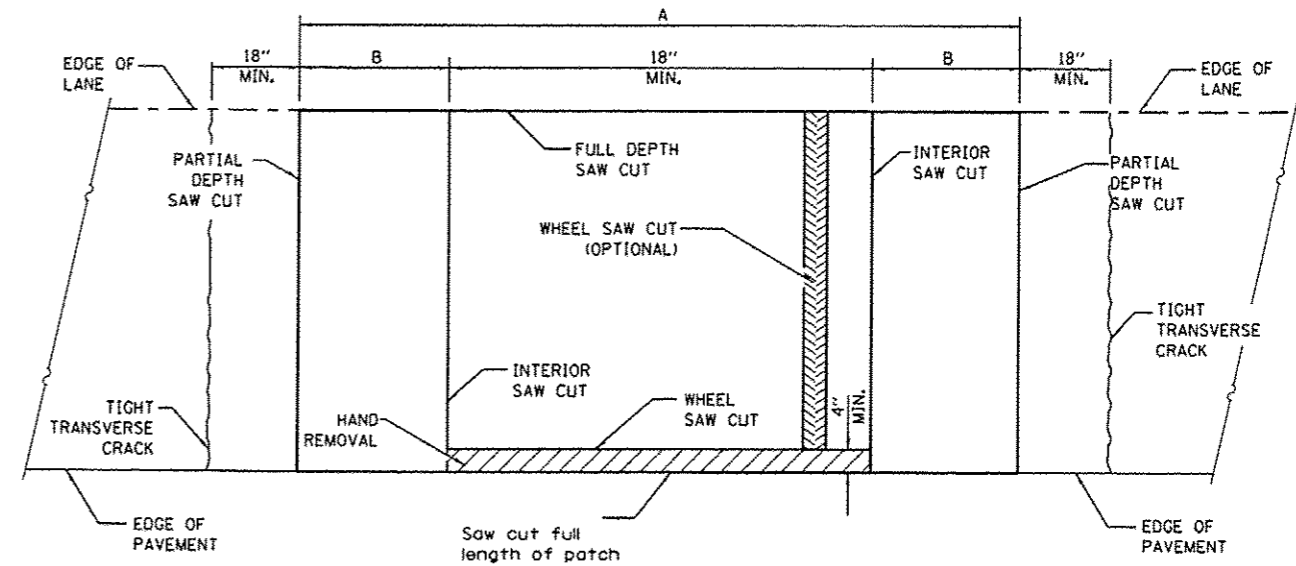

PAVEMENT SAWING DETAIL
(PCC SHOULDER)

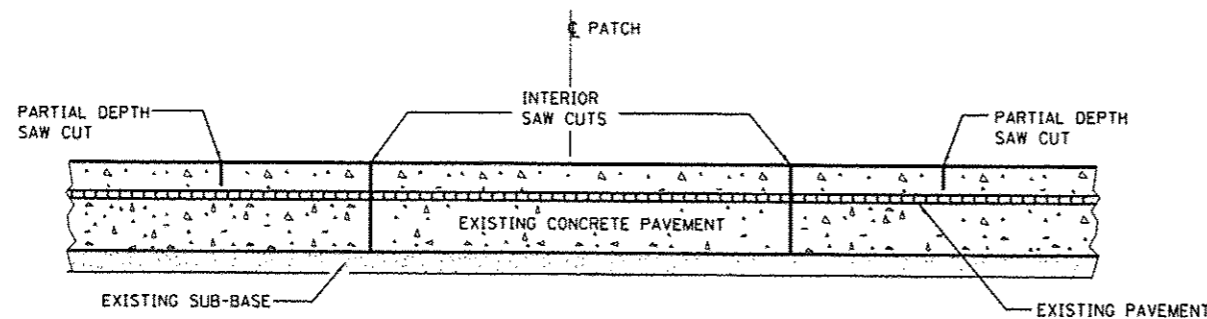

SAW CUT DETAIL
WITHOUT HMA SURFACE

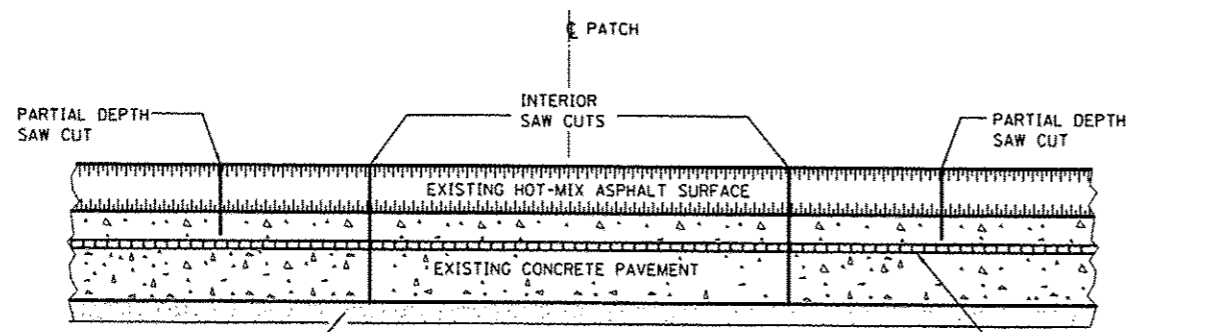

SAW CUT DETAIL
WITH HMA SURFACE

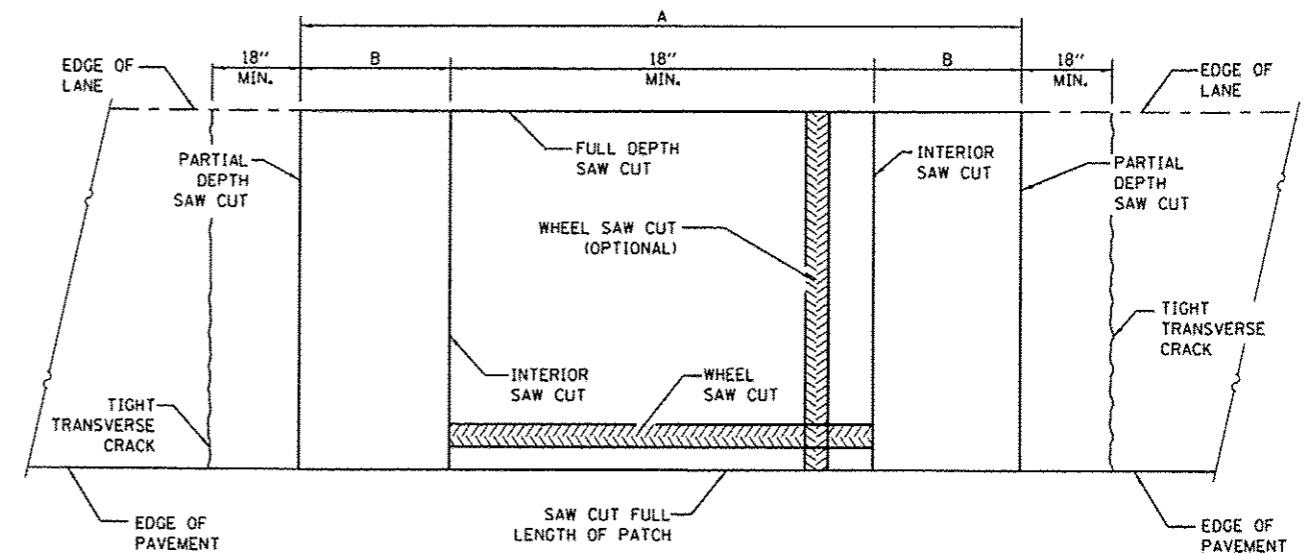

ALTERNATE SAWING DETAIL
(PCC SHOULDER)

EXISTING REINFORCEMENT BARS	A (MIN.)	B (MIN.)	C (MIN.)
#5	4'-6"	18"	16"
#6	5'-0"	21"	19"
#7	5'-6"	24"	22"
FABRIC	5'-0"	21"	18"

GENERAL NOTES

WHEN PATCHING TWO ADJACENT LANES IN ONE OPERATION THE LONGITUDINAL JOINT SHALL BE LONGITUDINAL SAWED JOINT AS DETAILED ON STANDARD 42001, HOWEVER, THE GROOVE MAYBE EITHER PREFORMED OR SAWED.

SEE STANDARD 421001 FOR DETAILS OF PAVEMENT REINFORCEMENT.

FILE NAME *	USER NAME * woodshankr	DESIGNED -	REVISED -
c:\pwwork\psidot\woodshankr\10336599\0366092-shit-details.dgn		DRAWN -	REVISED -
#MODELNAME*	PLOT SCALE * 100.0000' / in.	CHECKED -	REVISED -
	PLOT DATE * 3/28/2013	DATE -	REVISED -

STATE OF ILLINOIS
DEPARTMENT OF TRANSPORTATION

CLASS A PATCHES

SCALE: SHEET 1 OF 3 SHEETS STA. TO STA.

F.A.I. RTE.	SECTION	COUNTY	TOTAL SHEETS	SHEET NO.
57	03 PATCHING 2014-4	IROQUOIS	19	13
CONTRACT NO. 66C92			[ILLINOIS] FED. AID PROJECT	

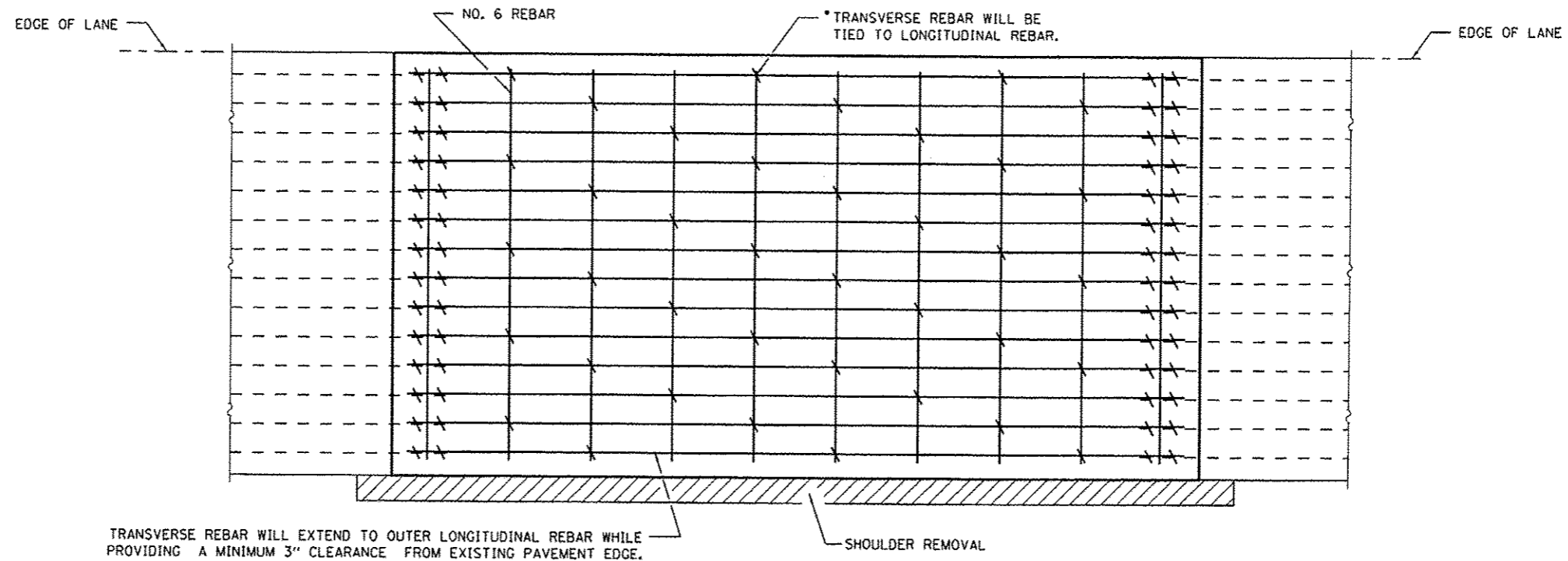

PAVEMENT REINFORCEMENT DETAIL

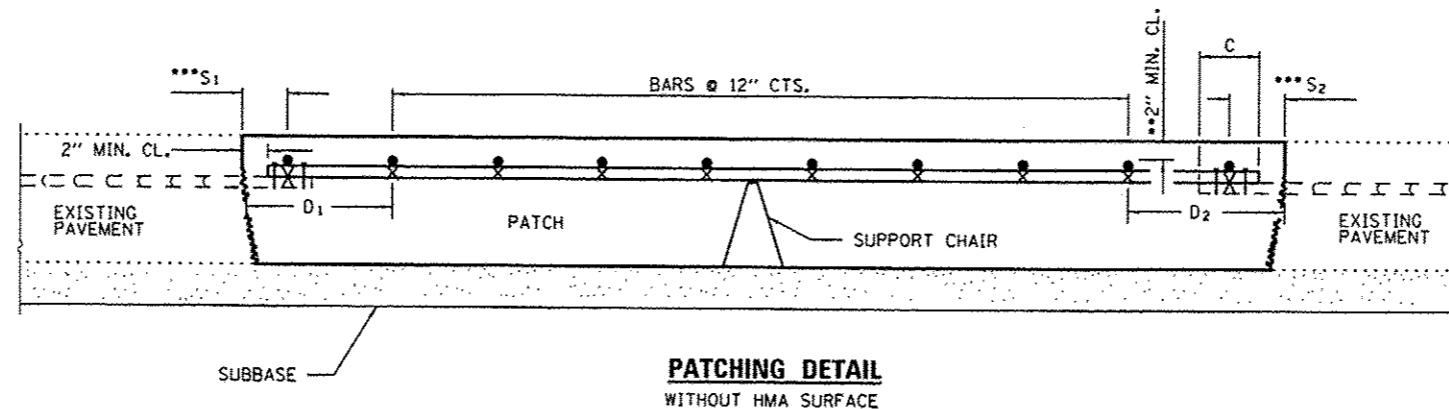

**PATCHING DETAIL
WITHOUT HMA SURFACE**

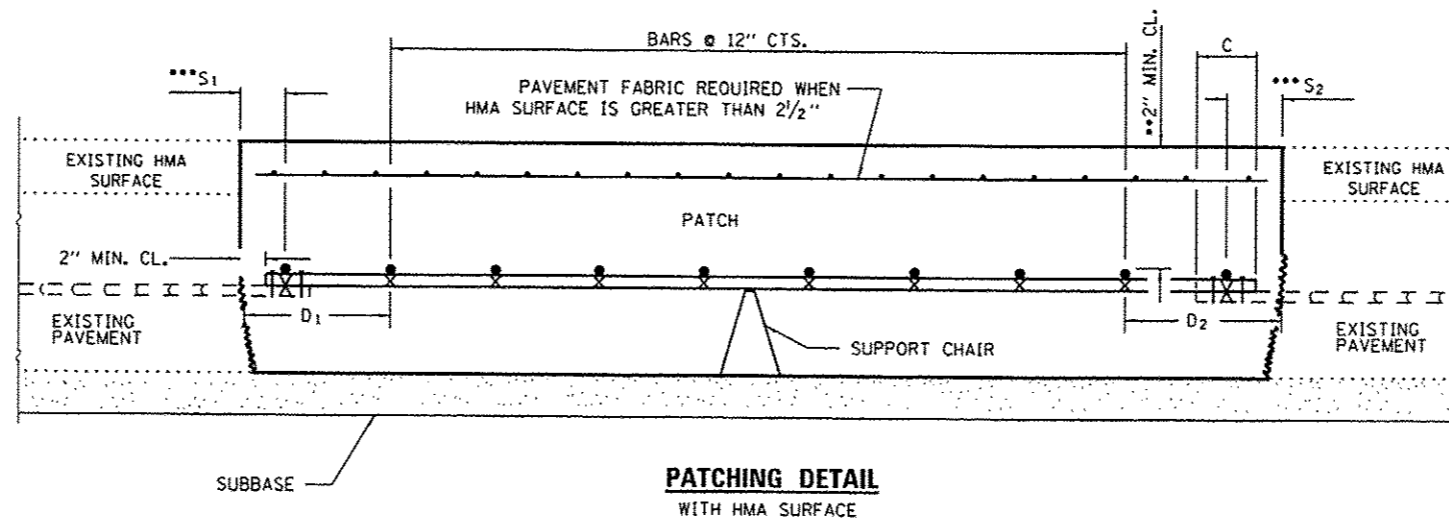

**PATCHING DETAIL
WITH HMA SURFACE**

- EVERY 3rd INTERSECTION MUST BE TIED.
- ** WHEN THE MINIMUM CLEARANCE CANNOT BE OBTAINED WITH THE TRANSVERSE REBAR ON TOP, THEN THE TRANSVERSE REBAR SHALL BE TIED TO THE BOTTOM OF THE LONGITUDINAL REBAR.
- *** VARIABLES: WHERE S_1 AND S_2 ARE $2\frac{1}{2}$ " MIN. AND 12" MAX. $D_1 = 2(S_1)$ AND $D_2 = 2(S_2)$.

FILE NAME :	USER NAME :	DESIGNED :	REVISED :
c:\pwwork\p\dot\woodshenkr1\0338599\066C92-shd-details.dgn	woodshenkr1	-	-
MODELNAME:	PLLOT SCALE :	CHECKED :	REVISED :
	100.0000' / 1"	-	-
	PLLOT DATE :	DATE :	REVISED :
	3/28/2013	-	-

STATE OF ILLINOIS
DEPARTMENT OF TRANSPORTATION

CLASS A PATCHES

SCALE: SHEET 2 OF 3 SHEETS STA. TO STA.

F.A.I. RTE.	SECTION	COUNTY	TOTAL SHEETS	SHEET NO.
57	D3 PATCHING 2014-4	IROQUOIS	19	14
				CONTRACT NO. 66C92
ILLINOIS FED. AID PROJECT				

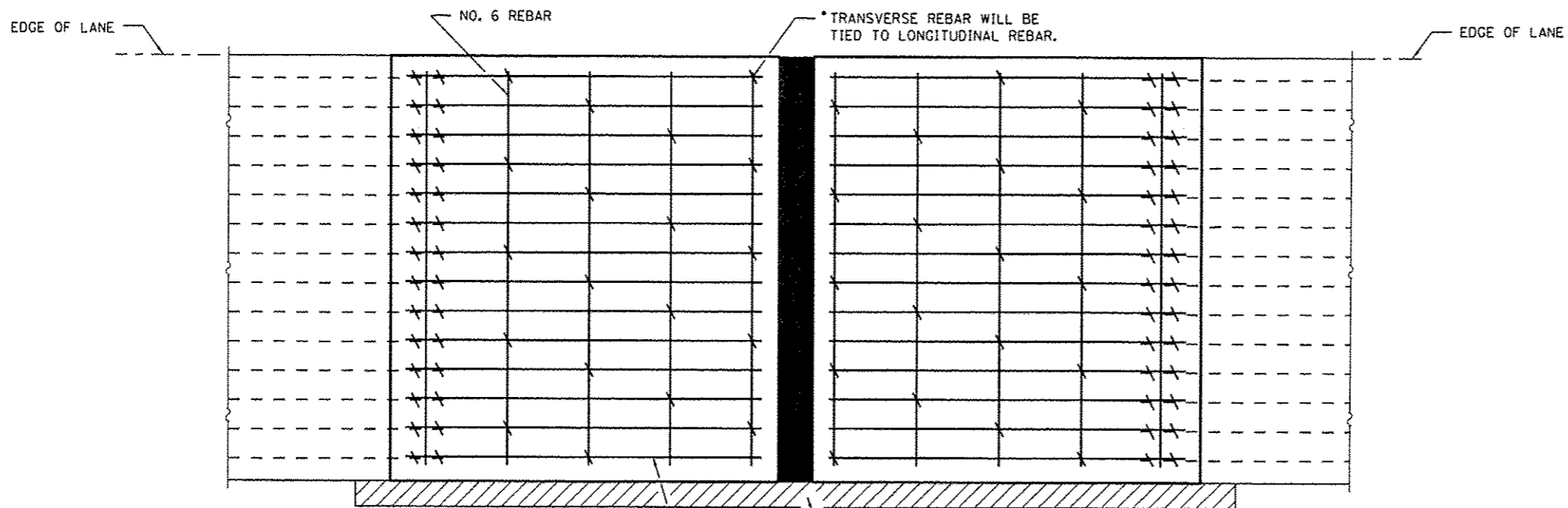

TRANSVERSE REBAR WILL EXTEND TO OUTER LONGITUDINAL REBAR WHILE PROVIDING A MINIMUM 3" CLEARANCE FROM EXISTING PAVEMENT EDGE.

PAVEMENT REINFORCEMENT DETAIL

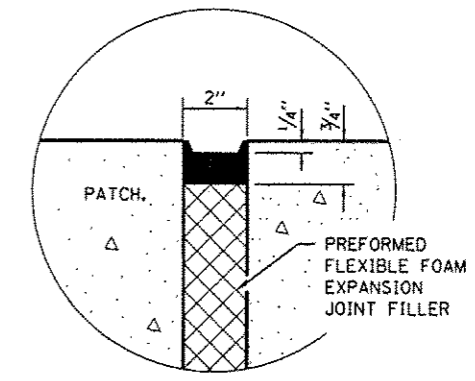

SEALING DETAIL

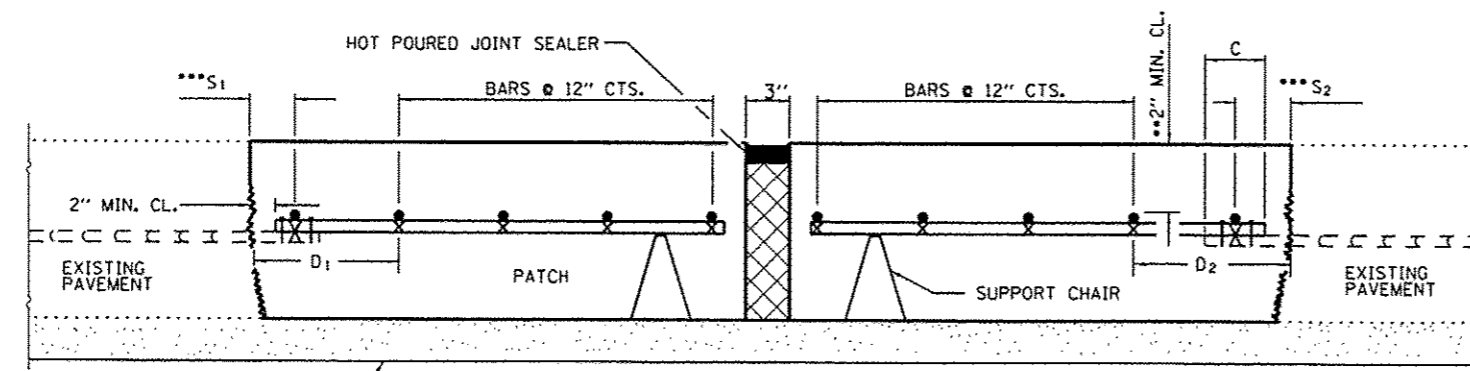

PATCHING DETAIL - EXPANSION WITHOUT HMA SURFACE

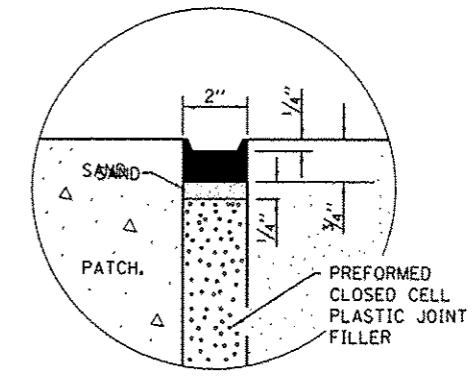

SEALING DETAIL

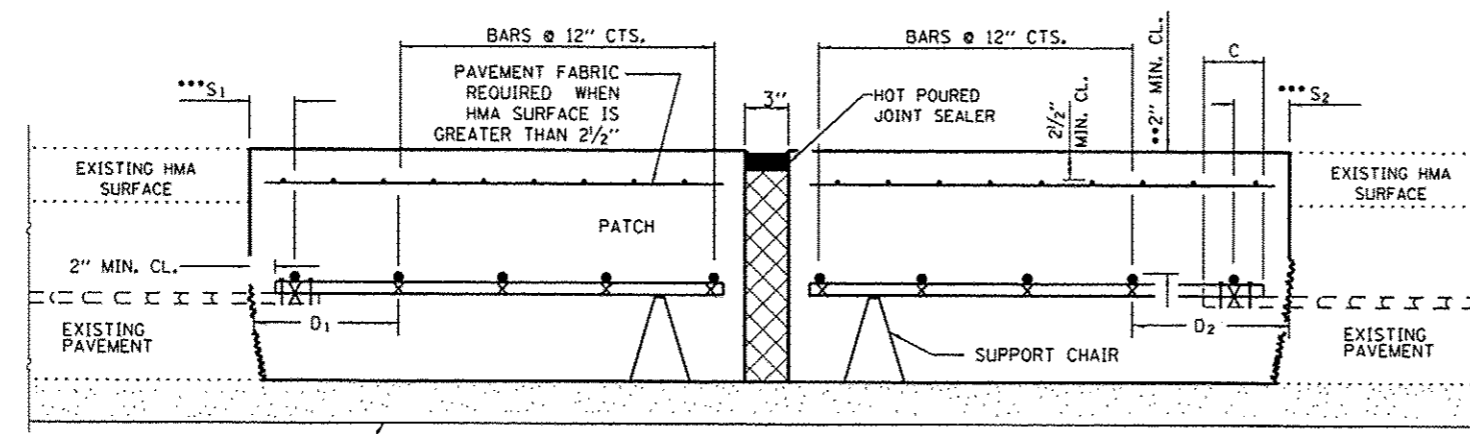

PATCHING DETAIL - EXPANSION WITH HMA SURFACE

- EVERY 3rd INTERSECTION MUST BE TIED.
 - ** WHEN THE MINIMUM CLEARANCE CANNOT BE OBTAINED WITH THE TRANSVERSE REBAR ON TOP, THEN THE TRANSVERSE REBAR SHALL BE TIED TO THE BOTTOM OF THE LONGITUDINAL REBAR.
 - ***
- VARIABLES: WHERE S^1 AND S^2 ARE $2\frac{1}{2}$ " MIN. AND 12" MAX. $D = 2(S^1)$ AND $D = 2(S^2)$.

FILE NAME =	USER NAME = woodshenkr1	DESIGNED -	REVISED -	STATE OF ILLINOIS DEPARTMENT OF TRANSPORTATION	CLASS A PATCHES WITH EXPANSION	F.A.I. RTE.	SECTION	COUNTY	TOTAL SHEETS	SHEET NO.	
on:\p\work\p\ridot\woodshenkr1\d8336599\036692-ah1-details.dgn	36692-ah1	DRAWN -	REVISED -			57	D3 PATCHING 2014-4	IROQUOIS	19	15	
PLOT SCALE = 1/8" = 1' / in.		CHECKED -	REVISED -			CONTRACT NO. 66C92					
PLOT DATE = 3/20/2013		DATE -	REVISED -			ILLINOIS FED. AID PROJECT					

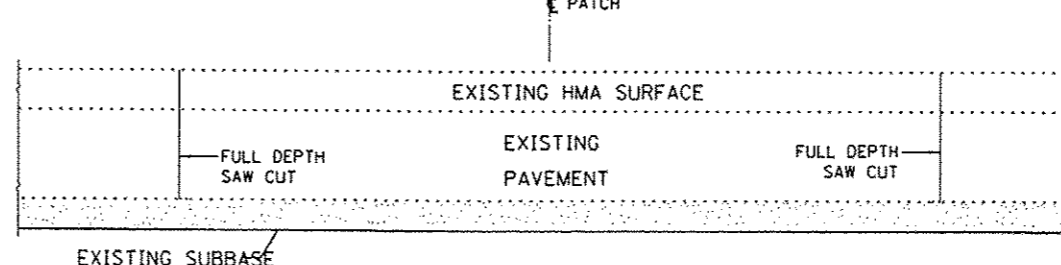
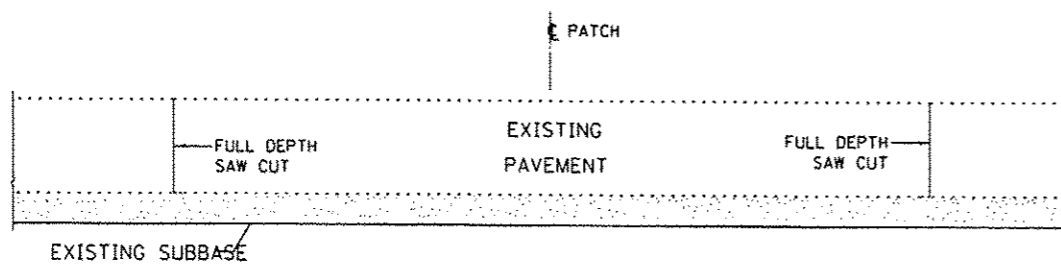
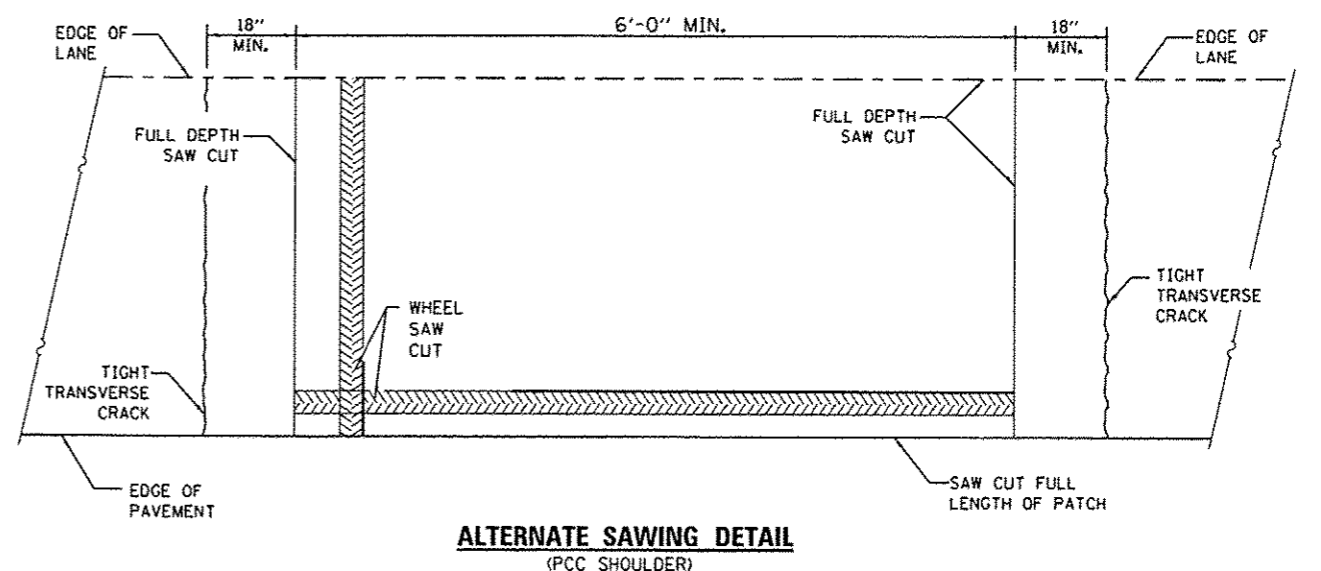
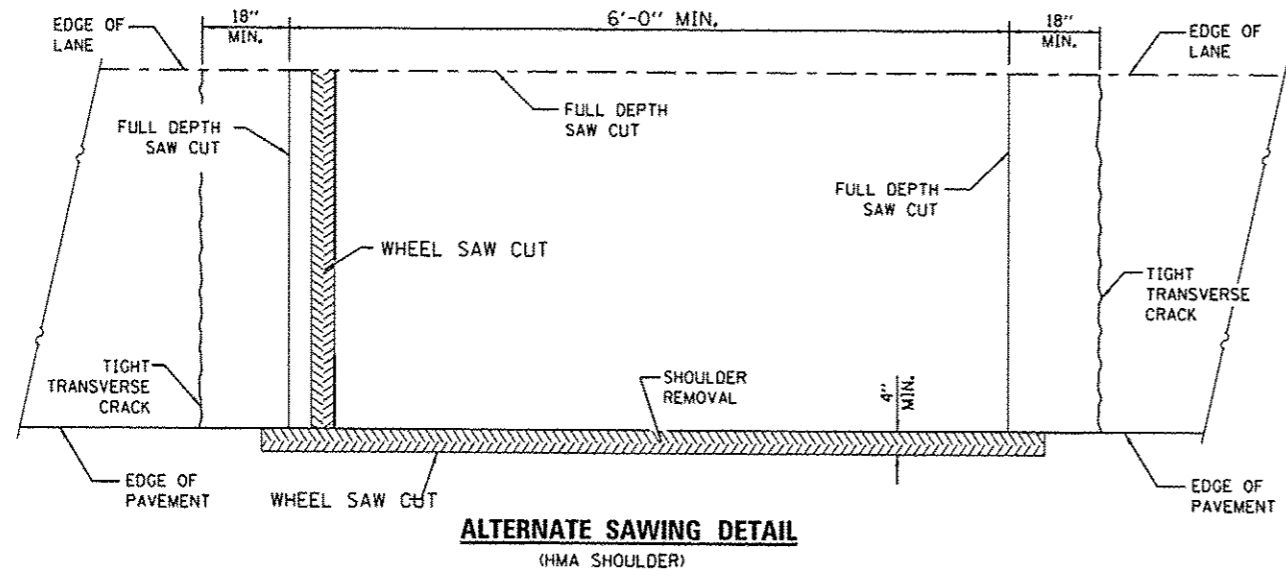
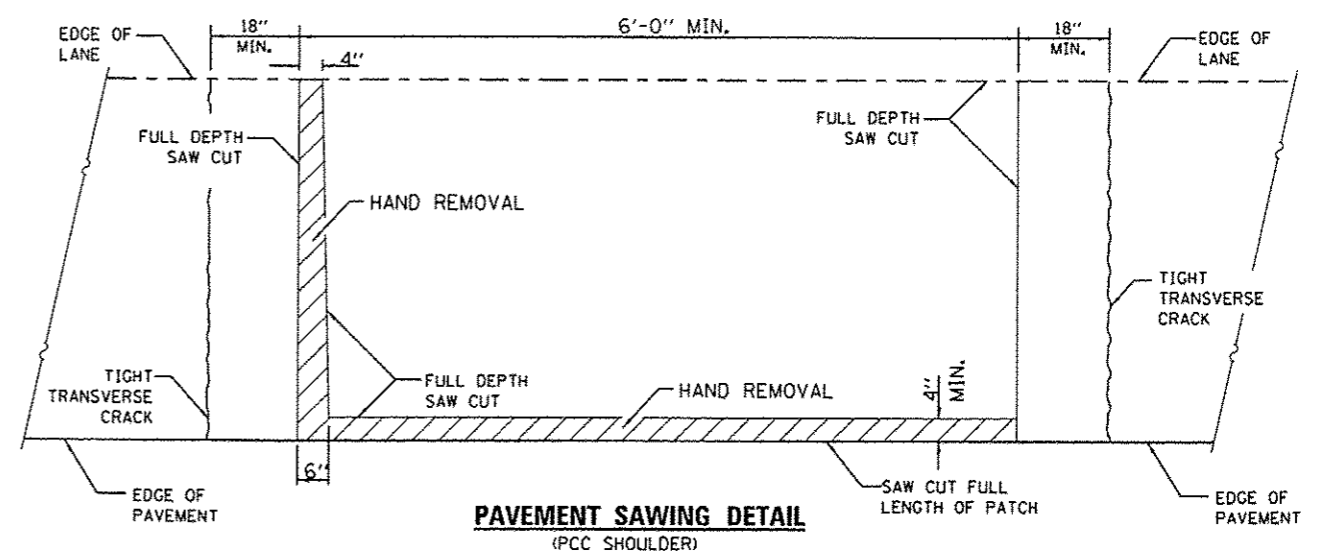
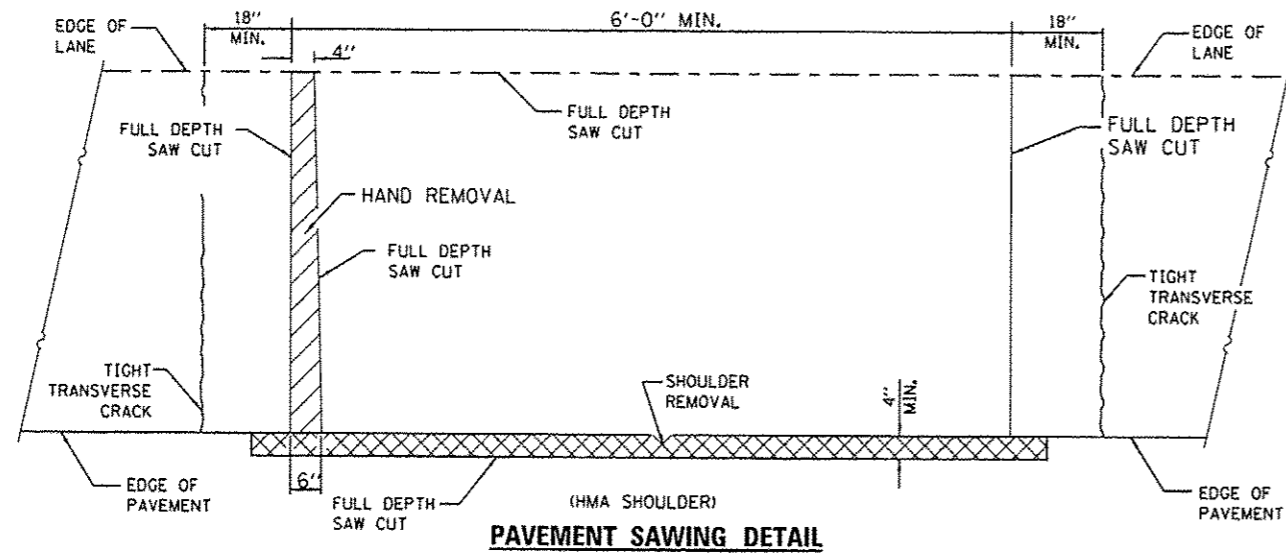

GENERAL NOTES

THE TRANSVERSE JOINTS FOR CLASS B PATCHES SHALL ALIGN WITH JOINTS OR CRACKS IN THE ADJACENT LANE WHENEVER POSSIBLE.

SEE STANDARD 420701 FOR DDETAIL OF PAVEMENT FABRIC.

FILE NAME =	USER NAME = woodshankr1	DESIGNED -	REVISED -	STATE OF ILLINOIS DEPARTMENT OF TRANSPORTATION	CLASS B PATCHES	F.A.I. RTE.	SECTION	COUNTY	TOTAL SHEETS	SHEET NO.
c:\pwwork\pridot\woodshankr1\08336599\386C92-shd-detail.dgn	DRAWN -	REVISED -	57			03 PATCHING 2014-4	IROQUOIS	19	16	
PLOT SCALE = 100.0000' / 1"	CHECKED -	REVISED -	CONTRACT NO. 66C92							
MODELNAME	DATE -	REVISED -	ILLINOIS FED. AID PROJECT							
					SCALE:	SHEET 1 OF 3 SHEETS		STA.	TO STA.	

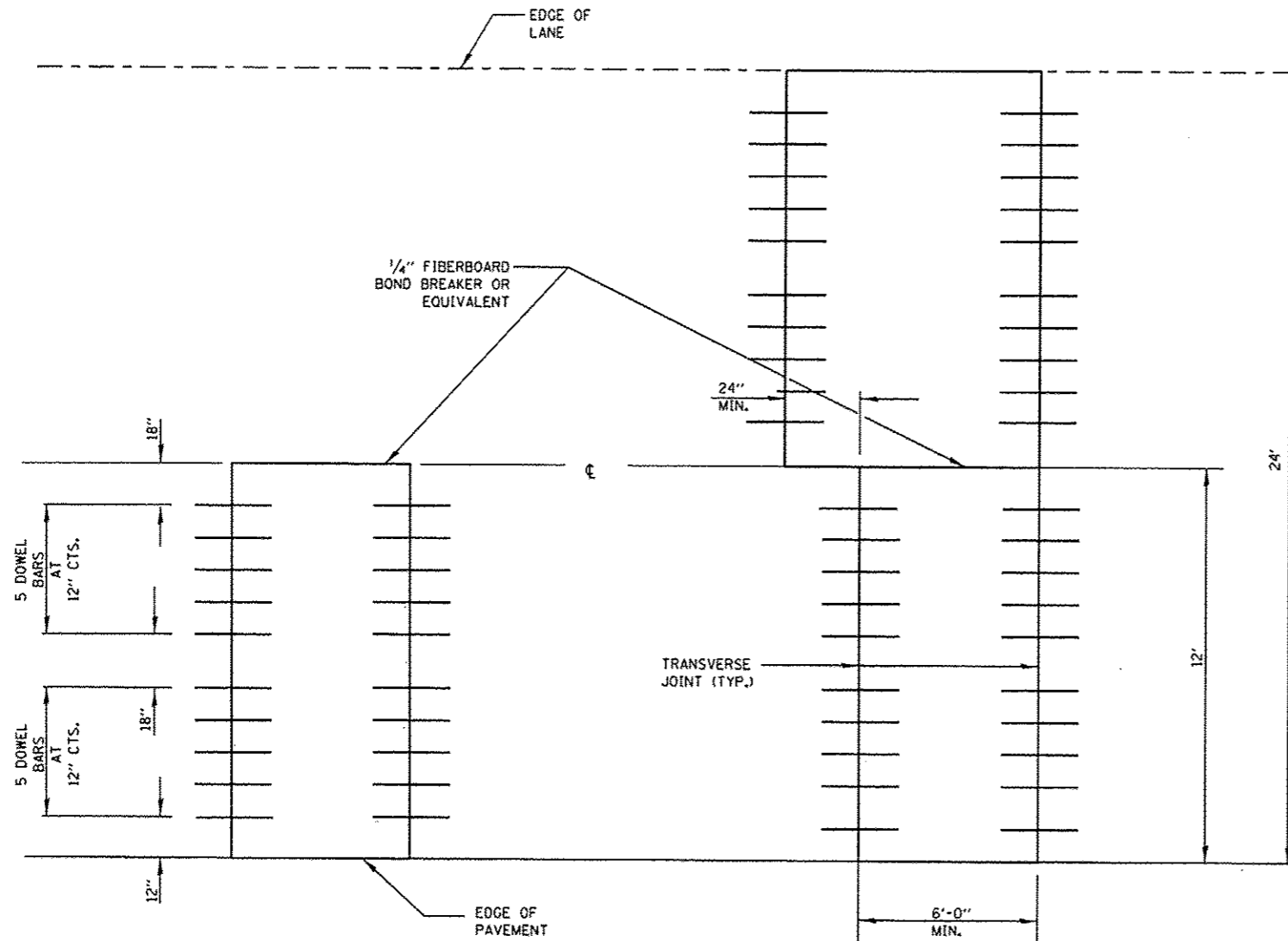

12' (3.6 m) WIDE LANES

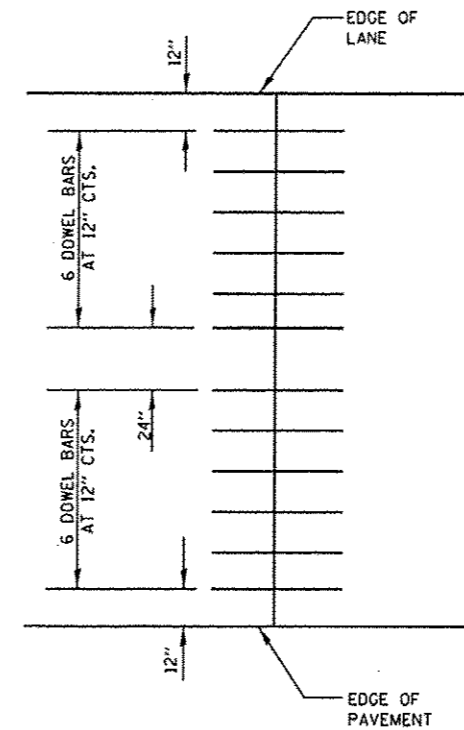

14' WIDE RAMP

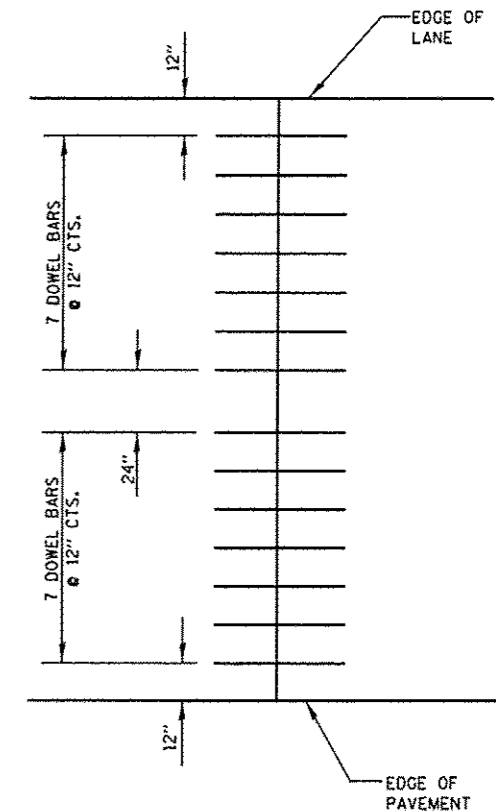

16' WIDE RAMP

FILE NAME *	USER NAME *	DESIGNED -	REVISED -
c:\pr_work\pedit\woodshankr\0336599\366C92-shr-details.dgn	woodshankr	DRAWN -	REVISED -
#MODELNAME*	PLOT SCALE * 100.0000' / in.	CHECKED -	REVISED -
	PLOT DATE * 3/28/2013	DATE -	REVISED -

STATE OF ILLINOIS
DEPARTMENT OF TRANSPORTATION

CLASS B PATCHES

SCALE: SHEET 2 OF 3 SHEETS STA. TO STA.

F.A.I. RTE.	SECTION	COUNTY	TOTAL SHEETS	SHEET NO.
57	D3 PATCHING 2014-4	IROQUOIS	19	17
			CONTRACT NO. 66C92	
ILLINOIS FED. AID PROJECT				

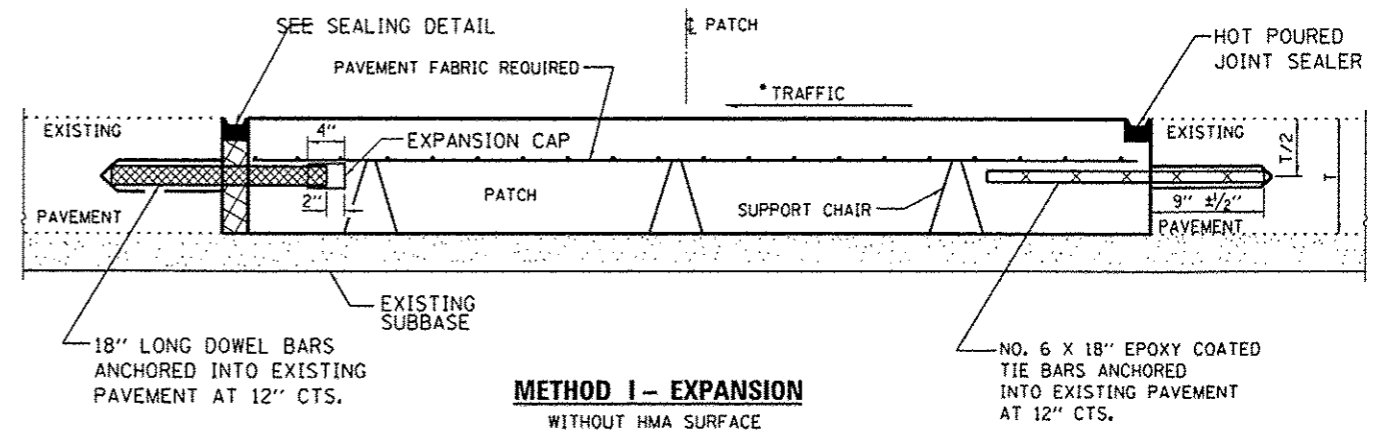
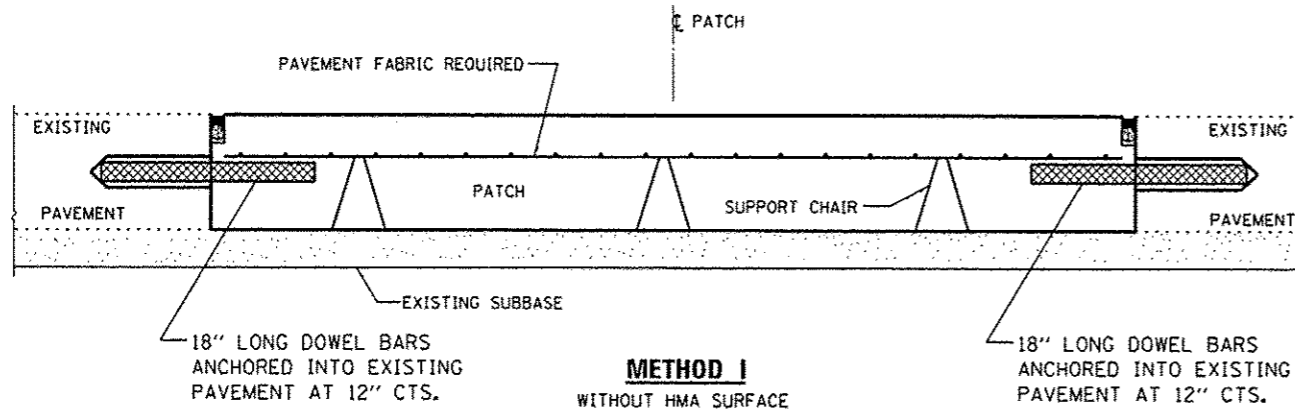

DOWEL BAR TABLE		
PAVEMENT THICKNESS	DOWEL BAR DIAMETER	HOLE DIAMETER
8" OR GREATER	1 1/2"	1 5/8"
7" THRU 7 5/8"	1 1/4"	1 3/8"
LESS THAN 7"	1"	1 1/8"

NOTE
 WHEN RE-ESTABLISHING A TRANSVERSE EXPANSION JOINT ON A TWO-LANE, TWO-WAY ROAD, REVERSE THE ORIENTATION OF THE DOWEL BARS WITH RESPECT TO TRAFFIC FOR ONE OF THE PATCHES SUCH THAT THE JOINT WILL BE CONTINUOUS ACROSS BOTH LANES.

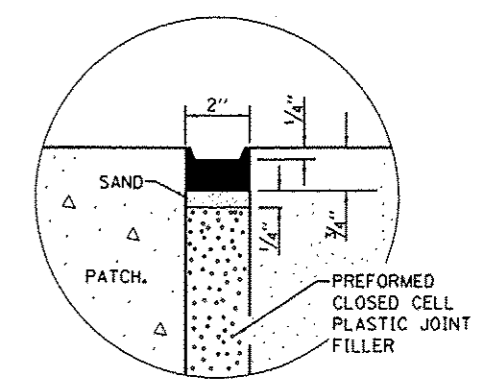
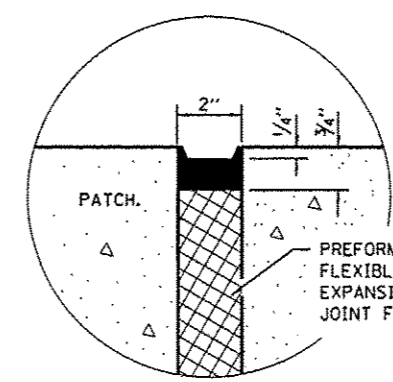
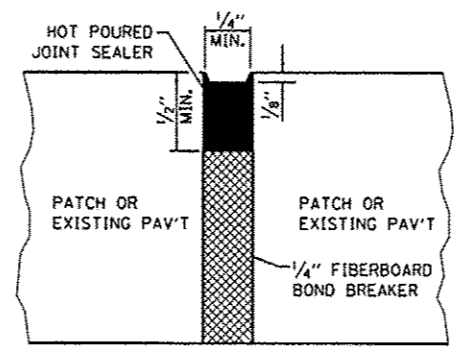
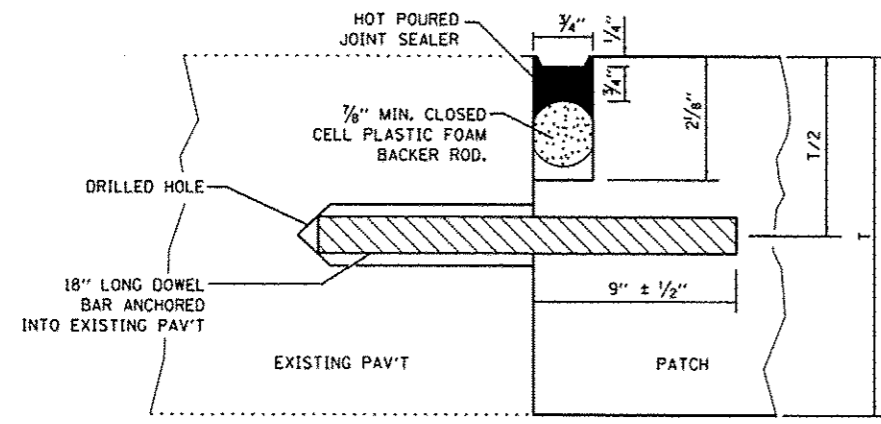
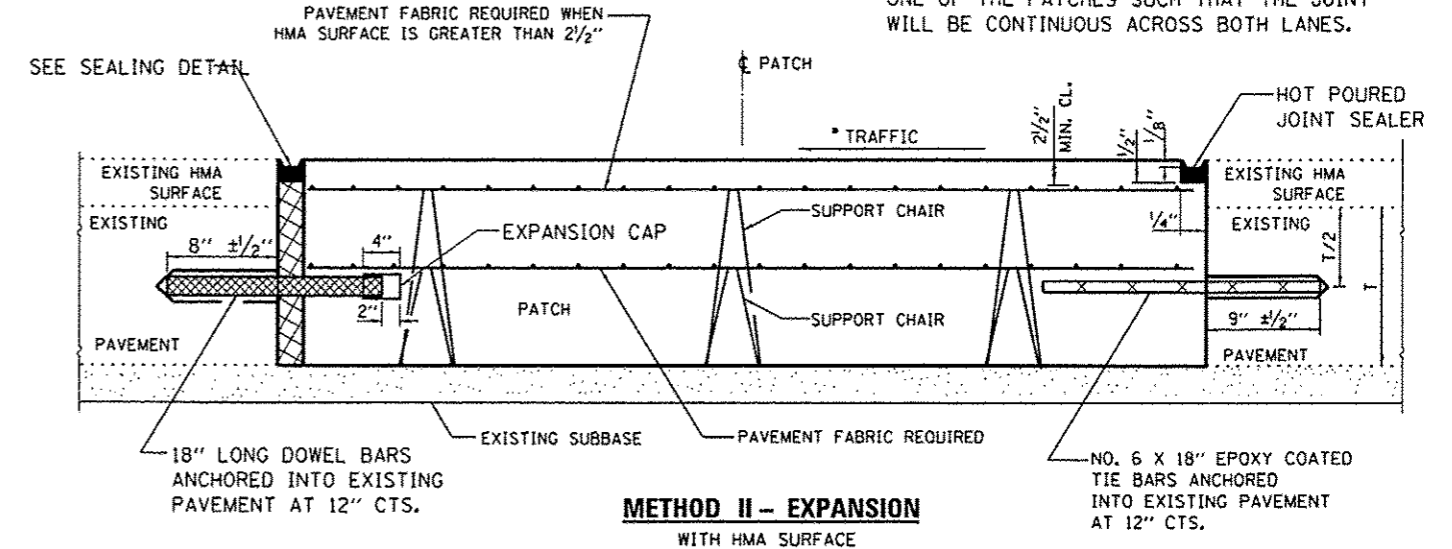
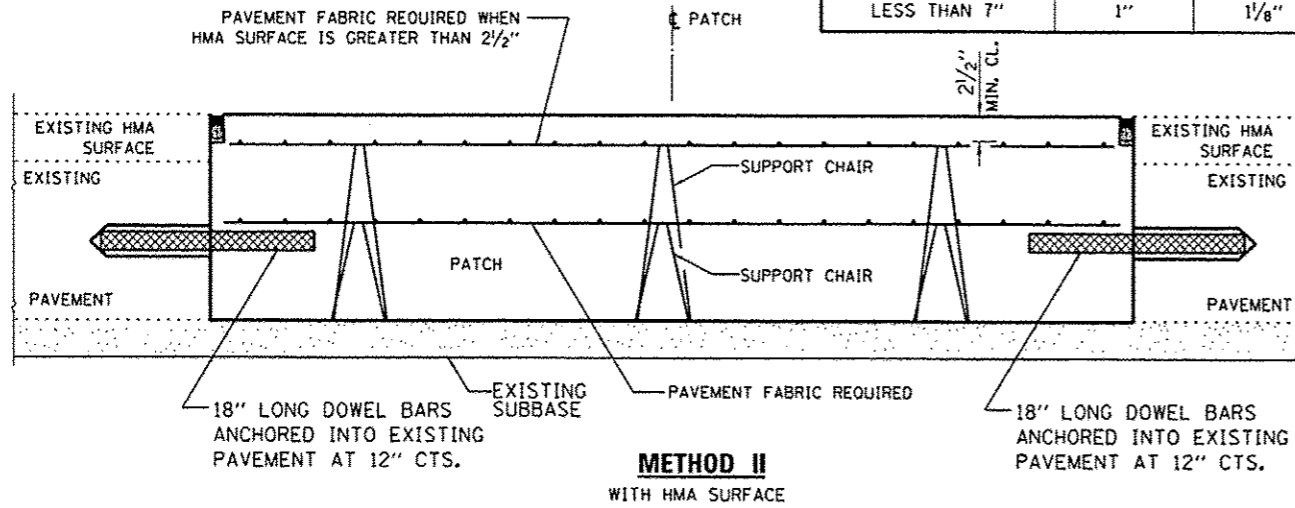

FILE NAME =	USER NAME = woodshankr1	DESIGNED -	REVISED -
c:\pwwork\pwwork\woodshankr1\d8336599\386C92-shr\details.dgn		DRAWN -	REVISED -
#MODELNAME#	PLOT SCALE = 100.0000 / 1 in.	CHECKED -	REVISED -
	PLOT DATE = 3/28/2013	DATE -	REVISED -

STATE OF ILLINOIS
 DEPARTMENT OF TRANSPORTATION

CLASS B PATCHES WITH EXPANSION

SCALE: SHEET 3 OF 3 SHEETS STA. TO STA.

F.A.I. RTE. 57	SECTION D3 PATCHING 2014-4	COUNTY IROQUOIS	TOTAL SHEETS 19	SHEET NO. 18
CONTRACT NO. 66C92			ILLINOIS FED. AID PROJECT	

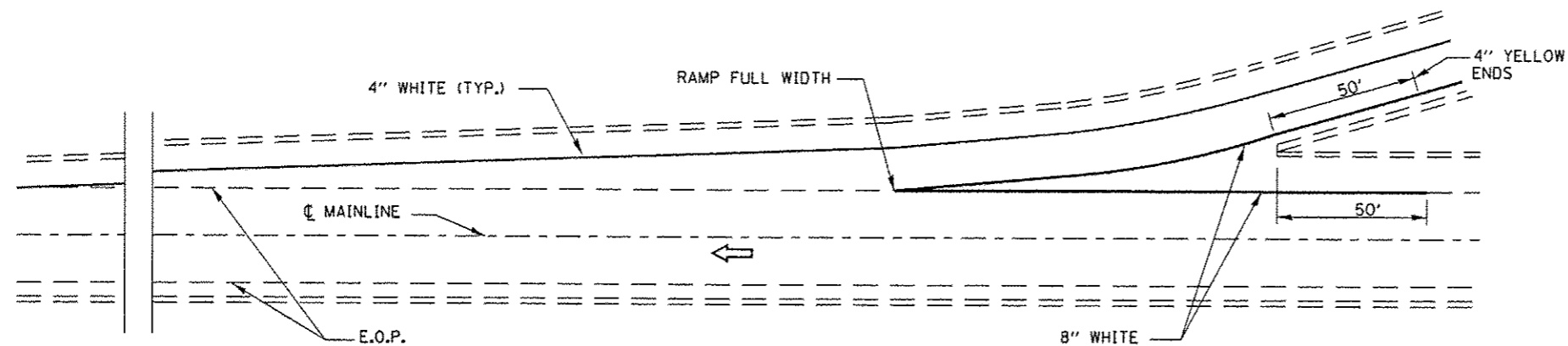

TYPICAL PAVEMENT MARKING FOR ENTRANCE RAMP TERMINALS

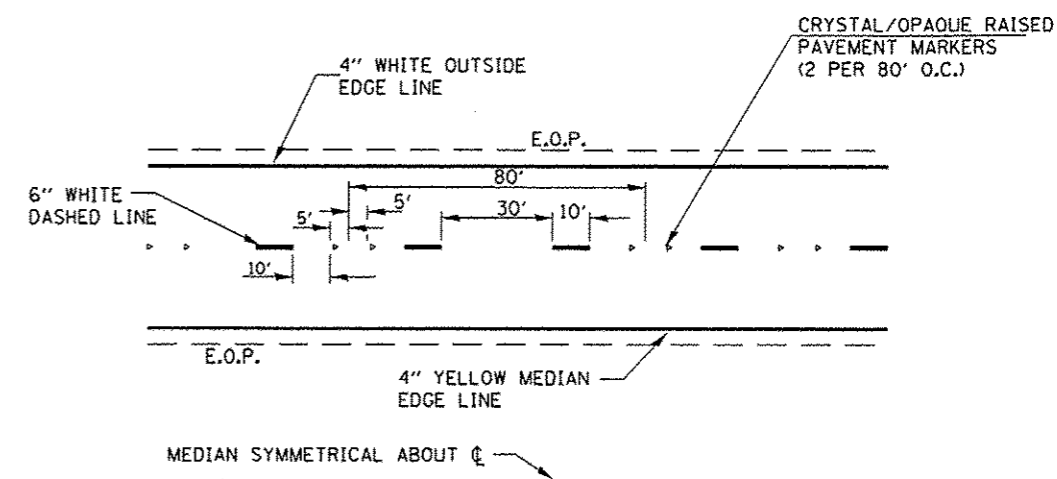

TYPICAL PAVEMENT MARKINGS

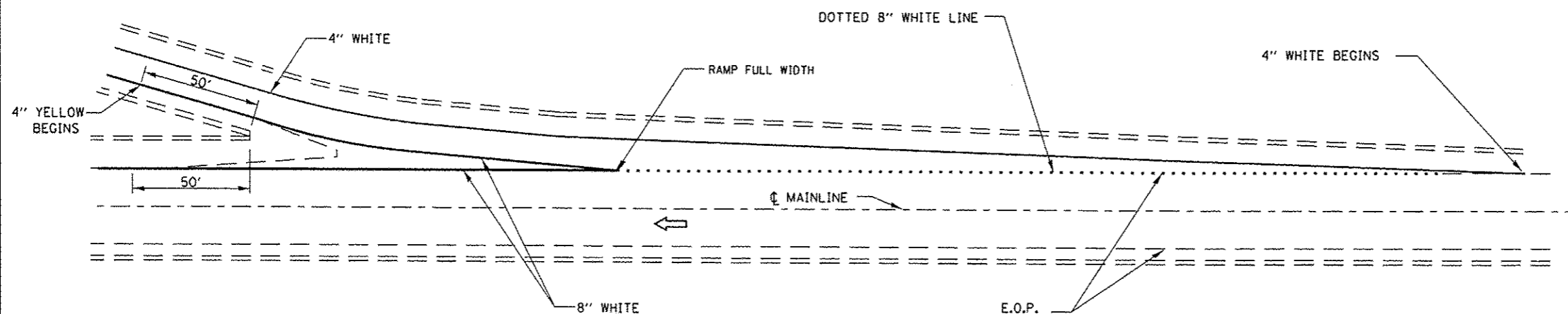

TYPICAL PAVEMENT MARKINGS FOR EXIT RAMP TERMINALS

FILE NAME =	USER NAME = woodshankr1	DESIGNED - RON WOODSHANK	REVISED -	STATE OF ILLINOIS DEPARTMENT OF TRANSPORTATION	TYPICAL PAVEMENT MARKING		F.A.T. RTE.	SECTION	COUNTY	TOTAL SHEETS	SHEET NO.
c:\pwwork\pwwork\woodshankr1\0336599\366C92-shr-details.dgn		DRAWN - RON WOODSHANK	REVISED -		57	D3 PATCHING 2014-4	IROQUOIS	19	19		
PLOT SCALE = 1/8" = 1'-0"		CHECKED -	REVISED -		SCALE: SHEET NO. 1 OF 1 SHEETS STA. TO STA.		CONTRACT NO. 66C92		ILLINOIS FED. AID PROJECT		
PLOT DATE = 3/28/2013		DATE -	REVISED -								