

INDEX OF SHEETS

1. COVER SHEET, INDEX OF SHEETS & STATE STANDARDS
2. SUMMARY OF QUANTITIES & GENERAL NOTES
3. TYPICAL SECTIONS
- 4-7. PAVEMENT PLAN
- 8-11. PAVEMENT MARKING PLAN
- 12-19. IDOT DISTRICT 1 STANDARD DETAILS

HIGHWAY STANDARDS

- 000001-06 STANDARD SYMBOLS, ABBREVIATIONS AND PATTERNS
424001-07 PERPENDICULAR CURB RAMPS
442201-03 CLASS C AND D PATCHES
606001-05 CONCRETE CURB TYPE B AND COMBINATION CONCRETE CURB AND GUTTER
701006-04 OFF ROAD OPERATIONS, 2L,2W, 15' TO 24' FROM PAVEMENT EDGE
701301-04 LANE CLOSURE, 2L,2W SHORT TIME OPERATIONS
701311-03 LANE CLOSURE, 2L,2W MOVING OPERATIONS - DAY ONLY
701501-06 URBAN LANE CLOSURE, 2L,2W, MOVING OPERATIONS - DAY ONLY
701502-05 URBAN LANE CLOSURE, 2L,2W, WITH BIDIRECTIONAL LEFT TURN LANE
701602-06 URBAN LANE CLOSURE, MULTILANE 2L,2W, WITH BIDIRECTIONAL LEFT TURN LANE
701701-08 URBAN LANE CLOSURE, MULTILANE INTERSECTION
701801-05 SIDEWALK, CORNER OR CROSSWALK CLOSURE
701901-02 TRAFFIC CONTROL DEVICES
886001-01 DETECTOR LOOP INSTALLATIONS

STATE OF ILLINOIS DEPARTMENT OF TRANSPORTATION DIVISION OF HIGHWAYS

PLANS FOR PROPOSED FEDERAL AID HIGHWAY

FAU 0286 (TAYLOR ROAD)
BUDLER ROAD TO FAP 0856 (WEBER ROAD)
ROADWAY RESURFACING
PROJECT NO.: M-4003 (157)
SECTION NO.: 13-00060-00-RS
VILLAGE of ROMEOVILLE
WILL COUNTY
C-91-171-13

F.A.H. NO.	SECTION	COUNTY	TOTAL SHEETS	SHEET NO.
0286	13-00060-00-RS	WILL	19	1
STA.	TO STA.			
FED. ROAD DIST. NO. 1	PLANES	FED. AID PROJECT NO.-4003 (157)		

CONTRACT #63824

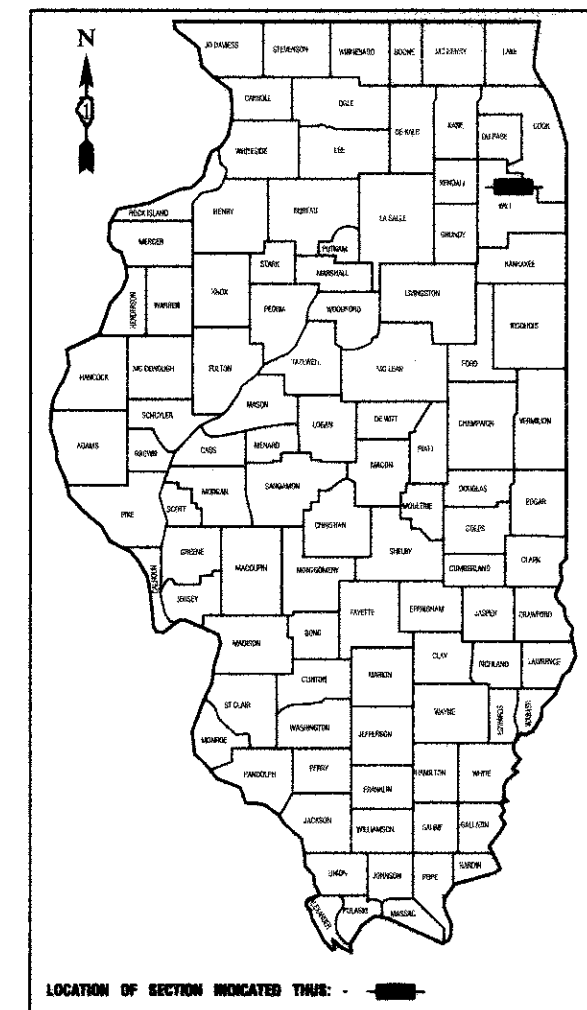

LOCATION OF SECTION INDICATED THIS: -

TAYLOR ROAD	
2012 ADT -	2,900
2040 ADT -	3,200
POSTED SPEED LIMIT -	35 mph
DESIGN PERIOD -	20 YEARS
DESIGN SPEED LIMIT -	40 mph
STREET CLASSIFICATION -	COLLECTOR

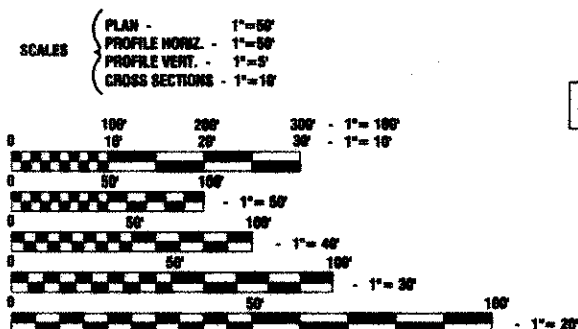

FULL SIZE PLANS HAVE BEEN PREPARED USING STANDARD ENGINEERING SCALES, REDUCED SIZED PLANS WILL NOT CONFORM TO STANDARD SCALES, IN MAKING MEASUREMENTS ON REDUCED PLANS, THE ABOVE SCALES MAY BE USED.

J. U. L. I. E.
JOINT UTILITY LOCATION INFORMATION FOR EXCAVATION
1-800-892-0123 or 811

CONTRACT NO. 63824

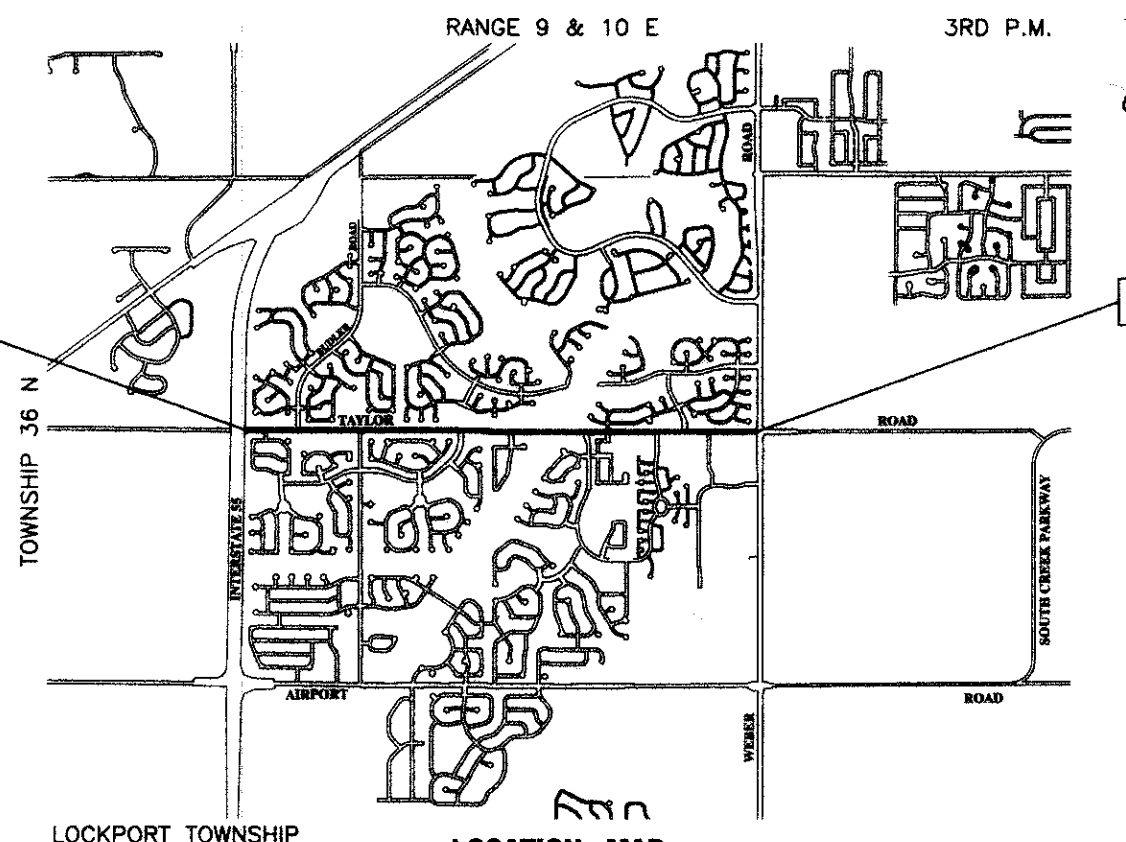

LOCATION MAP

GROSS LENGTH= 10,645 FEET= 2.02 MILES
NET LENGTH= 10,645 FEET= 2.02 MILES

STATE OF ILLINOIS DEPARTMENT OF TRANSPORTATION DIVISION OF HIGHWAYS	
Approved	<u>March 19, 2013</u> <u>John D. Mueh</u> President, Village of Romeoville
Passed	<u>April 4, 2013</u> <u>C. Holt</u> District 1 Engineer of Local Roads & Streets
Released for Bid Based on Limited Review	<u>April 10, 2013</u> <u>John Fontana</u> Deputy Director of Highways, Region 1 Engineer

PRINTED BY THE AUTHORITY OF
THE STATE OF ILLINOIS

PREPARED BY OR UNDER THE
DIRECT SUPERVISION OF:
Henry J. Hlubek Jr.
3/21/13

